

LOC	DIST	REVISIONS			
		REV	DESCRIPTION	DATE	BY
		P1	REVISED PER ECR-06-022654	22SEP06	SYJ LSF
		P2	REVISED PER ECO-10-000445	08JAN10	KK AEG

- △ MATERIAL: HOUSING AND COVER ARE HIGH TEMPERATURE THERMOPLASTIC, LIQUID CRYSTAL POLYMER (LCP), COLOR: NATURAL, FOR 1-916783-5, 1-916783-8 AND 3-916783-5, COVER IS BLACK. LP SLZ LEVER MATERIAL IS STAINLESS STEEL. CONTACT MATERIAL IS COPPER ALLOY.
- △ FINISH: CONTACT AREA-GOLD THICKNESS PER TABLE OVER 0.0038[.000150] MIN. THICK NICKEL PLATE. SOLDER TAIL- 0.00381-0.00635 [.000150-.000250] MIN. THICK TIN-LEAD OVER 0.00127[.000050] MIN. THICK NICKEL PLATE. CONTACT AREA SHALL BE FREE OF LUBRICANT.
- △ PRODUCT LINE: LOW PROFILE SINGLE LEVER ZIF (LP SLZ). PRODUCT SPEC 108-1572, APPLICATION SPEC 114-1100.
- △ PRODUCT LINE: LOW PROFILE SCREWDRIVER ACTUATED ZIF (LP SAZ). PRODUCT SPEC 108-1572-1, APPLICATION SPEC 114-1105, INSTRUCTION SHEET 408-3355.
- △ PRODUCT CONFORMS TO NOTE △ EXCEPT DURABILITY PER PRODUCT SPECIFICATION IS 20 CYCLES AND SMALL INDENTATIONS IN SCREWDRIVER SLOTS PERMISSIBLE AFTER ACTUATION.
- 6 DATE CODE MAY VARY IN LOCATION AND FORMAT DEPENDING ON MANUFACTURING LOCATION.
- △ OBSOLETE PARTS: OBSOLETE CIS STREAMLINING PER D.RENAUD/D.SINISI

DRAWING	TRAY PACKAGED NUMBER OF SOCKETS PER SHIPPING BOX	POSITIONS	SOLDER TAIL LENGTH DIM A±0.25 [±.010]	MIN GOLD THICKNESS 2?	FC-PGA/PPGA	HANDLE STYLE	PRODUCT LINE	PART NUMBER
OBSOLETE 9	SEE SHEET 6	160	370	2.03 [.080]	0.00076 [.000030]	-	LP SAZ △ 5	<del>6-916783-1</del>
	SEE SHEET 5	160	370	2.79 [.110]	0.00038 [.000015]	-	LP SAZ △ 4	<del>5-916783-6</del>
	SEE SHEET 5	160	370	2.36 [.093]	0.00038 [.000015]	-	LP SAZ △ 4	5-916783-5
	SEE SHEET 5	160	370	2.36 [.093]	0.00076 [.000030]	-	LP SAZ △ 4	5-916783-2
OBSOLETE 9	SEE SHEET 4	160	370	3.56 [.140]	0.00038 [.000015]	-	LP SAZ △ 4	4-916783-7
	SEE SHEET 4	160	370	2.79 [.110]	0.00038 [.000015]	-	LP SAZ △ 4	<del>4-916783-6</del>
OBSOLETE 9	SEE SHEET 4	160	370	2.36 [.093]	0.00038 [.000015]	-	LP SAZ △ 4	4-916783-5
	SEE SHEET 4	160	370	2.36 [.093]	0.00076 [.000030]	-	LP SAZ △ 4	<del>4-916783-2</del>
OBSOLETE 9	SEE SHEET 3	90	371	2.36 [.093]	0.00038 [.000015]	LOW PROFILE	LP SLZ △ 3	<del>3-916783-5</del>
	SEE SHEET 3	90	370	2.36 [.093]	FLASH	LOW PROFILE	LP SLZ △ 3	<del>1-916783-8</del>
OBSOLETE 9	SEE SHEET 3	60	370	2.36 [.093]	0.00038 [.000015]	JOG	LP SLZ △ 3	1-916783-5
	SEE SHEET 2	90	370	2.79 [.110]	FLASH	LOW PROFILE	LP SLZ △ 3	<del>2-916783-9</del>
OBSOLETE 9	SEE SHEET 2	90	370	2.36 [.093]	FLASH	LOW PROFILE	LP SLZ △ 3	2-916783-8
	SEE SHEET 2	90	370	2.03 [.080]	FLASH	LOW PROFILE	LP SLZ △ 3	<del>2-916783-7</del>
RESTRICTED TO INTEL	SEE SHEET 2	90	370	2.79 [.110]	0.00038 [.000015]	LOW PROFILE	LP SLZ △ 3	2-916783-6
	SEE SHEET 2	90	370	2.36 [.093]	0.00038 [.000015]	LOW PROFILE	LP SLZ △ 3	2-916783-5
	SEE SHEET 2	90	370	2.03 [.080]	0.00038 [.000015]	LOW PROFILE	LP SLZ △ 3	2-916783-4
	SEE SHEET 2	90	370	2.79 [.110]	0.00076 [.000030]	LOW PROFILE	LP SLZ △ 3	2-916783-3
OBSOLETE 9	SEE SHEET 2	90	370	2.36 [.093]	0.00076 [.000030]	LOW PROFILE	LP SLZ △ 3	2-916783-2
	SEE SHEET 2	90	370	2.03 [.080]	0.00076 [.000030]	LOW PROFILE	LP SLZ △ 3	<del>2-916783-1</del>
SUPERSEDED	SEE SHEET 2	90	370	3.56 [.140]	0.00076 [.000030]	LOW PROFILE	LP SLZ △ 3	2-916783-0
	-	90	370	2.79 [.110]	FLASH	SHORT	LP SLZ △ 3	916783-9
	-	90	370	2.36 [.093]	FLASH	SHORT	LP SLZ △ 3	916783-8
	-	90	370	2.03 [.080]	FLASH	SHORT	LP SLZ △ 3	916783-7
	-	90	370	2.79 [.110]	0.00038 [.000015]	SHORT	LP SLZ △ 3	916783-6
	-	90	370	2.36 [.093]	0.00038 [.000015]	SHORT	LP SLZ △ 3	916783-5
	-	90	370	2.03 [.080]	0.00038 [.000015]	SHORT	LP SLZ △ 3	916783-4
	-	90	370	2.79 [.110]	0.00076 [.000030]	SHORT	LP SLZ △ 3	916783-3
	-	90	370	2.36 [.093]	0.00076 [.000030]	SHORT	LP SLZ △ 3	916783-2
	-	90	370	2.03 [.080]	0.00076 [.000030]	SHORT	LP SLZ △ 3	916783-1

THIS DRAWING IS A CONTROLLED DOCUMENT.		DATE: 11SEP98	AMP MANUFACTURING (SINGAPORE) PTE. LTD.
DIMENSIONS: mm [INCHES]	TOLERANCES UNLESS OTHERWISE SPECIFIED:	APPROVED: SE LEONG	NAME: SOCKET ASSEMBLY, LOW PROFILE, ZIF PGA, 19 X 19 GRID
0 PLC ±	1 PLC ±0.30 [0.012]	PRODUCT SPEC: SEE TABLE	SIZE: 3:1
2 PLC ±	3 PLC ±	APPLICATION SPEC: SEE TABLE	CASE CODE: 00779
4 PLC ±	5 PLC ±	WEIGHT: -	DRAWING NO: 916783
6 PLC ±	7 PLC ±	CUSTOMER DRAWING	SCALE: 3:1 SHEET 1 OF 6 REV P2



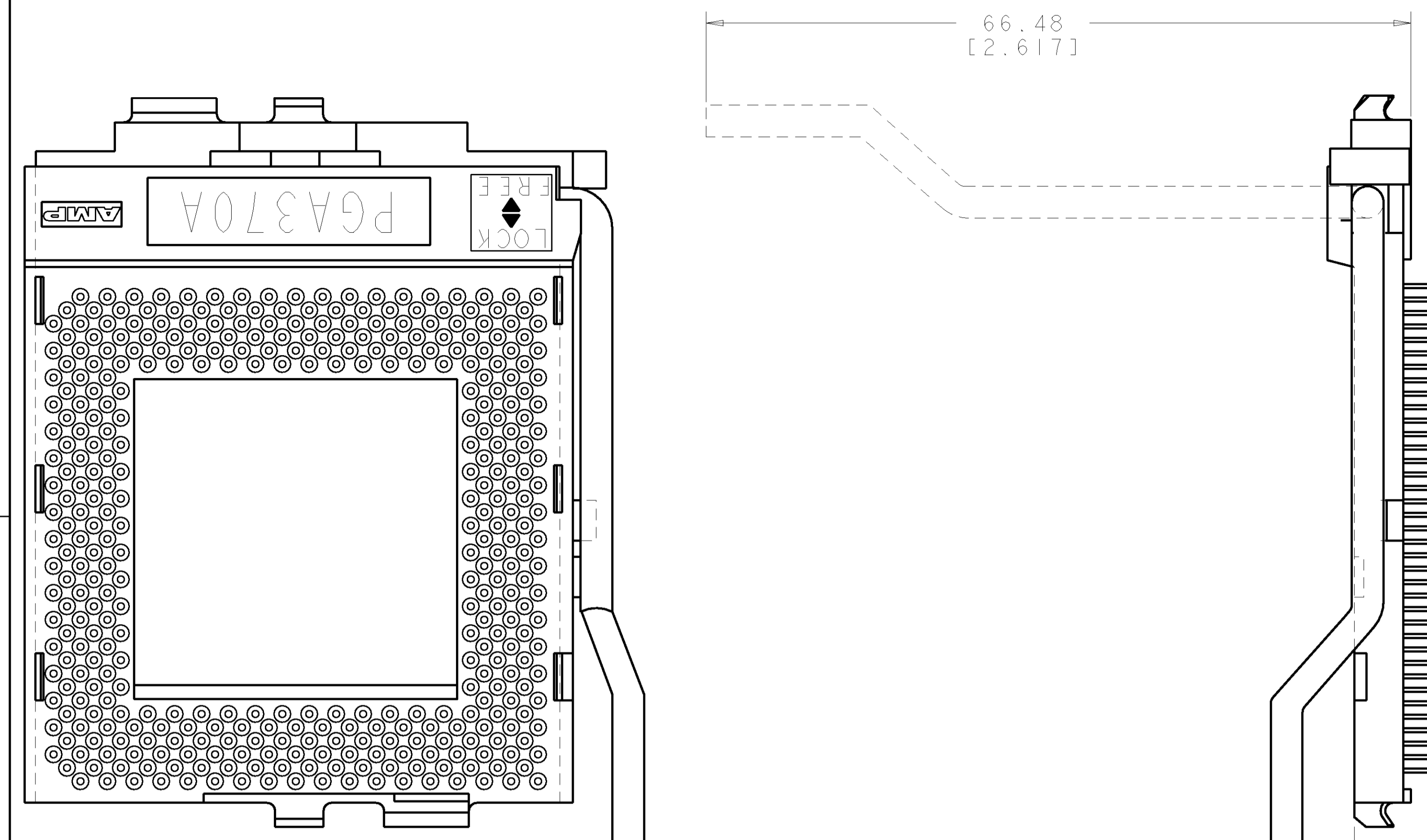

66.48  
[2.617]

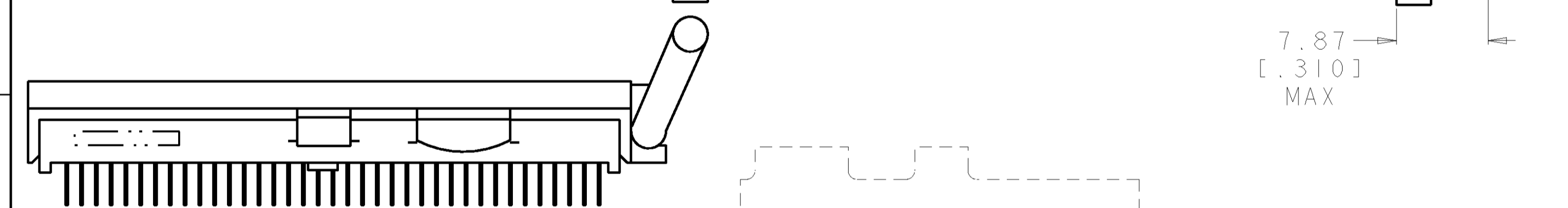

7.87  
[.310]  
MAX

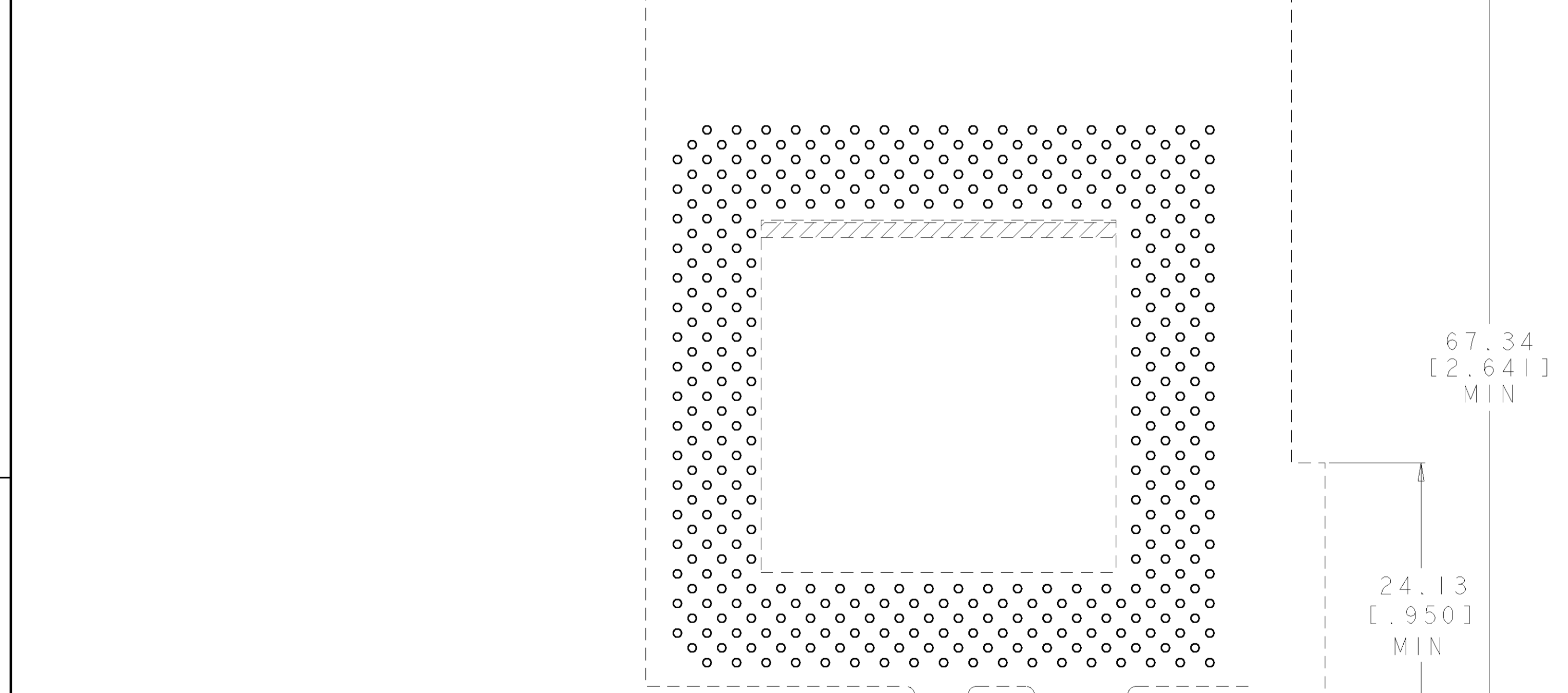

67.34  
[2.641]  
MIN

24.13  
[.950]  
MIN

RECOMMENDED PCB HOLE LAYOUT

6.60  
[.260]  
MIN

PART NUMBER 1-916783-5

EXCEPT ROTATED PATTERN, PGA370A LOGO AND HANDLE, ALL OTHER DETAILS SAME AS ON SHEET 2.

LOC	DATE	DESCRIPTION	DATE	BY	APP'D
DY		SEE SHEET 1			

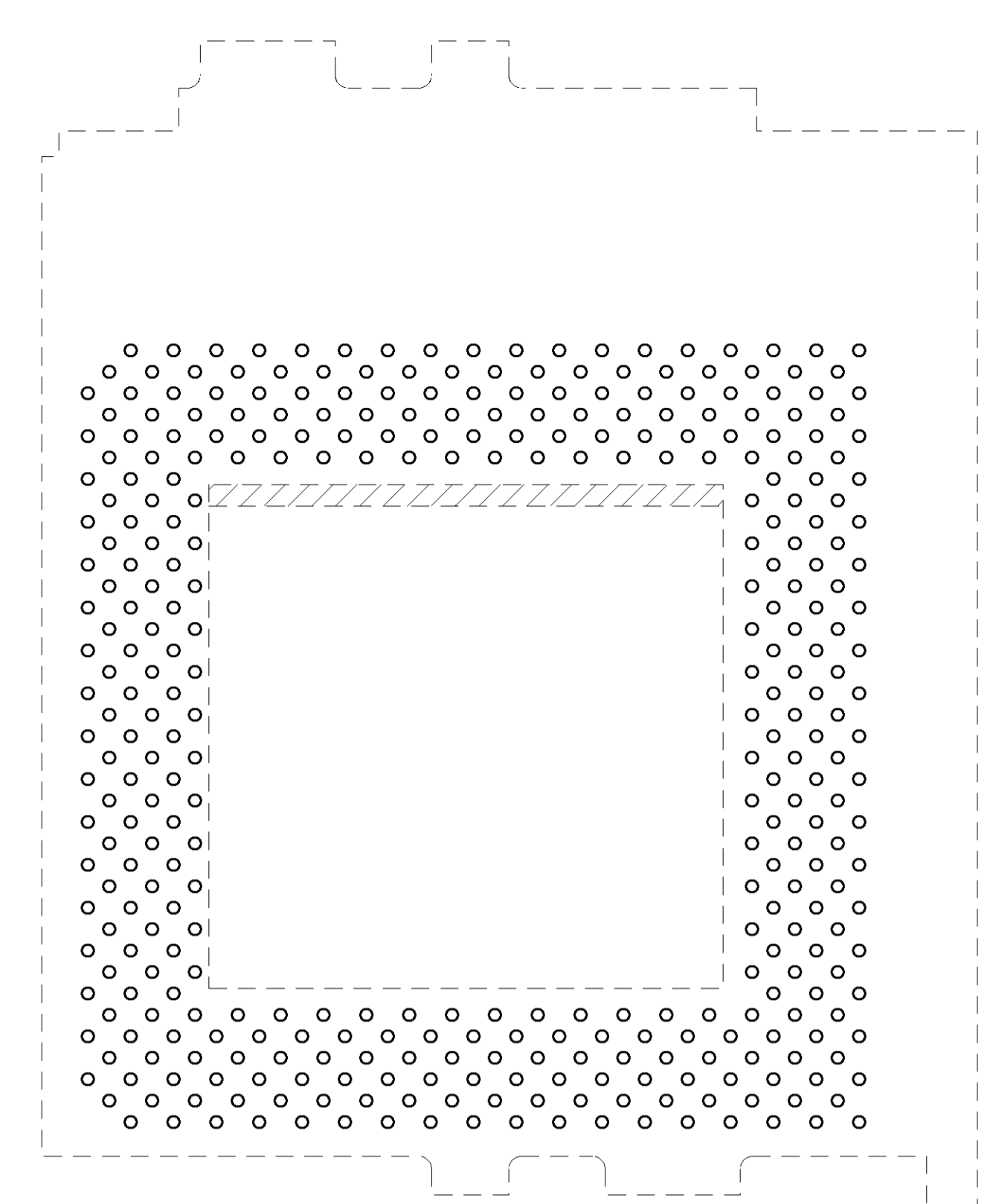
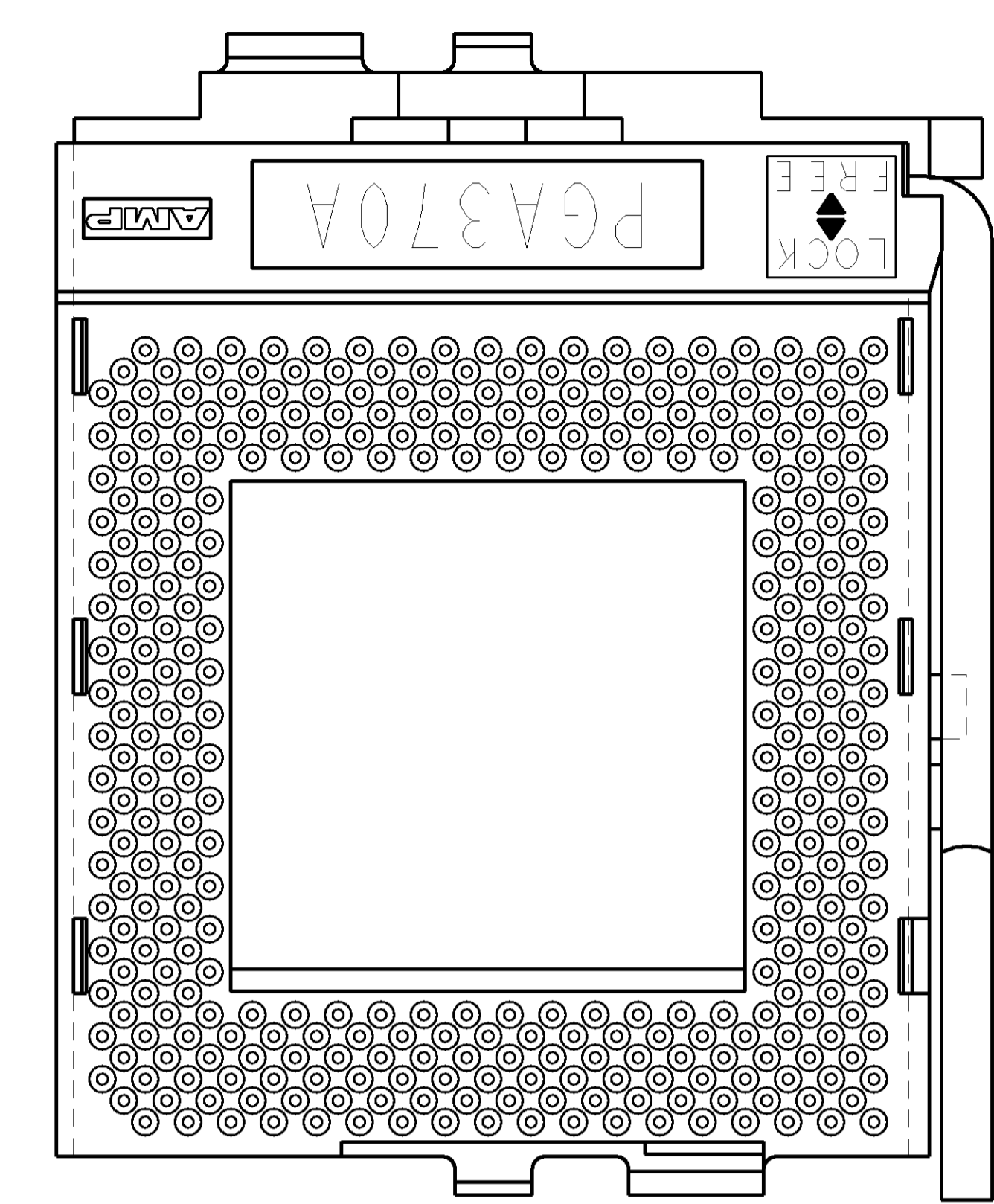

RECOMMENDED PCB HOLE LAYOUT

PART NUMBER 1-916783-8

EXCEPT ROTATED PATTERN AND PGA370A LOGO, ALL OTHER DETAILS SAME AS ON SHEET 2.

CIRCUIT FOR USE WITH A SOCKET 7 CPU

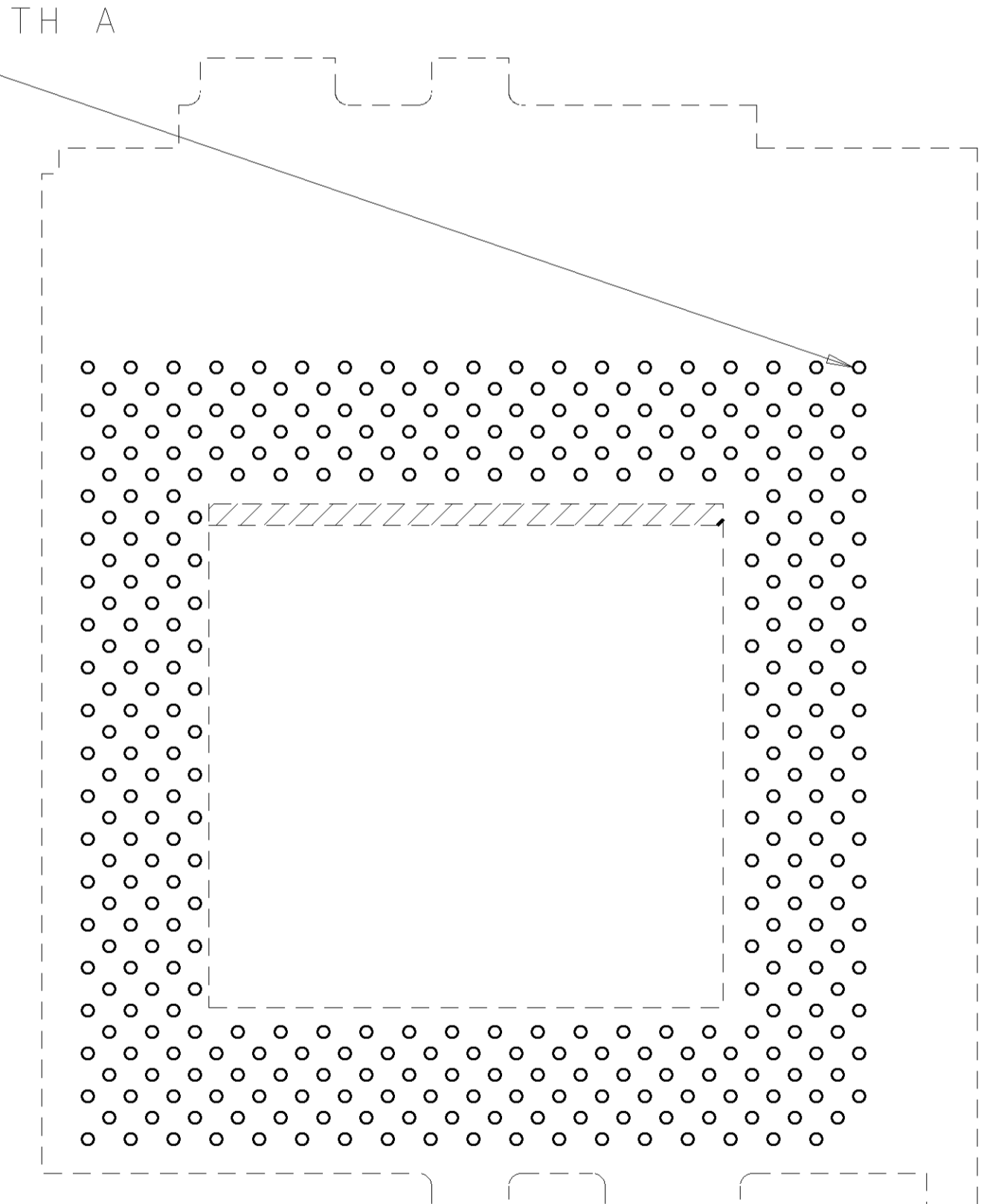
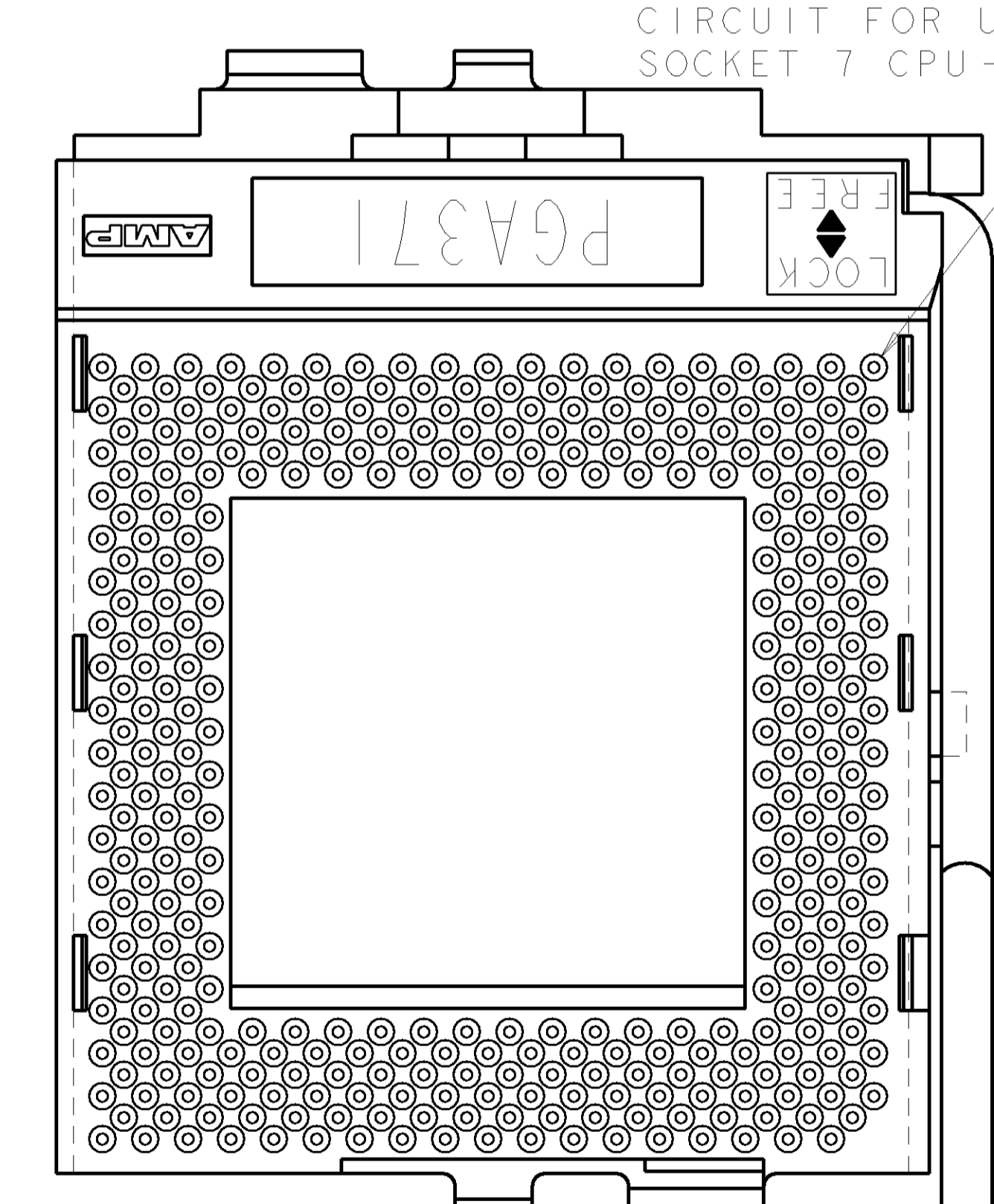

RECOMMENDED PCB HOLE LAYOUT

PART NUMBER 3-916783-5, 371 POSITIONS  
 EXCEPT 371 POSITIONS PATTERN AND PGA371 LOGO, ALL OTHER DETAILS SAME AS ON SHEET 2.

THIS DRAWING IS A CONTROLLED DOCUMENT.		OWN: B. HOLT	DSMATS9	<b>AMP</b> AMP MANUFACTURING (SINGAPORE) PTE. LTD.
DIMENSIONS: mm (INCHES)		CHK: B. KUHNLY	DSMATS9	
TOLERANCES UNLESS OTHERWISE SPECIFIED:		APP'D: SE. LEONG	NAME:	SOCKET ASSEMBLY, LOW PROFILE, ZIF PGA, 19 X 19 GRID
Ø PLC ±		PRODUCT SPEC:	SEE TABLE	
PLC ±0.20 (.008)		APPLICATION SPEC:	SEE TABLE	SIZE: CADE CODE: DRAWING NO:
PLC ±		REIGHT:	AI 00779	RESTRICTED TO:
MATERIAL: ALUMINUM		CUSTOMER DRAWING	SCALE: 3:1	SHEET 3 OF 6
				REV P2

LOC		DIST		REVISIONS				
1	2	3	4	5	6	7	8	
DATE	BY	APPD	DESCRIPTION	DATE	BY	APPD	DESCRIPTION	
-	-	-	SEE SHEET 1	-	-	-	-	

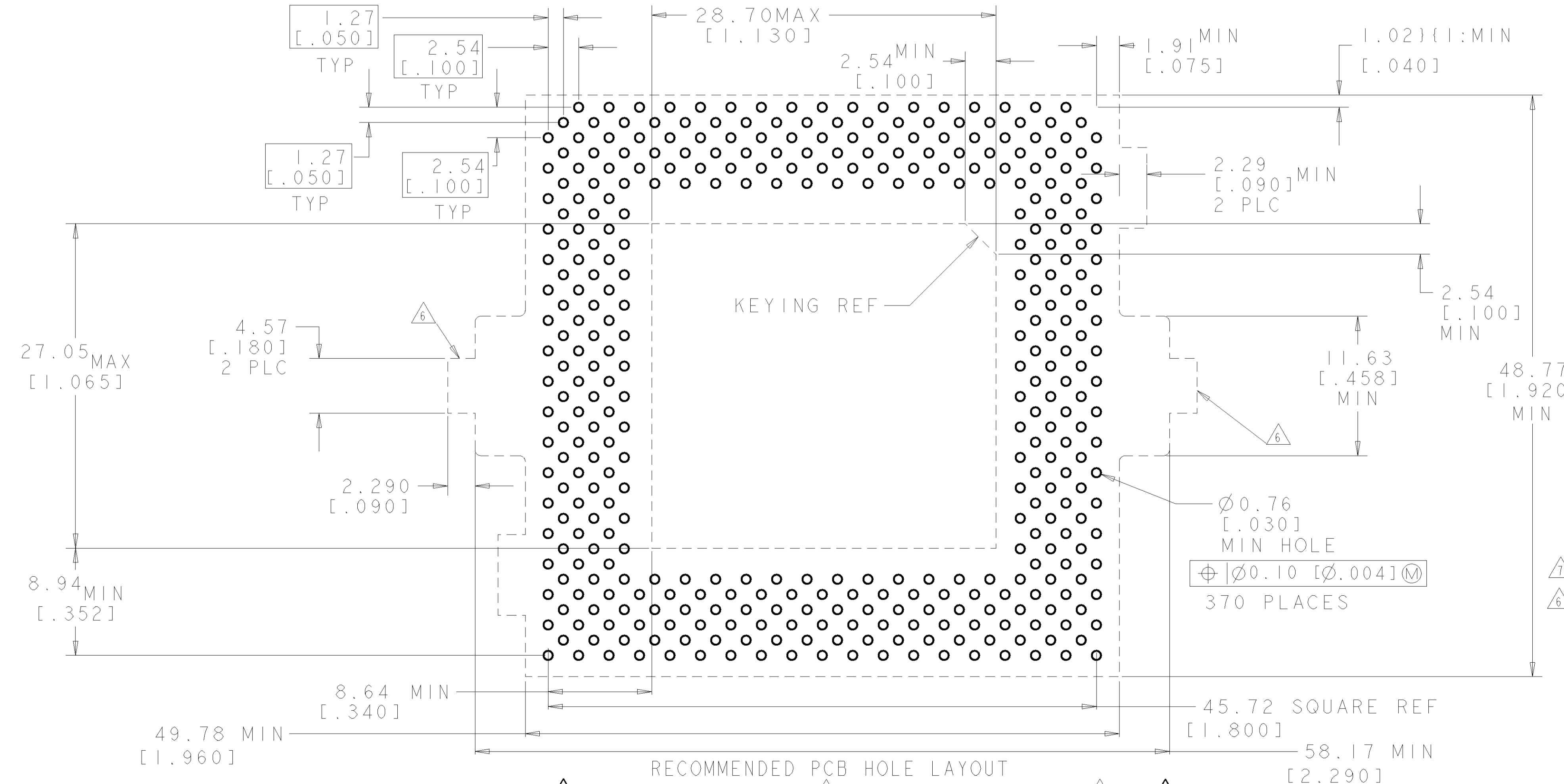
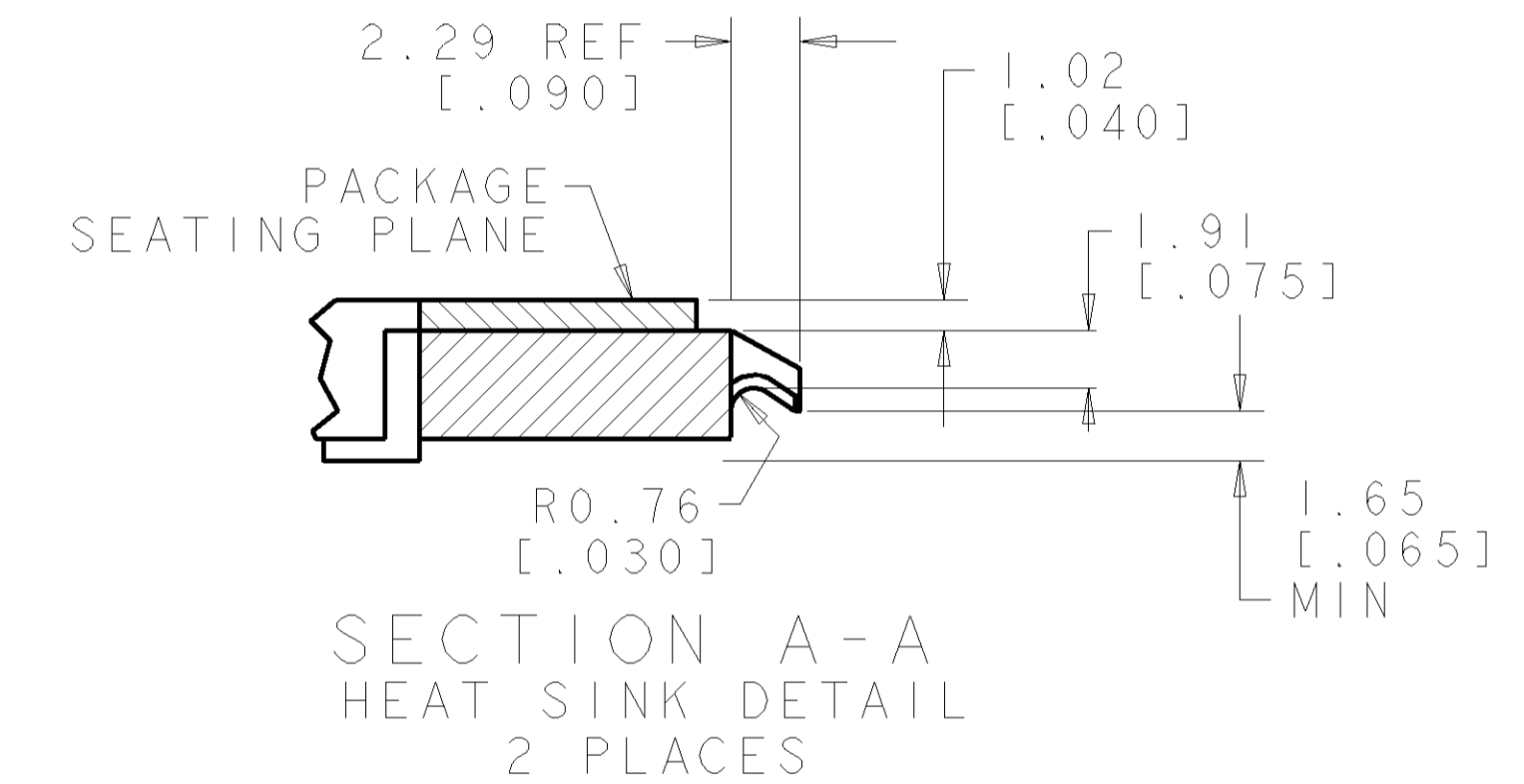
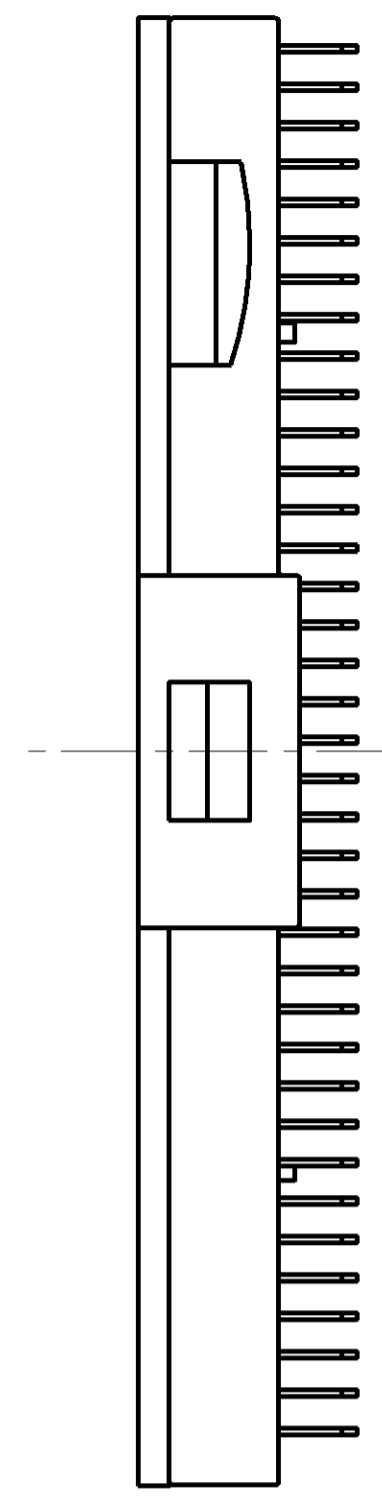
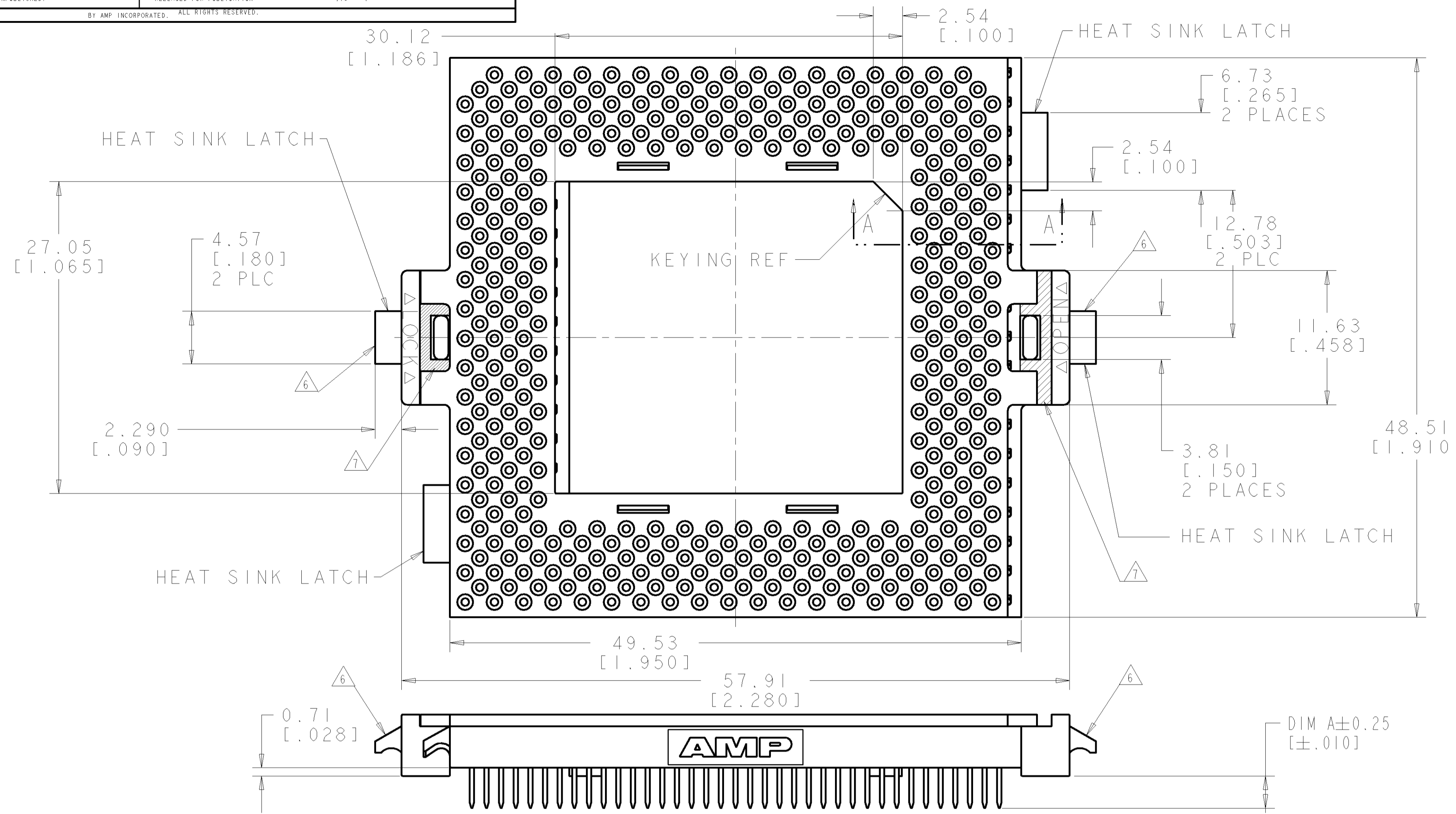

⚠ BLACK COLOUR MARKING ON HOUSING P/N: 4-916783-7 ONLY.  
 ⚠ HEAT SINK LATCHES ON 4-916783-5, 4-916783-6 AND 4-916783-7

PART NUMBERS 4-916783-2, 4-916783-5 AND 4-916783-6 & 4-916783-7

THIS DRAWING IS A CONTROLLED DOCUMENT.		DWG: A. HOLT 05MAY99	AMP MANUFACTURING (SINGAPORE) PTE. LTD.	
DIMENSIONS: mm (INCHES)		CHK: B. KUHNLY 05MAY99	NAME: SOCKET ASSEMBLY, LOW PROFILE, ZIF PGA, 19 X 19 GRID	
TOLERANCES UNLESS OTHERWISE SPECIFIED:		APPD: S.F. LEONG	PRODUCT SPEC: SEE TABLE	
0.150 ±		DATE: 05MAY99	APPLICATION SPEC: SEE TABLE	
0.250 ±		SCALE: 4:1	RESTRICTED TO: P2	
0.500 ±		SHEET: 4 OF 6	MATERIAL: CUSTOMER DRAWING	
0.750 ±		REV: P2	SIZE: A1 00779 916783	
1.000 ±			CUSTOMER DRAWING	

LOC	DIST	REVISIONS				
1	2	LYR	DESCRIPTION	DATE	DWG	APPD
-	-	-	SEE SHEET 1	-	-	-

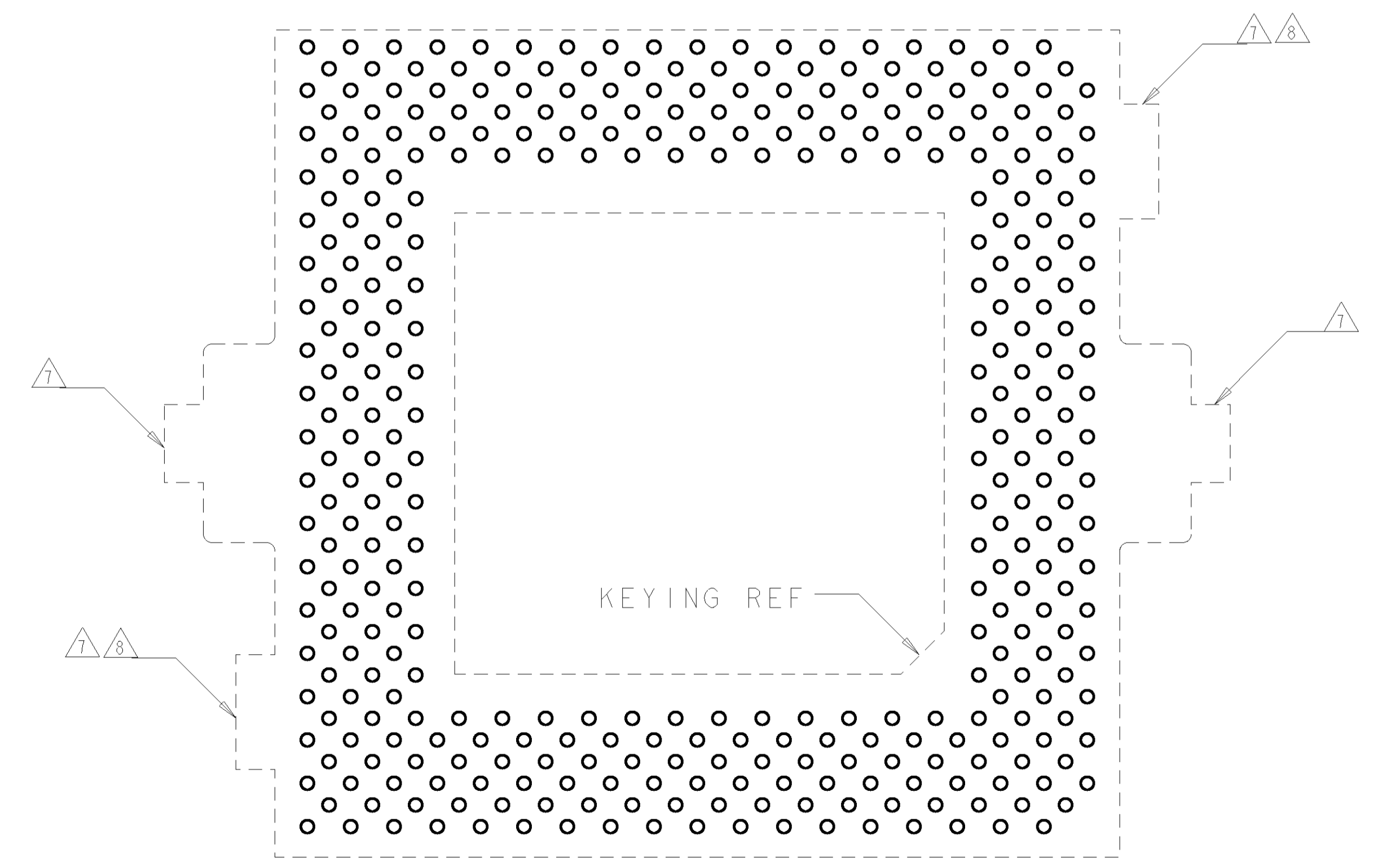
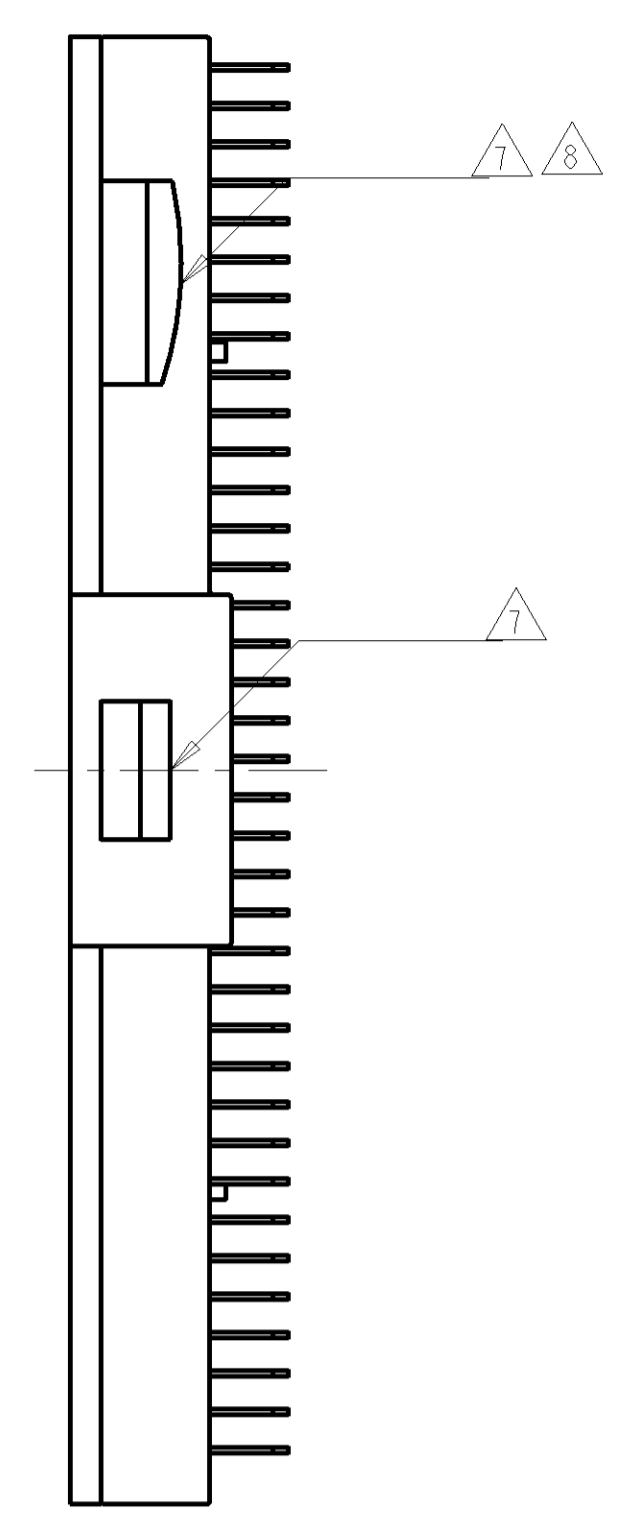
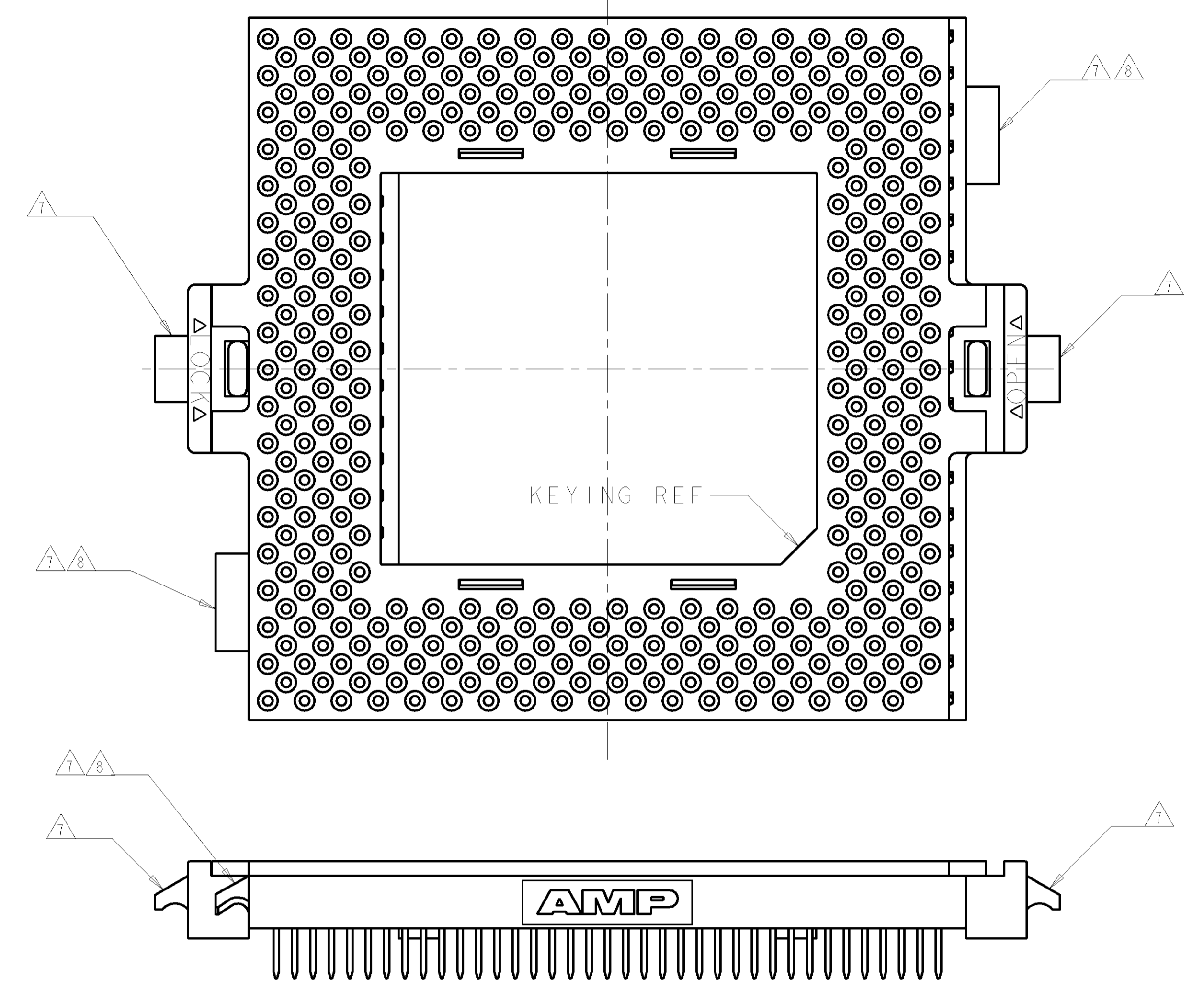

RECOMMENDED PCB HOLE LAYOUT  
 PART NUMBERS 5-916783-2, 5-916783-5 AND 5-916783-6  
 EXCEPT FOR PATTERN AND ROTATED KEYING  
 ALL OTHER DETAILS SAME AS SHEET 4

7? HEAT SINK LATCHES ON 5-916783-5 ONLY.  
 8? HEAT SINK LATCHES ON 5-916783-6 ONLY.

THIS DRAWING IS A CONTROLLED DOCUMENT.		DWG A. HOLT	OSMAY99	<b>AMP</b> AMP MANUFACTURING (SINGAPORE) PTE. LTD.
DIMENSIONS: mm (INCHES)		CHK B. KUHNH Y	OSMAY99	
TOLERANCES UNLESS OTHERWISE SPECIFIED:		APPD S.F. LFONG	NAME SOCKET ASSEMBLY, LOW PROFILE, ZIF PGA, 19 X 19 GRID	RESTRICTED TO
0.150 ±		PRODUCT SPEC SEE TABLE	APPLICATION SPEC SEE TABLE	
MATERIAL		WEIGHT	SIZE A1	SCALE 4:1
FINISH		REVISIONS	DATE 00779	SHEET 5 OF 6
CUSTOMER DRAWING		DRAWING NO 916783		REV P2

LOC		DIST		REVISIONS			
1	2	3	4	5	6	DATE	APPD
- SEE SHEET 1							

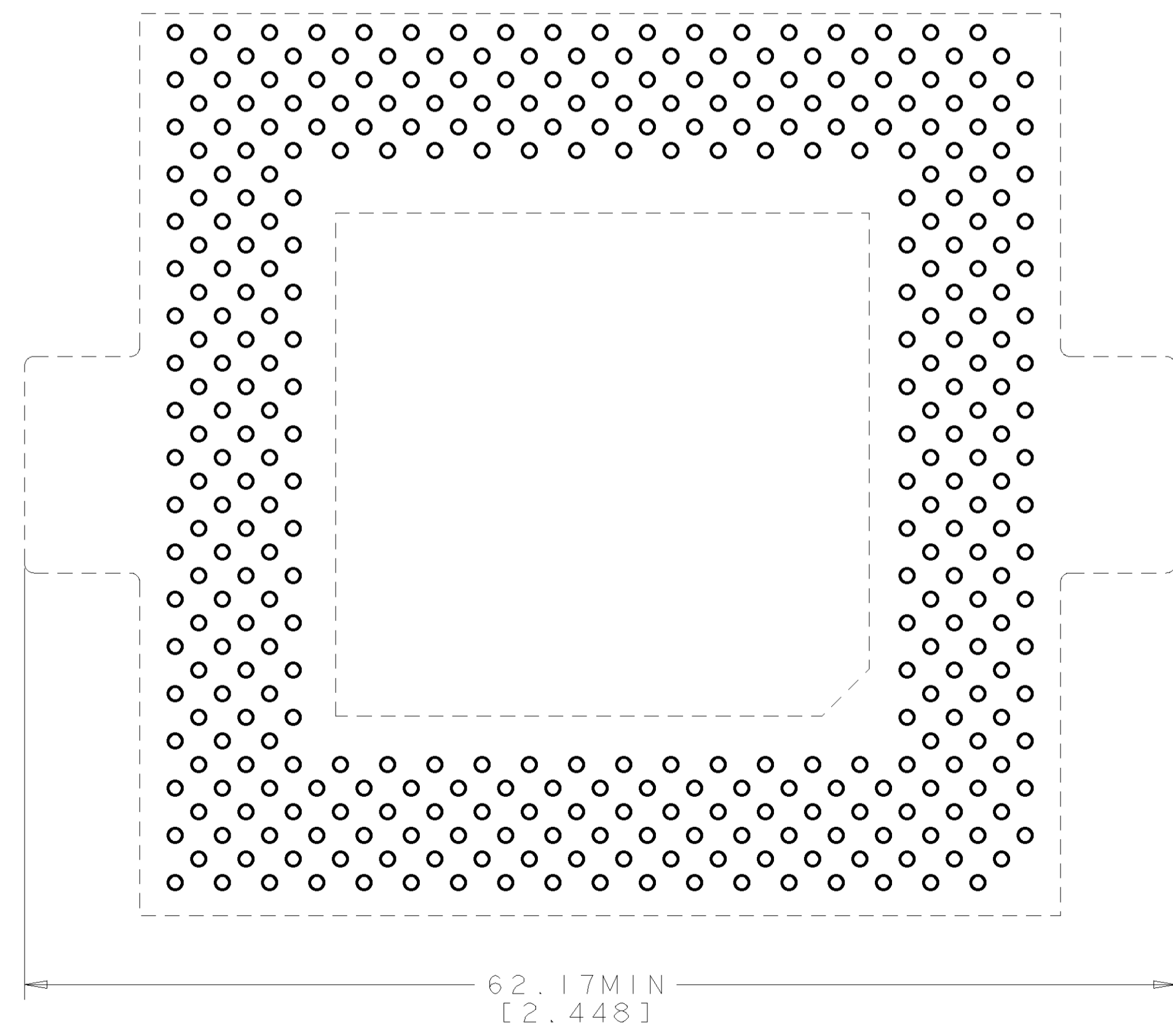
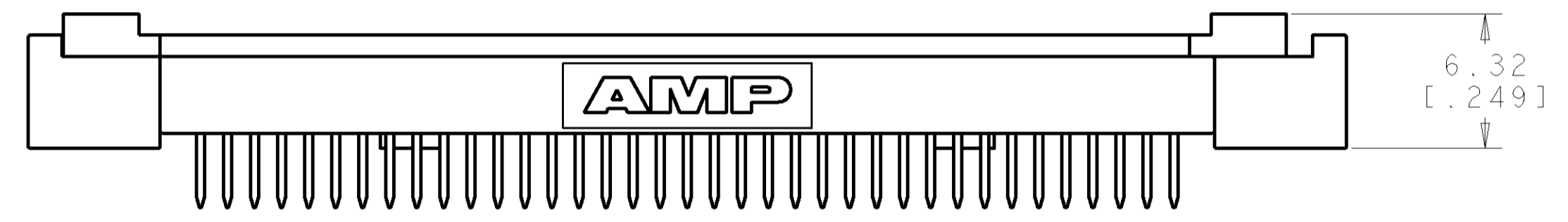
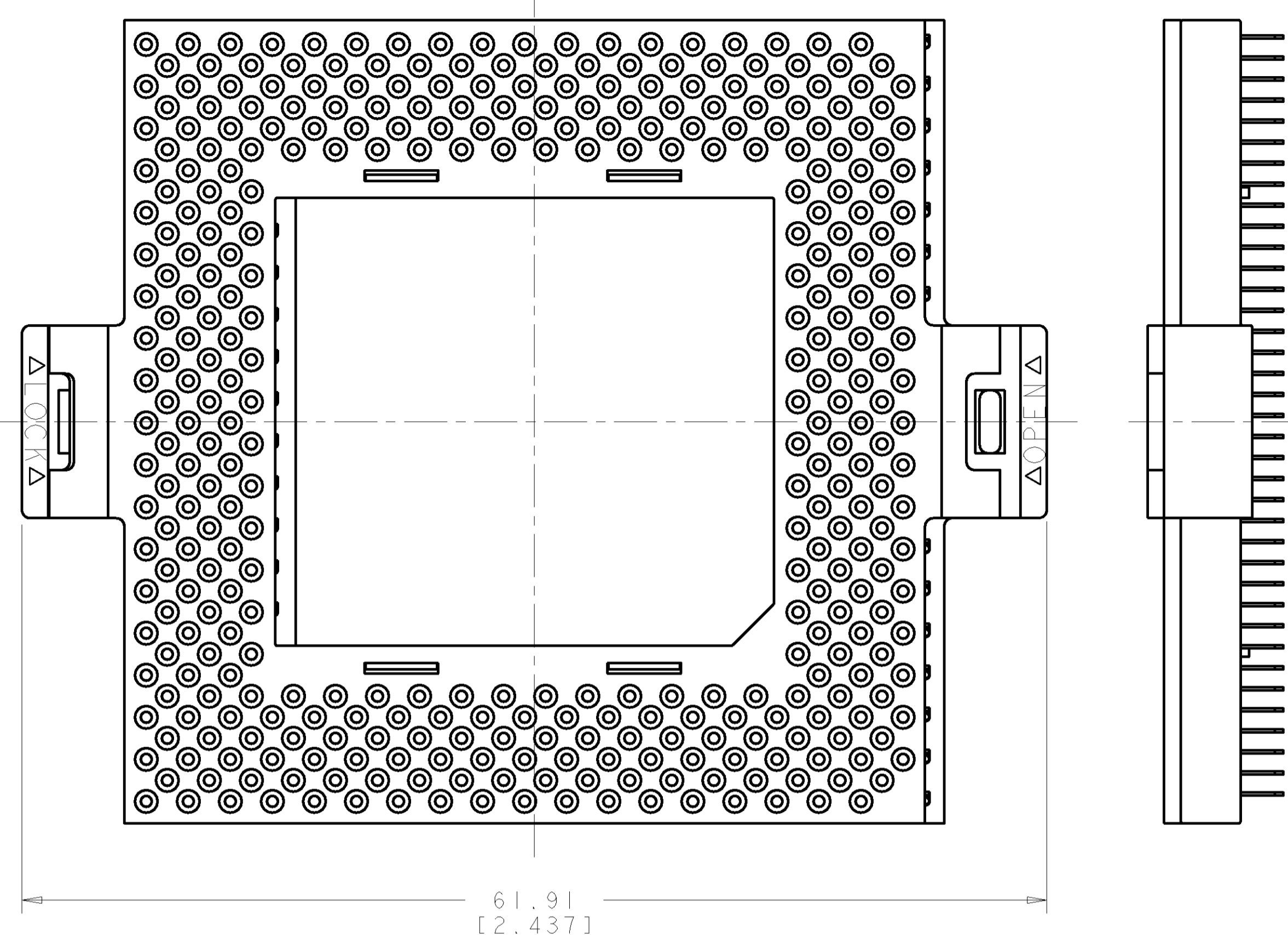

RECOMMENDED PCB HOLE LAYOUT

PART NUMBER 6-916783-1

EXCEPT FOR PATTERN, ROTATED KEYING, NO HEAT SINK LATCHES AND EXTENDED ACTUATION TABS, ALL OTHER DETAILS SAME AS 4-916783-2

THIS DRAWING IS A CONTROLLED DOCUMENT.		DWN A. HOLT	SIMAROO	<b>AMP</b> AMP MANUFACTURING (SINGAPORE) PTE. LTD.
DIMENSIONS: mm (INCHES)		CHK B. KUHNLY	SIMAROO	
TOLERANCES UNLESS OTHERWISE SPECIFIED:		NAME SE L'FONG		SOCKET ASSEMBLY, LOW PROFILE, ZIF PGA, 19 X 19 GRID
0 PLG ±		PRODUCT SPEC SEE TABLE		
1 PLG ±		APPLICATION SPEC SEE TABLE		SIZE A1
2 PLG ±		RESTRICTED TO		
3 PLG ±		MATERIAL		SCALE 4:1 SHEET 6 OF 6 REV P2
4 PLG ±		FINISH		
ANGLES ±		WEIGHT		
DRAWING NO. 00779		DRAWING NO. 916783		
CUSTOMER DRAWING				