

Y	HSG COLOR
Y = 0	WHITE
Y = 1	BLACK
Y = 2	YELLOW
Y = 3	BLUE
Y = 4	BLACK

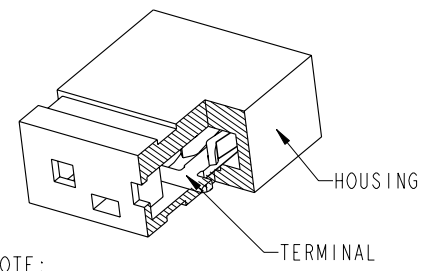

NOTE:
 1. MATERIAL
 HOUSING : 30% GLASS FILLED POLYESTER
 FLAME RETARDANT PER UL 94V-0
 COLOR : REFER TO TABLE
 TERMINAL : PHOSPHOR BRONZE

2. PLATING : REFER TO TABLE
 3. TECHNICAL REQUIREMENTS:
 INSERTION FORCE : 12 NEWTONS (2.7 LB) MAX. PER CONNECTOR.
 WITHDRAWL FORCE : 2 NEWTONS (0.45 LB) MIN. PER CONNECTOR.
 (MATE WITH 0.635MM SQ. PIN 2.54MM PITCH HEADER)
 4. THE HOUSING WILL WITHSTAND EXPOSURE TO 200°C PEAK TEMPERATURE FOR 10 SECONDS IN A CONVECTION, INFRA-RED OR VAPOR PHASE REFLOW OVEN.
 5. THE HOUSING WILL WITHSTAND EXPOSURE TO 200°C PEAK TEMPERATURE FOR 10 SECONDS IN A CONVECTION, INFRA-RED OR VAPOR PHASE REFLOW OVEN.
 6. THIS PRODUCT MEETS EUROPEAN UNION DIRECTIVES AND OTHER COUNTRY REGULATIONS AS DESCRIBED IN GS-22-008.
 7. A \triangle SYMBOL WILL BE NEXT TO ANY DIMENSION, VIEW OR NOTE WHICH HAS BEEN MODIFIED WITH THE CURRENT DRAWING REVISION.

PRODUCT NO	PLATING
63429-1Y2	0.38 μ m/15 μ " Au CONTACT. Au FLASH ALL OVER 1.27 μ m/50 μ " Ni
63429-2Y2	0.76 μ m/30 μ " Au CONTACT. Au FLASH ALL OVER 1.27 μ m/50 μ " Ni
63429-3Y2	2.54 μ m/100 μ " TIN/LEAD OVER 1.27 μ m/50 μ " Ni
63429-4Y2	0.08 μ m/3 μ " Au FLASH OVER 1.27 μ m/50 μ " Ni

PRODUCT NO	PLATING
63429-1Y2LF SEE NOTE 6	0.38 μ m/15 μ " Au CONTACT. Au FLASH ALL OVER 1.27 μ m/50 μ " Ni
63429-2Y2LF SEE NOTE 6	0.76 μ m/30 μ " Au CONTACT. Au FLASH ALL OVER 1.27 μ m/50 μ " Ni
63429-4Y2LF SEE NOTE 6	0.08 μ m/3 μ " Au FLASH OVER 1.27 μ m/50 μ " Ni

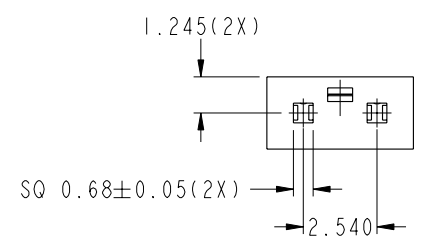
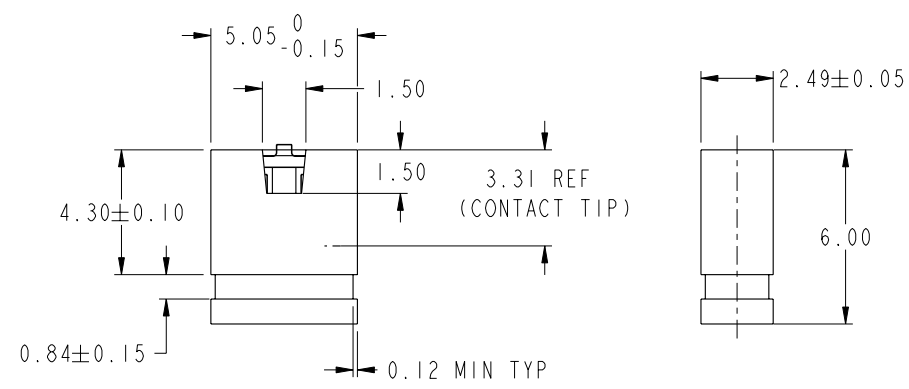

rev	ecn no	dr	date
A	S90164	BSL	1999-09-16
B	S90219	BSL	1999-12-15
C	S90227	BSL	1999-12-23
D	S04-0261	KBM	2004-12-10
E	S09-0247	KHL	2009-08-07
F	S10-0204	SM	2009-12-08

www.fciconnect.com

surface	-	tolerance std	ISO 1302	ISO 406	ISO 1101	projection	MM
TOLERANCES UNLESS OTHERWISE SPECIFIED						size	A3
ANGULAR	LINEAR	0.X	±0.35			Scale	6:1
0° ±3°		0.XX	±0.25			ECN	S10-0204
		0.XXX	±0.10			Spec ref	

Dr	BS LOW	1999-12-23
Eng	JPEH	1999-12-23
Chr	KBMAH	2009-12-08
Appr	JOEY NG	2009-12-08

Product family: JUMPER

FCI	title	JUMPER	dwg no	63429	Rev.	F
	catalog no					

CUSTOMER sheet 1 of 1

Copyright FCI

REV F - 2006-04-17