

PART NO	PLATING
90518-102 SEE NOTE 5	0.38µm/15µ" Au CONTACT. Au FLASH ALL OVER 1.27µm/50µ" Ni
90518-202 SEE NOTE 5	0.76µm/30µ" Au CONTACT. Au FLASH ALL OVER 1.27µm/50µ" Ni
71363-302 SEE NOTE 5	2.54µm/100µ" TIN/LEAD PLATING
90518-102LF SEE NOTE 5	0.38µm/15µ" Au CONTACT. Au FLASH ALL OVER 1.27µm/50µ" Ni
90518-202LF SEE NOTE 5	0.76µm/30µ" Au CONTACT. Au FLASH ALL OVER 1.27µm/50µ" Ni

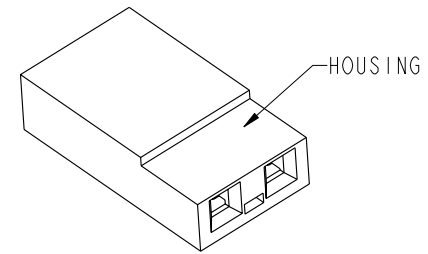

- NOTES:
- MATERIAL  
HOUSING : 30% GLASS FILLED POLYESTER  
FLAME RETARDANT PER UL 94V-0  
COLOR : BLACK
  - TERMINAL : PHOSPHOR BRONZE  
PLATING : REFER TO CHART
  - 90518-102 AND 90518-202 ARE THE SAME AS 90518-102LF AND 90518-202LF RESPECTIVELY. THE SUFFIX"LF" IS ADDED FOR EASY LEAD-FREE IDENTIFICATION.
  - THE HOUSING WILL WITHSTAND EXPOSURE TO 200°C PEAK TEMPERATURE FOR 10 SECONDS IN A CONVECTION, INFRA-RED OR VAPOR PHASE REFLOW OVEN.
  - THIS PRODUCT MEETS EUROPEAN UNION DIRECTIVES AND OTHER COUNTRY REGULATIONS AS DESCRIBED IN GS-22-008.
  - A  $\triangle$  SYMBOL WILL BE NEXT TO ANY DIMENSION, VIEW OR NOTE WHICH HAS BEEN MODIFIED WITH THE CURRENT DRAWING REVISION.

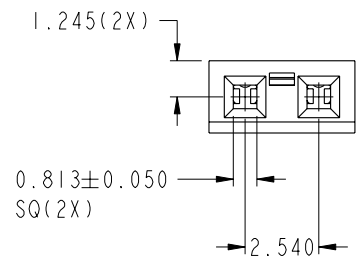
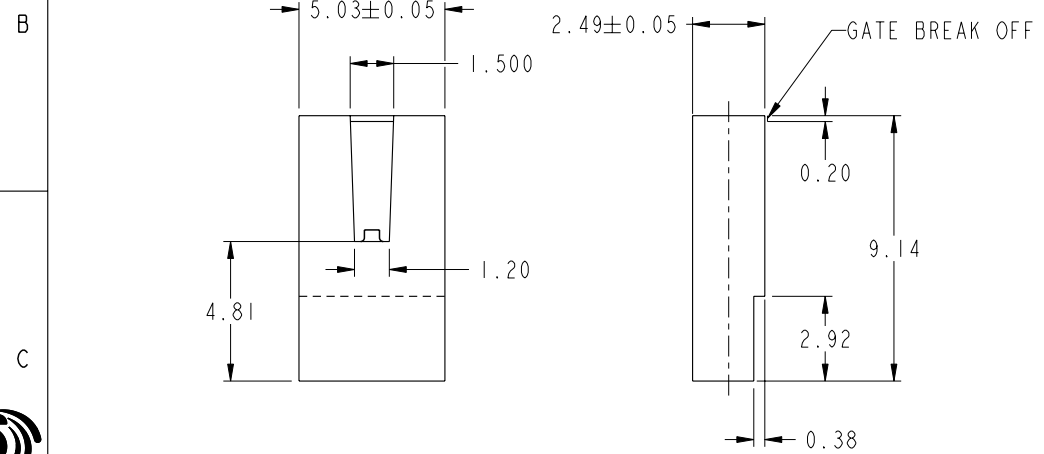

Copyright FCI.

rev	ecn no	dr	date
A	S10079	MLC	1991-03-22
B	S04-0218	KBM	2004-10-18
C	S06-0061	KHL	2006-02-24
D	S10-0015	KHL	2010-01-18
E	S10-0204	SM	2010-07-05
-	-	-	-
-	-	-	-

www.fciconnect.com		surface - ✓	tolerance std	projection	MM
		ISO 1302	ISO 406 ISO 1101		
		TOLERANCES UNLESS OTHERWISE SPECIFIED		size	Scale
Dr	ML CHWA	1991-03-22	ANGULAR	A3	6:1
Eng	KB MAH	2004-10-18	LINEAR		
Chr	KH LEE	2010-07-05	0° ±3°		
Appr	JOEY NG	2010-07-05	Product family	JUMPER	Spec ref
		title		90518	Rev.
		HIGH BODY JUMPER			E
		catalog no		CUSTOMER	sheet 1 of 1

REV I - 2006-04-17