

4

3

2

1

used for:

D-SUB

F

F

E

E

D

D

C

C

B

B

A

A

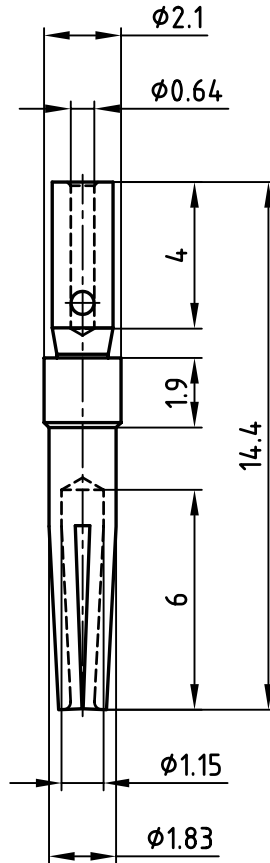

APPROVAL # FREIGABE # DEBLOCAGE # AUTOR/ZACION # APPROVAL	
CUSTOMER APPROVAL DATE:	
NAME:	TITLE:
COMPANY NAME:	
APPROVAL # FREIGABE # DEBLOCAGE # AUTOR/ZACION # APPROVAL	

Notes:

Material: brass

Finish: hard-gold-plated in the contact area

Temperature range: -55°C to +125°C

Rated current: 5.0A

Contact resistance: <= 10mOhm

THIS DRAWING MAY NOT BE COPIED OR REPRODUCED IN ANY WAY, AND MAY NOT BE PASSED ON TO A THIRD PARTY WITHOUT WRITTEN PERMISSION.
OWNERSHIP AND COPYRIGHT OF CONEC GmbH
DO NOT ALTER CAD DRAWING BY HAND

tolerance		dim. in mm	
2003	date	name	
drawn	14.02.	Parei	
appd.	14.02.	Kühle	
norm			
d-old			
1 x b	Ä 2127	02.12.2004	Lehmen
rev.	description	date	name

scale:	5:1	
material:	SEE NOTES	
title:	CRIMP SOCKET CONTACT screw machined version accepts cable AWG 28-24	
dwg no:	AutoCAD 2000	DIN-A
	16K1A886	4
		sh: 1/1
part no:	162A18719X	

4

3

2

1