

# THUMB SCREWS

For quick removal of panel from chassis. Other variations available

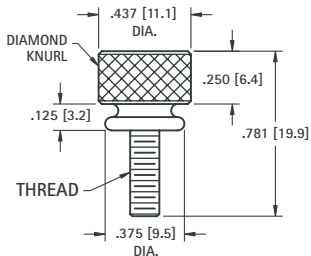

CAT. NO.	THREAD
1708	6-32
1709	8-32
1710	10-32

**MATERIAL:** Brass, Nickel Plate

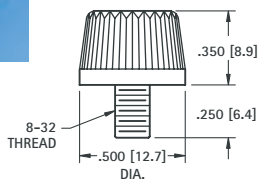

**CAT. NO. 1711**

**MATERIAL:**  
Knob: Phenolic  
Stud: Steel, Zinc Plate

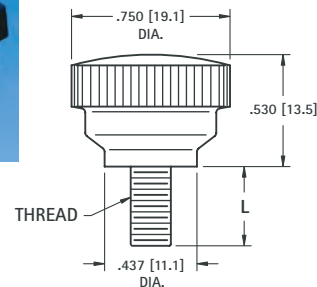

CAT. NO.	L	THREAD
1712	.375 (9.5)	10-24
1720	.500 (12.7)	.250-20

**MATERIAL:**  
Knob: Phenolic  
Stud: Steel, Zinc Plate

## SHAFT LOCKS

**MATERIAL:** Brass, Nickel Plate

For .125 (3.2) SHAFT

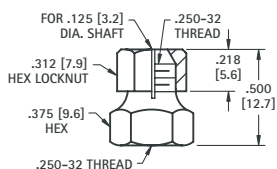

**CAT. NO. 1700**

For .250 (6.4) SHAFT

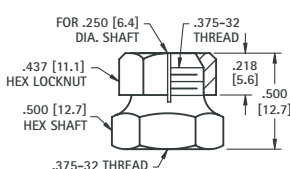

**CAT. NO. 1701**

For .250 (6.4) SHAFT

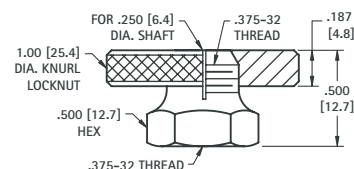

**CAT. NO. 1702**

## .250 (6.4) SHAFT COUPLING



• Two set screws hold shaft securely

**MATERIAL:** Brass, Nickel Plate  
Supplied unassembled

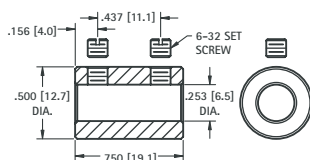

**CAT. NO. 1453**

## VOLUME CONTROL EXTENDERS



For .250 (6.4) volume control shafts having .375-32 threaded bushings.

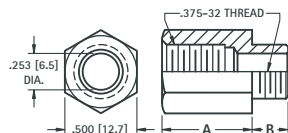

CAT. NO.	A	B
1464	.625 (15.9)	.250 (6.4)
1465	.625 (15.9)	.375 (9.5)
1466	.687 (17.4)	.500 (12.7)
1467	.750 (19.1)	.250 (6.4)

**MATERIAL:** Brass, Nickel Plate

## PANEL BEARINGS

STANDARD and MINIATURE

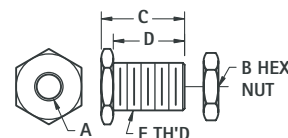

**MATERIAL:** Brass, Nickel Plate  
Supplied unassembled

CAT. NO.	A	B (HEX)	C	D	E THREAD
1705	.253 (6.5)	.437 (11.1)	.500 (12.7)	.437 (11.1)	.375-32 Standard
1706	.128 (3.3)	.343 (8.7)	.437 (11.1)	.375 (9.5)	.250-32 Miniature

## PRECISION PANEL NUTS



For Volume Controls, Switches, Capacitors, Tip Jacks, etc.

CAT. NO.	FOR	THREAD	DIAMETER	THICKNESS
1448	Mounting	.250-32	.375 Hex	.093 (2.38)
1449	Mini. Control	.250-32	.312 Hex	.078 (1.98)
1456	Vol. Control	.375-32	.500 Hex	.093 (2.38)
1458	Switch	.468-32	.562 Hex	.078 (1.98)
1459	Switch Ring	.468-32	.625 Knurled	.062 (1.57)
1472	Filter	.312-32	.375 Hex	.093 (2.38)

**MATERIAL:** Brass, Nickel Plate

# STAINLESS STEEL PANEL HARDWARE

MATERIAL: Stainless Steel per ASTM-A581/A582

## CAPTIVE PANEL SCREWS

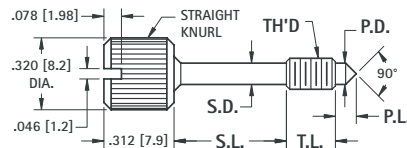
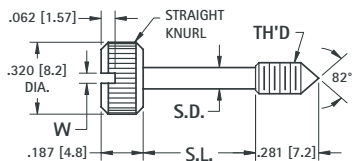

CAT. NO.	THREAD	S.D. ± .005 (.13)	S.L. ± .010 (.25)	W + .015 (+.38) -.000
8700	4-40	.078 (2.0)	.375 (9.5)	.036 (.091)
8701	4-40	.078 (2.0)	.500 (12.7)	.036 (.091)
8702	4-40	.078 (2.0)	.625 (15.9)	.036 (.091)
8703	6-32	.095 (2.41)	.375 (9.5)	.045 (1.14)
8704	6-32	.095 (2.41)	.500 (12.7)	.045 (1.14)
8705	6-32	.095 (2.41)	.625 (15.9)	.045 (1.14)

CAT. NO.	THREAD	T.L. ±.015 (.38)	S.D. ±.005 (.13)	S.L. ±.010	P.D. +.000, -.016 (-.40)	P.L. ±.015 (.38)
8706	4-40	.125 (3.2)	.078 (2.0)	.171 (4.3)	.078 (2.0)	.078 (2.0)
8707	4-40	.125 (3.2)	.078 (2.0)	.296 (7.5)	.078 (2.0)	.078 (2.0)
8708	4-40	.125 (3.2)	.078 (2.0)	.421 (10.7)	.078 (2.0)	.078 (2.0)
8709	6-32	.218 (5.5)	.095 (2.41)	.187 (4.7)	.095 (2.41)	.093 (2.36)
8710	6-32	.218 (5.5)	.095 (2.41)	.312 (7.9)	.095 (2.41)	.093 (2.36)
8711	6-32	.218 (5.5)	.095 (2.41)	.437 (11.1)	.095 (2.41)	.093 (2.36)

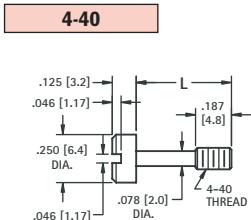

CAT. NO.	LENGTH
2413	.469 (11.9)
2414	.531 (13.4)

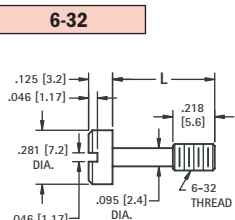

CAT. NO.	LENGTH
2415	.531 (13.5)
2416	.593 (15.1)
2417	.656 (16.7)

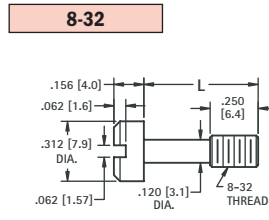
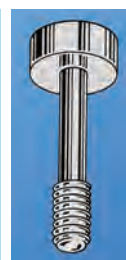

CAT. NO.	LENGTH
2418	.656 (16.7)
2419	.718 (18.2)
2420	.781 (19.8)

## THUMB SCREWS

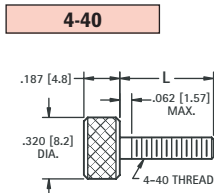

CAT. NO.	LENGTH
2400	.312 (7.9)
2401	.375 (9.5)
2402	.437 (11.1)
2403	.500 (12.7)

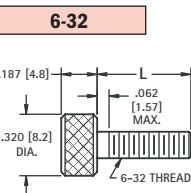

CAT. NO.	LENGTH
2404	.312 (7.9)
2405	.375 (9.5)
2406	.437 (11.1)
2407	.500 (12.7)

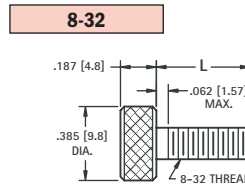

CAT. NO.	LENGTH
2408	.375 (9.5)
2409	.437 (11.1)
2410	.500 (12.7)
2411	.562 (14.3)
2412	.625 (15.9)

## SHOULDER SCREWS

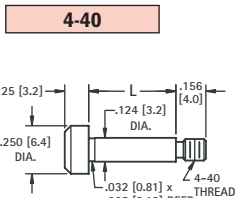

SLOTTED



SOCKET

CAT. NO.	LENGTH	CAT. NO.
2421	.125 (3.2)	2441
2422	.250 (6.4)	2442
2423	.375 (9.5)	2443
2424	.500 (12.7)	2444

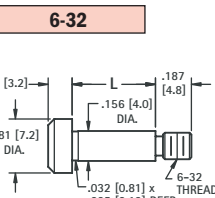

SLOTTED



SOCKET

CAT. NO.	LENGTH	CAT. NO.
2425	.125 (3.2)	2445
2426	.250 (6.4)	2446
2427	.375 (9.5)	2447
2428	.500 (12.7)	2448
2429	.625 (15.9)	2449
2430	.750 (19.1)	2450

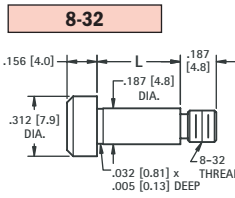

SLOTTED



SOCKET

CAT. NO.	LENGTH	CAT. NO.
2431	.125 (3.2)	2451
2432	.250 (6.4)	2452
2433	.375 (9.5)	2453
2434	.500 (12.7)	2454
2435	.625 (15.9)	2455
2436	.750 (19.1)	2456
2437	1.000 (25.4)	2457