

LOC		DIST		REVISIONS			
F	LTR	DESCRIPTION	DATE	DWN	APVD		
C		REVISED PER ECO-06-25468	11/08/06	SS	SH		
C1		REVISED PER-ECO-09-022908	08OCT09	KK	AEG		

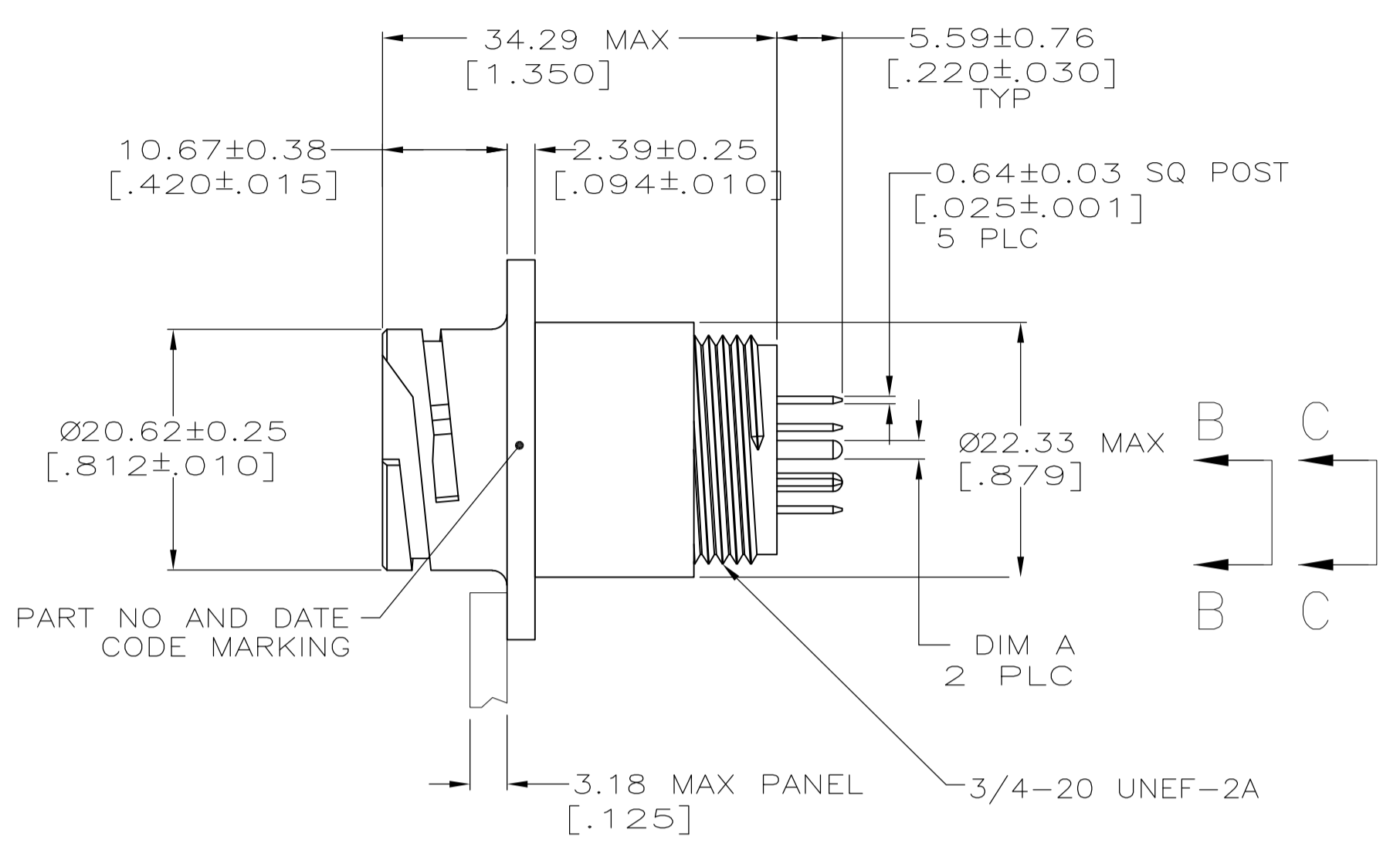

- CAVITY IDENTIFICATION ON FRONT AND REAR FACE.
- RECEPTACLE: NYLON, UL 94V-0 RATED, BLACK.
PIN CONTACT WITH 0.64 [.025] SQ POST: BRASS.
PIN CONTACT WITH Ø1.57 [.062] POST: COPPER ALLOY.
SPRING: STAINLESS STEEL.
INSERTS: BRASS.
- PIN CONTACT WITH SQ POST:
CONTACT: 0.76µm [.000030] MIN GOLD FOR A DISTANCE OF 6.35 [.250] FROM MATING END, ALL OVER 1.27µm [.000050] MIN NICKEL.
POST: 2.54µm [.000100] MIN TIN-LEAD OVER 1.27µm [.000050] MIN NICKEL.
- PIN CONTACT WITH Ø1.57 [.062] POST: 5.08µm [.000200] MIN SILVER ALL OVER 1.27µm [.000050] MIN NICKEL.
- PIN CONTACT WITH SQ POST:
CONTACT: 0.76µm [.000030] MIN GOLD FOR A DISTANCE OF 6.35 [.250] FROM MATING END, ALL OVER 1.27µm [.000050] MIN NICKEL.
POST: 2.54µm [.000100] MIN TIN OVER 1.27µm [.000050] MIN NICKEL.
- OBsolete PARTS: OBsolete CIS STREAMLINING PER D.RENAUD/D.SINISI

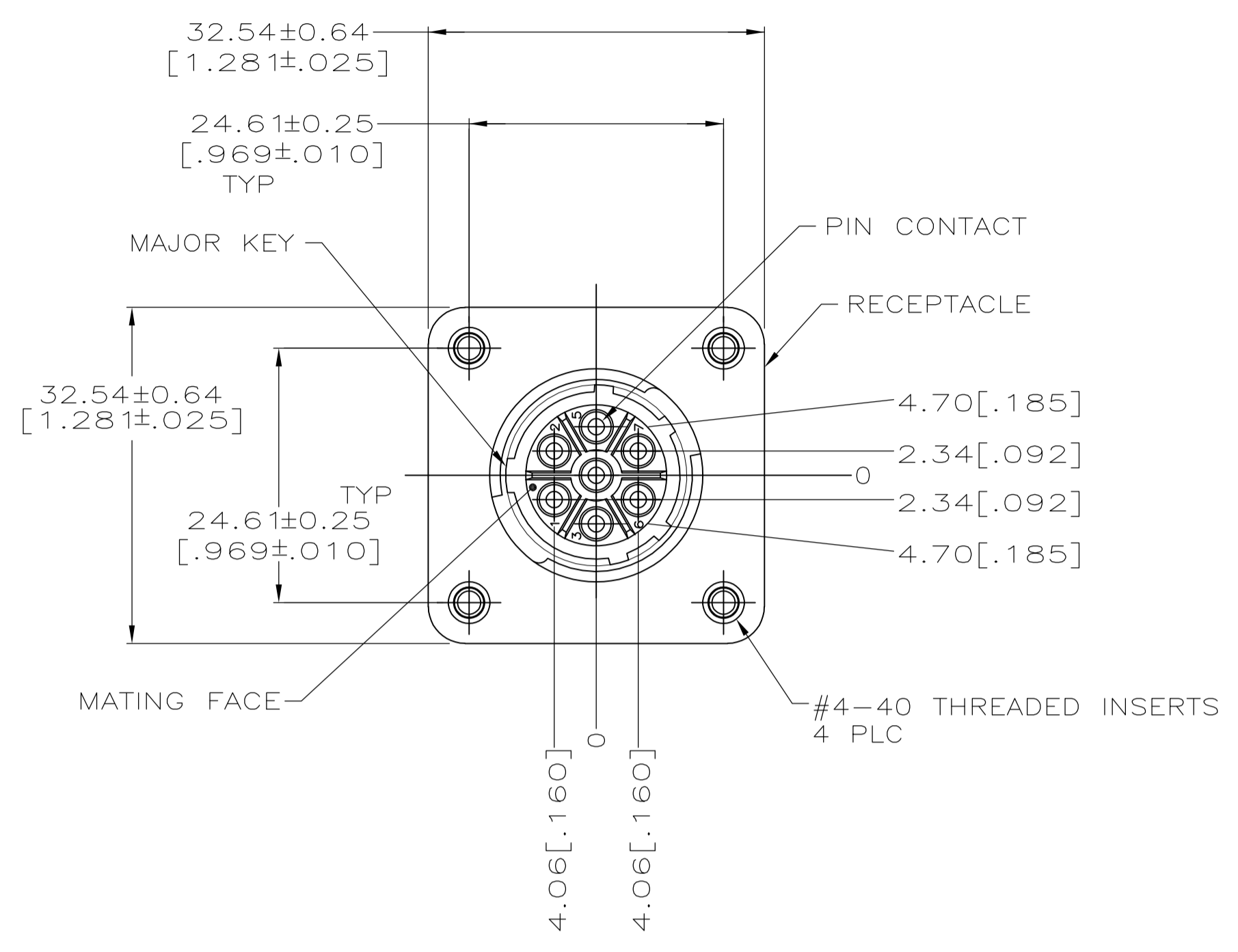
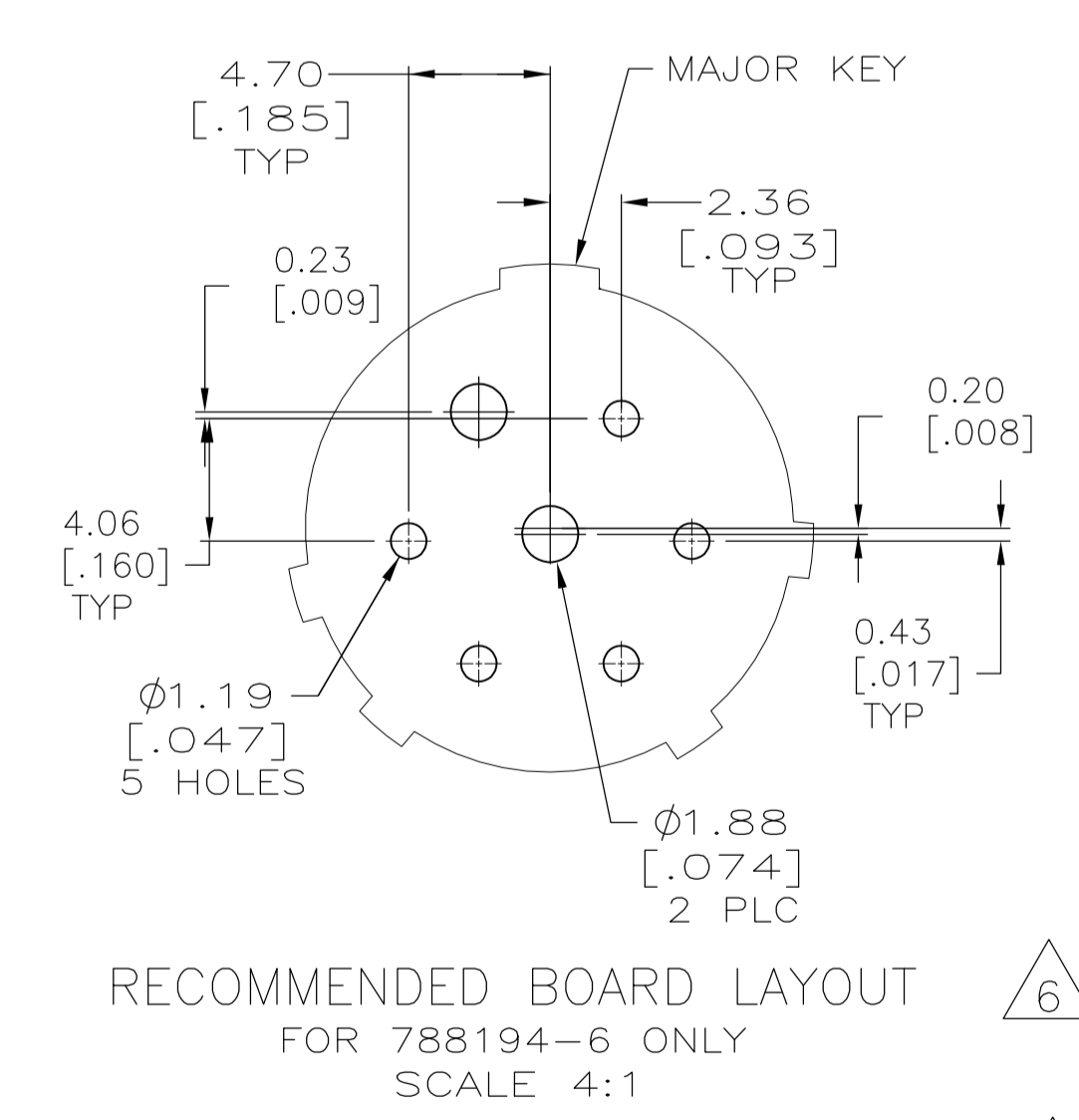
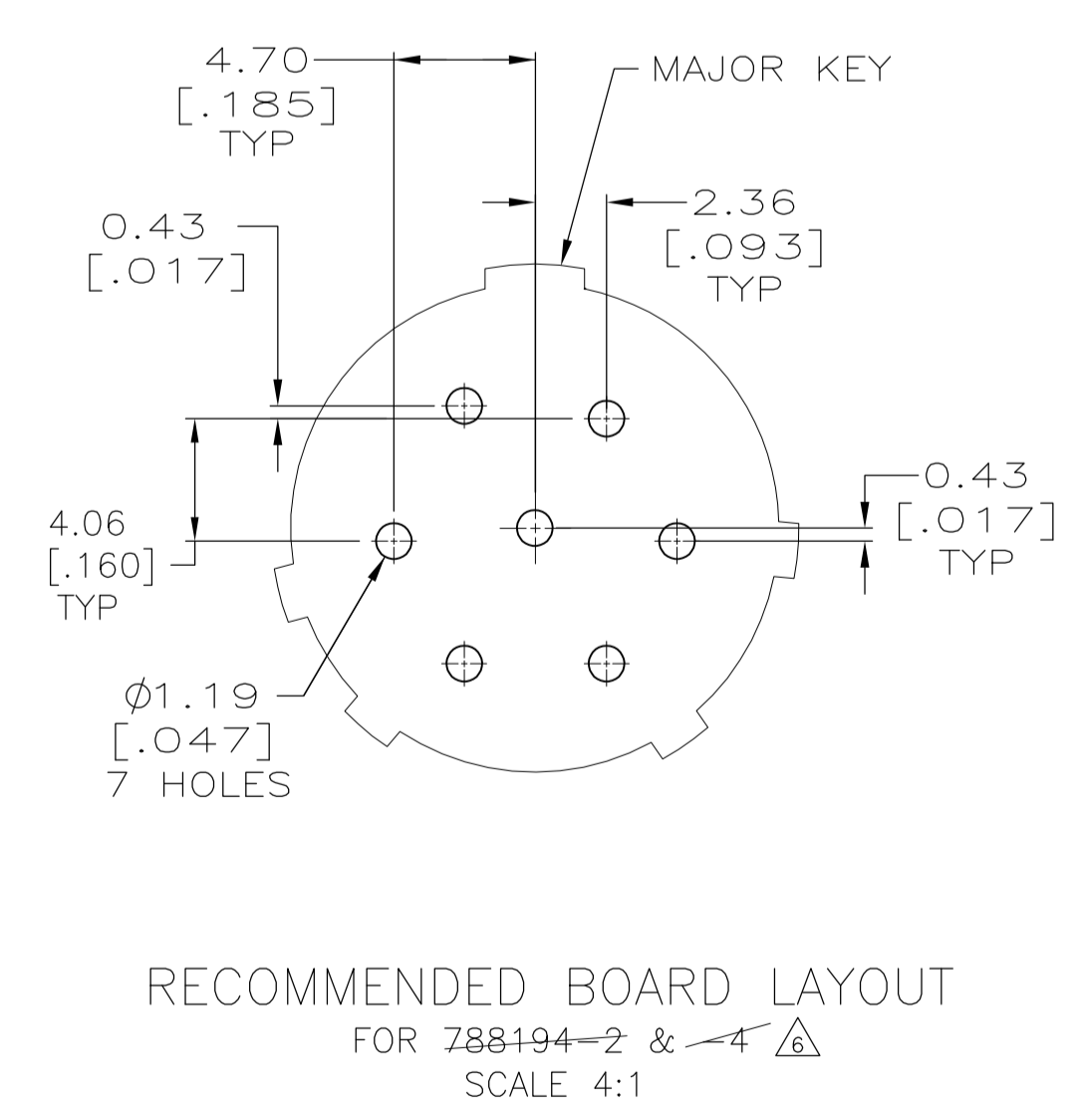
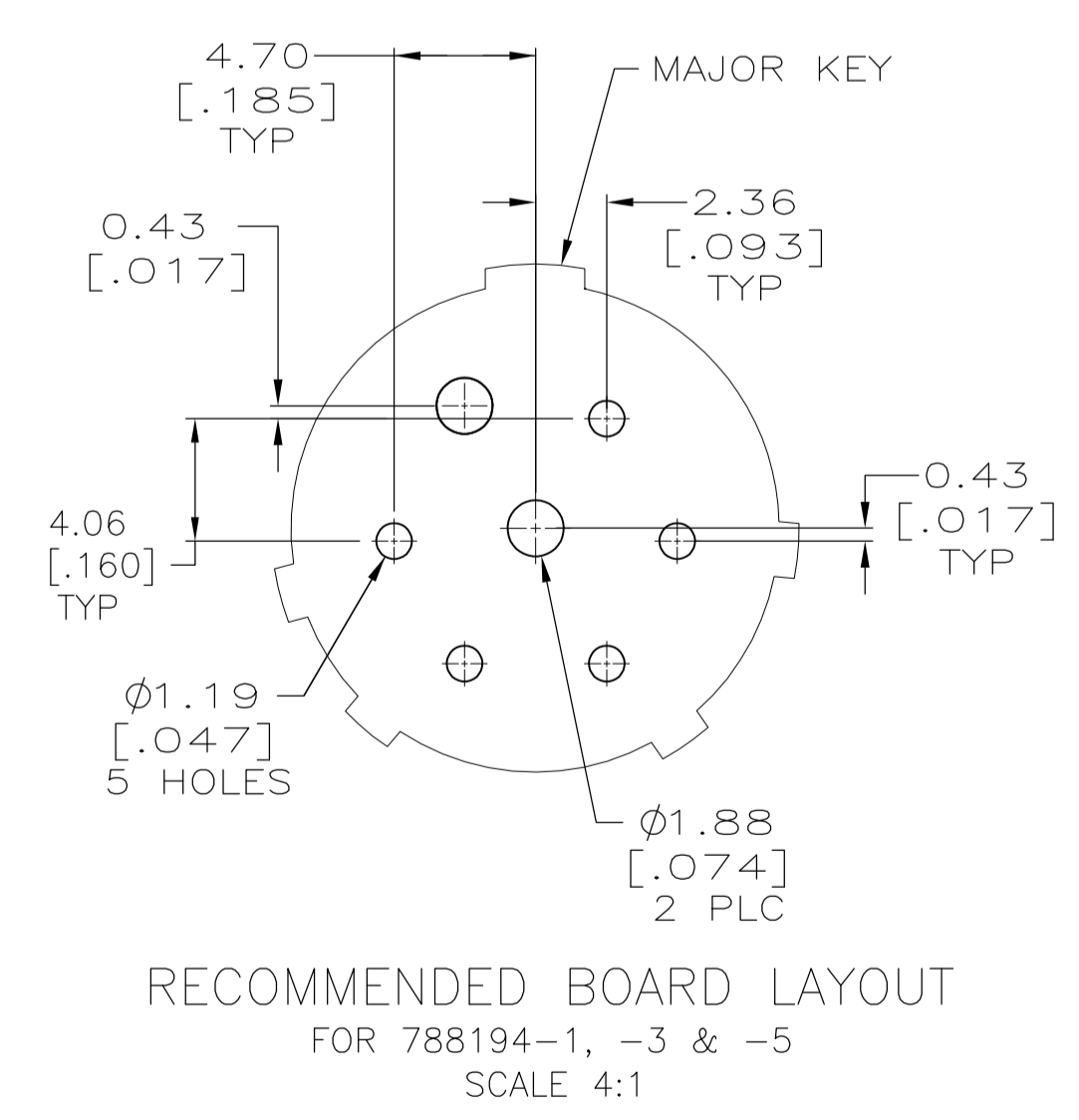
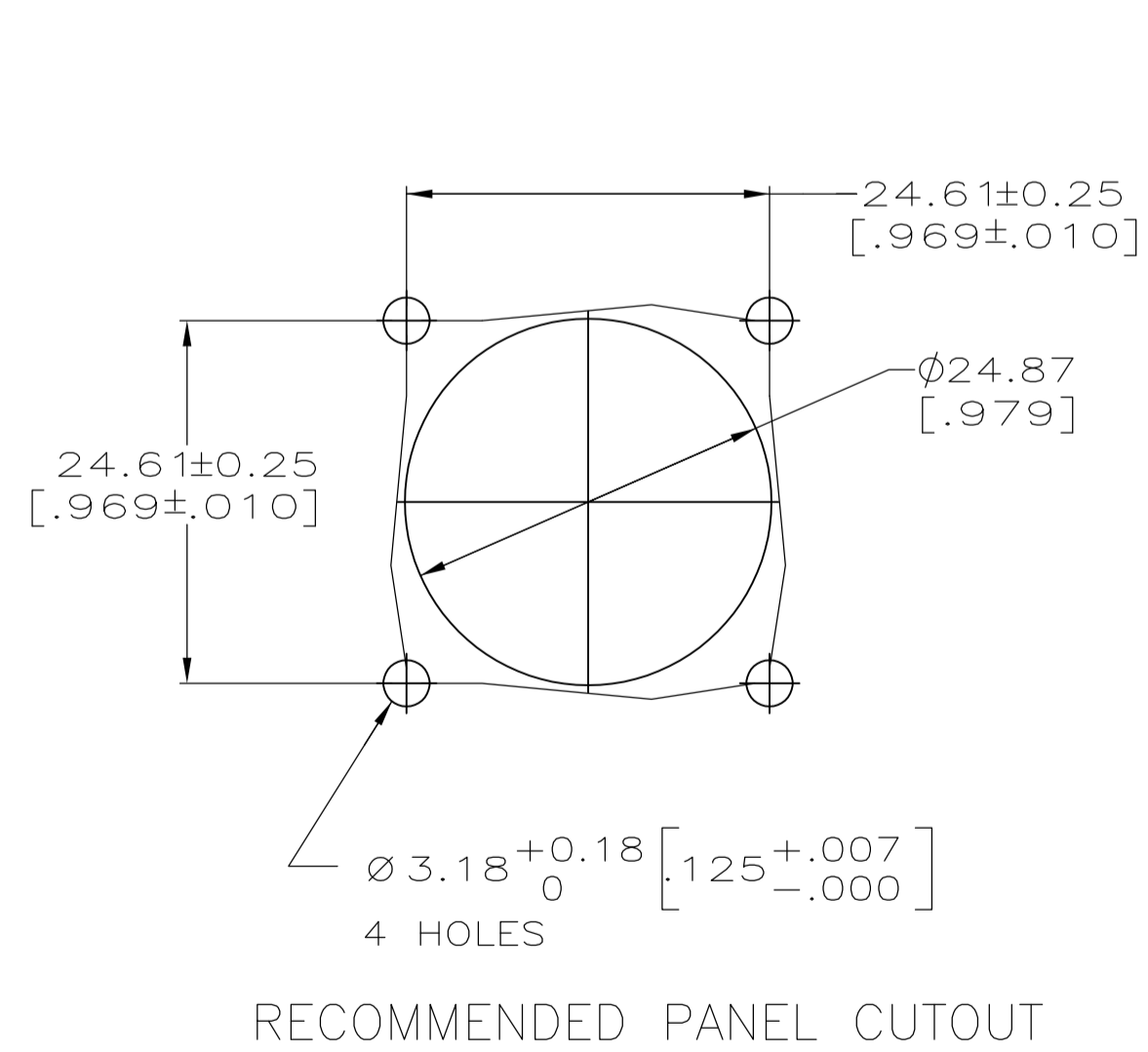
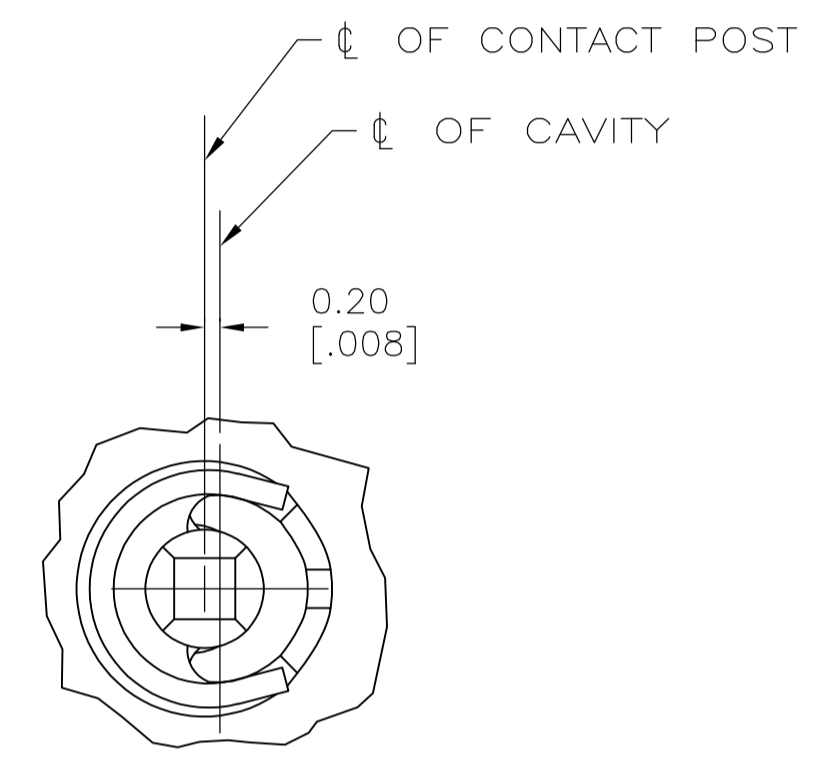
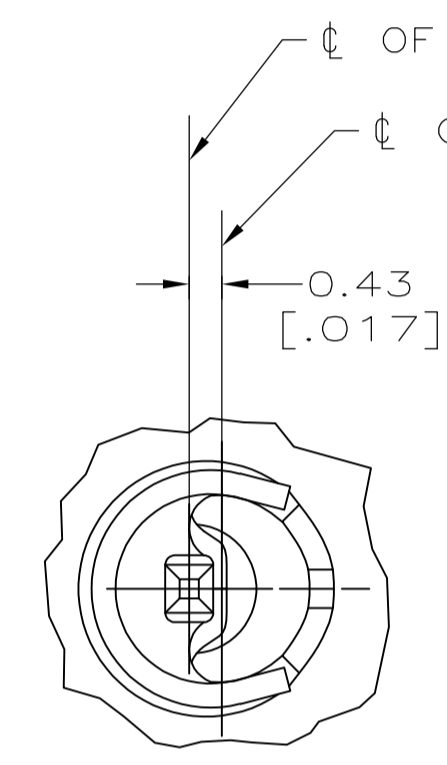

	.062 DIA.	2/5	788194-6
	.045 SQ	2/5	788194-5
6	OBsolete	2/5	788194-4
	.062 DIA.	2/4/5	788194-3
6	OBsolete	2/3	788194-2
	.062 DIA.	2/3/4	788194-1
	DIM A	PIN CONTACT	PART NUMBER

THIS DRAWING IS A CONTROLLED DOCUMENT.

DIMENSIONS: mm [INCHES]	TOLERANCES UNLESS OTHERWISE SPECIFIED:	DWN: K. WHITAKER 28-MAR-2000	CHK: M. CHACKO 28-MAR-2000	APVD: M. CHACKO 28-MAR-2000	NAME: RECEPTACLE ASSEMBLY, STANDARD SEX, 13-7, CPC
0 PLC ± -	1 PLC ± -	2 PLC ± 0.13 [.005]	3 PLC ± -	4 PLC ± -	ANGLES ± -
MATERIAL: -	FINISH: -	SIZE: A1	CAGE CODE: 00779	DRAWING NO: 788194	RESTRICTED TO: -
CUSTOMER DRAWING		SCALE: 2:1	SHEET: 1 of 1	REV: C1	

Tyco Electronics Corporation
Harrisburg, PA 17105-3608