

DIMENSIONS mm (inches)

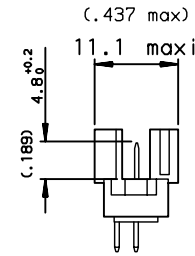

TERMINATION

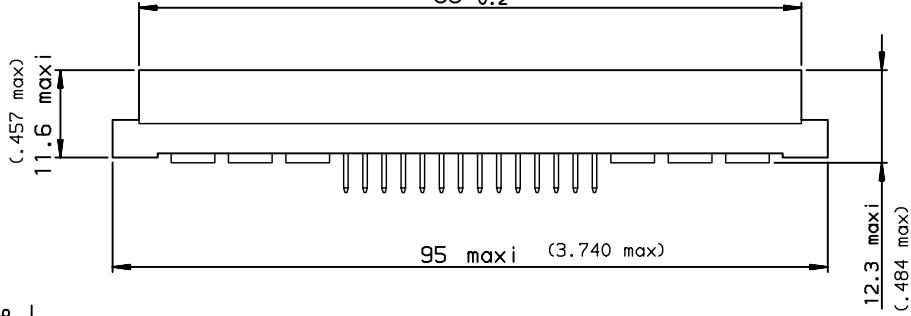
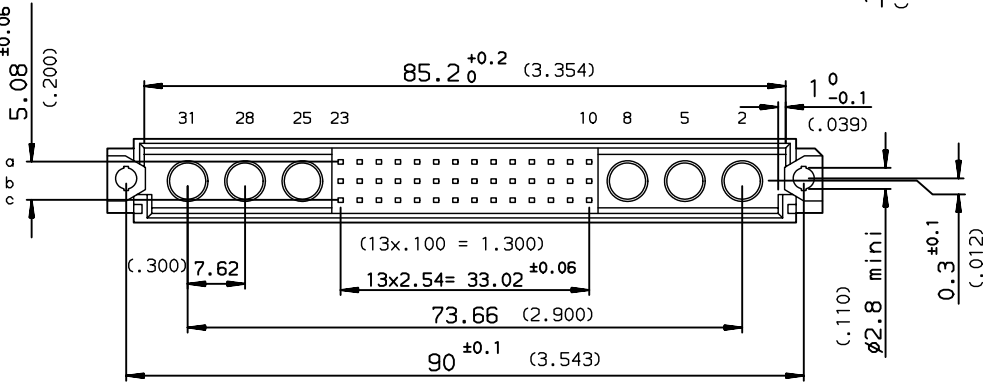
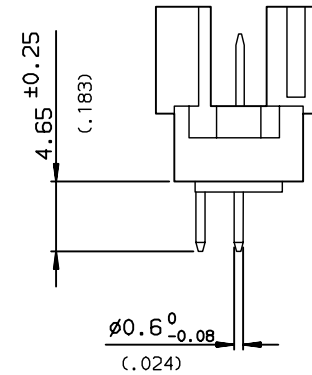

TIN LEAD
PART NUMBER
8609228E814765000E1

LEAD FREE
PART NUMBER
8609228E814765E1LF

PCB DRILLING component side

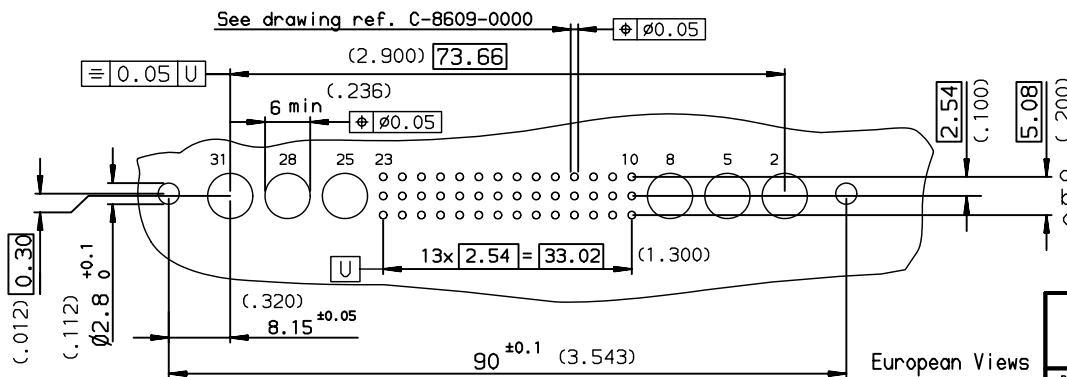

GENERAL CHARACTERISTICS and ROHS INFORMATIONS
SEE DRAWING C-8609-0000A

European Views

| rev | ecn no | dr | date |
|-----|-----------|-----|------------|
| A | - | ROU | 2001/07/25 |
| B | LS07-0130 | HLE | 2007/06/08 |
| C | LS07-0211 | HLE | 2007/08/16 |
| - | - | - | - |
| - | - | - | - |
| - | - | - | - |

| | | | | |
|---------------------------------------|-----------|-----------------------|-----------------------------------|------------------|
| www.fciconnect.com | | surface ISO 1302 ✓ | tolerance std ISO 406 ISO 1101 | projection mm |
| TOLERANCES UNLESS OTHERWISE SPECIFIED | | | | |
| ANGULAR | LINEAR | 0.X | ±0.1 | size A3 |
| | | 0.XX | ±0.1 | Scale 1.5 |
| | | 0.XXX | ±0.1 | ECN LS07-0211 |
| Dr | ROUILLARD | 2001/07/25 | Product family | DIN Spec ref - |
| Eng | ROUILLARD | 2001/07/25 | | |
| Chr | LEGARE | 2001/07/25 | | |
| Appr | LEGARE | 2001/07/25 | | |
| title STRAIGHT MALE WITH | | dwg no C-8609-1087 | | Rev. C |
| catalog no SEE TABLE | | CUSTOMER | | sheet 1 of 1 |

Copyright FCJ