

DIMENSIONS mm (inches)

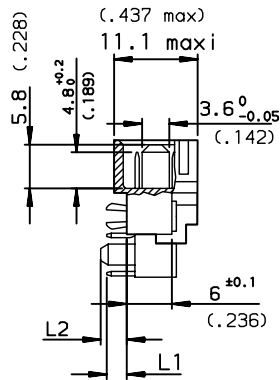

PCB DRILLING

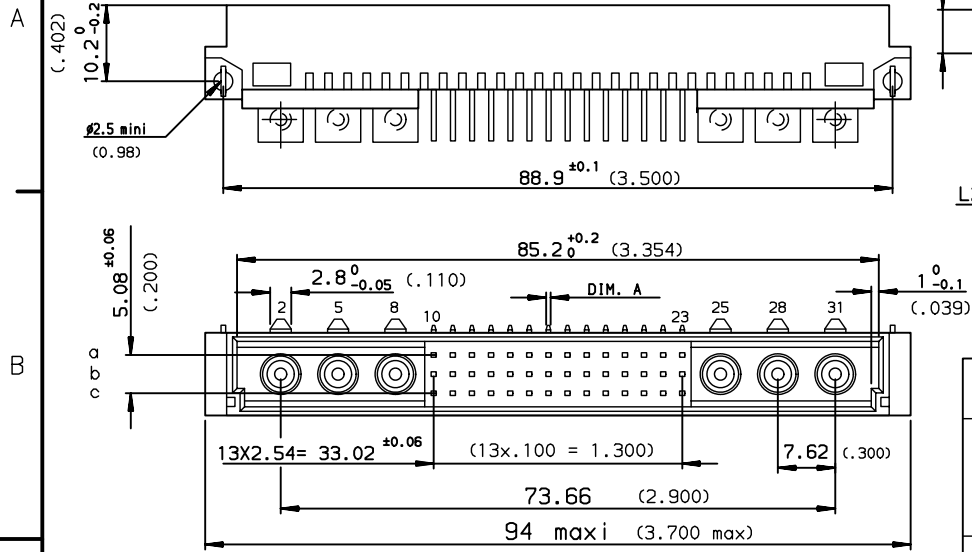
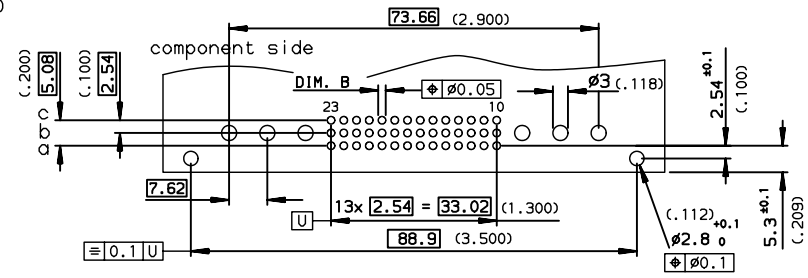

PART NUMBER	8609	EP	13	5
PIN OUT				
rows a-b-c	---	---	3	42
rows a-c	---	---	4	28
NUMBER OF CONTACTS				
TERMINATION				
L1 = 2.75 ±0.15 (.108)	A = Ø0.6 ±0.08	B = Ø0.8 ±0.3	13	
L2 = 3.40 ±0.2 (.134)				
OPTIONS				
no option	-----			7
with harpoons	----- for PCB thickness 1.6 mm			H
PERFORMANCE CLASS				
DIN 41612 class 3	-----			4
DIN 41612 class 2	-----			5
DIN 41612 class 1	-----			6
TERMINATION TYPE				
TIN LEAD	-----			000E1
LEAD FREE	-----			E1LF

GENERAL CHARACTERISTICS and ROHS INFORMATIONS  
SEE DRAWING C-8609-0000A

European Views

rev	ecn no	dr	date
A	-	ROU	1997/09/22
B	LS07-0130	HLE	2007/06/04
C	LS07-0211	HLE	2007/08/09
-	-	-	-
-	-	-	-
-	-	-	-

www.fciconnect.com		surface ISO 1302 ✓	tolerance std ISO 406 ISO 1101	projection mm
TOLERANCES UNLESS OTHERWISE SPECIFIED				
Dr	ROUILLARD	1997/09/22	ANGULAR	0.x ±0.1
Eng	ROUILLARD	1997/09/22	LINEAR	0.xx ±0.1
Chr	LEGARE	1997/09/22	0.xx' ±2'	0.xxx ±0.1
Appr	LEGARE	1997/09/22	Product family	size A3
			DIN	Scale 1.5
			Spec ref -	ECN LS07-0211
FCJ		title RIGHT ANGLE MALE STYLE M WITH POWER PINS FITTED		Rev. C
catalog no		SEE TABLE	dwg no C-8609-0612	sheet 1 of 1