

# DA1206D600R-10

## PHYSICAL DIMENSIONS:

A	3.20 [.126]	+ 0.20 [.008]
B	1.60 [.063]	+ 0.20 [.008]
C	0.80 [.031]	+ 0.20 [.008]
D	0.40 [.016]	+ 0.15 [.006]
D1	0.20 [.008]	+ 0.10 [.004]
E	0.80 [.031]	+ 0.10 [.004]

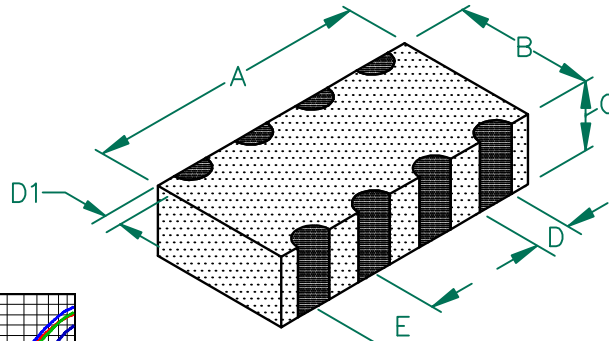

## ELECTRICAL CHARACTERISTICS:

	Z @ 100MHz ( $\Omega$ )	DCR ( $\Omega$ )	Rated Current
Nominal	60		
Minimum	45		
Maximum	75	0.2	400 mA

LINE TO LINE INSULATION RESISTANCE  
>100 M $\Omega$  AT 75 VOLTS.

NOTES: UNLESS OTHERWISE SPECIFIED

1. TAPED AND REELED per CURRENT EIA SPECIFICATIONS 7" REELS, 3000 PCS/REEL.
2. TERMINATION FINISH IS 100% TIN.
3. COMPONENTS SHOULD BE ADEQUATELY PREHEATED BEFORE SOLDERING.

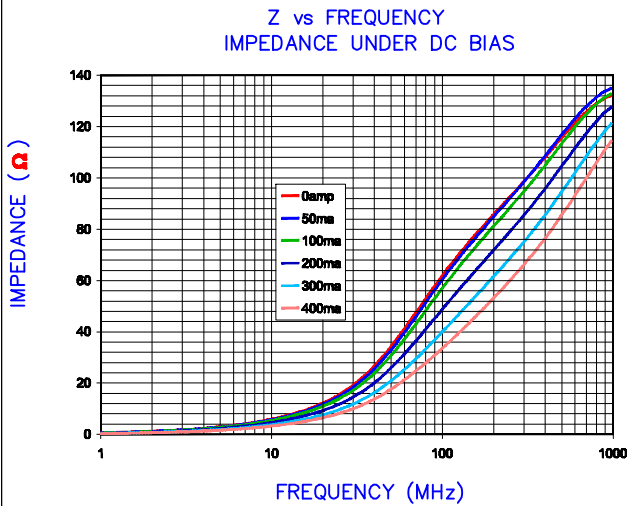

RoHS  
Comp  
**OBSELETE**

## LAND PATTERNS FOR REFLOW SOLDERING

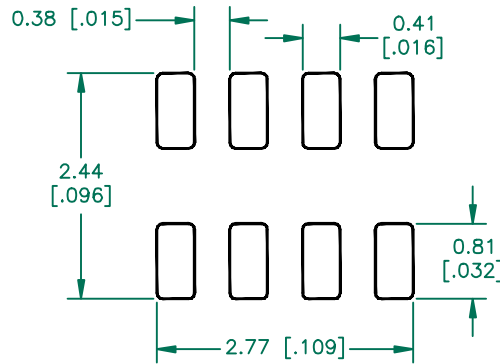

(For wave soldering, add 0.762 (0.030) to this dimension)

## RECOMMENDED SOLDERING CONDITIONS

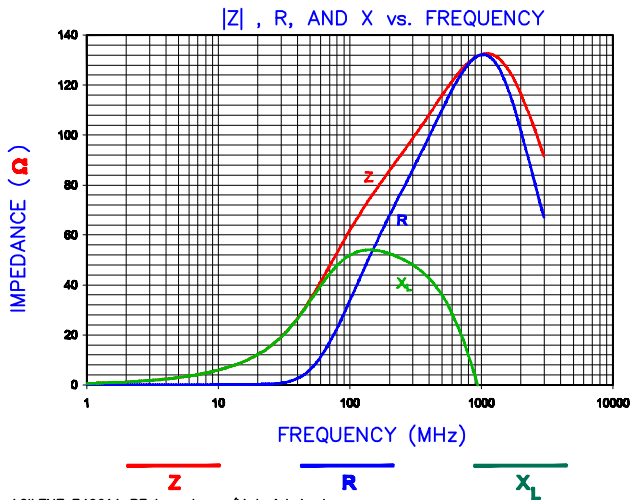
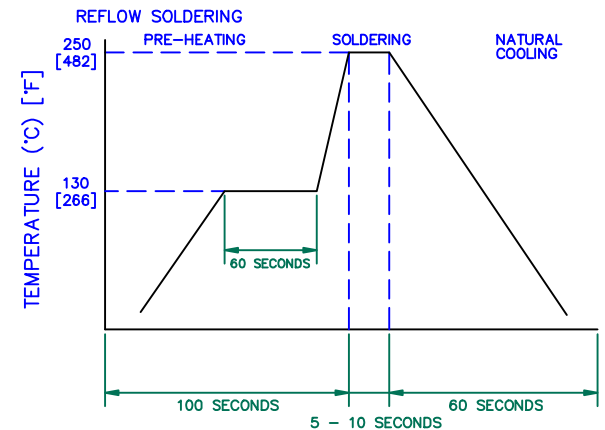

DIMENSIONS ARE IN mm [INCHES].

THIS DOCUMENT CONTAINS INFORMATION WHICH IS PROPRIETARY AND CONFIDENTIAL TO STEWARD. NO PRODUCTION OR PUBLICATION OF THIS DOCUMENT IN WHOLE OR IN PART SHALL BE MADE WITHOUT WRITTEN AUTHORIZATION FROM STEWARD.

**Steward**

PROJECT/PART NUMBER: DA1206D600R-10	REV B	PART TYPE: CO-FIRE	DRAWN BY: TMB
DATE: 04/02/04	SCALE: NTS	SHEET: 2 of 2	
REV A	DESCRIPTION ORIGINAL DRAFT	DATE 04/02/04	INT TMB
REV B	DESCRIPTION ADD ROHS COMPLIANT SYMBOL	DATE 08/20/04	INT TMB