

DESCRIPTION: 0.085 RIBBON - DIP SOLDER

	014	024	036	050
A	1.728	2.154	2.667	3.264
	43.90	54.70	67.75	82.90
B	0.992	1.417	1.925	2.624
	25.20	36.00	48.90	64.10
C	1.417	1.843	2.352	2.947
	36.00	46.80	59.74	74.85

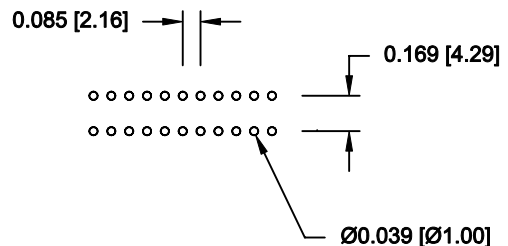
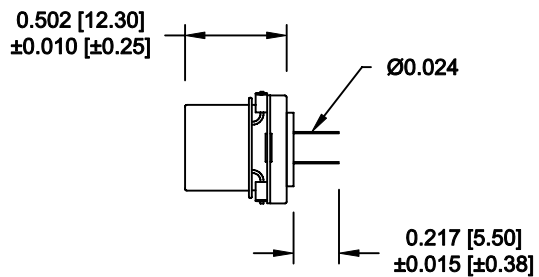
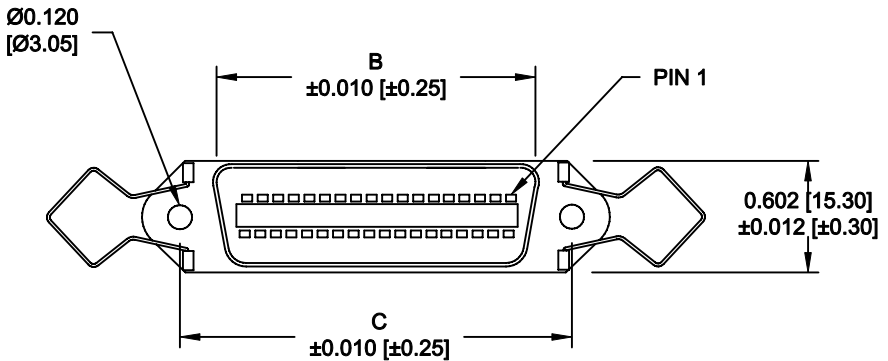
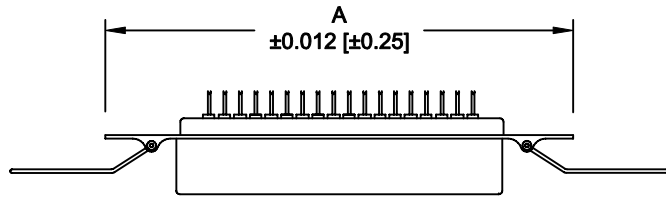

**MATERIAL:**

INSULATION: GLASS- FILLED THERMOPLASTIC  
 UL RATED 94V-0, 230°C PROCESS TEMP.  
 CONTACTS: COPPER ALLOY  
 SHELL: STEEL, NICKEL PLATED

**ELECTRICAL:**

CURRENT RATING: 5 AMPS  
 VOLTAGE RATING: 1,200V AC r.m.s.  
 INSULATION RESISTANCE: 1,000MegOhms Min. @ 500VDC  
 CONTACT RESISTANCE: 30MilliOhms Max.  
 OPERATING TEMPERATURE: -55°C TO +125°C

111-YYY-2 1 3 L 00 1

SERIES \_\_\_\_\_  
 POSITIONS \_\_\_\_\_  
 014 \_\_\_\_\_  
 024 \_\_\_\_\_  
 036 \_\_\_\_\_  
 050 \_\_\_\_\_  
 GENDER \_\_\_\_\_  
 2 = FEMALE  
 TERMINATION \_\_\_\_\_  
 1 = DIP SOLDER  
 RoHS COMPLIANT \_\_\_\_\_  
 L = LOW TEMP. PROCESS  
 SHELL PLATING \_\_\_\_\_  
 3 = NICKEL  
 HARDWARE \_\_\_\_\_  
 00 = NO HARDWARE  
 PLATING \_\_\_\_\_  
 1 = GOLD FLASH

DO NOT SCALE FROM DRAWING

	THESE DRAWINGS AND SPECIFICATIONS ARE THE PROPERTY OF NorComp AND SHALL NOT BE REPRODUCED, COPIED OR USED AS THE BASIS FOR THE MANUFACTURE OF SALE OF APPARATUS WITHOUT WRITTEN PERMISSION.		DRAWN: <b>WAYNE ROBBINS</b>	DATE: <b>09-15-05</b>
			CHECKED:	DATE:
<b>NorComp</b>	SCALE: <b>NONE</b>	SHEET <b>1</b> OF <b>1</b>	REV <b>4</b>	
	DWG NO. <b>111-YYY-213L001</b>			

RoHS COMPLIANT