

Product Facts

- High density packaging features
- Minimum mass
- MIL spec or COTS options
- Durable performance, rugged
- Outstanding electrical performance; low contact resistance
- Withstands shock and vibration
- Expanded temperature range
- Reliable mass crimp terminations
- Crimp any material, shape, finish
- Extensive design options
- Other options:
 - EMI/RFI filter
 - SMT or thru-hole
 - Harness assemblies
 - Mounting brackets
 - Custom modifications
 - Backshells
 - Lo-profile
 - Headers
 - Flex circuit attached
 - Mixed signal technology

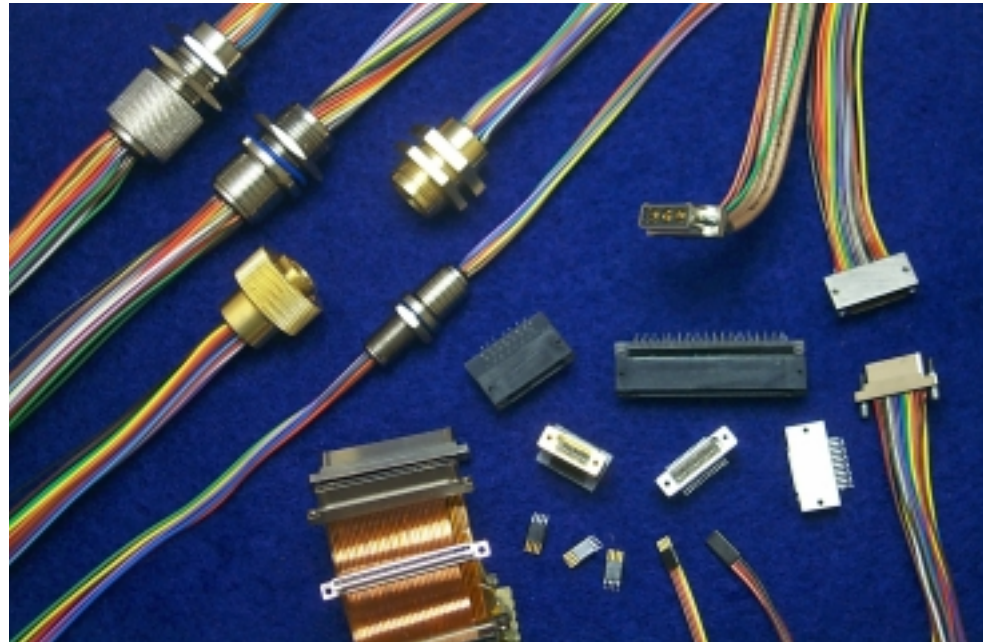

NANONICS connectors and associated cable systems are designed for size and weight reduction while maintaining highest levels of reliability and ruggedness. The contact system is used throughout the product family to enhance long-term performance and quality of the system in difficult applications. Connector manufacturing utilizes only materials that are selected to pass Space and Military Specifications. Fabrication of the connectors includes machine controlled crimping of the leads or wires directly to the pin or socket contacts prior to final connector assembly. These high-end Nanominiature connectors are designed into numerous configurations that range from wired nano-strips to complex flex circuit interconnect systems and cover the circuit spectrum from dc. to rf. applications. Customized versions of each design type can be requested. Application Engineering and custom harness designs are available to help resolve fitting previously large interconnection systems into smaller and smaller spaces.

General Specifications

Military — meets *DSCC specs. 94031 through 94046

Goldbore Contacts

Material — Beryllium copper

Plating — Nickel over gold

Contact Current — 4 Amps continuous

Resistance — .003-.008 ohms

Engage Force — 1.0 oz. average/contact

Wire size/Current — 30 AWG & smaller/1 Amp

Contact Pitch — .025 [.635], .0125 [.317] for 2 row

Insulators — Polyphenylene sulfide or liquid crystal polymer

Metal Shells — 6061 Aluminum with electroless nickel plate; 303 stainless steel; other metals & plating available

Dielectric WV — Sea level 70,000ft.
 Plastic 500VDC 250VDC
 Metal 400VDC 200VDC

IR — 1000 Megohms

Vibration & Shock — *DSCC 94031 - 94046 & MIL-C-83513

Environment — *DSCC 94031 - 94046 & MIL-C-83513 (Tested over 4000 engagements)

Polarization — DUALLOBE, pins, keys

Temperature Range — -200°C to +225°C

Layouts — 2-65 positions

Coupling — Jackscrews; friction

Outgassing — Meets Sp-R-0022

*DSCC-Defense Supply Center, Columbus. Formerly, DESC, Dayton, Ohio

Need more information?

Call Technical Support at the numbers listed below.

Technical Support is staffed with specialists well versed in all Tyco Electronics products. They can provide you with:

- Technical support
- Catalogs
- Technical Documents
- Product Samples
- Tyco Electronics Authorized Distributor Locations

©2001 by Tyco Electronics Corporation. All rights reserved.

AMP FAX, DUALLOBE, NANONICS, and TYCO are trademarks.

Other trademarks used are the property of their respective owners.

Dimensions are in inches and millimeters unless otherwise specified. Values in brackets are metric equivalents.

Dimensions are shown for reference purposes only. Specifications subject to change.

Technical Support
 USA: 1-800-522-6752
 Canada: 1-905-475-6222
 Mexico: 01-800-733-8926

www.tycoelectronics.com

Introduction



Strip

- Smallest of connectors
- Friction coupling
- Guide pin polarization
- SMT, or thru-hole
- Wire, flex and ribbon options

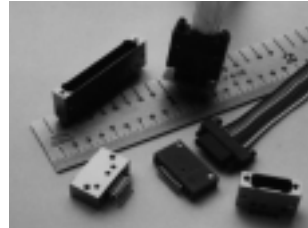

DUALLOBE Connector

- Polarized scoop-proof mating
- Blindmating with ease
- Coupling with jackscrews
- Panel mount, SMT, thru-hole
- MIL Specs or COTS



Hermetic "H" Series

- Hermetic per MIL-STD-202
- MIL-STD-883; 1X10-8 CC/sec leak rate
- 5-60 positions, larger sizes as assemblies
- Mate with NANONICS standard DUALLOBE receptacles



Nano-Axial Connectors

- More than 1/3 smaller than Micro-Ds
- Custom mixed signal systems
- Uses 32 AWG coax
- Maintains low cross talk
- Improved analog signal control



Environmentally Sealed Circulars

- Quick Disconnect or Thread Coupling Plugs
- Panel Mount and Flush Mount Receptacles
- Sizes include: 7, 19 and 44 position
- Nano-Sized Shells and .025 [0.635] pitch connections

The Contact System

The contact system features burnished gold bores and surfaces throughout the tubular pins and sockets. The one-piece seamless contacts are fabricated using techniques that result in superior, gold finish contacts.

Tyco Electronics provides a typical gold thickness of 30 micro-inches (.000030 [0.00076]). In addition, seamless contact bores further contribute to crimps of outstanding quality and durability (i.e., gas tight and intrusion proof). Innovative receptacle design effectively doubles the electrical "creep" distance between sockets permitting higher voltage limits. The contact system also minimizes bias to resonate, thus, vibration and shock induced "opens" are

virtually eliminated.

Excellent physical and electrical mating characteristics are obtained via a low engaging force that maintains an effective contact wiping action during mating. Problems associated with special mating tools or jigs and zero force engaging techniques (i.e., ZIF) are eliminated.

Socket Contact

The socket is the active element. It incorporates the necessary spring action to promote low contact resistance and long life endurance. The socket is a seamless one piece tubular part without slots or other traditional means to provide the spring action. Precision manufacturing techniques produce a highly reliable and simple contact. A unique burnished Goldbore finish is common to the crimp barrels of both contacts and the socket engaging bore. The gold finish provides contact integrity for superior reliability and environmental performance.

Pin Contact

The pin contact is fabricated employing ultra precision methods producing a blind-bore

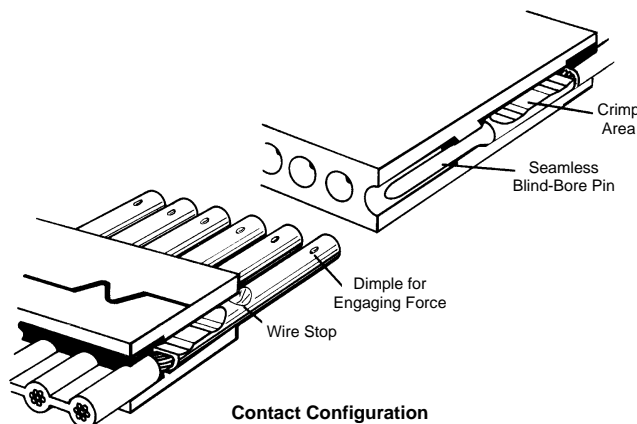

Contact Configuration

NANONICS Nanominiature Strip Connectors

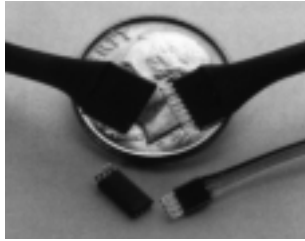

NANONICS Strip Connectors provide dramatic reduction in size and weight, and enable reduction in board space requirements while retaining DUALLOBE Connector series performance.

Strips are useful in applications such as hearing aids, hand-held communication devices, flex terminations, and high density electronics where packaging space is at a premium.

Strips are available for PCB surface mount and thru-hole applications and may be terminated with ribbon cable, flex circuits and a variety of insulated wire, 30 AWG thru 42 AWG and smaller.

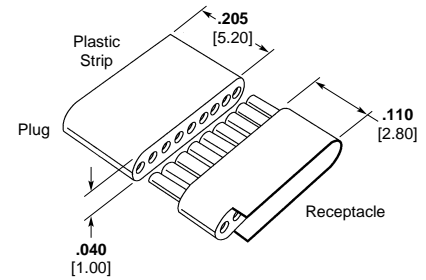
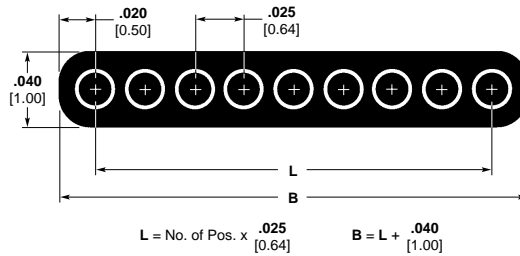

Polarization

Polarization of the strips is accomplished with the use of polarizing guide posts.

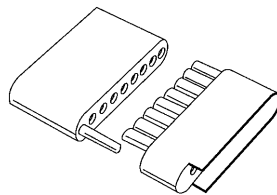

“T” Shown

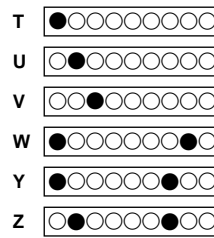

Polarizing Guide Post (PGP) Positions

Stocked Sizes

No. of Positions	Dimensions	
	L	B
4	.115 2.92	.155 3.92
9	.240 6.10	.280 7.10
15	.390 9.91	.430 10.91

Other sizes available. Contact Tyco Electronics for more information.

9-Position, Single Row, Strip Connector and Plug

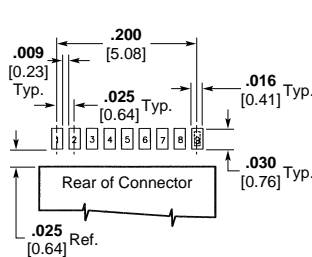
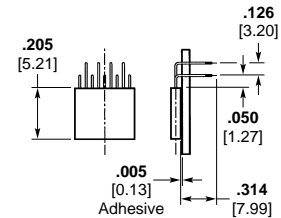
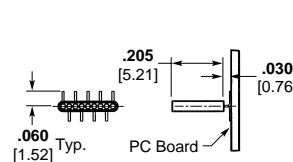
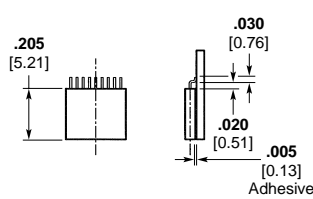

Recommended PC Board Layout

Surface Mount Option

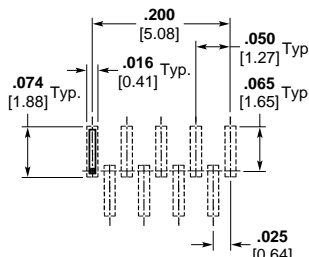

Recommended PC Board Layout

Vertical Surface Mount Option

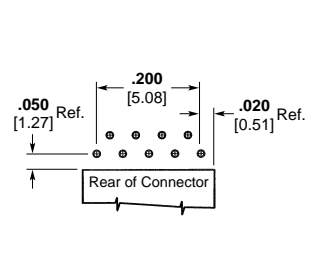

Recommended PC Board Layout

Thru Hole Option

For Design Specification and additional ordering information, contact Tyco Electronics.

NANONICS DUALLOBE Single Row Connectors

Options

- Plastic or Metal
- Standard Sizes: 5, 9, 15, 25, 37, and 51
- Factory wired to your specifications, or PC board termination shown in examples
- Contact Tyco Electronics for design specifications

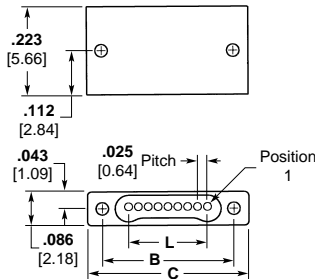
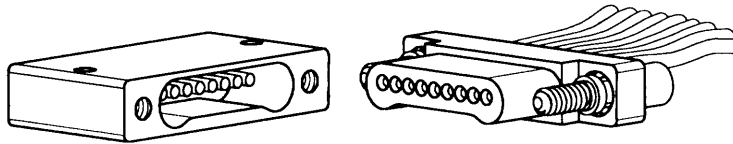

Receptacle

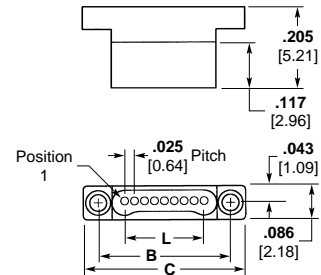

Plug

Size	Dimensions		
	L ±.005 [±0.13]	B ±.005 [±0.13]	C ±.005 [±0.13]
5	.100 2.51	.233 5.87	.308 7.76
9	.200 5.08	.333 8.46	.405 10.29
15	.350 8.89	.483 12.27	.555 14.10
25	.600 15.24	.733 18.62	.805 20.45
37	.900 22.86	1.033 26.24	1.105 28.07
51	1.250 31.75	1.383 35.13	1.455 36.96

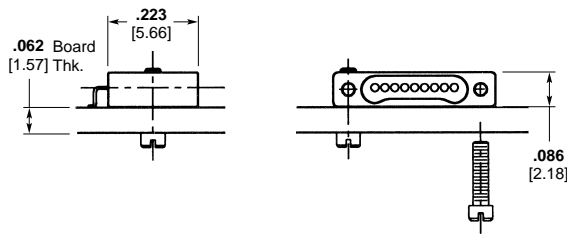

Horizontal Surface Mount

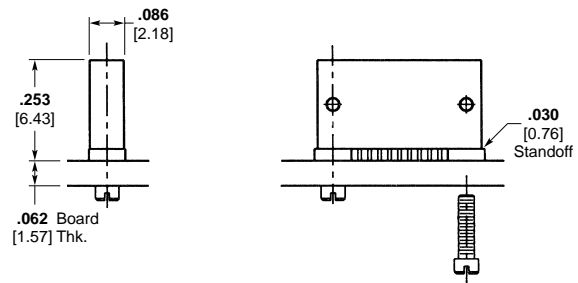

Vertical Surface Mount

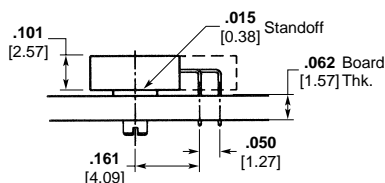

Horizontal Thru Hole

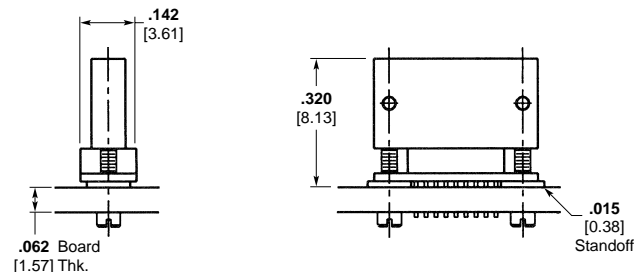

Vertical Thru Hole

For Design Specification and additional ordering information, contact Tyco Electronics.

NANONICS DUALLOBE Two Row Connectors

Options

- Plastic or Metal
- Standard Sizes: 9, 15, 25, 37, 51 and 65
- Factory wired to your specifications, or PC board termination shown in examples
- Contact Tyco Electronics for design specifications

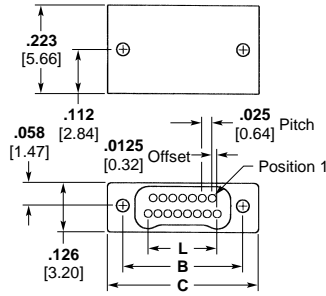
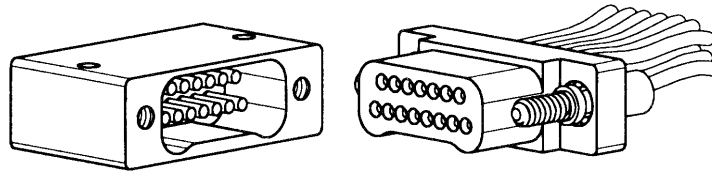

Receptacle

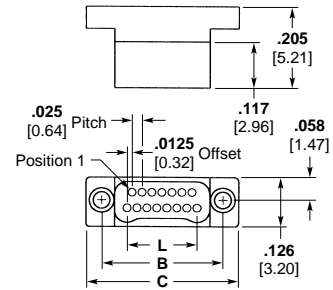

Plug

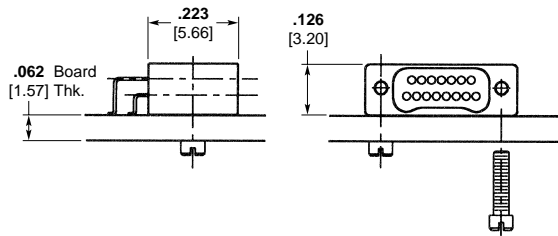

Horizontal Surface Mount

Size	Dimensions		
	L ±.005 [±0.13]	B ±.005 [±0.13]	C ±.005 [±0.13]
9	.100 2.54	.229 5.82	.305 7.75
15	.175 4.45	.304 7.72	.385 9.78
25	.300 7.62	.429 10.90	.510 12.95
37	.450 11.43	.579 14.71	.660 16.76
51	.625 15.88	.754 19.15	.835 21.21
65	.800 20.32	.929 23.60	1.010 25.65

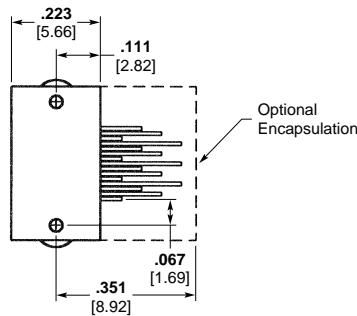

Vertical Surface Mount

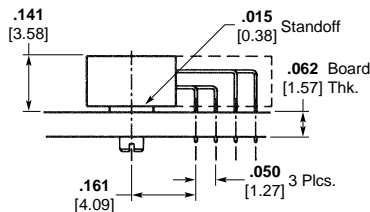
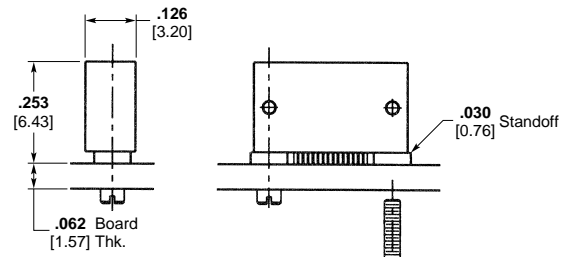

Horizontal Thru Hole

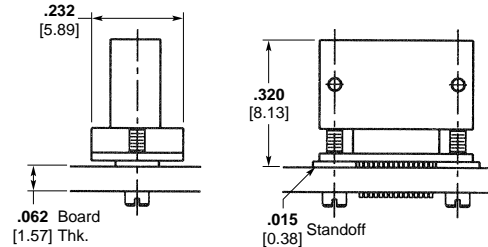

Vertical Thru Hole

For Design Specification and additional ordering information, contact Tyco Electronics.

NANONICS N-Series Circular Connectors

Circular Nanominiature Connectors .025 [.635] Pitch

NANONICS N-Series circulars are one of the industry's smallest, reliable, circular nanominiature connectors.

Design and manufacturing focus is aimed directly at:

- High Density
- Reduced Weight
- Reduced Diameter
- High Reliability

This family of in-line circulars is available in pin counts of 7, 19 and 44 positions. Outside diameters range from .300 [7.62] OD. to .530 [13.46] OD.

The connector contact system features burnished gold bores and surfaces through the tubular pins and sockets.

One-piece seamless contacts are used to increase contact area and current carrying capability while reducing effects from vibration, shock and thermal excursions.

NANONICS circular connectors are offered with a wide variety of wire and cable terminations. Leads can be left pigtailed for convenient attachment into pc boards, systems and sensors. Connectors of any type available can be included in the harness design and manufacturing process at Tyco Electronics. Additional

Specifications

- Metal Shell** — Aluminum 6061
- Plating** — Nickel/Gold
- Insulator** — Liquid crystal polymer
- Contacts** — Beryllium copper, Nickel over gold plated
- Resistance** — .003-.008 Ohm
- Threaded Coupling Nut Action**
- Temperature Rated** — 250° C

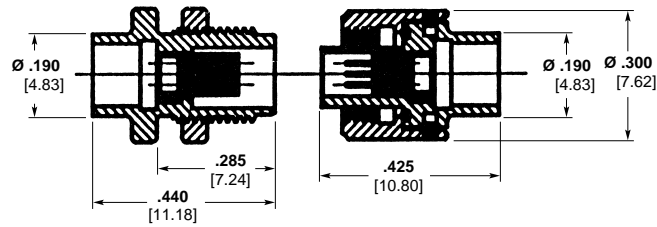

NCG007 — 7 Position Circular

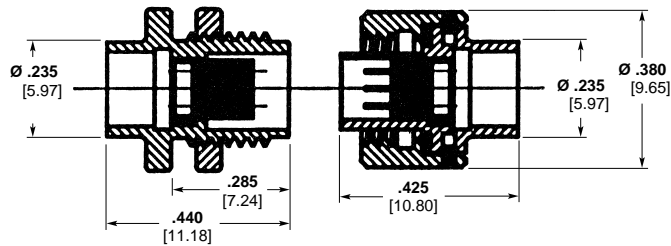

NCG019 — 19 Position Circular

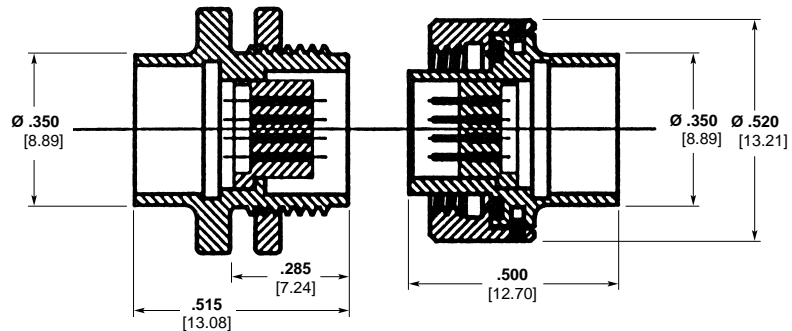

NCG044 — 44 Position Circular

For Design Specification and additional ordering information, contact Tyco Electronics.

NANONICS Environmentally Sealed Quick Disconnect Circular Connectors

Nanominiature
.025 [0.64] Contact Pitch

19 Position Quick Disconnect
Flush Mount Receptacle
and Plug

- Environmental seal
- EMI/RFI seal
- Contact system exceeds MIL-C-83513
- Also available in 7 and 44 positions
- "O" rings for environmental seal

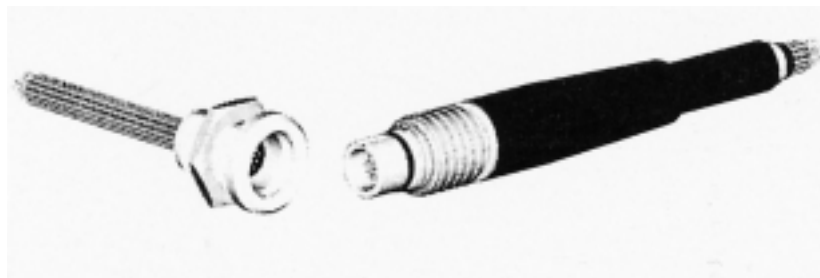

(Shown with Optional Strain Relief)

No. of Positions	Receptacle A Dim.	Plug B Dim.
7	.312 7.92	.250 6.35
19	.375 9.53	.300 7.62
44	.500 12.70	.395 10.03

Specifications

Connector Body — 6061-T6 Aluminum

Plating — Nickel per MIL-C-26074

Insulator — Liquid crystal polymer

Contact Current — 4 amps continuous

Contact Resistance — .003-.008 Ohm

Contact Mating Force — 1.0 oz. avg./contact

Wire Size — 30 AWG stranded or smaller

Wire Current — 1 amp max. (30 AWG)

Coupling — Push-pull quick disconnect

Mated Length —
.705 [17.91] (without strain relief)
1.71 [43.43] (with strain relief sizes 7, 19)
2.21 [56.13] (with strain relief size 44)

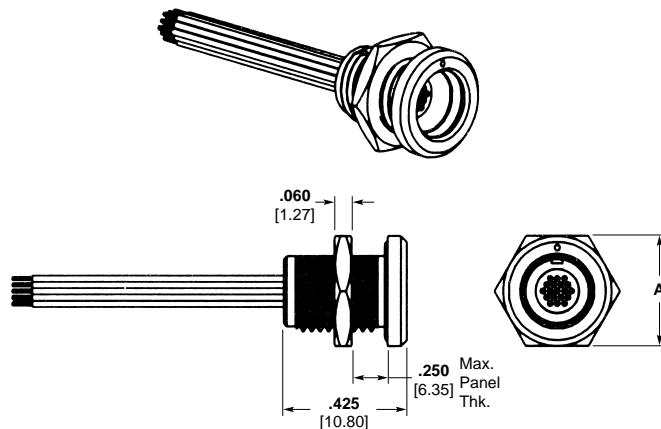

19 Position Flush Mount Receptacle (Shown)

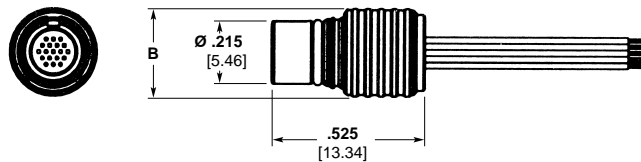
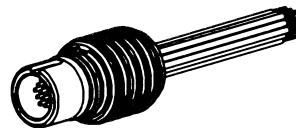

19 Position Plug (Without Strain Relief) (Shown)

For Design Specification and additional ordering information, contact Tyco Electronics.

NANONICS Environmentally Sealed Threaded Coupling Circular Connectors

Nanominiature
.025 [0.64] Contact Pitch

19 Position Threaded
Coupling Panel Mount
Receptacle and Plug

- Environmental seal
- EMI/RFI seal
- Contact system exceeds MIL-C-83513
- Also available in 7 and 44 positions
- The panel mount receptacle will also mate with the quick disconnect plug

Specifications

Connector Body — 6061-T6 Aluminum

Plating — Nickel per MIL-C-26074

Insulator — Liquid crystal polymer

Contact Current — 4 amps continuous

Contact Resistance — .003-.008 Ohm

Contact Mating Force — 1.0 oz. avg./contact

Wire Size — 30 AWG stranded or smaller

Wire Current — 1 amp max. (30 AWG)

Coupling — Threaded coupling nut

Mated Length —
.830 [21.08] (without strain relief)
1.83 [46.48] (with strain relief sizes 7, 19)
2.33 [59.18] (with strain relief size 44)

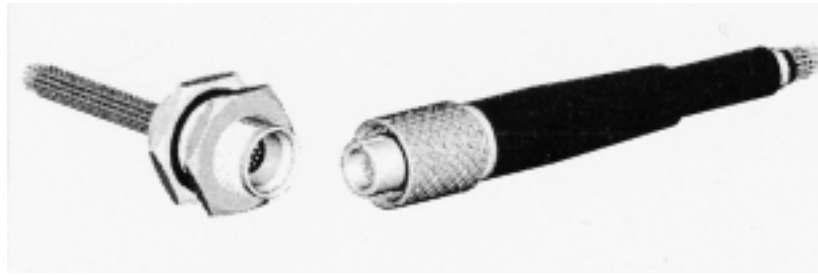

(Shown with Optional Strain Relief)

No. of Positions	Receptacle Flange A Dim.	Plug B Dim.
7	.406 10.31	.315 8.00
19	.469 11.91	.355 9.02
44	.563 14.30	.475 12.07

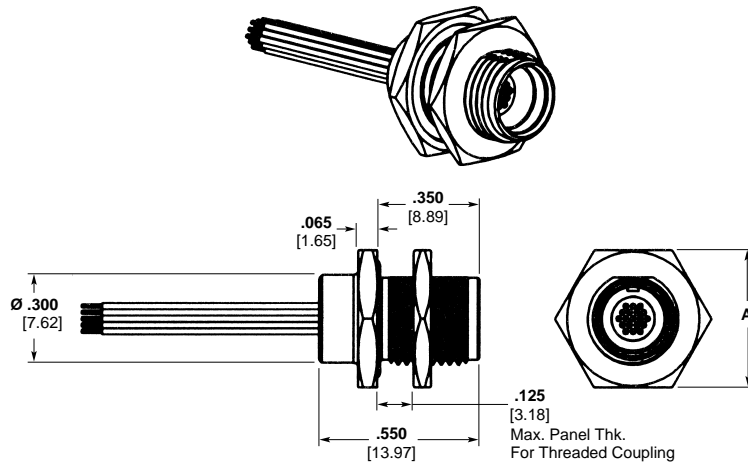

19 Position Panel Mount Receptacle (Shown)

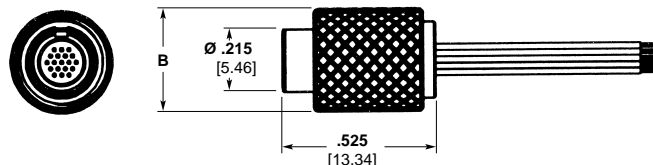
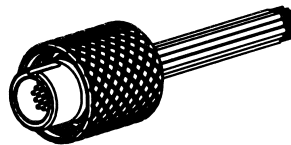

19 Position Plug (Without Strain Relief) (Shown)

For Design Specification and additional ordering information, contact Tyco Electronics.

NANONICS Environmental Connectors

.025 [0.64] Contact Pitch

- Environmentally sealed
- 3000 PSI performance
- RFI/EMI protected
- Vibration and Shock DSCC 94031-94046 MIL-C-83513
- Terminate with wire, flex circuit, and ribbon cable
- Interface with NANONICS standard DUALOBE connectors

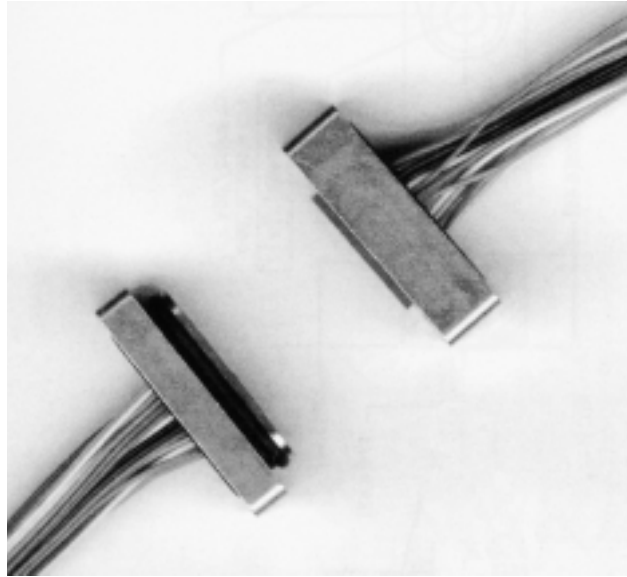

NANONICS nanominiature environmental connectors provide reliability and high density packaging solutions in harsh environmental conditions.

These connectors offer a variety of terminations including one or two rows, plastic or metal shrouds, vertical, horizontal, or panel mount.

Typical

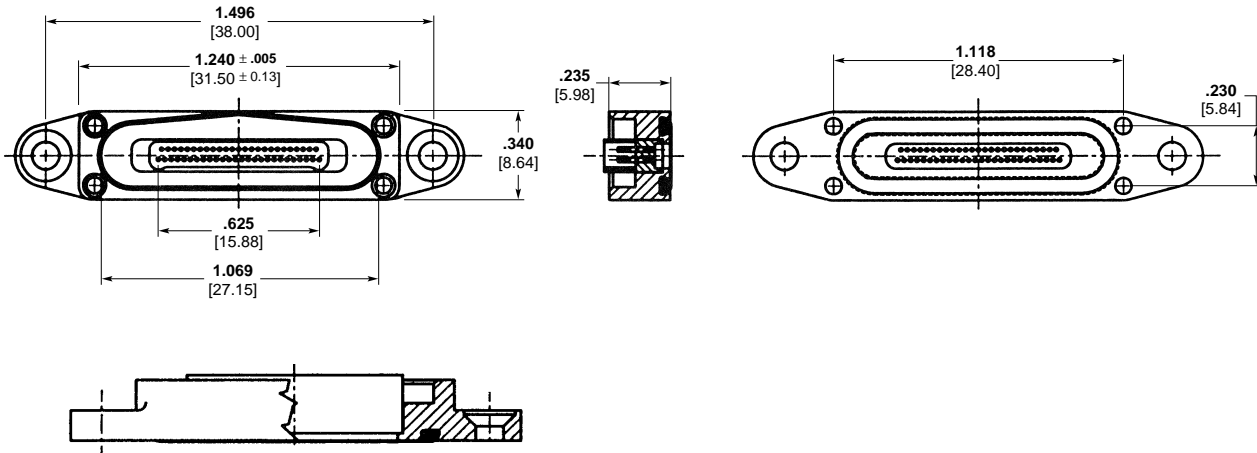

**Size 51, 2 Row, DUALOBE
Environmental Series,
Receptacle Assembly**

For Design Specification and additional ordering information, contact Tyco Electronics.

NANONICS Hermetic Connectors

"H Series" Nanominiature (.025 [.635] pitch)

- Hermetic per MIL-STD-202
- Meets MIL-STD 833, 1-10-8CC He/s max. leak rate
- Solder/Braze Kovar bodies
- Laser weldable 4047 aluminum flange
- Seamless spring socket
- One or two contact rows
- Low engaging forces (1.0 oz) minimize stress
- High performance contact system
- Contact Tyco Electronics for detailed information

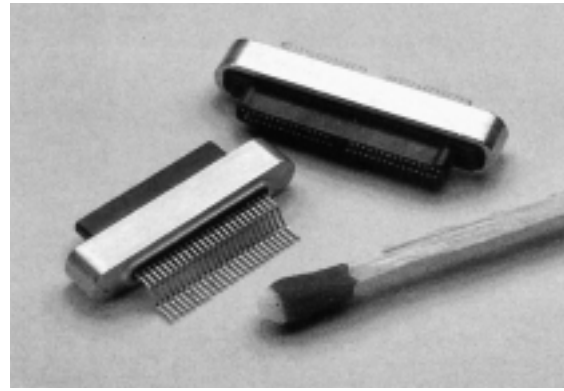

Single Row, 25 Pin

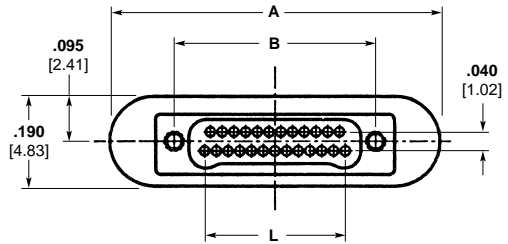

The "H Series" Hermetics bring together established hermetic manufacturing capabilities and our Nanominiature contact and connector design.

The NANONICS "H Series" connectors offer a hermetically glass sealed receptacle per MIL-STD-202 in all sizes. They can be laser welded (aluminum, stainless steel) or soldered/brazed (KOVAR). The hermetic receptacles intermate with NANONICS standard line of DUALOBE plugs.

The connectors are designed for MIL class reliability in severe environments and for dense packaging and reduced size and weight.

Mating DUALOBE plugs offer a variety of terminations and feature one or two rows, plastic or metal shrouds, vertical, horizontal, or panel mount. The contact system features one-piece, seamless, spring socket and gold plated Kovar pins.

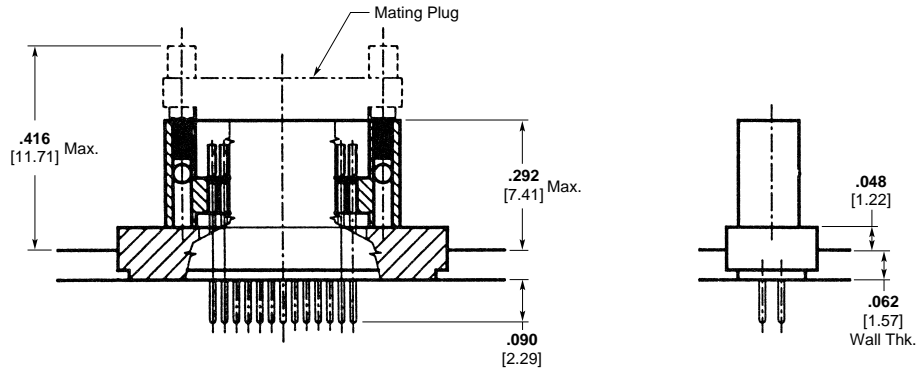

Two Row, Glass Seal, Receptacle

Size	Dimensions		
	A	B	L
9	.500 12.70	.229 5.82	.100 2.54
15	.575 14.61	.304 7.72	.175 4.45
25	.700 17.78	.429 10.90	.300 7.62
37	.850 21.59	.579 14.71	.450 11.43
51*	1.025 26.04	.754 19.15	.625 15.88
65**	1.200 30.48	.929 23.60	.800 20.32

* 46 Contacts, Pos. 12, 13, 14, 38 & 39 are omitted.
** 60 Contacts, Pos. 16, 17, 48, 49 & 50 are omitted.

For Design Specification and additional ordering information, contact Tyco Electronics.

NANONICS Filtered Connectors

10 MHz - 6+ GHz
Size 30 Contacts — .025
[.635]/.0125 [.318] Pitch

- EMI/RFI filter options for nanominiature connectors
- 30 microinches of pore-free Goldbore burnished gold on all internal and external contact and crimp surfaces;
 - Low resistance of .003-.008 ohms
 - 4000+ engagement cycles
 - High performance contact system
- Gas-tight mass crimp;
 - termination reliability
 - enables ribbon, flex circuits
- Reliable, seamless contacts
- Temperature, -55°C to +125°C
- Increased voltage limits
- Low engaging forces (1.0 oz)
- MIL-C-83513 performance
- Stocked sizes 9, 15, 25, 37, 51 and 65
- Standard sizes available, 5 thru 65 contacts in increments of 1 (1 row) or 2 (2 row)

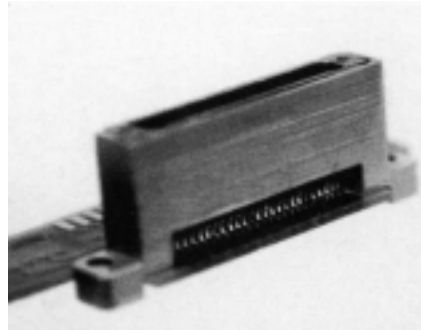

PCB Mount, 51 Position With Filters

Filtered connectors are designed for MIL class, high reliability in severe environments, and for dense packaging requirements. Small size and weight (0.5 gr avg.) are featured benefits of filtered connectors making them highly suitable for high-density circuit designs. The filter options are available in PI, L, or C configurations and have a range from

10MHz to over 6.0GHz. PCB connectors with filters (SM or thru-hole) are configured within shrouded DUALOBE connectors versions. Filters are housed within the connector body. The DUALOBE connectors series features one or two rows, with plastic or metal shrouds, vertical, horizontal, or panel mount. Filters may be specified for either plugs or receptacles.

All configurations incorporate an innovative high performance rated contact system on .025 [.635] centers. The contact/filter system features a one-piece, seamless, spring socket design that improves connector reliability and performance in severe environments.

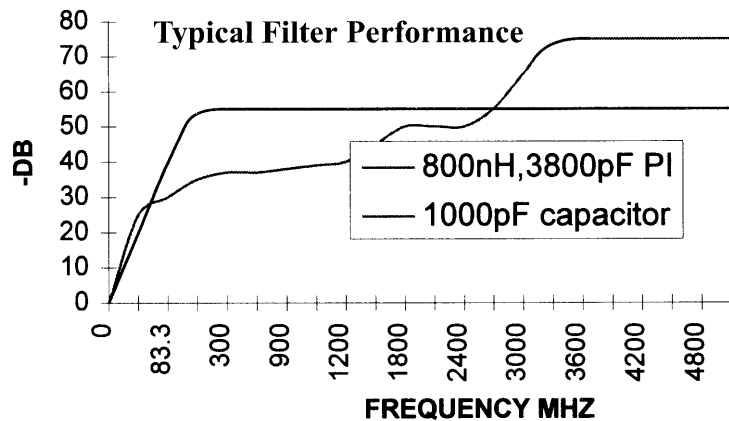

For Design Specification and additional ordering information, contact Tyco Electronics.

NANONICS Nanominiature 50 Ohm Coaxial Connector System

Options

- Mixed signal option; five signal leads and shell with coax
- Up to 9 coax connections per shell
- Horizontal surface mount receptacle also available

Mechanical Specifications

- Receptacle Contact Outside Diameter — .075 [1.91]
- Mated Contact Pair Length — .322 [8.19]
- Mated Shells Height — .166 [4.22]
- Mated Shells Width — .535 [13.59]
- Mated Shells Length With Back Potting — .511 [12.98]

Product Specifications

- Main Connector** — 6061 Aluminum nickel plated, liquid crystal polymer insulator
- Outer Contact** — Beryllium copper, gold/nickel plated
- Inner Coax Contact** — Beryllium copper, gold/nickel plated
- Coax Insulator** — Teflon
- Back Potting** — Space quality epoxy
- Wire Size** — 30 AWG to 38 AWG
- Environmental Rating** — Meets MIL-C-83513
- Operating Temperature** — -55°C to 155°C
- Electrical Specifications**
- Impedance** — 50 Ohm
- Frequency Range** — 0 -20 GHz.
- Working Voltage** — 100 v
- Dielectric Withstanding** — 300 Vrms @ Sea Level

Note: Insertion Loss of 30 AWG Coax Cable @ (50 Ohm) is approximately 1.0db/ft. @ 3 GHz. The connector system with 6" of coax on each side, is better than 1.5db @ 3 GHz.



Size Comparison: Above; Nano, Below; Micro-D

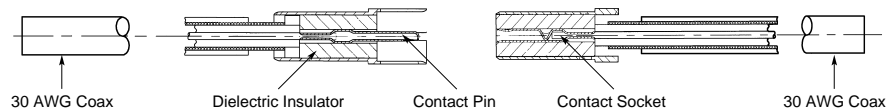

Coax Pin & Socket Contact Set

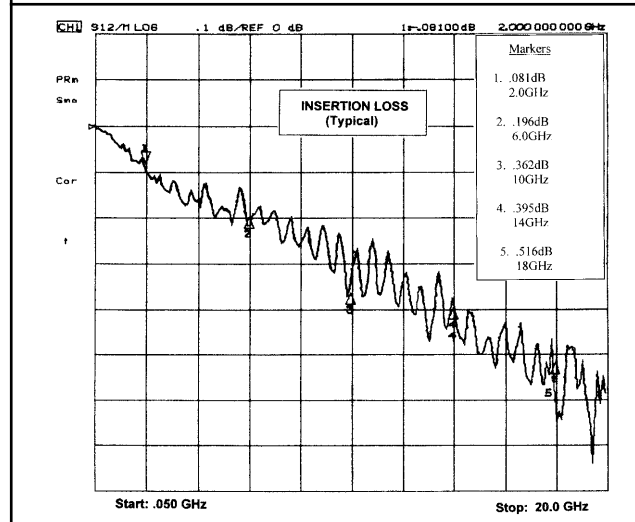
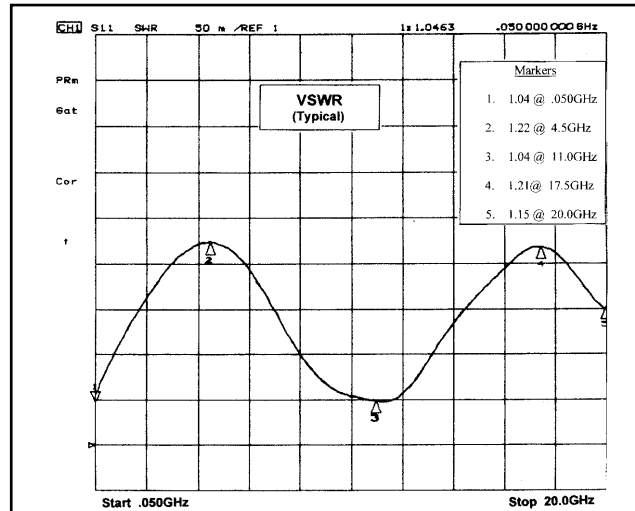

For Design Specification and additional ordering information, contact Tyco Electronics.

NANONICS Flex Circuit, Ribbon Cable Terminations

Proprietary crimp technology helps eliminate solder terminations and related problems

- Mass Crimps exceed requirements of MIL-C-39029 and terminate any material, any shape, any finish, 28 AWG or larger
- Connectors meet DSCC* specifications 94031-94046 for Nanominiature connectors, and the performance requirements of MIL-C-83513
- The contact system features a one-piece, seamless, spring socket and pin design enhancing environmental performance
- New thresholds of performance have been established via the Goldbore contact and proprietary crimp terminations, i.e.:
 - Low resistance of .003-.008 ohms
 - High performance contact system
 - MIL quality mass crimp
 - Seamless contacts
 - MIL spec performance
 - DSCC* spec qualified
 - Increased voltage limits via insulator design
 - Low engaging forces
- Stocked sizes: 9, 15, 25, 37, 51 and 65
- Standard sizes: 5-65 positions

*DSCC-Defense Supply Center, Columbus. Formerly, DESC, Dayton, Ohio

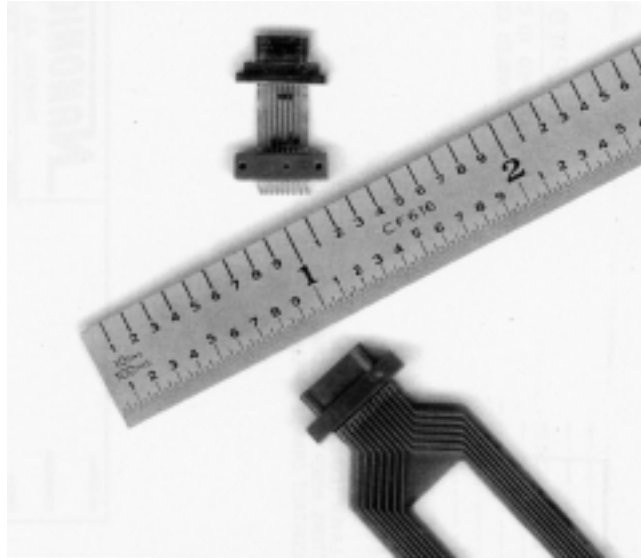

Tyco Electronics offers a wide range of nanominiature connectors for flex circuit and ribbon cable. Designed for mass crimp termination to .025 [.635] and .0125 [.318] pitch flat/ribbon cable and flex circuits, connectors feature

MIL class reliability in severe environments, and dense packaging capability (1/4 of microminiature size) and reduced weight — 0.5 grams avg.). The 2-row DUALLOBE connector provides an effective termination pitch of .0125

[.318].

Available as strips or shrouded DUALLOBE connectors feature one or two rows, vertical, horizontal, surface mount, thru-hole, and panel mount options.

Crimp to Sculptured Flex Version

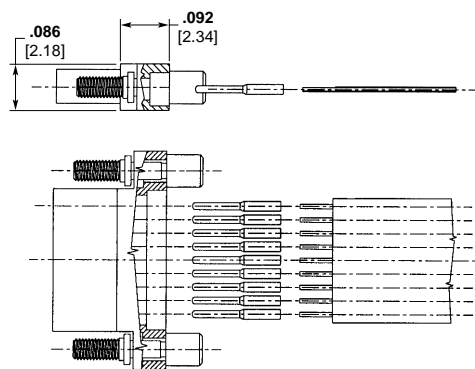

Disassembled View

For Design Specification and additional ordering information, contact Tyco Electronics.

NANONICS Flex Circuit, Ribbon Cable Terminations (Continued)

Soldered to Flex
Metal or Plastic, Duckbill
Leads, Two Row DUALLOBE
Connectors

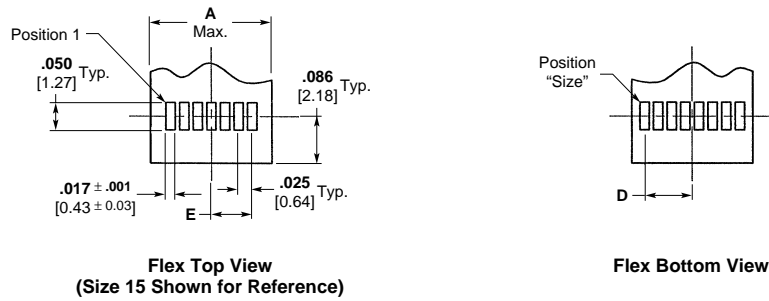
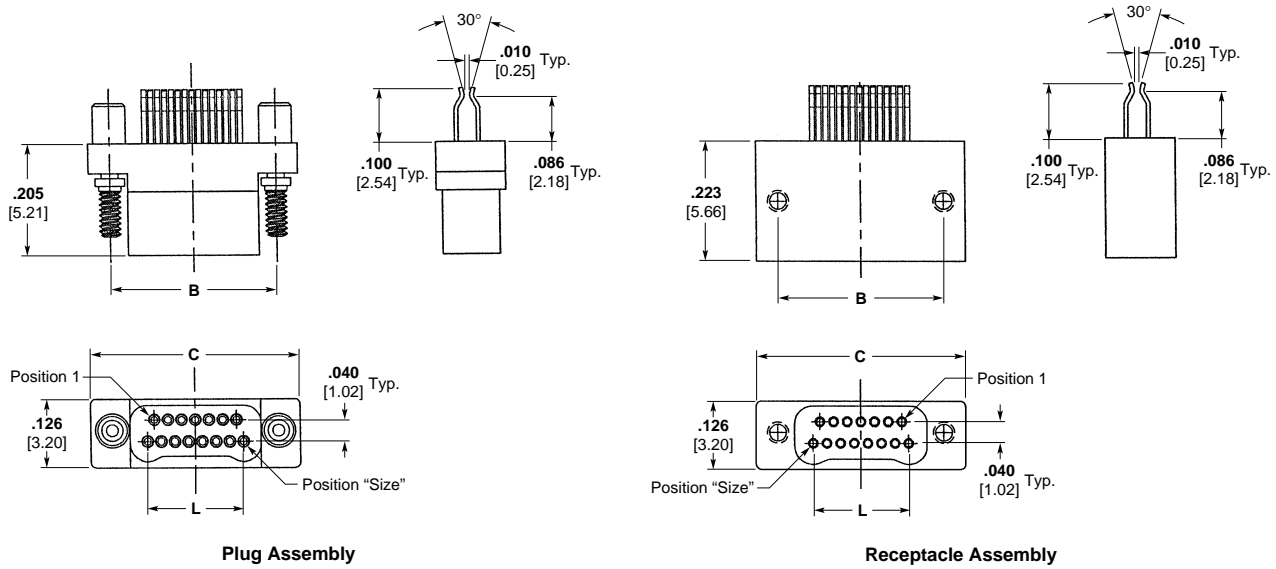

Size	Dimensions					
	A Max.	B	C ±.0050 [0.13]	D	E	L
09	.150 3.81	.229 5.82	.3085 7.84	.0500 1.27	.0375 0.95	.100 2.54
15	.225 5.72	.304 7.72	.3835 9.74	.0875 2.22	.0750 1.91	.175 4.45
25	.350 8.89	.429 10.90	.5085 12.92	.1500 3.81	.1375 3.49	.300 7.62
37	.500 12.70	.579 14.71	.6585 16.73	.2250 5.72	.2125 5.40	.450 11.43
51	.675 17.15	.754 19.15	.8335 21.17	.3125 7.94	.3000 7.62	.625 15.88
65	.850 21.59	.929 23.60	1.0085 25.62	.4000 10.16	.3875 9.84	.800 20.32

For Design Specification and additional ordering information, contact Tyco Electronics.

NANONICS Blindmate Connectors

Blind Mating Board to Board, or Flex Circuit to Board with Metal DUALOBE Connectors

- Mounted vertically or horizontally
- Surface Mount or Thru-Hole
- Guide pin assisted alignment
- MIL spec quality connectors
- Miniaturization of modules

Formats include horizontal board to horizontal board, and horizontal board to vertical board. Board clamping promotes contact retention, and the connectors act as standoffs to protect the spacing for components between boards.

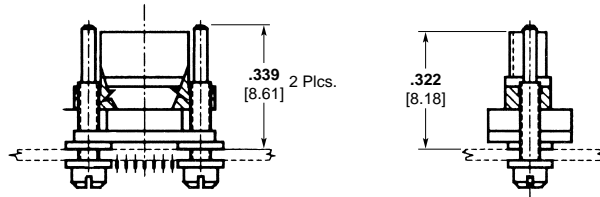
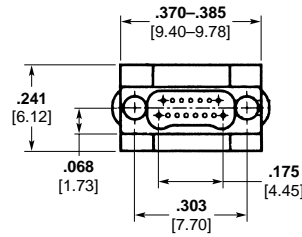

Metal Shell, 2 Row, DUALOBE,

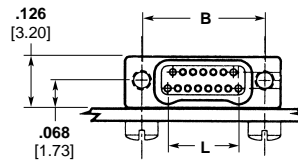
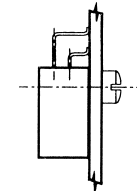
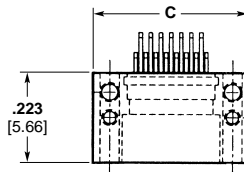

**Metal, 2 Row, DUALOBE,
Horizontal Surface Mount, Receptacle**

Size	Dimensions		
	L	B	C +.010/-0.005 [+.025/-0.13]
9	.100 2.54	.229 5.82	.310 7.87
15	.175 4.45	.304 7.72	.385 9.78
25	.300 7.62	.429 10.90	.510 12.95
37	.450 11.43	.579 14.71	.660 16.76
51	.625 15.88	.754 19.15	.835 21.21
61	.750 19.05	.879 22.33	.960 24.38
65	.800 20.32	.929 23.60	1.010 25.65

For Design Specification and additional ordering information, contact Tyco Electronics.

Standard Part Numbering System

Strip Connectors - Wire Terminations

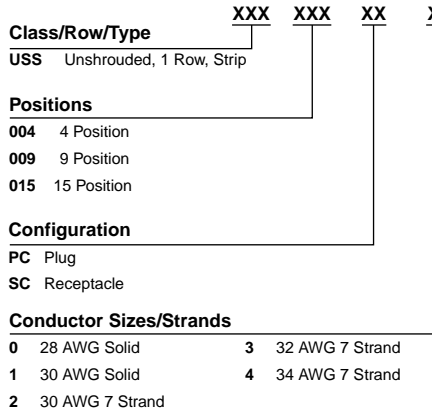

Polarization
Plug contains guide post
Receptacle accepts guide post

Conductor Length

XXX Three numbers only, length is in inches (i.e. 012 = twelve inches)
CXX A "C" followed by two numbers, length is in centimeters (i.e. C06 = six centimeters)
MXX An "M" followed by two numbers, length is in meters (i.e. M02 = two meters)

Conductor Type

DX	White Teflon	DM	Color Coded Teflon per MIL-STD-681
DY	White PTFE M16878/6	DT	White Tefzel M22759/33
DC	Color Coded Teflon		

Polarization: (Strip Type Only)

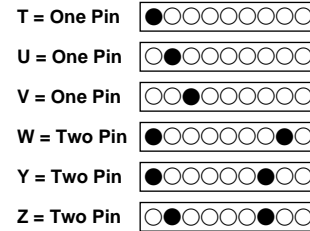

Strip Connectors - Surface Mount and Thru Hole Terminations

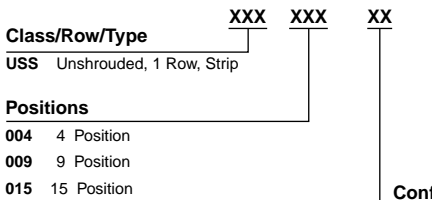

Polarization
Plug contains guide post
Receptacle accepts guide post

Configuration

Surface Mount	Thru Hole		
B2	Plug, Horizontal SMT	C6	Plug, Horizontal Mount, Thru Hole
L2	Receptacle, Horizontal SMT	M6	Receptacle, Horizontal Mount, Thru Hole

Polarization: (Strip Type Only)

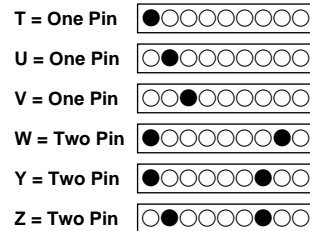

©2001 by Tyco Electronics Corporation.
All rights reserved.
AMP FAX, DUALOBE, NANONICS, and TYCO are trademarks.
Other trademarks used are the property of their respective owners.

Standard Part Numbering System

DUALOBE Connectors - Jumper Terminations*

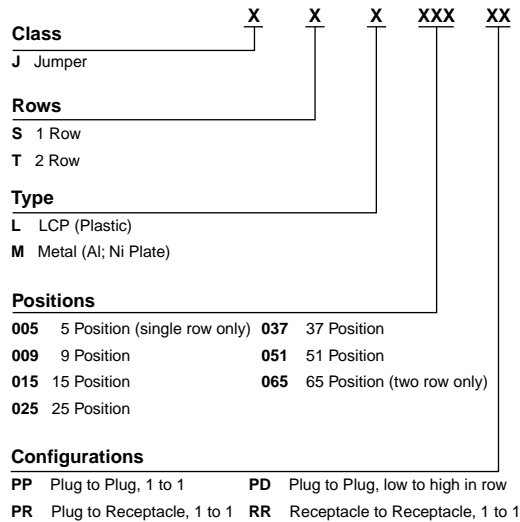

Threads/Jackscrew

Threads (Receptacles Only)

- N Thread for 1.0 mm Jackscrews
- Q Thread for 1.2 mm Jackscrews

Jackscrews (Plugs Only)

- M 1.0 mm Non Captive Jackscrew
- N 1.0 mm Captive Jackscrew
- Q 1.2 mm Captive Jackscrew

Conductor Length

- XXX Three numbers only, length is in inches (i.e. 012 = twelve inches)
- CXX A "C" followed by two numbers, length is in centimeters (i.e. C06 = six centimeters)
- MXX An "M" followed by two numbers, length is in meters (i.e. M02 = two meters)

Conductor Type

- | | |
|------------------------|---------------------------------------|
| DX White Teflon | DM Color Coded Teflon per MIL-STD-681 |
| DY White PTFE M16878/6 | DT White Tefzel M22759/33 |
| DC Color Coded Teflon | GX Teflon Ribbon Cable FEP |

Conductor Size/Strands

- | | |
|-------------------|-------------------|
| 0 28 AWG Solid | 3 32 AWG 7 Strand |
| 1 30 AWG Solid | 4 34 AWG 7 Strand |
| 2 30 AWG 7 Strand | |

*Made to Order

DUALOBE Connectors - Surface Mount and Thru Hole Terminations

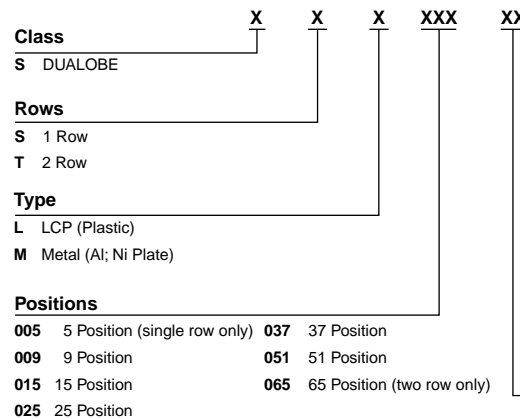

Threads/Jackscrew

Threads (Receptacles Only)

- N Thread for 1.0 mm Jackscrews
- Q Thread for 1.2 mm Jackscrews

Jackscrews (Plugs Only)

- M 1.0 mm Non Captive Jackscrew
- N 1.0 mm Captive Jackscrew
- Q 1.2 mm Captive Jackscrew

Mounting Hardware (Receptacles Only)

- | | |
|---------------------------------|---------------------------------|
| A 1.2 mm x .160" | K 1.0 mm x .200" w/ 4 Standoffs |
| C 1.0 mm x .200" w/ 2 Standoffs | L 1.2 mm x .200" w/ 2 Standoffs |
| D 1.2 mm x .160" w/ 2 Standoffs | P 1.2 mm x .200" w/ 4 Standoffs |
| H 1.0 mm x .160" | S 1.0 mm x .160" w/ 2 Standoffs |
| I 1.2 mm x .200" | |

Configuration

- B2 Plug, Horizontal SMT
- B4 Plug, Vertical SMT
- B42 Plug, Vertical SMT, .020" Extended Leads
- B44 Plug, Vertical SMT, .040" Extended Leads
- L2 Receptacle, Horizontal SMT
- L4 Receptacle, Vertical SMT
- L42 Receptacle, Vertical SMT, .020" Extended Leads
- L44 Receptacle, Vertical SMT, .040" Extended Leads
- L8 Receptacle, Vertical SMT w/ integrated standoffs (metal shell only)
- L82 Receptacle, Vertical SMT w/ integrated standoffs, .020" Extended Leads (metal shell only)
- L84 Receptacle, Vertical SMT w/ integrated standoffs, .040" Extended Leads (metal shell only)
- C5 Plug, Vertical Mount, Thru Hole
- C6 Plug, Horizontal Mount, Thru Hole
- M5 Receptacle, Vertical Mount, Thru Hole
- M6 Receptacle, Horizontal Mount, Thru Hole

For Design Specification and additional ordering information, contact Tyco Electronics.

Standard Part Numbering System

DUALLOBE Connectors - Wire Terminations

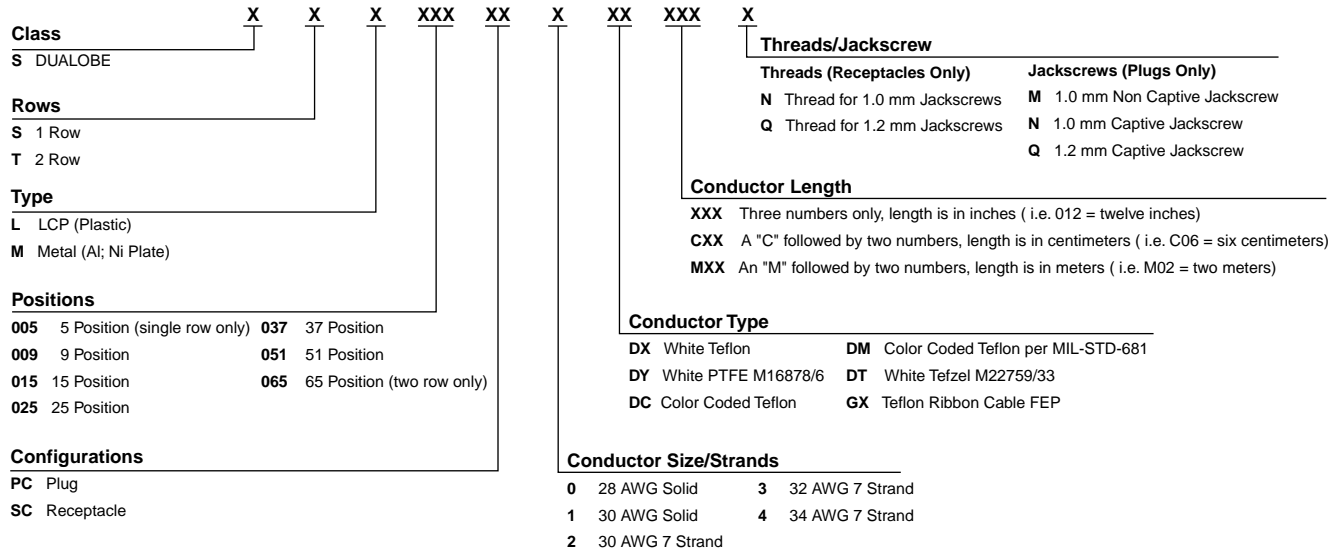

Circular Connectors - Wire Terminations

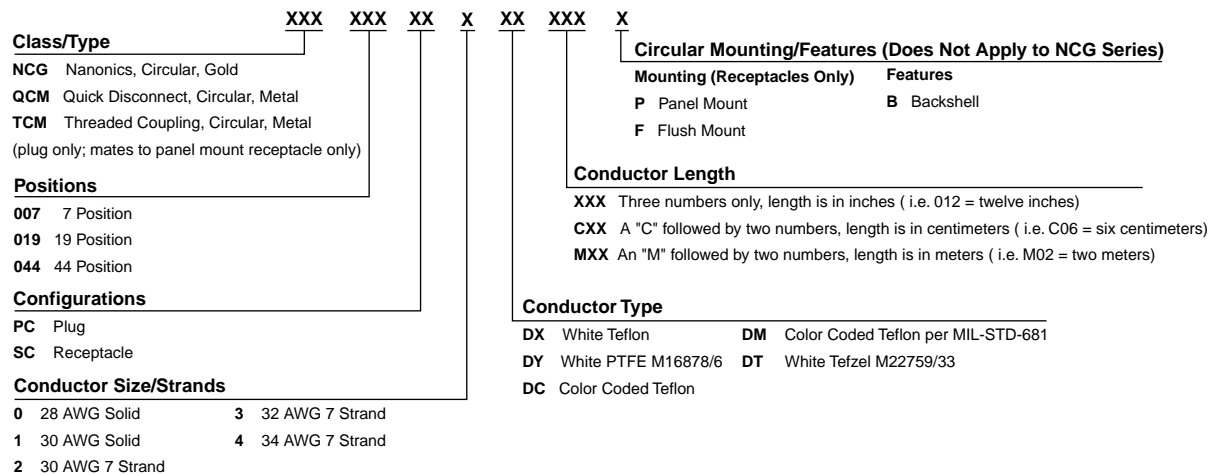

For Design Specification and additional ordering information, contact Tyco Electronics.

Standard Part Numbering System

Coax with Mixed Signals - Wire Terminations

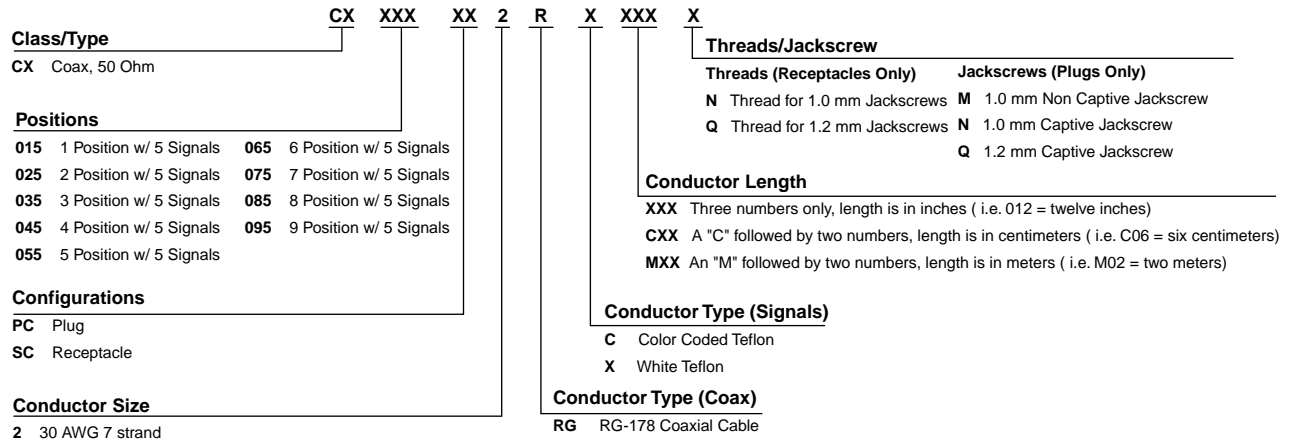

For Design Specification and additional ordering information, contact Tyco Electronics.

Part Number Index -- Current Part Numbers

NANONICS Part Number	Tyco Part Number	NANONICS Part Number	Tyco Part Number	NANONICS Part Number	Tyco Part Number
Coax Only					
CX010PC2RG006N	0-1589070-1	NCG019SC2DC036	0-1589428-5	QCM019SC0DM072F	0-1589058-2
CX010PC2RG018N	0-1589070-2	NCG019SC2DC072	0-1589428-6	QCM019SC0DXC15P	0-1589061-2
CX010PC2RG072N	0-1589070-3	NCG019SC3DC036	0-1589428-7	QCM019SC2DC003P	0-1589061-3
CX020PC2RG018N	0-1589070-4	NCG044PC2DC003	0-1589429-1	QCM019SC2DC006F	0-1589058-3
CX030PC2RG006N	0-1589070-5	NCG044PC2DC006	0-1589429-2	QCM019SC2DC006P	0-1589061-4
CX030PC2RG012	0-1589070-6	NCG044PC2DC012	0-1589429-3	QCM019SC2DC012P	0-1589061-5
CX030PC2RG012N	0-1589070-7	NCG044PC2DC015	0-1589429-4	QCM019SC2DC018F	0-1589058-4
CX030PC2RG018N	0-1589070-8	NCG044PC2DC033	0-1589429-5	QCM019SC2DC020F	0-1589058-5
CX030PC2RG020Q	0-1589070-9	NCG044PC2DC036	0-1589429-6	QCM019SC2DC020P	0-1589061-6
CX030SC2RG006N	0-1589071-3	NCG044PC2DC042	0-1589429-7	QCM019SC2DC036P	0-1589061-7
CX030SC2RG012	0-1589071-4	NCG044PC2DC060	0-1589429-8	QCM019SC2DCC30P	0-1589061-8
CX040PC2RG012N	1-1589070-0	NCG044PC2DCC30	0-1589429-9	QCM019SC2DMC16F	0-1589058-6
CX040PC2RG030N	1-1589070-1	NCG044SC2DC003	0-1589430-1	QCM019SC2DMC46F	0-1589058-7
CX040SC2RG012	0-1589071-5	NCG044SC2DC006	0-1589430-2	QCM019SC2DXC30F	0-1589058-8
Coaxial - Horizontal Surface Mount					
CX010L2HN	0-1589072-1	NCG044SC2DC012	0-1589430-3	QCM019SC2DXC30P	0-1589061-9
CX030L2HN	0-1589072-3	NCG044SC2DC015	0-1589430-4	QCM044PC2DC003	0-1589059-1
CX030L23N	0-1589072-2	NCG044SC2DC018	0-1589430-5	QCM044PC2DC006	0-1589059-2
CX03511822L2HN	0-1589075-1	NCG044SC2DC024	0-1589430-6	QCM044PC2DC006B	0-1589059-3
CX04511822L2HN	0-1589075-2	NCG044SC2DC036	0-1589430-7	QCM044PC2DC012	0-1589059-4
Coax with Mixed Signals					
CX015PC2RC012	0-1589068-1	NCG044SC2DC060	0-1589430-8	QCM044PC2DC012B	0-1589059-5
CX015SC2RC012N	0-1589069-1	NCG044SC2DCC30	0-1589430-9	QCM044PC2DC020	0-1589059-6
CX035PC2RC006N	0-1589068-2	QCM007PC2DC003	0-1589055-1	QCM044PC2DC030	0-1589059-7
CX035PC2RC018N	0-1589068-3	QCM007PC2DC006	0-1589055-2	QCM044PC2DC060B	0-1589059-8
CX035SC2RC006N	0-1589069-2	QCM007PC2DC012	0-1589055-3	QCM044PC2DC120B	0-1589059-9
CX035SC2RC018N	0-1589069-3	QCM007PC2DC012B	0-1589055-4	QCM044SC2DC003P	0-1589062-1
CX045PC2RC006N	0-1589068-4	QCM007PC2DC018B	0-1589055-5	QCM044SC2DC006F	0-1589058-9
CX045SC2RC006N	0-1589069-4	QCM007PC2DC020	0-1589055-6	QCM044SC2DC006P	0-1589062-2
Circular Connectors					
NCG007PC2DC003	0-1589425-1	QCM007PC2DC036B	0-1589055-7	QCM044SC2DC012F	1-1589058-0
NCG007PC2DC006	0-1589425-2	QCM007PC2DC040	0-1589055-8	QCM044SC2DC012P	0-1589062-3
NCG007PC2DC008	0-1589425-3	QCM007PC2DC072	0-1589055-9	QCM044SC2DC018F	1-1589058-1
NCG007PC2DC012	0-1589425-4	QCM007PC2DCC30	1-1589055-0	QCM044SC2DC019PB	0-1589062-4
NCG007PC2DC018	0-1589425-5	QCM007PC2DMC46	1-1589055-1	QCM044SC2DC020F	1-1589058-2
NCG007PC2DC040	0-1589425-6	QCM007PC2DX006B	1-1589055-2	QCM044SC2DC036P	0-1589062-5
NCG007PC2DCC60	0-1589425-7	QCM007SC2DC003P	0-1589060-1	QCM044SC2DC060F	1-1589058-3
NCG007PC2DM024	0-1589425-8	QCM007SC2DC004P	0-1589060-2	QCM044SC2DMC16P	0-1589062-6
NCG007SC2DC003	0-1589426-1	QCM007SC2DC006F	0-1589056-1	QCM044SC2DMC46P	0-1589062-7
NCG007SC2DC004	0-1589426-2	QCM007SC2DC006P	0-1589060-3	TCM007PC2DC003	0-1589063-1
NCG007SC2DC006	0-1589426-3	QCM007SC2DC012P	0-1589060-4	TCM007PC2DC006	0-1589063-2
NCG007SC2DC008	0-1589426-4	QCM007SC2DC012PB	0-1589060-5	TCM007PC2DC006B	0-1589063-3
NCG007SC2DC012	0-1589426-5	QCM007SC2DC018PB	0-1589060-6	TCM007PC2DC012	0-1589063-4
NCG007SC2DC018	0-1589426-6	QCM007SC2DC020F	0-1589056-2	TCM007PC2DC012B	0-1589063-5
NCG007SC2DC024	0-1589426-7	QCM007SC2DC036P	0-1589060-7	TCM007PC2DC018B	0-1589063-6
NCG007SC2DC036	0-1589426-8	QCM007SC2DC036PB	0-1589060-8	TCM007PC2DC036	0-1589063-7
NCG007SC2DC048	0-1589426-9	QCM007SC2DCC30F	0-1589056-3	TCM007PC2DM003	0-1589063-8
NCG007SC2DC060	1-1589426-0	QCM007SC2DCC30P	0-1589060-9	TCM019PC0DCC10	0-1589064-1
NCG007SC2DM024	1-1589426-1	QCM007SC2DM003P	1-1589060-0	TCM019PC0DXC10	0-1589064-2
NCG019PC2DC003	0-1589427-1	QCM007SC2DMC16F	0-1589056-4	TCM019PC2DC003	0-1589064-3
NCG019PC2DC006	0-1589427-2	QCM007SC2DMC46F	0-1589056-5	TCM019PC2DC006	0-1589064-4
NCG019PC2DC018	0-1589427-3	QCM007SC2DX006F	0-1589056-6	TCM019PC2DC006B	0-1589064-5
NCG019PC2DC036	0-1589427-4	QCM019PC0DC012	0-1589057-1	TCM019PC2DC012	0-1589064-6
NCG019PC2DC072	0-1589427-5	QCM019PC0DM072B	0-1589057-2	TCM019PC2DC012B	0-1589064-7
NCG019PC3DC036	0-1589427-6	QCM019PC2DC003	0-1589057-3	TCM019PC2DC024	0-1589064-8
NCG019SC2DC003	0-1589428-1	QCM019PC2DC006	0-1589057-4	TCM019PC2DC036	0-1589064-9
NCG019SC2DC006	0-1589428-2	QCM019PC2DC012	0-1589057-5	TCM019PC2DC060B	1-1589064-0
NCG019SC2DC018	0-1589428-3	QCM019PC2DC020	0-1589057-6	TCM019PC2DC066	1-1589064-1
NCG019SC2DC024	0-1589428-4	QCM019PC2DC120B	0-1589057-7	TCM019PC2DCC03	1-1589064-2
		QCM019PC2DMC46	0-1589057-8	TCM044PC2DC003	0-1589065-1
		QCM019PC2DXC30	0-1589057-9	TCM044PC2DC006	0-1589065-2
		QCM019SC0DC012F	0-1589058-1	TCM044PC2DC006B	0-1589065-3
		QCM019SC0DCC15P	0-1589061-1	TCM044PC2DC012	0-1589065-4

Part Number Index -- Current Part Numbers

NANONICS Part Number	Tyco Part Number	NANONICS Part Number	Tyco Part Number	NANONICS Part Number	Tyco Part Number
TCM044PC2DC012B	0-1589065-5	JSM051PP2GXC12	5-1589672-4	JTM025PP2DY006N	3-1589674-4
TCM044PC2DC018B	0-1589065-6	JSM051PP2GXC12N	5-1589672-5	JTM025PP2DY020N	3-1589674-5
TCM044PC2DC019B	0-1589065-7	JSM051PP2GXC17N	5-1589672-6	JTM025PR0DXC20N	3-1589674-6
TCM044PC2DC036	0-1589065-8	JSM051PP2GXC22N	5-1589672-7	JTM025PR0DXC30N	3-1589674-7
TCM044PC2DC036B	0-1589065-9	JSM051PP2GXC50N	5-1589672-8	JTM025PR2DT001N	3-1589674-8
TCM044PC2DMC46	1-1589065-0	JSM051PP2GXC75N	5-1589672-9	JTM025PR2DT240N	3-1589674-9
DUALOBE Jumpers					
JSL009PP2DX003N	7-1589671-1	JSM051PR2GX002N	6-1589672-1	JTM025PR2DX0.5N	4-1589674-0
JSL009PR2DC012N	7-1589671-2	JTL015PP2DX008M	9-1589672-5	JTM025PR2DX006Q	4-1589674-1
JSL009RR2DX0.5N	7-1589671-3	JTL015PR2DX008	9-1589672-6	JTM025PR2DX012N	4-1589674-2
JSL015PP2DX006N	7-1589671-4	JTL025PP2DC036N	9-1589672-8	JTM025PR2DX020	4-1589674-3
JSL037PD2GXC02N	7-1589671-5	JTL025PP2DCC07N	9-1589672-9	JTM037PD2DC002N	8-1589674-8
JSL037PR2DX002N	7-1589671-6	JTL025PP2DX002N	0-1589673-1	JTM037PD2DC004N	8-1589674-9
JSL051PD2GXC10N	7-1589671-7	JTL025PP2DX003N	0-1589673-2	JTM037PD2GX012N	9-1589674-0
JSL051PD2GXC17N	7-1589671-8	JTL025PP2DX010N	0-1589673-3	JTM037PD2GX024N	9-1589674-1
JSL051PD2GXC22N	7-1589671-9	JTL025PR2DCM31N	0-1589673-4	JTM037PP0DM006	9-1589674-2
JSL051PD2GXC30N	8-1589671-0	JTL037PP2DC07.5N	0-1589673-5	JTM037PP2DX001N	9-1589674-4
JSL051PD2GXC75N	8-1589671-1	JTL037PP2DC08.5N	0-1589673-6	JTM037PP2DX002N	9-1589674-5
JSL051PD2GXC80N	8-1589671-2	JTL037PP2DC09.5N	0-1589673-7	JTM037PP2DX004N	9-1589674-6
JSL051PP2DC004N	8-1589671-3	JTL037PP2DX002N	0-1589673-8	JTM037PP2DX006Q	9-1589674-7
JSL051PP2GXC10N	8-1589671-4	JTL037PP2DX003N	0-1589673-9	JTM037PP2DX009Q	9-1589674-8
JSL051PP2GXC15N	8-1589671-5	JTL037PP2DX012	1-1589673-0	JTM037PP2DX016	9-1589674-9
JSL051PP2GXC17N	8-1589671-6	JTL037PR2DT024N	1-1589673-1	JTM037PP2DX024N	0-1589675-1
JSL051PP2GXC22N	8-1589671-7	JTL051PP2DX002N	1-1589673-4	JTM037PP2GX024N	0-1589675-2
JSL051PP2GXC75N	8-1589671-8	JTL051PR2DC048	1-1589673-8	JTM037PR0DC036M	0-1589675-3
JSL051PP2GXC80N	8-1589671-9	JTL051PP2DX006N	1-1589673-5	JTM037PR2DT001N	0-1589675-4
JSL051PP2GXC80N	8-1589671-9	JTL051PP2DX010N	1-1589673-6	JTM037PR2DX001N	0-1589675-5
JSM005PP2DC002N	9-1589671-0	JTL051PP2DX024N	1-1589673-7	JTM037PR2GX002	0-1589675-6
JSM005PP2DT150N	9-1589671-1	JTL051PR2DC048	1-1589673-8	JTM037PR2GX003N	0-1589675-7
JSM009PP2DC002N	9-1589671-5	JTL065PP2DC012N	2-1589673-3	JTM051PD2DT004N	6-1589675-1
JSM009PP2DC003N	9-1589671-6	JTL065PP2DCC05N	2-1589673-4	JTM051PD2DXC10N	6-1589675-2
JSM009PP2DC024N	9-1589671-7	JTM009PD2DX003N	3-1589673-1	JTM051PP2DC004N	6-1589675-3
JSM009PR2DC002N	9-1589671-8	JTM009PD2DX006N	3-1589673-2	JTM051PP2DX001N	6-1589675-4
JSM009PR2DC006N	9-1589671-9	JTM009PP2DC02.5N	3-1589673-3	JTM051PP2DX004N	6-1589675-5
JSM015PD2DCC02N	0-1589672-6	JTM009PP2DT002N	3-1589673-4	JTM051PP2DX012N	6-1589675-6
JSM015PP2GX014N	0-1589672-7	JTM009PP2DT004N	3-1589673-5	JTM051PP2DX2.5N	6-1589675-7
JSM015PP2GX018N	0-1589672-8	JTM009PP2DX006N	3-1589673-6	JTM051PP2DX4.5N	6-1589675-8
JSM015PR2DC001N	0-1589672-9	JTM009PR2DCC50N	3-1589673-7	JTM051PR2DC002N	6-1589675-9
JSM015PR2DC002N	1-1589672-0	JTM015PD2GX012N	6-1589673-4	JTM051PR2DC005	7-1589675-0
JSM015PR2DC003N	1-1589672-1	JTM015PP2DC006M	6-1589673-5	JTM051PR2DT001N	7-1589675-1
JSM015PR2DC006N	1-1589672-2	JTM015PP2DC012M	6-1589673-6	JTM051PR2DX002N	7-1589675-2
JSM025PP2DX004N	2-1589672-0	JTM015PP2DC02.5N	6-1589673-7	JTM051PR2GX002	7-1589675-3
JSM025PP2DX008N	2-1589672-1	JTM015PP2DT004N	6-1589673-8	JTM051PR2GX006Q	7-1589675-4
JSM025PP2DXC17N	2-1589672-2	JTM015PP2DX001N	6-1589673-9	JTM051RR2DC003	7-1589675-5
JSM025PP2GX003N	2-1589672-3	JTM015PP2DX006N	7-1589673-0	JTM065PP2DX002N	0-1589676-1
JSM025PP2GX024N	2-1589672-4	JTM015PP2DX009N	7-1589673-1	JTM065PP2DX004N	0-1589676-2
JSM025PP4DXC20N	2-1589672-5	JTM015PR2DX024N	7-1589673-2	JTM065PP2DX006N	0-1589676-3
JSM025PR2DC006N	2-1589672-6	JTM015PP2GX003	7-1589673-3	JTM065PP2DX007N	0-1589676-4
JSM025PR2GX002N	2-1589672-7	JTM015PP2GX006	7-1589673-4	JTM065PR2DC001N	0-1589676-5
JSM037PD2GXC10N	3-1589672-3	JTM015PP2GX012	7-1589673-5	JTM065PR2DC003	0-1589676-6
JSM037PP2DCC06Q	3-1589672-4	JTM015PP2GX012N	7-1589673-6	JTM065PR2DC003N	0-1589676-7
JSM037PP2DCC08Q	3-1589672-5	JTM015PP2GX024	7-1589673-7	JTM065PR2DX004N	0-1589676-8
JSM037PP2DX018N	3-1589672-6	JTM015PR2DC002N	7-1589673-8	JTM065PR2GX001N	0-1589676-9
JSM037PP2GX072N	3-1589672-7	JTM015PR2DC012M	7-1589673-9	JTM065RR2DC003	1-1589676-0
JSM051PD2GXC10N	4-1589672-7	JTM015PR2DT001N	8-1589673-0	DUALOBE - Surface Mount & Thru Hole	
JSM051PD2GXC12	4-1589672-8	JTM025PP2DX001N	2-1589674-8	SSL005L2AN	0-1589462-5
JSM051PD2GXC12N	4-1589672-9	JTM025PP2DX012N	2-1589674-9	SSL005L2HN	0-1589462-6
JSM051PD2GXC15N	5-1589672-0	JTM025PP2DX018N	3-1589674-0	SSL005M6SN	0-1589469-6
JSM051PD2GXC17N	5-1589672-1	JTM025PR2DX022N	3-1589674-1	SSL009L2AN	0-1589462-7
JSM051PD2GXC50N	5-1589672-2	JTM025PP2DX03.8M	3-1589674-2	SSL009L2AQ	0-1589462-8
JSM051PP2DCC12Q	5-1589672-3	JTM025PP2DX03.8N	3-1589674-3	SSL009L2HN	0-1589462-9

Part Number Index -- Current Part Numbers

NANONICS Part Number	Tyco Part Number	NANONICS Part Number	Tyco Part Number	NANONICS Part Number	Tyco Part Number
SSL009L42HN	0-1589463-1	SSM025L2SN	3-1589462-8	SSM015L4KN	1-1589463-1
SSL009L43KN	0-1589464-1	SSM025L44HN	1-1589463-3	SSM015L4PQ	1-1589463-2
SSL009L4CN	0-1589463-2	SSM025L44KN	1-1589463-4	SSM015M5CN	0-1589470-8
SSL009L4KN	0-1589463-3	SSM025L4HN	1-1589463-5	SSM015M5LQ	0-1589470-9
SSL009M6D	0-1589469-7	SSM025L4KN	1-1589463-6	SSM015M6HN	2-1589469-5
SSL009M6H	0-1589469-8	SSM025L4PQ	1-1589463-7	SSM015M6SN	2-1589469-6
SSL009M6SN	0-1589469-9	SSM025L4SN	1-1589463-8	STL025B2	0-1589490-2
SSL015L2AN	1-1589462-0	SSM025M5CN	1-1589470-0	STL025C5N	0-1589482-1
SSL015L2AQ	1-1589462-1	SSM025M5HN	1-1589470-1	STL025C6N	0-1589481-1
SSL015L2CN	1-1589462-2	SSM025M5LQ	0-1589470-2	STL025L2AN	1-1589483-5
SSL015L2H	1-1589462-3	SSM025M6DQ	2-1589469-7	STL025L2AQ	1-1589483-6
SSL015L2H2HN	1-1589462-4	SSM025M6HN	2-1589469-8	STL025L2H2HN	1-1589483-7
SSL015L4N	0-1589463-4	SSM025M6SN	3-1589469-0	STL025L42KN	1-1589484-1
SSL015M5KN	0-1589470-2	SSM031L2AN	7-1589679-2	STL025L44N	1-1589484-2
SSL015M6D	1-1589469-0	SSM031L2HN	7-1589679-3	STL025L4HN	1-1589484-3
SSL015M6N	1-1589469-1	SSM037B2	0-1589460-9	STL025L4KN	1-1589484-4
SSL025B2	0-1589460-1	SSM037B2N	1-1589460-2	STL025M5	1-1589488-0
SSL025L2AN	1-1589462-6	SSM037L2AQ	3-1589462-9	STL025M5CN	1-1589488-1
SSL025L2H2HN	1-1589462-7	SSM037L2HN	4-1589462-1	STL025M6	0-1589487-9
SSL025L42	0-1589463-5	SSM037L42KN	1-1589463-9	STL025M6DQ	1-1589487-0
SSL025M5CN	0-1589470-3	SSM037L4KN	2-1589463-0	STL025M6N	1-1589487-1
SSL025M6D	1-1589469-2	SSM037L84KN	0-1589467-1	STL025M6SN	1-1589487-2
SSL025M6DQ	1-1589469-3	SSM037M6HN	3-1589469-2	STL037B42	0-1589485-2
SSL025M6H	1-1589469-4	SSM037M6SN	3-1589469-3	STL037L2AN	2-1589483-0
SSL025M6HN	1-1589469-5	SSM051C5N	0-1589461-3	STL037L2AQ	2-1589483-1
SSL025M6SQ	1-1589469-6	SSM051L2AQ	4-1589462-3	STL037L2HN	2-1589483-2
SSL037B2N	0-1589460-4	SSM051L2HN	4-1589462-4	STL037L44KN	1-1589484-5
SSL037L2HN	1-1589462-8	SSM051L2IQ	4-1589462-5	STL037L4HN	1-1589484-6
SSL037M5N	0-1589470-4	SSM051L42KN	2-1589463-1	STL037M5LQ	1-1589488-3
SSL051B2	0-1589460-5	SSM051L44KN	2-1589463-2	STL037M5Q	1-1589488-4
SSL051L2CN	1-1589462-9	SSM051L4KN	2-1589463-3	STL037M6SN	1-1589487-5
SSL051L2HN	2-1589462-0	SSM051M5CN	1-1589470-3	STL051L2AQ	2-1589483-4
SSM005L2HN	2-1589462-1	SSM051M6SN	3-1589469-4	STL051L2CN	2-1589483-5
SSM005M6SN	1-1589469-7	STL009L2H	0-1589483-8	STL051L2HN	2-1589483-6
SSM009B2N	0-1589460-7	STL009L2HN	0-1589483-9	STL051L42KN	1-1589484-7
SSM009C5Q	0-1589461-1	STL009L42KN	0-1589484-2	STL051L4HN	1-1589484-8
SSM009C6Q	0-1589471-1	STL009L4KN	0-1589484-3	STL051L4KN	1-1589484-9
SSM009L2	2-1589462-2	STL009M5L	0-1589488-7	STL051M5CN	1-1589488-5
SSM009L2AN	2-1589462-3	STL015B2N	0-1589490-1	STL051M6A	1-1589487-6
SSM009L2AQ	2-1589462-4	STL015B44N	0-1589485-1	STL051M6SN	1-1589487-7
SSM009L2HN	2-1589462-5	STL015L2AN	1-1589483-1	STL065L2HN	2-1589483-7
SSM009L2N	2-1589462-6	STL015L2AQ	1-1589483-2	STL065L2N	2-1589483-8
SSM009L2SN	2-1589462-7	STL015L2CN	1-1589483-3	STL065L42KN	2-1589484-0
SSM009L42KN	0-1589463-6	STL015L2HN	1-1589483-4	STL065L44N	2-1589484-1
SSM009L44KN	0-1589463-7	STL015L42KN	0-1589484-5	STL065L4CQ	2-1589484-2
SSM009L44N	0-1589463-8	STL015L44KN	0-1589484-6	STL065L4KN	2-1589484-3
SSM009L4KN	0-1589463-9	STL015L44N	0-1589484-7	STL065M6SN	1-1589487-8
SSM009M5CN	0-1589470-5	STL015L4CQ	0-1589484-8	STM009B42N	0-1589485-3
SSM009M5HN	0-1589470-6	STL015L4HN	0-1589484-9	STM009C6N	0-1589481-2
SSM009M5LQ	0-1589470-7	STL015L4KN	1-1589484-0	STM009L2HN	3-1589483-0
SSM009M6AQ	1-1589469-8	STL015M5CN	0-1589488-8	STM009L2N	3-1589483-1
SSM009M6CN	1-1589469-9	STL015M6CN	0-1589487-6	STM009L2SN	3-1589483-2
SSM009M6DQ	2-1589469-0	STL015M6SN	0-1589487-7	STM009L42HN	2-1589484-4
SSM009M6HN	2-1589469-2	SSM015C5N	0-1589461-2	STM009L42KN	2-1589484-5
SSM009M6SN	2-1589469-4	SSM015L2AN	2-1589462-8	STM009L44HN	2-1589484-6
SSM025B44N	0-1589465-1	SSM015L2AQ	2-1589462-9	STM009L44PQ	2-1589484-7
SSM025C6Q	0-1589471-2	SSM015L2CN	3-1589462-0	STM009L44Q	2-1589484-8
SSM025L2AN	3-1589462-4	SSM015L2HN	3-1589462-1	STM009L4AQ	2-1589484-9
SSM025L2AQ	3-1589462-5	SSM015L2SN	3-1589462-2	STM009L4KN	3-1589484-0
SSM025L2HN	3-1589462-6	SSM015L44KN	1-1589463-0	STM009L4PQ	3-1589484-1

Part Number Index -- Current Part Numbers

NANONICS Part Number	Tyco Part Number	NANONICS Part Number	Tyco Part Number	NANONICS Part Number	Tyco Part Number
STM009M5CN	1-1589488-6	STM025L4LQ	4-1589484-8	STM051L2Q	6-1589483-6
STM009M5DQ	1-1589488-7	STM025L4PN	4-1589484-9	STM051L2SN	6-1589483-8
STM009M5HN	1-1589488-8	STM025L4PQ	5-1589484-0	STM051L42HN	6-1589484-3
STM009M5LQ	1-1589488-9	STM025L4SN	5-1589484-1	STM051L42KN	6-1589484-4
STM009M5Q	2-1589488-0	STM025L82HN	0-1589486-3	STM051L42N	6-1589484-5
STM009M6AN	1-1589487-9	STM025L84KN	0-1589486-4	STM051L44HN	6-1589484-6
STM009M6DQ	2-1589487-0	STM025M5CN	2-1589488-8	STM051L44KN	6-1589484-7
STM009M6HN	2-1589487-1	STM025M5HN	2-1589488-9	STM051L44PQ	6-1589484-8
STM009M6SN	2-1589487-2	STM025M5LQ	3-1589488-0	STM051L44Q	6-1589484-9
STM015B2N	0-1589490-3	STM025M5PQ	3-1589488-1	STM051L4KN	7-1589484-0
STM015B42N	0-1589485-4	STM025M5SN	3-1589488-2	STM051L4PQ	7-1589484-1
STM015C6N	0-1589481-3	STM025M6AN	2-1589487-9	STM051M5AQ	3-1589488-9
STM015L2AQ	3-1589483-5	STM025M6CN	3-1589487-0	STM051M5CN	4-1589488-0
STM015L2HN	3-1589483-6	STM025M6DQ	3-1589487-1	STM051M5DQ	4-1589488-1
STM015L2HQ	3-1589483-7	STM025M6HN	3-1589487-2	STM051M5LQ	4-1589488-2
STM015L2LQ	3-1589483-8	STM025M6N	3-1589487-3	STM051M5PQ	4-1589488-3
STM015L2N	3-1589483-9	STM025M6Q	3-1589487-4	STM051M6CN	4-1589487-3
STM015L2SN	4-1589483-0	STM025M6SN	3-1589487-5	STM051M6DQ	4-1589487-4
STM015L42KN	3-1589484-2	STM037B2N	0-1589490-5	STM051M6HN	4-1589487-5
STM015L44AQ	3-1589484-3	STM037B42N	0-1589485-8	STM051M6PQ	4-1589487-6
STM015L44HN	3-1589484-4	STM037B4N	0-1589485-9	STM051M6SN	4-1589487-7
STM015L44KN	3-1589484-5	STM037C6N	0-1589481-5	STM051M6SQ	4-1589487-8
STM015L44Q	3-1589484-6	STM037L2AN	5-1589483-3	STM065B2Q	0-1589490-9
STM015L4HN	3-1589484-7	STM037L2AQ	5-1589483-4	STM065B42N	1-1589485-1
STM015L4KN	3-1589484-8	STM037L2HN	5-1589483-5	STM065B44	1-1589485-2
STM015L4PQ	3-1589484-9	STM037L2SN	5-1589483-7	STM065B44Q	1-1589485-3
STM015L82HN	0-1589486-1	STM037L42HN	5-1589484-2	STM065B4Q	1-1589485-4
STM015L84KN	0-1589486-2	STM037L42K	5-1589484-3	STM065C5Q	0-1589482-5
STM015M5AN	2-1589488-1	STM037L42KN	5-1589484-4	STM065C6	0-1589481-7
STM015M5CN	2-1589488-2	STM037L44KN	5-1589484-5	STM065L2AQ	7-1589483-1
STM015M5HN	2-1589488-3	STM037L44PQ	5-1589484-6	STM065L2CN	7-1589483-2
STM015M5KN	2-1589488-4	STM037L44Q	5-1589484-7	STM065L2HN	7-1589483-3
STM015M5LN	2-1589488-5	STM037L44SN	5-1589484-8	STM065L2KN	7-1589483-5
STM015M5LQ	2-1589488-6	STM037L4HN	5-1589484-9	STM065L42HN	7-1589484-2
STM015M5PQ	2-1589488-7	STM037L4KN	6-1589484-0	STM065L42KN	7-1589484-3
STM015M6AN	2-1589487-3	STM037L4PQ	6-1589484-1	STM065L42N	7-1589484-4
STM015M6DQ	2-1589487-4	STM037L82AQ	0-1589486-5	STM065L4KN	7-1589484-5
STM015M6HN	2-1589487-5	STM037M5AN	3-1589488-3	STM065L82AQ	0-1589486-6
STM015M6N	2-1589487-6	STM037M5CN	3-1589488-4	STM065L82HN	0-1589486-7
STM015M6S	2-1589487-7	STM037M5HN	3-1589488-5	STM065L84IQ	0-1589486-8
STM015M6SN	2-1589487-8	STM037M5N	3-1589488-6	STM065M5CN	4-1589488-4
STM025B2N	0-1589490-4	STM037M5PQ	3-1589488-7	STM065M5LQ	4-1589488-6
STM025B42N	0-1589485-5	STM037M5SN	3-1589488-8	STM065M5N	4-1589488-7
STM025B44	0-1589485-6	STM037M6AN	3-1589487-6	STM065M6	5-1589487-0
STM025C5N	0-1589482-2	STM037M6AQ	3-1589487-7	STM065M6CN	5-1589487-1
STM025C6N	0-1589481-4	STM037M6DN	3-1589487-8	STM065M6HN	5-1589487-3
STM025L2AN	4-1589483-2	STM037M6DQ	3-1589487-9	STM065M6SN	5-1589487-4
STM025L2AQ	4-1589483-3	STM037M6HN	4-1589487-0	DUALOBE - Soldered to Flex (Duckbill)	
STM025L2CN	4-1589483-4	STM037M6SN	4-1589487-1	STL00911378PC	0-1589066-3
STM025L2HN	4-1589483-5	STM037M6SQ	4-1589487-2	STL00911378PCN	0-1589066-4
STM025L2HQ	4-1589483-6	STM051B2N	0-1589490-6	STL00911378SCN	0-1589067-1
STM025L2IQ	4-1589483-7	STM051B2Q	0-1589490-8	STL01511378PCN	0-1589066-5
STM025L2N	4-1589483-9	STM051B42N	1-1589485-0	STL02511378PCN	0-1589066-6
STM025L42KN	4-1589484-0	STM051C5N	0-1589482-3	STL02511378SCN	0-1589067-2
STM025L44HN	4-1589484-2	STM051C5Q	0-1589482-4	STL03711378PCN	0-1589066-7
STM025L44KN	4-1589484-3	STM051C6N	0-1589481-6	STL05111378PCN	0-1589066-8
STM025L44N	4-1589484-4	STM051L2AQ	6-1589483-0	STL05111378SCHN	0-1589067-3
STM025L44PQ	4-1589484-5	STM051L2CN	6-1589483-2	STL06511378PC	0-1589066-9
STM025L44Q	4-1589484-6	STM051L2HN	6-1589483-3	STL06511378PCN	1-1589066-0
STM025L4KN	4-1589484-7	STM051L2HQ	6-1589483-4	STL06511378SCN	0-1589067-4

Part Number Index -- Current Part Numbers

NANONICS Part Number	Tyco Part Number	NANONICS Part Number	Tyco Part Number	NANONICS Part Number	Tyco Part Number
STM00911378PCN	1-1589066-1	SSL025PC2DC006N	3-1589455-2	SSM009PC3DC018N	8-1589455-2
STM00911378SCN	0-1589067-6	SSL025PC2DC012	3-1589455-3	SSM009SC1DC002	2-1589457-5
STM01511378SCN	0-1589067-7	SSL025PC2DC020N	3-1589455-4	SSM009SC2DC006HN	2-1589457-6
STM02511378PC	1-1589066-2	SSL025PC2DM018M	3-1589455-5	SSM009SC2DC006N	2-1589457-7
STM02511378PCN	1-1589066-3	SSL025PC2DX012Q	3-1589455-6	SSM009SC2DC012N	2-1589457-9
STM02511378SCN	0-1589067-8	SSL025PC2GX006N	3-1589455-7	SSM009SC2DC018N	3-1589457-0
STM03711378PCN	1-1589066-4	SSL025SC2DC006	1-1589457-5	SSM009SC2DC024N	3-1589457-1
STM03711378PCQ	1-1589066-5	SSL025SC2DC006N	1-1589457-6	SSM009SC2DC036N	3-1589457-2
STM05111378PC	1-1589066-6	SSL025SC2DC012N	1-1589457-7	SSM009SC2DM006N	3-1589457-4
STM05111378PCM	1-1589066-7	SSL037PC2DC012N	3-1589455-8	SSM009SC2DM012	3-1589457-5
STM05111378PCN	1-1589066-8	SSL037PC2DC024N	3-1589455-9	SSM009SC2DX012N	3-1589457-6
STM05111378PCQ	1-1589066-9	SSL037PC2DC096N	4-1589455-0	SSM009SC2DX018N	3-1589457-7
STM05111378SCN	0-1589067-9	SSL037SC2DC012N	1-1589457-8	SSM009SC2DX024HN	3-1589457-8
STM06511378PCN	2-1589066-0	SSL051PC2DC012N	4-1589455-1	SSM009SC2DX036HN	3-1589457-9
STM06511378PCQ	2-1589066-1	SSM005PC2DC006	4-1589455-2	SSM015PC0DC012N	8-1589455-3
STM06511378SCN	1-1589067-0	SSM005PC2DC006N	4-1589455-3	SSM015PC0DC018N	8-1589455-4
DUALOBE - Wire Terminations					
SSL005PC0DC006N	0-1589455-2	SSM005PC2DC012N	4-1589455-4	SSM015PC0DMM02N	8-1589455-5
SSL005PC0DC012N	0-1589455-3	SSM005PC2DC018N	4-1589455-5	SSM015PC2DC003N	8-1589455-6
SSL005PC2DC004	0-1589455-4	SSM005PC2DC036N	4-1589455-6	SSM015PC2DC006	8-1589455-7
SSL005PC2DC006	0-1589455-5	SSM005PC2DC040N	4-1589455-7	SSM015PC2DC006N	8-1589455-8
SSL005PC2DC006N	0-1589455-6	SSM005PC2DX012N	4-1589455-8	SSM015PC2DC008N	8-1589455-9
SSL005PC2DX006N	0-1589455-7	SSM005PC2DX018N	4-1589455-9	SSM015PC2DC012	9-1589455-0
SSL005SC0DC006N	0-1589457-1	SSM005PC2DX024N	5-1589455-0	SSM015PC2DC012N	9-1589455-1
SSL005SC2DC006N	0-1589457-2	SSM005PC4DX012N	5-1589455-1	SSM015PC2DC018	9-1589455-2
SSL005SC3DM024N	0-1589457-3	SSM005PC4DXM01	5-1589455-2	SSM015PC2DC018N	9-1589455-3
SSL009PC0DC006N	0-1589455-8	SSM005SC2DC006N	1-1589457-9	SSM015PC2DC024N	9-1589455-4
SSL009PC0DMM03N	0-1589455-9	SSM005SC2DC012N	2-1589457-0	SSM015PC2DC036N	9-1589455-5
SSL009PC2DC001N	1-1589455-0	SSM005SC2DC018N	2-1589457-1	SSM015PC2DC048N	9-1589455-6
SSL009PC2DC003	1-1589455-1	SSM005SC2DC040N	2-1589457-2	SSM015PC2DC060N	9-1589455-7
SSL009PC2DC006N	1-1589455-2	SSM005SC2DX024HN	2-1589457-3	SSM015PC2DM024N	9-1589455-8
SSL009PC2DC009N	1-1589455-3	SSM005SC4DX012N	2-1589457-4	SSM015PC2DMC20N	9-1589455-9
SSL009PC2DC012	1-1589455-4	SSM009PC0DC024N	5-1589455-3	SSM015PC2DMM02N	0-1589456-1
SSL009PC2DC012M	1-1589455-5	SSM009PC0DM024N	5-1589455-4	SSM015PC2DT012N	0-1589456-2
SSL009PC2DC012N	1-1589455-6	SSM009PC0DX012N	5-1589455-5	SSM015PC2DY006N	0-1589456-3
SSL009PC2DC018N	1-1589455-7	SSM009PC2DC003	5-1589455-6	SSM015PC2DX006Q	0-1589456-4
SSL009PC2DCC03N	1-1589455-8	SSM009PC2DC003N	5-1589455-7	SSM015PC2DX008	0-1589456-5
SSL009PC2DCC10N	1-1589455-9	SSM009PC2DC006	5-1589455-8	SSM015PC2DX012N	0-1589456-6
SSL009PC2DM010N	2-1589455-0	SSM009PC2DC006N	5-1589455-9	SSM015PC2DX024N	0-1589456-7
SSL009PC2DM018M	2-1589455-1	SSM009PC2DC010N	6-1589455-0	SSM015PC2DY003N	0-1589456-8
SSL009PC2DMC60Q	2-1589455-2	SSM009PC2DC012	6-1589455-1	SSM015PC2DY006N	0-1589456-9
SSL009SC0DMM03N	0-1589457-4	SSM009PC2DC012M	6-1589455-2	SSM015PC2DY012N	1-1589456-0
SSL009SC2DC003	0-1589457-5	SSM009PC2DC012N	6-1589455-3	SSM015PC2GX018N	1-1589456-1
SSL009SC2DC006N	0-1589457-6	SSM009PC2DC018	6-1589455-4	SSM015PC4DX030N	1-1589456-2
SSL009SC2DC012	0-1589457-7	SSM009PC2DC018N	6-1589455-5	SSM015SC0DC012N	4-1589457-0
SSL009SC2DM006N	0-1589457-8	SSM009PC2DC024	6-1589455-6	SSM015SC2DC003N	4-1589457-1
SSL009SC2GX006	1-1589457-0	SSM009PC2DC024N	6-1589455-7	SSM015SC2DC006N	4-1589457-2
SSL015PC0DMM03N	2-1589455-3	SSM009PC2DC036N	6-1589455-8	SSM015SC2DC012N	4-1589457-3
SSL015PC2DC006N	2-1589455-4	SSM009PC2DC060N	6-1589455-9	SSM015SC2DC018	4-1589457-4
SSL015PC2DC008N	2-1589455-5	SSM009PC2DCC10N	7-1589455-0	SSM015SC2DC036N	4-1589457-5
SSL015PC2DC012	2-1589455-6	SSM009PC2DCM01N	7-1589455-1	SSM015SC2DX006N	4-1589457-8
SSL015PC2DC012N	2-1589455-7	SSM009PC2DM010N	7-1589455-2	SSM015SC2DX012HN	4-1589457-9
SSL015PC2DC018	2-1589455-8	SSM009PC2DM018N	7-1589455-3	SSM015SC2DX018N	5-1589457-0
SSL015PC2DC024	2-1589455-9	SSM009PC2DM024	7-1589455-4	SSM015SC2DX024HN	5-1589457-2
SSL015PC2DM018M	3-1589455-0	SSM009PC2DX005N	7-1589455-5	SSM015SC2DY012N	5-1589457-3
SSL015SC0DMM03N	1-1589457-1	SSM009PC2DX006N	7-1589455-6	SSM015SC2DY018N	5-1589457-4
SSL015SC2DC006N	1-1589457-2	SSM009PC2DX010N	7-1589455-7	SSM015SC4DX005N	5-1589457-5
SSL015SC2DC012N	1-1589457-3	SSM009PC2DX012N	7-1589455-8	SSM025PC2DC003N	1-1589456-4
SSL015SC2DC024N	1-1589457-4	SSM009PC2DX018N	7-1589455-9	SSM025PC2DC006Q	1-1589456-5
SSL025PC2DC006	3-1589455-1	SSM009PC2DX024N	8-1589455-0	SSM025PC2DC010N	1-1589456-6
		SSM009PC2DY006N	8-1589455-1	SSM025PC2DC012	1-1589456-7

Part Number Index -- Current Part Numbers

NANONICS Part Number	Tyco Part Number	NANONICS Part Number	Tyco Part Number	NANONICS Part Number	Tyco Part Number
SSM025PC2DC012N	1-1589456-8	STL009PC2DC018N	1-1589472-5	STL037PC2DC018N	5-1589472-9
SSM025PC2DC018	1-1589456-9	STL009PC2DC036N	1-1589472-6	STL037PC2DC020Q	6-1589472-0
SSM025PC2DC018N	2-1589456-0	STL009PC2DM010N	1-1589472-7	STL037PC2DC036M	6-1589472-1
SSM025PC2DC025N	2-1589456-1	STL009PC2DX024N	1-1589472-8	STL037PC2DC036N	6-1589472-2
SSM025PC2DC030N	2-1589456-2	STL009PC2GX010N	1-1589472-9	STL037PC2DC040N	6-1589472-3
SSM025PC2DC036N	2-1589456-3	STL009PC3DX024N	2-1589472-0	STL037PC2DCC15N	6-1589472-4
SSM025PC2DCC30N	2-1589456-4	STL009PC3DX030N	2-1589472-1	STL037PC2DM010N	6-1589472-5
SSM025PC2DX006N	2-1589456-5	STL009SC2DC012	0-1589476-6	STL037PC2GX005N	6-1589472-6
SSM025PC2DX012N	2-1589456-6	STL009SC2DC012N	0-1589476-7	STL037SC2DC012N	2-1589476-4
SSM025PC2DX018N	2-1589456-7	STL009SC2DC036N	0-1589476-8	STL037SC2DC012Q	2-1589476-5
SSM025PC2DX024N	2-1589456-8	STL009SC3DX024N	0-1589476-9	STL037SC2DC030N	2-1589476-6
SSM025PC2GX006	2-1589456-9	STL015PC0DC006N	2-1589472-2	STL037SC2DC036N	2-1589476-7
SSM025PC2GX018N	3-1589456-0	STL015PC0DC012Q	2-1589472-3	STL037SC2DCC15N	2-1589476-8
SSM025PC3DY006N	3-1589456-1	STL015PC0DMM03N	2-1589472-4	STL037SC3DX024N	2-1589476-9
SSM025SC2DC012N	5-1589457-6	STL015PC2DC006	2-1589472-6	STL051PC0DXC50N	6-1589472-7
SSM025SC2DC018	5-1589457-7	STL015PC2DC008	2-1589472-7	STL051PC2DC003N	6-1589472-8
SSM025SC2DC024N	5-1589457-9	STL015PC2DC010N	2-1589472-8	STL051PC2DC006N	6-1589472-9
SSM025SC2DX006N	6-1589457-0	STL015PC2DC012	2-1589472-9	STL051PC2DC012	7-1589472-0
SSM025SC2DX018N	6-1589457-1	STL015PC2DC012N	3-1589472-0	STL051PC2DC012N	7-1589472-1
SSM025SC2DX024HN	6-1589457-3	STL015PC2DC015N	3-1589472-1	STL051PC2DC018	7-1589472-2
SSM025SC3DY006N	6-1589457-4	STL015PC2DC018M	3-1589472-2	STL051PC2DC024N	7-1589472-3
SSM037PC2DC006	3-1589456-2	STL015PC2DC030N	3-1589472-3	STL051PC2DC036N	7-1589472-4
SSM037PC2DC006N	3-1589456-3	STL015PC2DC036N	3-1589472-4	STL051PC2DC040N	7-1589472-5
SSM037PC2DC012	3-1589456-4	STL015PC2DCC10N	3-1589472-5	STL051PC2DCC35N	7-1589472-6
SSM037PC2DC012N	3-1589456-5	STL015PC2DM010N	3-1589472-6	STL051SC2DC003N	3-1589476-0
SSM037PC2DC015N	3-1589456-6	STL015PC2DX010N	3-1589472-8	STL051SC2DC012N	3-1589476-1
SSM037PC2DC018	3-1589456-7	STL015PC2DX036N	3-1589472-9	STL051SC2DC018N	3-1589476-2
SSM037PC2DC018N	3-1589456-8	STL015PC2GX040N	4-1589472-0	STL051SC2DC024N	3-1589476-3
SSM037PC2DC024N	3-1589456-9	STL015SC0DMM03N	1-1589476-0	STL051SC2DC048	3-1589476-4
SSM037PC2DCM01N	4-1589456-0	STL015SC2DC008	1-1589476-1	STL065PC0DC036N	7-1589472-8
SSM037PC2DX012Q	4-1589456-2	STL015SC2DC008N	1-1589476-2	STL065PC2DC006	7-1589472-9
SSM037PC2DX018N	4-1589456-3	STL015SC2DC012N	1-1589476-3	STL065PC2DC006N	8-1589472-0
SSM037PC2GX030N	4-1589456-4	STL015SC2DC018N	1-1589476-4	STL065PC2DC012N	8-1589472-1
SSM037SC2DC018	6-1589457-5	STL015SC2DC030N	1-1589476-5	STL065PC2DC018	8-1589472-2
SSM037SC2DC018N	6-1589457-6	STL015SC2DC036N	1-1589476-6	STL065PC2DC018N	8-1589472-3
SSM051PC2DC006	4-1589456-5	STL015SC2DX010N	1-1589476-7	STL065PC2DC024N	8-1589472-4
SSM051PC2DC006N	4-1589456-6	STL015SC3DX024N	1-1589476-8	STL065PC2DC036N	8-1589472-5
SSM051PC2DC012N	4-1589456-7	STL025PC2DC006	4-1589472-1	STL065PC2DC040N	8-1589472-6
SSM051PC2DC018	4-1589456-8	STL025PC2DC006N	4-1589472-2	STL065PC2DC072N	8-1589472-7
SSM051PC2DC024	4-1589456-9	STL025PC2DC010N	4-1589472-3	STL065PC2DCC10N	8-1589472-8
SSM051PC2DC024N	5-1589456-0	STL025PC2DC012	4-1589472-4	STL065PC2DM018N	8-1589472-9
SSM051PC2DC030N	5-1589456-1	STL025PC2DC012N	4-1589472-5	STL065PC2DM036N	9-1589472-0
SSM051PC2DCC06Q	5-1589456-2	STL025PC2DC015N	4-1589472-6	STL065PC2GX036Q	9-1589472-1
SSM051PC2DM012Q	5-1589456-3	STL025PC2DC018N	4-1589472-7	STL065PC3DM072N	9-1589472-2
SSM051PC2DM024N	5-1589456-4	STL025PC2DC020N	4-1589472-8	STL065SC2DC006N	3-1589476-6
SSM051PC2DMC10N	5-1589456-5	STL025PC2DC030N	4-1589472-9	STL065SC2DC012N	3-1589476-7
SSM051PC2DMC30N	5-1589456-6	STL025PC2DM010N	5-1589472-0	STL065SC2DC048N	3-1589476-8
SSM051PC2DX008	5-1589456-9	STL025PC3DX006N	5-1589472-1	STL065SC2DM036N	3-1589476-9
SSM051PC2DXM05Q	6-1589456-0	STL025PC4DX030N	5-1589472-2	STL065SC3DM072N	4-1589476-0
SSM051PC2DY012N	6-1589456-1	STL025SC2DC001N	1-1589476-9	STM009PC0DC020N	9-1589472-3
SSM051PC2GX012N	6-1589456-2	STL025SC2DC006N	2-1589476-0	STM009PC0DXC10N	9-1589472-4
SSM051SC2DC018	6-1589457-7	STL025SC2DC012N	2-1589476-1	STM009PC2DC003N	9-1589472-5
SSM051SC2DC018N	6-1589457-8	STL025SC2DC030N	2-1589476-2	STM009PC2DC004N	9-1589472-6
SSM051SC2DNC15Q	6-1589457-9	STL025SC2DC036N	2-1589476-3	STM009PC2DC006	9-1589472-7
SSM051SC2DT021	7-1589457-1	STL037PC2DC010N	5-1589472-3	STM009PC2DC006N	9-1589472-8
SSM051SC2GX012N	7-1589457-3	STL037PC2DC012	5-1589472-4	STM009PC2DC012	9-1589472-9
STL009PC2DC012	1-1589472-1	STL037PC2DC012M	5-1589472-5	STM009PC2DC012N	0-1589473-1
STL009PC2DC012N	1-1589472-2	STL037PC2DC012N	5-1589472-6	STM009PC2DC016N	0-1589473-2
STL009PC2DC018	1-1589472-3	STL037PC2DC017N	5-1589472-7	STM009PC2DC018N	0-1589473-3
STL009PC2DC018M	1-1589472-4	STL037PC2DC018M	5-1589472-8	STM009PC2DC019	0-1589473-4

Part Number Index -- Current Part Numbers

NANONICS Part Number	Tyco Part Number	NANONICS Part Number	Tyco Part Number	NANONICS Part Number	Tyco Part Number
STM009PC2DC020Q	0-1589473-5	STM015PC2DC036N	4-1589473-8	STM025PC2DC006N	7-1589473-9
STM009PC2DC024	0-1589473-6	STM015PC2DC048N	4-1589473-9	STM025PC2DC008N	8-1589473-0
STM009PC2DC024N	0-1589473-7	STM015PC2DC060Q	5-1589473-0	STM025PC2DC010N	8-1589473-1
STM009PC2DC028N	0-1589473-8	STM015PC2DC120N	5-1589473-1	STM025PC2DC012	8-1589473-2
STM009PC2DC030N	0-1589473-9	STM015PC2DCC30N	5-1589473-2	STM025PC2DC012N	8-1589473-3
STM009PC2DC036	1-1589473-0	STM015PC2DCC90Q	5-1589473-3	STM025PC2DC015N	8-1589473-4
STM009PC2DC036M	1-1589473-1	STM015PC2DCM01N	5-1589473-4	STM025PC2DC016N	8-1589473-5
STM009PC2DC036N	1-1589473-2	STM015PC2DM018N	5-1589473-5	STM025PC2DC018N	8-1589473-6
STM009PC2DC060Q	1-1589473-3	STM015PC2DM024N	5-1589473-6	STM025PC2DC020N	8-1589473-7
STM009PC2DCC40N	1-1589473-4	STM015PC2DM036N	5-1589473-7	STM025PC2DC020Q	8-1589473-8
STM009PC2DCC90Q	1-1589473-5	STM015PC2DMM01N	5-1589473-8	STM025PC2DC024N	8-1589473-9
STM009PC2DCM01N	1-1589473-6	STM015PC2DT006Q	5-1589473-9	STM025PC2DC024Q	9-1589473-0
STM009PC2DM012N	1-1589473-7	STM015PC2DT012N	6-1589473-0	STM025PC2DC030N	9-1589473-1
STM009PC2DM012Q	1-1589473-8	STM015PC2DT030N	6-1589473-1	STM025PC2DC036M	9-1589473-2
STM009PC2DM018N	1-1589473-9	STM015PC2DT036N	6-1589473-2	STM025PC2DC036N	9-1589473-3
STM009PC2DM036N	2-1589473-0	STM015PC2DTC45N	6-1589473-3	STM025PC2DC048N	9-1589473-4
STM009PC2DT018N	2-1589473-2	STM015PC2DX010N	6-1589473-4	STM025PC2DC060N	9-1589473-5
STM009PC2DT030N	2-1589473-3	STM015PC2DX012N	6-1589473-5	STM025PC2DC060Q	9-1589473-6
STM009PC2DX010N	2-1589473-4	STM015PC2DX024N	6-1589473-6	STM025PC2DC072N	9-1589473-7
STM009PC2DX024N	2-1589473-5	STM015PC2DX030N	6-1589473-7	STM025PC2DC120N	9-1589473-8
STM009PC2DXC15Q	2-1589473-6	STM015PC2DX048N	6-1589473-8	STM025PC2DC180N	9-1589473-9
STM009SC0DX012N	4-1589476-1	STM015PC2DXC15Q	6-1589473-9	STM025PC2DC40N	0-1589474-1
STM009SC2DC006	4-1589476-2	STM015PC2GX004N	7-1589473-0	STM025PC2DCC50N	0-1589474-2
STM009SC2DC006HN	4-1589476-3	STM015PC3DX024N	7-1589473-1	STM025PC2DCC60N	0-1589474-3
STM009SC2DC006N	4-1589476-4	STM015PC4DX012N	7-1589473-2	STM025PC2DM006Q	0-1589474-4
STM009SC2DC012HN	4-1589476-5	STM015SC0DXC10N	6-1589476-7	STM025PC2DM012Q	0-1589474-5
STM009SC2DC012N	4-1589476-6	STM015SC0DXC10Q	6-1589476-8	STM025PC2DM018N	0-1589474-6
STM009SC2DC012Q	4-1589476-7	STM015SC2DC003N	7-1589476-1	STM025PC2DM024N	0-1589474-7
STM009SC2DC018HN	4-1589476-9	STM015SC2DC004HN	7-1589476-2	STM025PC2DM036N	0-1589474-8
STM009SC2DC018N	5-1589476-0	STM015SC2DC006N	7-1589476-3	STM025PC2DT012N	0-1589474-9
STM009SC2DC024N	5-1589476-1	STM015SC2DC008HN	7-1589476-4	STM025PC2DT030N	1-1589474-0
STM009SC2DC036HN	5-1589476-2	STM015SC2DC012HN	7-1589476-5	STM025PC2DT036Q	1-1589474-1
STM009SC2DC036N	5-1589476-3	STM015SC2DC012N	7-1589476-6	STM025PC2DT048Q	1-1589474-2
STM009SC2DC048N	5-1589476-4	STM015SC2DC016N	7-1589476-7	STM025PC2DX005	1-1589474-3
STM009SC2DC060Q	5-1589476-5	STM015SC2DC018N	7-1589476-8	STM025PC2DX006N	1-1589474-4
STM009SC2DCM01HN	5-1589476-6	STM015SC2DC024N	7-1589476-9	STM025PC2DX006Q	1-1589474-5
STM009SC2DCM02N	5-1589476-7	STM015SC2DC036N	8-1589476-0	STM025PC2DX010N	1-1589474-6
STM009SC2DM018HN	5-1589476-8	STM015SC2DC060Q	8-1589476-1	STM025PC2DX012N	1-1589474-7
STM009SC2DM036N	5-1589476-9	STM015SC2DCC30N	8-1589476-2	STM025PC2DX018N	1-1589474-8
STM009SC2DT012HN	6-1589476-0	STM015SC2DCM01HN	8-1589476-3	STM025PC2DX048N	1-1589474-9
STM009SC2DT012N	6-1589476-1	STM015SC2DM006N	8-1589476-4	STM025PC2DY004	2-1589474-0
STM009SC2DT030N	6-1589476-2	STM015SC2DM01N	8-1589476-5	STM025PC2DY006	2-1589474-1
STM009SC2DX010N	6-1589476-3	STM015SC2DT006Q	8-1589476-6	STM025PC2DY006N	2-1589474-2
STM009SC2DX012HN	6-1589476-4	STM015SC2DT012HN	8-1589476-7	STM025PC4DX012M	2-1589474-4
STM009SC2DX012N	6-1589476-5	STM015SC2DT030N	8-1589476-8	STM025PC4DX012N	2-1589474-5
STM009SC2DXC15Q	6-1589476-6	STM015SC2DX005HN	8-1589476-9	STM025SC2DC003	9-1589476-8
STM015PC0DCM02Q	2-1589473-9	STM015SC2DX006HN	9-1589476-0	STM025SC2DC004	9-1589476-9
STM015PC0DM012N	3-1589473-0	STM015SC2DX010N	9-1589476-1	STM025SC2DC006N	0-1589477-1
STM015PC2DC003N	3-1589473-6	STM015SC2DX012N	9-1589476-2	STM025SC2DC008N	0-1589477-2
STM015PC2DC005N	3-1589473-7	STM015SC2DX018HN	9-1589476-3	STM025SC2DC012HN	0-1589477-3
STM015PC2DC006N	3-1589473-8	STM015SC2DXC15Q	9-1589476-4	STM025SC2DC012N	0-1589477-4
STM015PC2DC012N	3-1589473-9	STM015SC4DX012Q	9-1589476-5	STM025SC2DC016N	0-1589477-5
STM015PC2DC012Q	4-1589473-0	STM015SC4DX030N	9-1589476-6	STM025SC2DC018N	0-1589477-6
STM015PC2DC016N	4-1589473-1	STM015SC4DXC20N	9-1589476-7	STM025SC2DC020N	0-1589477-7
STM015PC2DC018N	4-1589473-2	STM025PC0DC012N	7-1589473-3	STM025SC2DC024N	0-1589477-8
STM015PC2DC020Q	4-1589473-3	STM025PC0DM012N	7-1589473-4	STM025SC2DC036N	0-1589477-9
STM015PC2DC024N	4-1589473-4	STM025PC2DC003	7-1589473-5	STM025SC2DC040N	1-1589477-0
STM015PC2DC030N	4-1589473-5	STM025PC2DC003N	7-1589473-6	STM025SC2DC048HN	1-1589477-1
STM015PC2DC036	4-1589473-6	STM025PC2DC004	7-1589473-7	STM025SC2DC048N	1-1589477-2
STM015PC2DC036M	4-1589473-7	STM025PC2DC006	7-1589473-8	STM025SC2DC060HN	1-1589477-3

Part Number Index -- Current Part Numbers

NANONICS Part Number	Tyco Part Number	NANONICS Part Number	Tyco Part Number	NANONICS Part Number	Tyco Part Number
STM025SC2DC060Q	1-1589477-4	STM037SC2DC036N	3-1589477-7	STM051SC2DX012N	6-1589477-4
STM025SC2DC180N	1-1589477-5	STM037SC2DC060Q	3-1589477-8	STM051SC2DX015N	6-1589477-5
STM025SC2DCC60N	1-1589477-6	STM037SC2DM024N	3-1589477-9	STM065PC2DC003N	0-1589475-1
STM025SC2DT012HN	1-1589477-7	STM051PC2DT030N	4-1589477-0	STM065PC2DC006	0-1589475-2
STM025SC2DT030N	1-1589477-8	STM037SC2DX006N	4-1589477-1	STM065PC2DC006N	0-1589475-3
STM025SC2DX005HN	1-1589477-9	STM037SC2DX010N	4-1589477-2	STM065PC2DC008Q	0-1589475-4
STM025SC2DX006N	2-1589477-0	STM037SC2DX012N	4-1589477-3	STM065PC2DC012N	0-1589475-5
STM025SC2DX010N	2-1589477-1	STM037SC2GX006N	4-1589477-4	STM065PC2DC012Q	0-1589475-6
STM025SC2DX012N	2-1589477-2	STM051PC0DC012N	6-1589474-5	STM065PC2DC016M	0-1589475-7
STM025SC2DX018N	2-1589477-3	STM051PC0DC048N	6-1589474-6	STM065PC2DC016N	0-1589475-8
STM025SC2DY018N	2-1589477-4	STM051PC0DXC10N	6-1589474-7	STM065PC2DC018M	0-1589475-9
STM025SC3DC012N	2-1589477-5	STM051PC1DXC20	6-1589474-8	STM065PC2DC018N	1-1589475-0
STM025SC3DMC20DQ	2-1589477-6	STM051PC2DC003N	6-1589474-9	STM065PC2DC018Q	1-1589475-1
STM025SC4DX030N	2-1589477-7	STM051PC2DC006	7-1589474-0	STM065PC2DC024N	1-1589475-2
STM037PC0DC009N	2-1589474-6	STM051PC2DC006N	7-1589474-1	STM065PC2DC024Q	1-1589475-3
STM037PC0DXC10N	2-1589474-7	STM051PC2DC012N	7-1589474-2	STM065PC2DC030N	1-1589475-4
STM037PC2DC003N	2-1589474-8	STM051PC2DC012Q	7-1589474-3	STM065PC2DC036N	1-1589475-5
STM037PC2DC005N	2-1589474-9	STM051PC2DC015N	7-1589474-4	STM065PC2DC072N	1-1589475-6
STM037PC2DC006M	3-1589474-0	STM051PC2DC016N	7-1589474-5	STM065PC2DM018N	1-1589475-7
STM037PC2DC006N	3-1589474-1	STM051PC2DC018	7-1589474-6	STM065PC2DT018N	1-1589475-8
STM037PC2DC012	3-1589474-2	STM051PC2DC018N	7-1589474-7	STM065PC2DT030N	1-1589475-9
STM037PC2DC012M	3-1589474-3	STM051PC2DC018Q	7-1589474-8	STM065PC2DX006N	2-1589475-0
STM037PC2DC012N	3-1589474-4	STM051PC2DC024N	7-1589474-9	STM065PC2DX018N	2-1589475-1
STM037PC2DC012Q	3-1589474-5	STM051PC2DC030N	8-1589474-0	STM065PC2DX036N	2-1589475-2
STM037PC2DC015N	3-1589474-6	STM051PC2DC036N	8-1589474-1	STM065PC2DY012N	2-1589475-3
STM037PC2DC015Q	3-1589474-7	STM051PC2DC036Q	8-1589474-2	STM065PC2DY024N	2-1589475-4
STM037PC2DC018N	3-1589474-9	STM051PC2DC060N	8-1589474-3	STM065PC2GXM01N	2-1589475-5
STM037PC2DC020Q	4-1589474-0	STM051PC2DC060Q	8-1589474-4	STM065PC3DM006N	2-1589475-6
STM037PC2DC024	4-1589474-1	STM051PC2DCC20N	8-1589474-5	STM065PC3DX024N	2-1589475-7
STM037PC2DC024N	4-1589474-2	STM051PC2DM018N	8-1589474-6	STM065SC2DC003N	6-1589477-6
STM037PC2DC030N	4-1589474-3	STM051PC2DMM01N	8-1589474-7	STM065SC2DC006	6-1589477-7
STM037PC2DC036	4-1589474-4	STM051PC2DT012N	8-1589474-9	STM065SC2DC006N	6-1589477-8
STM037PC2DC036N	4-1589474-5	STM051PC2DT030N	9-1589474-0	STM065SC2DC012N	6-1589477-9
STM037PC2DC036Q	4-1589474-6	STM051PC2DT036N	9-1589474-1	STM065SC2DC012Q	7-1589477-0
STM037PC2DC048N	4-1589474-7	STM051PC2DT072N	9-1589474-2	STM065SC2DC015N	7-1589477-1
STM037PC2DC060Q	4-1589474-8	STM051PC2DX012N	9-1589474-3	STM065SC2DC018	7-1589477-2
STM037PC2DC072N	4-1589474-9	STM051PC2DX012Q	9-1589474-4	STM065SC2DC018N	7-1589477-3
STM037PC2DCC20Q	5-1589474-0	STM051PC2DX015N	9-1589474-5	STM065SC2DC018Q	7-1589477-4
STM037PC2DCC50N	5-1589474-1	STM051PC2DX018	9-1589474-6	STM065SC2DC024N	7-1589477-5
STM037PC2DCM01Q	5-1589474-2	STM051PC2DX018N	9-1589474-7	STM065SC2DC024Q	7-1589477-6
STM037PC2DM018N	5-1589474-3	STM051PC2DY015N	9-1589474-8	STM065SC2DC036HN	7-1589477-7
STM037PC2DM024M	5-1589474-4	STM051PC2GXM01N	9-1589474-9	STM065SC2DC036N	7-1589477-8
STM037PC2DM024N	5-1589474-5	STM051SC0DXC10N	4-1589477-5	STM065SC2DT030N	7-1589477-9
STM037PC2DT012N	5-1589474-7	STM051SC1DXC20	4-1589477-6		
STM037PC2DT030N	5-1589474-8	STM051SC2DC003N	4-1589477-7	Strip - Surface Mount & Thru Hole	
STM037PC2DX006N	5-1589474-9	STM051SC2DC006	4-1589477-8	USS004B2	0-1589451-1
STM037PC2DX010N	6-1589474-0	STM051SC2DC006N	4-1589477-9	USS004B2T	0-1589451-2
STM037PC2DX012N	6-1589474-1	STM051SC2DC012N	5-1589477-0	USS004C6	0-1589451-3
STM037PC2DX024N	6-1589474-2	STM051SC2DC015HN	5-1589477-1	USS004L2	0-1589451-4
STM037PC2GX006N	6-1589474-3	STM051SC2DC015N	5-1589477-2	USS004L2T	0-1589451-5
STM037PC3DC012N	6-1589474-4	STM051SC2DC016N	5-1589477-3	USS004M6	0-1589451-6
STM037SC0DXC10N	2-1589477-8	STM051SC2DC016N	5-1589477-4	USS009B2	0-1589451-3
STM037SC2DC006N	2-1589477-9	STM051SC2DC018HN	5-1589477-5	USS009B2T	0-1589451-4
STM037SC2DC006Q	3-1589477-0	STM051SC2DC018N	5-1589477-6	USS009B2Z	0-1589451-5
STM037SC2DC012N	3-1589477-1	STM051SC2DC018Q	5-1589477-7	USS009C6	0-1589451-6
STM037SC2DC015N	3-1589477-2	STM051SC2DC036N	5-1589477-8	USS009C6T	0-1589451-7
STM037SC2DC018HN	3-1589477-3	STM051SC2DC060N	5-1589477-9	USS009C6V	0-1589451-8
STM037SC2DC018N	3-1589477-4	STM051SC2DC060Q	5-1589477-0	USS009L2	0-1589451-9
STM037SC2DC020Q	3-1589477-5	STM051SC2DMM012N	6-1589477-0	USS009L2T	0-1589452-0
STM037SC2DC024N	3-1589477-6	STM051SC2DMM01N	6-1589477-1	USS009L2U	0-1589452-1
		STM051SC2DT030N	6-1589477-2	USS009L2V	0-1589452-2

Part Number Index -- Current Part Numbers

NANONICS Part Number	Tyco Part Number	NANONICS Part Number	Tyco Part Number	NANONICS Part Number	Tyco Part Number
USS009M6	0-1589454-2	USS009PC2DX001	2-1589448-9	USS051SC2DC012	5-1589449-8
USS015B2	0-1589451-8	USS009PC2DX004T	3-1589448-0		
USS015B2T	0-1589451-9	USS009PC2DX006T	3-1589448-1		
USS015C6	0-1589453-5	USS009PC2DX012	3-1589448-2		
USS015L2	0-1589452-7	USS009PC2GX006	3-1589448-3		
USS015L2T	0-1589452-8	USS009PC2GX012	3-1589448-4		
USS015L2V	0-1589452-9	USS009SC2DC004	2-1589449-0		
USS025B2	1-1589451-0	USS009SC2DC006	2-1589449-1		
USS025L2	1-1589452-0	USS009SC2DC006W	2-1589449-2		
USS037B2	1-1589451-1	USS009SC2DC006Z	2-1589449-3		
USS037L2	1-1589452-1	USS009SC2DC008	2-1589449-4		
USS037L2T	1-1589452-2	USS009SC2DC012	2-1589449-5		
USS051B2	1-1589451-3	USS009SC2DC012T	2-1589449-6		
USS051L2	1-1589452-3	USS009SC2DC012Z	2-1589449-7		
Strip - Wire Terminations					
USS004PC2DC003	0-1589448-1	USS009SC2DC018	2-1589449-8		
USS004PC2DC006	0-1589448-2	USS009SC2DC018T	2-1589449-9		
USS004PC2DC012	0-1589448-3	USS009SC2DC024	3-1589449-0		
USS004PC2DC012T	0-1589448-4	USS009SC2DC025T	3-1589449-1		
USS004PC2DC012U	0-1589448-5	USS009SC2DC036T	3-1589449-2		
USS004PC2DC024	0-1589448-6	USS009SC2DC036U	3-1589449-3		
USS004PC2DC036	0-1589448-7	USS009SC2DC036V	3-1589449-4		
USS004PC2DC036T	0-1589448-8	USS009SC2DC036W	3-1589449-5		
USS004PC2DCC30	0-1589448-9	USS009SC2DC060T	3-1589449-6		
USS004PC2DX006	1-1589448-1	USS009SC2DCC05T	3-1589449-7		
USS004PC2DX012	1-1589448-2	USS009SC2DCM01T	3-1589449-8		
USS004PC2GX006	1-1589448-3	USS009SC2DX004T	3-1589449-9		
USS004PC2GX024	1-1589448-4	USS009SC2DX006T	4-1589449-0		
USS004PC3DC018	1-1589448-5	USS009SC2DX012	4-1589449-1		
USS004SC2DC002	0-1589449-1	USS009SC2GX006	4-1589449-2		
USS004SC2DC003	0-1589449-2	USS009SC2GX012	4-1589449-3		
USS004SC2DC003T	0-1589449-3	USS009SC3DX004T	4-1589449-4		
USS004SC2DC004	0-1589449-4	USS010SC2DC006	4-1589449-5		
USS004SC2DC006	0-1589449-5	USS015PC2DC006	3-1589448-5		
USS004SC2DC012	0-1589449-6	USS015PC2DC012	3-1589448-6		
USS004SC2DC012T	0-1589449-7	USS015PC2DC012T	3-1589448-7		
USS004SC2DC012U	0-1589449-8	USS015PC2DC012V	3-1589448-8		
USS004SC2DC024	0-1589449-9	USS015PC2DC018	3-1589448-9		
USS004SC2DC036	1-1589449-0	USS015PC2DMC60T	4-1589448-0		
USS004SC2DC048	1-1589449-1	USS015PC2DX004T	4-1589448-1		
USS004SC2DCC30	1-1589449-2	USS015PC2DX012	4-1589448-2		
USS004SC2DX006	1-1589449-4	USS015PC2DX024T	4-1589448-3		
USS004SC2DX012T	1-1589449-5	USS015SC2DC006	4-1589449-6		
USS004SC2GX006	1-1589449-6	USS015SC2DC012	4-1589449-7		
USS004SC2GX024	1-1589449-7	USS015SC2DC012T	4-1589449-8		
USS004SC3DC018	1-1589449-8	USS015SC2DC036T	4-1589449-9		
USS004SC3DX004T	1-1589449-9	USS015SC2DMC60T	5-1589449-0		
USS009PC0DC006T	1-1589448-6	USS015SC2DX004T	5-1589449-1		
USS009PC2DC006	1-1589448-7	USS015SC2DX018T	5-1589449-2		
USS009PC2DC006W	1-1589448-8	USS015SC3DX004T	5-1589449-3		
USS009PC2DC012	1-1589448-9	USS025PC2DC006	4-1589448-4		
USS009PC2DC012T	2-1589448-0	USS025PC2DX018T	4-1589448-5		
USS009PC2DC012V	2-1589448-1	USS025SC2DC006	5-1589449-4		
USS009PC2DC018V	2-1589448-2	USS037PC1DXC20	4-1589448-6		
USS009PC2DC024	2-1589448-3	USS037PC2DC006	4-1589448-7		
USS009PC2DC036	2-1589448-4	USS037PC2DC020T	4-1589448-8		
USS009PC2DC036T	2-1589448-5	USS037SC1DXC20	5-1589449-5		
USS009PC2DC036U	2-1589448-6	USS037SC2DC006	5-1589449-6		
USS009PC2DC036V	2-1589448-7	USS037SC2DX006T	5-1589449-7		
USS009PC2DCC05T	2-1589448-8	USS051PC2DC012	5-1589448-0		
		USS051PC2DX012	5-1589448-1		