

PRODUCT NUMBER
SEE TABLE

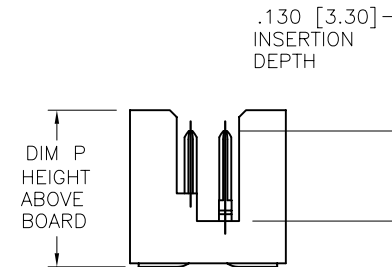
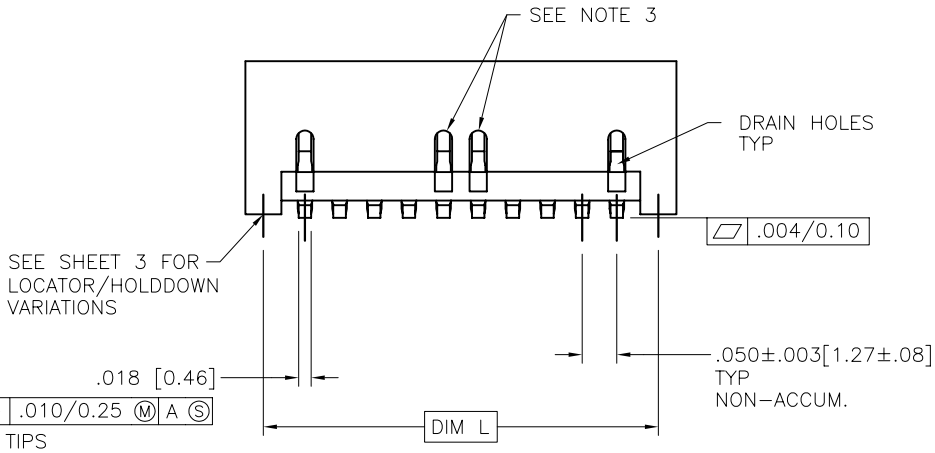
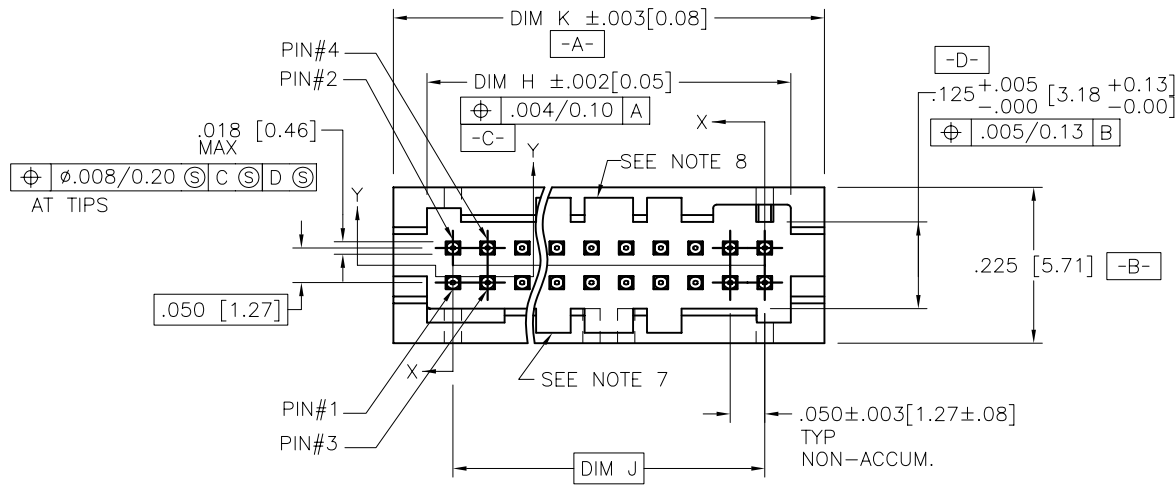

mat'l. code		surface		tolerance	projection		product family	
SEE NOTES				ISO 1302	ISO 406	RIB CAGE		
ltr	ecn no	dr	date	tolerances unless otherwise specified				title
T	v10994	CRG	3/15/01	angles	linear	INCH/MM		RIB CAGE III SMT VERT. HEADER ASS'Y
U	v11295	CRG	4/25/01	.XX ±.01/XX±.3			scale 1:1	
V	v10329	CRG	6/06/01	σ±2'	.XXX±.005/XX±0.13			
W	v04-0004	DAI	1/21/04	dr	M. CORNMAN	6/07/95		dwg no
X	M05-0084	MHT	5/05/05	engr	D. WHITING	6/07/95		sheet 1 of 6 size
Y	M06-0284	AEA	7/27/06	chr	D. WHITING	6/07/95		95781 A3
AA	M08-0245	MHT	8/27/08	appd	D. WHITING	6/07/95		type
sheet	revision	AA	AA	AA	AA	AA	AA	Product Customer Drawing
index	sheet	1	2	3	4	5	6	

PRODUCT NUMBER
SEE TABLE

SIZE	DIM H	DIM J	DIM K	DIM L
2X5	.275/6.99	.200/5.08	.372/9.45	.320/8.13
2X10	.525/13.34	.450/11.43	.622/15.80	.570/14.48
2X15	.775/19.68	.700/17.78	.872/22.15	.820/20.83
2X20	1.025/26.03	.950/24.13	1.122/28.50	1.070/27.18
2X25	1.275/32.38	1.200/30.48	1.372/34.85	1.320/33.53
2X30	1.525/38.74	1.450/36.83	1.622/41.20	1.570/39.88
2X35	1.775/45.08	1.700/43.18	1.872/47.55	1.820/46.23
2X40	2.025/51.43	1.950/49.53	2.122/53.90	2.070/52.58
2X45	2.275/57.78	2.200/55.88	2.372/60.25	2.320/58.93
2X50	2.525/64.14	2.450/62.23	2.622/66.60	2.570/65.28

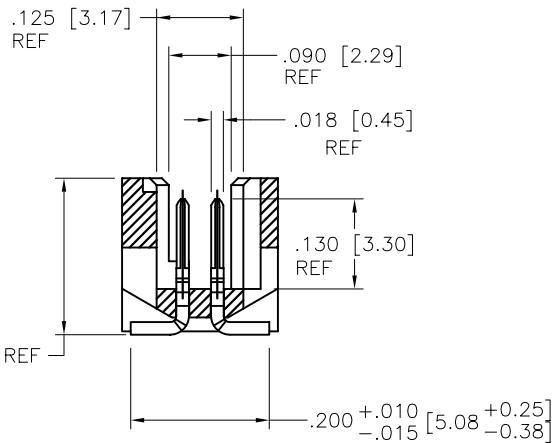

SECTION X-X
ROTATED 90° CW

⊕ .010/.25 ⊙ B

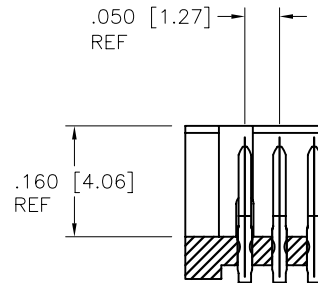

SECTION Y-Y

mat'l. code SEE NOTES		surface ISO 1302	tolerance ISO 406 ISO 1101	projection INCH/MM	product family RIB CAGE
ltr	ecn no	dr	date	tolerances unless otherwise specified	title
AA				angles linear XX ±01/XX±0.3 XXX±.005/XX±0.13 XXXXX±.0020/XXX±0.051	RIB CAGE III SMT VERT. HEADER ASS'Y
				σ±2'	scale 1:1
		dr	M. CORNMAN	6/07/95	dwg no
		enr	D. WHITING	6/07/95	95781
		chr	D. WHITING	6/07/95	sheet 2 of 6 size
		appd	D. WHITING	6/07/95	A3
sheet	revision				type
index	sheet				Product Customer Drawing

PRODUCT NUMBER
SEE TABLE

LOCATOR/HOLDDOWN VARIATIONS

STYLE 1

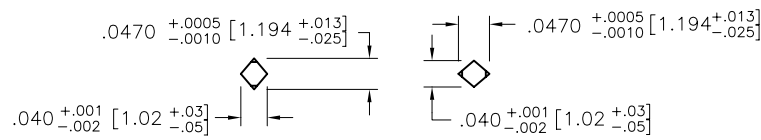
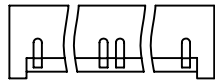

STYLE 2

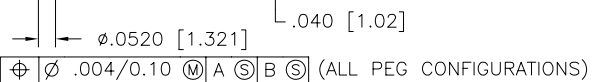
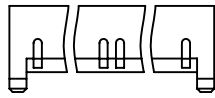

STYLE 6
SEE NOTE 9

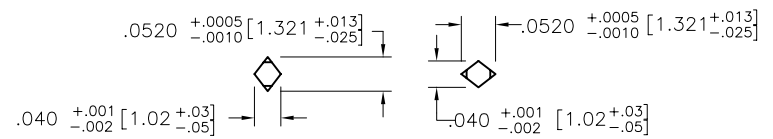
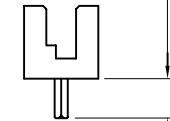
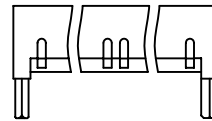

STYLE 3

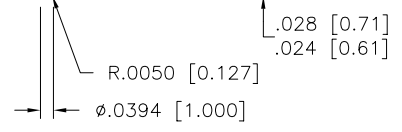
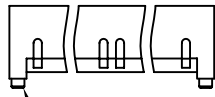

STYLE 7

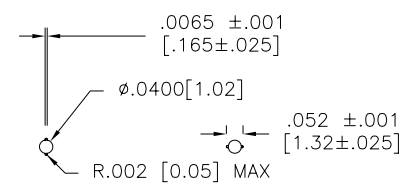
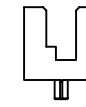
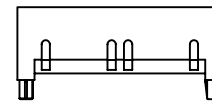

STYLE 4

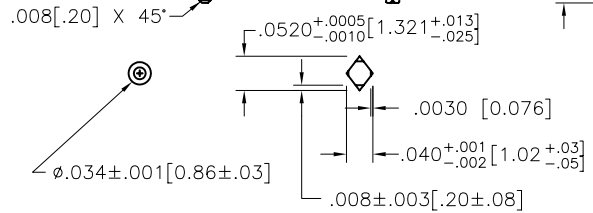
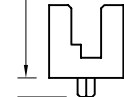
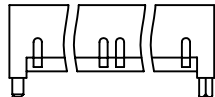

mat'l. code		surface		tolerance		projection		product family	
SEE NOTES		ISO 1302		ISO 406		ISO 1101		RIB CAGE	
ltr	ecm no	dr	date	tolerances unless otherwise specified		INCH/MM		title	
AA				angles	linear	.XX ±.01/XX±.03		RIB CAGE III SMT	
				σ±2		.XXX±.005/XX±0.13		VERT. HEADER ASS'Y	
						.XXXX±.0020/XXX±0.051		scale 1:1	
		dr	M. CORNMAN	6/07/95				dwg no	
		enr	D. WHITING	6/07/95	sheet 3 of 6 size				
		chr	D. WHITING	6/07/95	95781				
		appd	D. WHITING	6/07/95	A3				
sheet	revision					type		Product Customer Drawing	
index	sheet								

PRODUCT NUMBER
SEE TABLE

RECOMMENDED PCB MOUNTING PAD PATTERN

STYLE
1

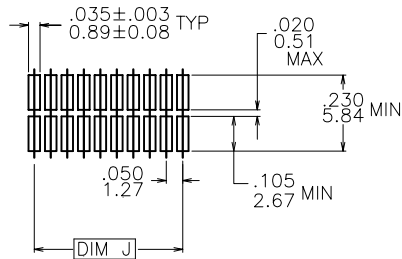

STYLE
5

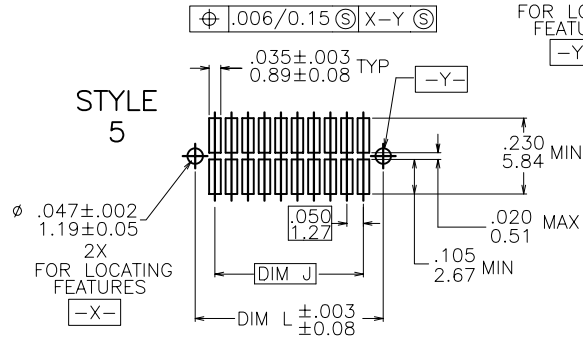

STYLE
4

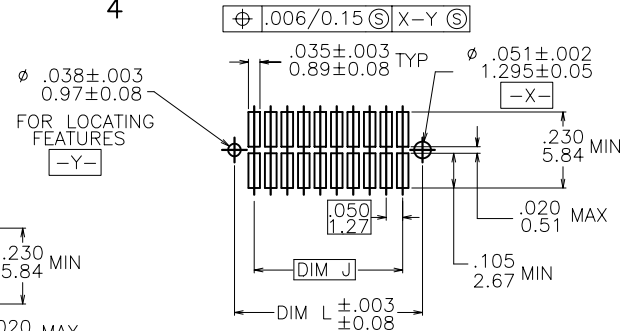

STYLE
6

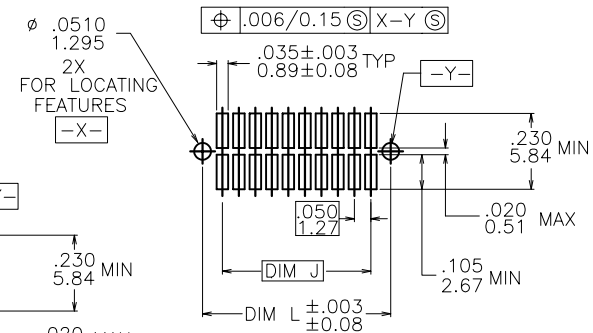

STYLE
2

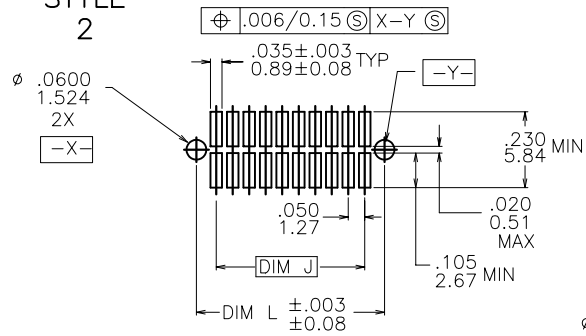

STYLE
7

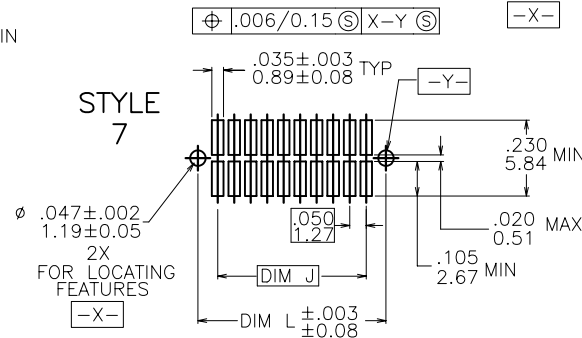

STYLE
3

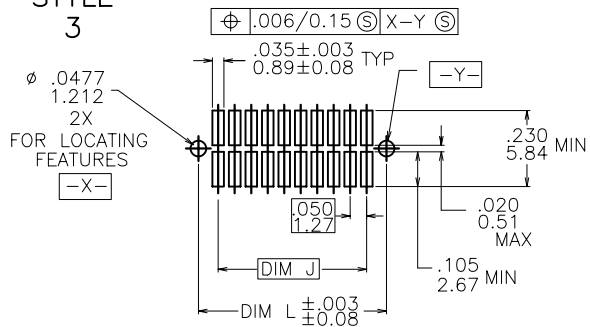

mat'l. code SEE NOTES		surface ISO 1302	tolerance ISO 406 ISO 1101	projection INCH/MM	product family RIB CAGE
ltr	ecn no	dr	date	title RIB CAGE III SMT VERT. HEADER ASS'Y	
AA				linear	scale 1:1
angles		σ±2'		dwg no 95781	
dr		M. CORNMAN		sheet 4 of 6 size A3	
engr		D. WHITING		type Product Customer Drawing	
chr		D. WHITING			
appd		D. WHITING			
sheet	revision				
index	sheet				



Copyright FCI

PRODUCT NUMBER NOTE 1,4A & 4B	DIM P HEIGHT ABOVE BOARD (REF.)	HOLDDOWN STYLE
72428-1XX	.244/6.20	1
73546-1XX	.364/9.25	1
73547-1XX	.364/9.25	2
73548-1XX	.364/9.25	4
84700-1XX	.226/5.74	7
84701-1XX	.298/7.57	7
84734-1XX	.364/9.25	7
87401-1XX	.226/5.74	6
87409-1XX	.226/5.74	2
87849-1XX	.226/5.74	1
88566-1XX	.260/6.60	2
90098-1XX	.298/7.57	2
90863-1XX	.226/5.74	1
91036-1XX	.364/9.25	5
91423-1XX	.226/5.74	2
91855-1XX	.226/5.74	5
92099-1XX	.226/5.74	4
92412-1XX	.298/7.57	4
93206-1XX	.226/5.74	3
93221-1XX	.298/7.57	1
93289-1XX	.298/7.57	5

TABLE A

* CUSTOMER SPECIAL

SEE NOTE 10

*

NOTES:

- ① XXXX-XXXLF
LEAD FREE OPTION (NOTE 11& 13)
NUMBER OF POSITIONS (NOTE 2)
- ② NUMBER OF POSITIONS = 05 THRU 50 IN 5 POS INCREMENTS.
(EXAMPLE : 105=10 POS., 110=20 POS. ETC.)
- ③ REQUIRED ON -X40,-X45 & -X50 POSITION PARTS ONLY.
- 4. PACKAGING :
A. ANTISTATIC TUBES. SEE TABLE A
B. ADD "CT" TO END OF DASH NUMBER FOR CONNECTOR WITH VACUUM CAP IN ANTISTATIC TUBES.
EX. : XXXX-1XXCT
C. PRESSURE SEALED TAPE AND REEL. SEE TABLE C FOR AVAILABLE PART NUMBERS.
- ⑤ HOUSING MATERIAL :
GLASS FILLED THERMOPLASTIC FLAME RETARDANT PER UL 94V-0.
COLOR : BLACK
- ⑥ TERMINAL PLATING :
30u"/.76u HARD Au OVER 50u"/1.27u Ni ON CONTACT ZONES.
100u"/2.54u TIN LEAD OVER 50u"/1.27u Ni IN SOLDERING ZONES.
LEAD FREE OPTION:
30u"/.76u HARD Au OVER 50u"/1.27u Ni ON CONTACT ZONES.
100u"/2.54u PURE TIN OVER 50u"/1.27u Ni IN SOLDERING ZONES.
- ⑦ MOLDING FLOW RESTRICTOR QUANTITY AND LOCATION IS MANUFACTURING OPTION.
- ⑧ VACUUM CAP SLOT REQUIRED ON ALL SIZES, SLOT MAY BE LOCATED ON OPPOSITE SIDE FOR 2 X 5.
- ⑨ STYLE 6 IS NOT AVAILABLE IN TAPE AND REEL.
- ⑩ 90863-1XX IS PACKAGED ONLY IN TAPE AND REEL.
- ⑪ ADD LF SUFFIX AT THE END OF PART NUMBER FOR LEAD FREE OPTION.
- 12. THE HOUSING WILL WITHSTAND EXPOSURE TO 260°C PEAK TEMPERATURE FOR 20 SECONDS IN A CONVECTION, INFRA-RED OR VAPOR PHASE REFLOW OVEN. SEE APPLICATION NOTE/PROCEDURES IF THEY ARE AVAILABLE.
- ⑬ THIS PRODUCT MEETS EUROPEAN UNION DIRECTIVES AND OTHER COUNTRY REGULATION AS DESCRIBED IN GS-22-008.

mat'l. code SEE NOTES		surface ISO 1302	tolerance ISO 406 ISO 1101	projection 	product family RIB CAGE
ltr	ecn no	dr	date	tolerances unless otherwise specified	title
AA				angles linear XX ±01/XX±0.3 XXX±.005/XX±0.13 XXXX±.0020/XXX±0.051	RIB CAGE III SMT VERT. HEADER ASS'Y
				σ±2'	INCH/MM scale 1:1
		dr	M. CORNMAN	6/07/95	dwg no
		enr	D. WHITING	6/07/95	sheet 5 of 6 size
		chr	D. WHITING	6/07/95	95781
		appd	D. WHITING	6/07/95	A3
sheet	revision				type Product Customer Drawing
index	sheet				

PRODUCT NUMBER NOTE 11,4C	QTY. REEL	TAPE WIDTH PITCH MM	CONNECTOR ORIENTATION IN TAPE POCKET
72428-120TR	500	44/12	VIEW 1
73547-110TR		24/12	
84700-105TR		24/12	
84700-135TR		56/12	
87409-115TR		44/12	
87409-120TR		44/12	
87409-125TR		56/12	
87409-130TR		56/12	
87409-140TR		72/12	
87849-110TR		24/12	
87849-115TR		44/12	
87849-120TR		44/12	
87849-125TR		56/12	
87849-130TR	500	56/12	
88566-110TR	750	24/12	
88566-115TR	500	44/12	
88566-130TR	500	56/12	
90863-110		24/12	
90863-115		44/12	VIEW 1
90863-115REV		44/12	VIEW 2 *
90863-120		44/12	VIEW 1
90863-125		56/12	
90863-130		56/12	
91036-110P		24/16	
93206-115TR		44/12	
93221-105TR		24/12	
93221-110TR		32/12	
93221-125TR	500	56/12	VIEW 1

TABLE C

* CUSTOMER SPECIAL
NO VACUUM CAP

REFERENCE ONLY :

TAPE WIDTH 32mm AND ABOVE HAS BOTH FEED TRACKS,
BELOW 32mm HAS TOP FEED TRACK ONLY.

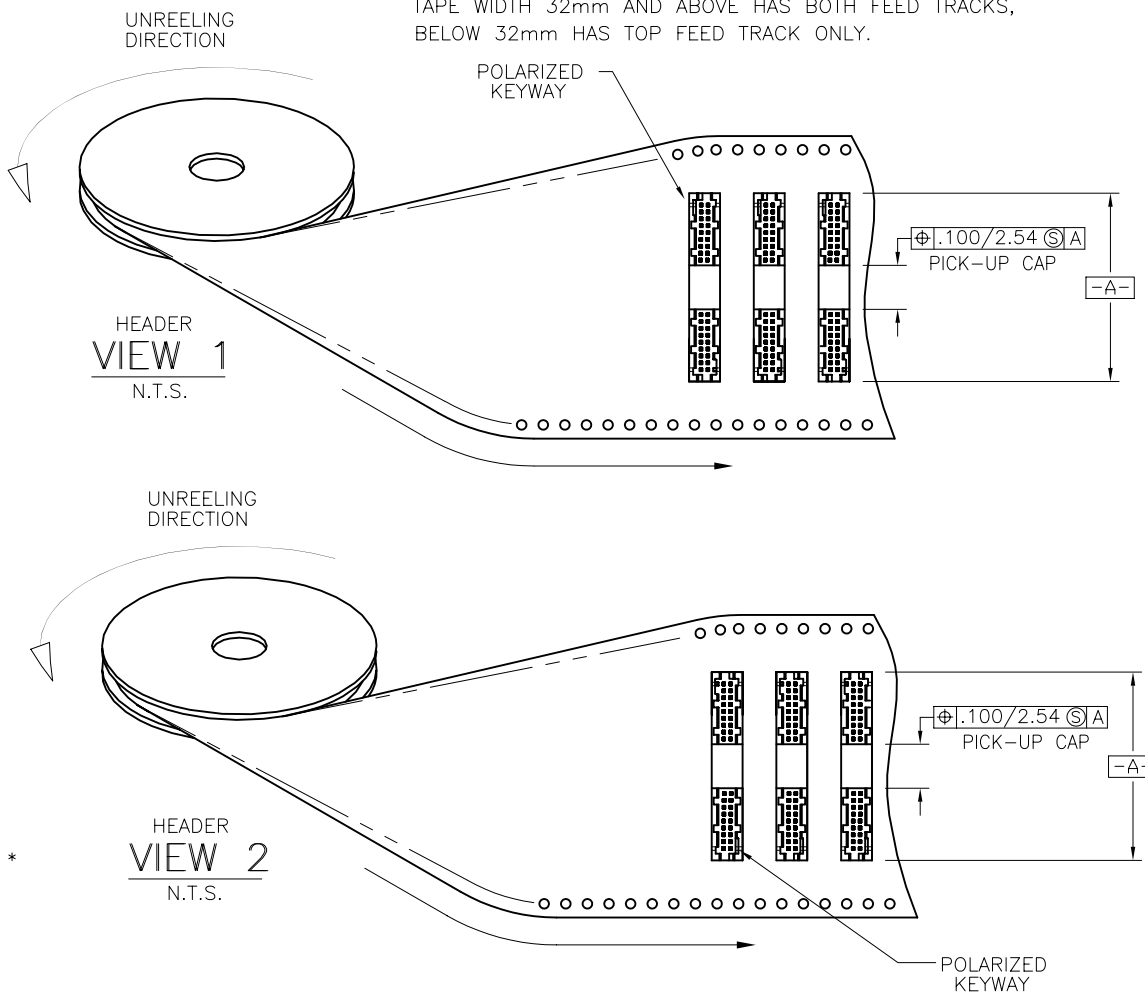

mat'l. code SEE NOTES		surface ISO 1302	tolerance ISO 406 ISO 1101	projection INCH/MM	product family RIB CAGE
ltr	ec'n no	dr	date	tolerances unless otherwise specified	title
AA				angles linear XX ±.01/XX±0.3 XXX±.005/XXX±0.13 XXXX±.0020/XXX±0.051	RIB CAGE III SMT VERT. HEADER ASS'Y
				σ±2'	scale 1:1
		dr	M. CORNMAN	6/07/95	dwg no
		engr	D. WHITING	6/07/95	95781
		chr	D. WHITING	6/07/95	sheet 6 of 6 size
		appd	D. WHITING	6/07/95	A3
sheet	revision				type
index	sheet				Product Customer Drawing