

Specification Status: Released

Maximum Electrical Rating

Operating Voltage: 16Vdc

Interrupt Current: 100A

Chip Size: 2.8 X 9.6mm

Leads: Nickel 1/2H
0.125mm nominal thickness

Tape: None

Solder: Lead-free

Marking:

□□□□ — Lot Identification

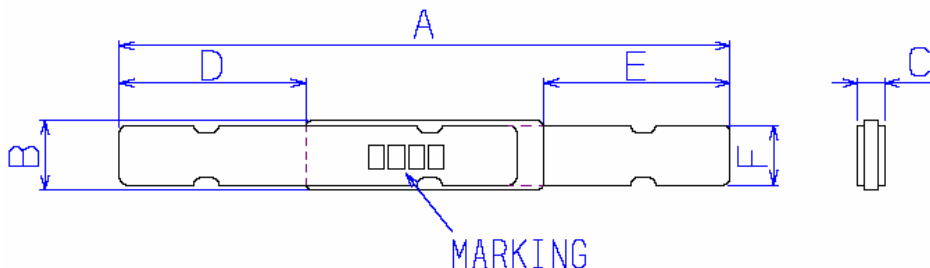

TABLE I. DIMENSIONS:

	A		B		C		D		E		F	
	MIN	MAX	MIN	MAX	MIN	MAX	MIN	MAX	MIN	MAX	MIN	MAX
mm:	23.6	25.6	2.7	2.9	---	0.7	7.0	8.0	7.0	8.0	2.3	2.5
in*:	(0.93)	(1.01)	(0.11)	(0.11)	--	(0.03)	(0.28)	(0.31)	(0.28)	(0.31)	(0.09)	(0.10)

*Rounded off approximation

TABLE II. PERFORMANCE RATINGS: As measured in Mueller Kelvin Clips model BU-75K.

I HOLD	CURRENT TRIP LIMITS								TIME TO TRIP		REFERENCE RESISTANCE		ONE-HOUR POST-TRIP RESISTANCE		TRIPPED-STATE POWER DISSIPATION
AMPS 25°C HOLD	AMPS AT 0°C HOLD TRIP		AMPS AT 25°C HOLD TRIP		AMPS AT 60°C HOLD TRIP		AMPS AT --°C HOLD TRIP		SECONDS AT 20°C, 5.5A MIN MAX		OHMS AT 25°C MIN MAX		OHMS AT 25°C MIN MAX		WATTS AT 25°C, 16V MAX
1.1	1.4	3.4	1.1	2.7	0.7	1.7	---	---	---	5	0.038	0.070	0.038	0.140	1.3

Agency Recognitions:
Reference Documents:
Precedence:
Effectivity:
CAUTION:

UL, TUV, CSA
PS300

This specification takes precedence over documents referenced herein.

Reference documents shall be the issue in effect on the date of invitation for bid.

Operation beyond the rated voltage or current may result in rupture, electrical arcing or flame.

Materials Information:

ROHS Compliant

ELV Compliant

Pb-Free

Directive 2000/53/EC
Compliant

Directive 2002/95/EC
Compliant

