

THIS DRAWING IS UNPUBLISHED. RELEASED FOR PUBLICATION
 © COPYRIGHT BY TYCO ELECTRONICS CORPORATION. ALL RIGHTS RESERVED.

LOC	DIST	REVISIONS			
P	LTR	DESCRIPTION	DATE	DWN	APVD
DW	-	REVISED (ECR-09-010844), OBSOLETE -4, 1-4, 2-3, 2-4, 2-5, 3-4	18MAY2009	SC	WK

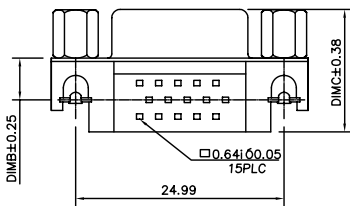

FOR P/N: X-1775046-4

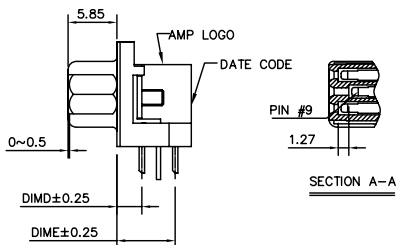
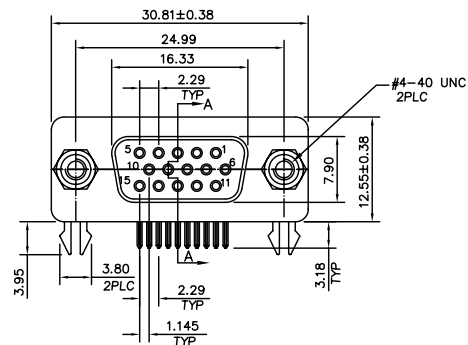
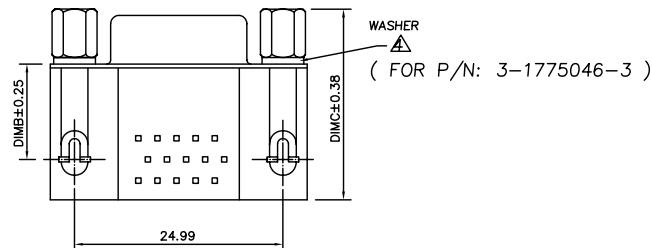

FOR P/N: X-1775046-3
X-1775046-5

NOTES:

- MATERIAL:
 - 1.1 HOUSING/COVER: THERMOPLASTIC(PBT), UL94V-0; COLOR: SEE TABLE
 - 1.2 CONTACTS AND BOARDLOCK: BRASS
 - 1.3 SHELL/WASHER: SPCC-SD, JIS G3141
 - 1.4 RIVET/SCREW: BRASS C3604
- FINISH:
 - 2.1 CONTACT:
 - GOLD PLATING (SEE TABLE) ON CONTACT AREA
 - 2.54um[100u"] MIN. MATTE TIN PLATING ON SOLDER TAIL
 - 1.27um[50u"] MIN. NICKEL UNDERPLATED OVERALL
 - 2.2 BOARDLOCK:
 - 2.54um[100u"] MIN. BRIGHT TIN PLATING
 - 2.032um[80u"] MIN. NICKEL UNDERPLATED OVERALL
 - 2.3 SHIELD, RIVET/SCREW AND WASHER:
 - 2.032um[80u"] MIN. NICKEL PLATED

- △ P/N: 2-3 ~ 2-5 WITH 2PCS SCREWS PACKAGED SEPARATELY FROM CONNECTOR
- △ P/N: 3-3 ASSEMBLED WITH 2PCS WASHER&SCREW
- 5. WAVE SOLDER CAPABLE TO 265°C, PER TE SPEC. 109-202, CONDITION B.
- 6. RECOMMENDED PCB THICKNESS: 1.0~1.8mm
- △ DIM H AND J ARE ESTABLISHED BY CUSTOMER

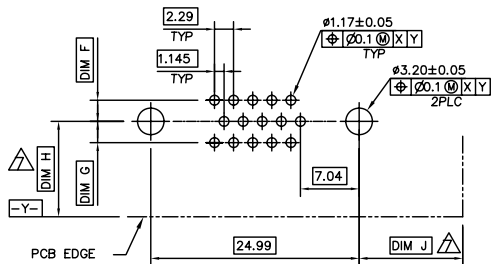

RECOMMENDED P.C.B. LAYOUT
RECOMMENDED P.C.B. THK=1.0~1.8mm

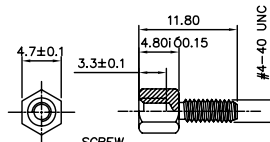

FOR P/N: 2-1775046-X

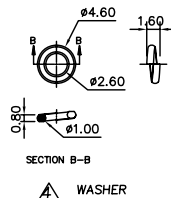

STATUS	PLATING	FINISH	COLOR	PART NUMBER
OBSOLETE	15u"	W/	BLUE/661C	3-1775046-4
	G/F	△W/	BLUE/661C	3-1775046-3
	G/F	△W/	BLACK	2-1775046-5
OBSOLETE	G/F	△W/	BLUE/661C	2-1775046-4
	G/F	△W/	BLUE/661C	2-1775046-3
NO PRODUCTION	G/F	△W/	LIGHT BLUE/611C	2-1775046-2
	G/F	△W/	LIGHT BLUE/611C	2-1775046-1
OBSOLETE	G/F	W/O	BLUE/661C	1-1775046-4
	G/F	W/O	BLUE/661C	1-1775046-3
NO PRODUCTION	G/F	W/O	LIGHT BLUE/611C	1-1775046-2
	G/F	W/O	LIGHT BLUE/611C	1-1775046-1
	G/F	W/	BLACK	1775046-5
OBSOLETE	G/F	W/	BLUE/661C	1775046-4
	G/F	W/	BLUE/661C	1775046-3
NO PRODUCTION	G/F	W/	LIGHT BLUE/611C	1775046-2
	G/F	W/	LIGHT BLUE/611C	1775046-1

DIM G	DIM F	DIM E	DIM D	DIM C	DIM B	PART NUMBER
2.54	2.54	13.97	8.89	22.70	11.43	3-1775046-3 △
2.54	2.54	13.97	8.89	21.90	11.43	X-1775046-5
2.00	2.00	7.08	3.08	14.88	5.08	X-1775046-1 NO PRODUCTION
						X-1775046-4 NO PRODUCTION
						X-1775046-2 NO PRODUCTION

THIS DRAWING IS A CONTROLLED DOCUMENT.

DWN	S. CHIEN	18MAY2009	Tyco Electronics Corporation Tyco Electronics Corporation Taipei, Taiwan	
CHK	S. CHIEN	18MAY2009	NAME	
APVD	W. KODAMA	18MAY2009	D-SUB, 15P RECEPTACLE, RIGHT ANGLE	
PRODUCT SPEC			SIZE	CAGE CODE
APPLICATION SPEC			DRAWING NO	RESTRICTED TO
WEIGHT			A300779	©=1775046
CUSTOMER DRAWING			SCALE	SHEET 1 of 2
				REV B

4 3 2 1

THIS DRAWING IS UNPUBLISHED. RELEASED FOR PUBLICATION
 © COPYRIGHT BY TYCO ELECTRONICS CORPORATION. ALL RIGHTS RESERVED.

LOC	DIST	REVISIONS			
P	LTR	DESCRIPTION	DATE	DWN	APVD
DW	-	SEE SHEET 1.			

NOTES:

- MATERIAL:
 TRAY: PVC
 SHIPPING BOX: CORRUGATED FIBERBOARD
- DIMENSION:
 FOR P/N: X-3, -5
 TRAY: 356mm(L) x 241mm(W) x 26.8mm(H)
 SHIPPING BOX: 363mm(L) x 248mm(W) x 275mm(H)
 FOR P/N: X-4
 TRAY: 356mm(L) x 241mm(W) x 19.0mm(H)
 SHIPPING BOX: 363mm(L) x 248mm(W) x 195mm(H)
- PRODUCT QUANTITY:
 100 PCS/TRAY
 10 TRAYS/SHIPPING BOX (=1,000 PCS)
 SCREW QTY: FOR P/N: 2-3 ~ 2-5
 2,000PCS/SHIPPING BOX

TOP COVER
LABEL

TRAY

SHIPPING BOX
LABEL

TAPE

THIS DRAWING IS A CONTROLLED DOCUMENT.		DWN		Tyco Electronics Corporation	
DIMENSIONS: MM		CHK		Tyco Electronics Taipei, Taiwan	
TOLERANCES UNLESS OTHERWISE SPECIFIED:		APVD		NAME	
0 PLC ± -		PRODUCT SPEC		D-SUB, 15P RECEPTACLE, RIGHT ANGLE	
1 PLC ± -		APPLICATION SPEC		SIZE CAGE CODE DRAWING NO RESTRICTED TO	
2 PLC ± -		WEIGHT		A3 00779 C=1775046 -	
3 PLC ± -		CUSTOMER DRAWING		SCALE SHEET REV	
4 PLC ANGLES ± -				- 2 of 2 B	
MATERIAL FINISH					

AMP 1470-19 REV 31MAR2000