

SCALE DRAWING 1:1

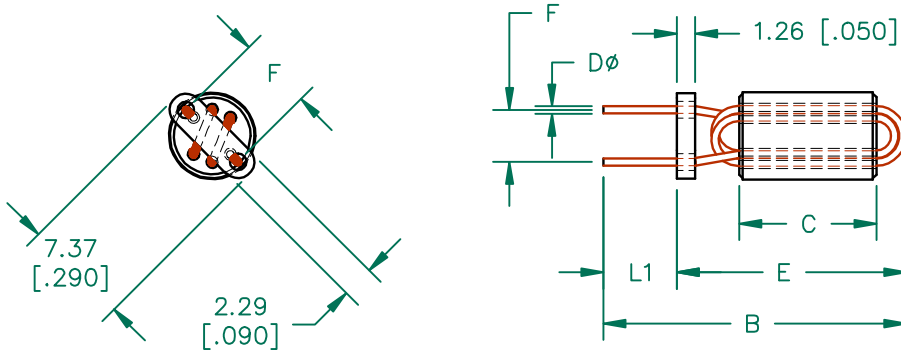
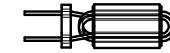

ELECTRICAL TESTING

TEST:	Z	Z
# TURNS	3	3
AWG	#24	#24
FREQUENCY	25 MHz	100 MHz
NOMINAL	605 Ω	998 Ω
MINIMUM	- Ω	749 Ω
MAXIMUM	- Ω	- Ω

Z, R, X vs Frequency

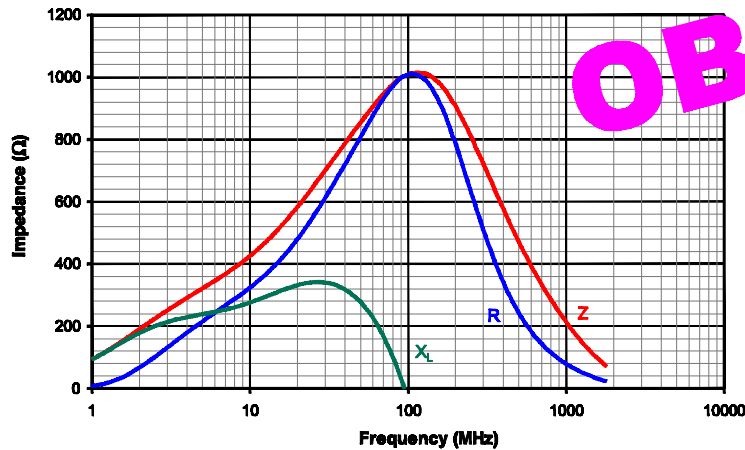

OBSOLETE

NOTES:

1. WIRE: COPPER 24 AWG 0.51 [.0201] DIAMETER.
2. PLATING: 100% TIN $5\mu \pm 2\mu$ [$200\mu\text{in} \pm 80\mu\text{in}$]
3. LEADS:
 - A. LEADS SOLDERABILITY CONFORMS TO MIL-STD-202, METHOD 208.
4. REF. STEWARD CORE P/N 28C0236-000.
5. WEIGHT/1000 1.22 kgs. 2.7 lbs.

DIMENSIONS:

A	6.00 [.236]	±	0.13 [.005]
B	20.96 [.825]		MAX
C	10.01 [.394]	±	0.25 [.010]
D	0.51 [.020]		TYP.
E	15.90 [.625]		MAX.
F	5.08 [.200]	±	0.64 [.025]
L1	5.08 [.200]	±	1.27 [.050]

DIMENSIONS ARE IN mm [INCHES].

THIS DOCUMENT CONTAINS INFORMATION WHICH IS PROPRIETARY AND CONFIDENTIAL TO STEWARD. NO PRODUCTION OR PUBLICATION OF THIS DOCUMENT IN WHOLE OR IN PART SHALL BE MADE WITHOUT WRITTEN AUTHORIZATION FROM STEWARD.

Steward

N	CHG TOLS ON B DIM TO MAX	04/06/06	JRK				
M	CORRECT NOTE 5	07/07/05	JRK				
L	CHG P/N TO -10 REV NOTE 2 ADD NOTE 5	10/07/03	JRK	PROJECT/PART NUMBER: 28C0236-0JW-10			
K	CHANGE DIM F TO L1, CHANGE DIM G TO F	09/23/02	JRK	REV: N	PART TYPE: ASSEMBLY	DRAWN BY: DJB	
J	UPDATE FORMAT PRINT FOR ELECTRONIC DATABASE UPDATE NOTES	01/08/02	TMB	DATE: 01/28/92	SCALE: 2 : 1	MATERIAL: STEWARD 28	
REV	DESCRIPTION	DATE	INT	CAD # 28C0236-0JW-10-N	TOOL # C0236		