

| LOC | DIST | REVISIONS |     |                           |         |     |      |
|-----|------|-----------|-----|---------------------------|---------|-----|------|
|     |      | P         | LTR | DESCRIPTION               | DATE    | DWN | APVD |
| J   |      |           | A   | REVISED ECR-09-015031     | 20OCT09 | A.Z | S.Y  |
|     |      |           | A1  | REVISED PER ECO-09-024927 | 09NOV09 | KK  | AEG  |

30,34,50 POS      40,48,60,96 POS

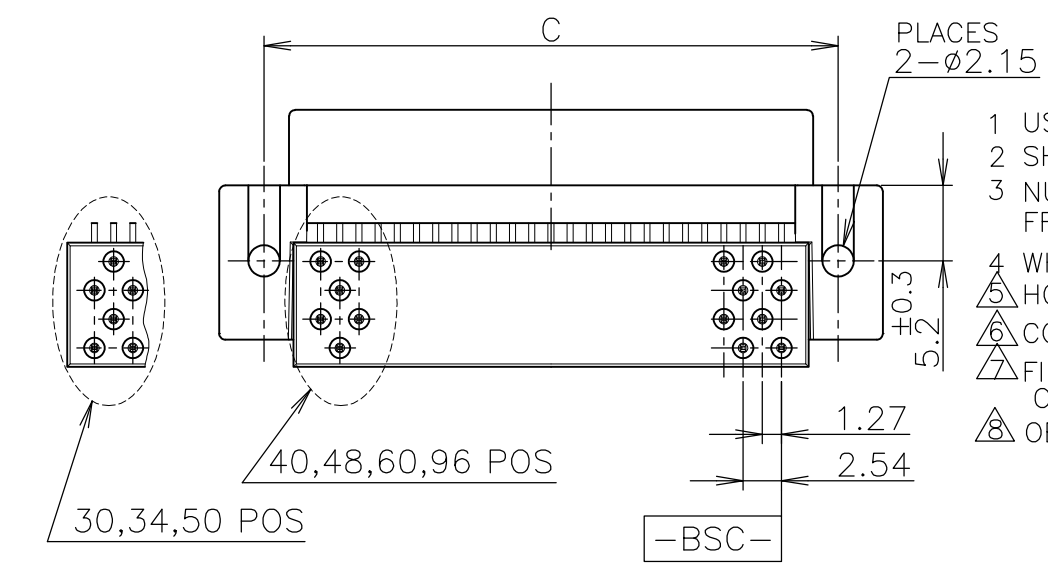
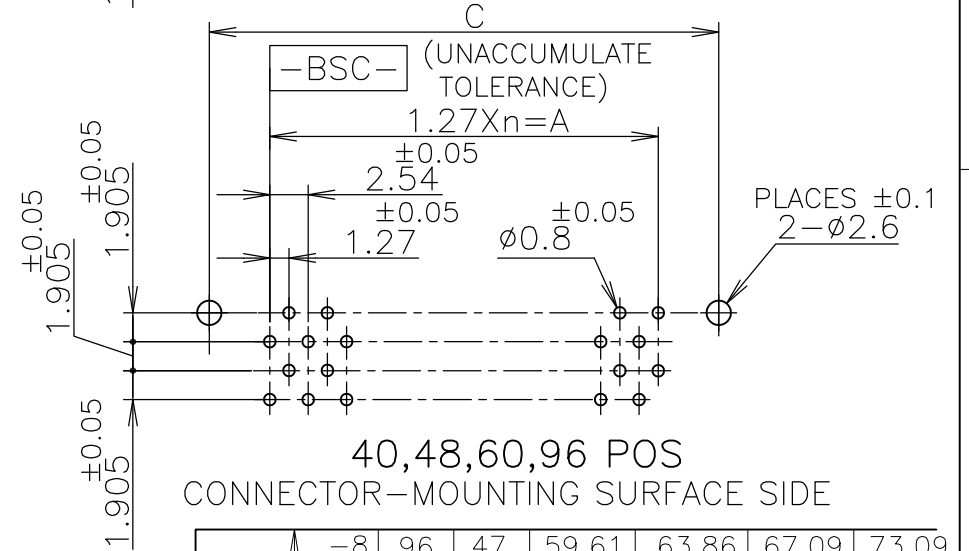
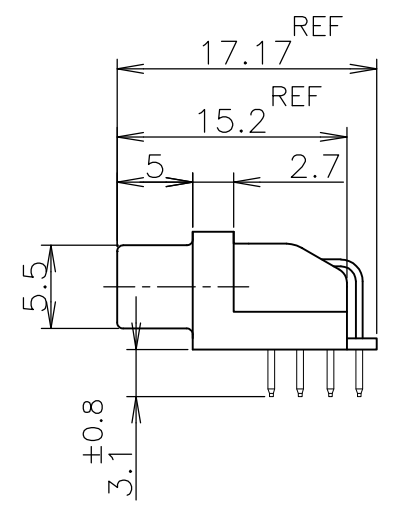
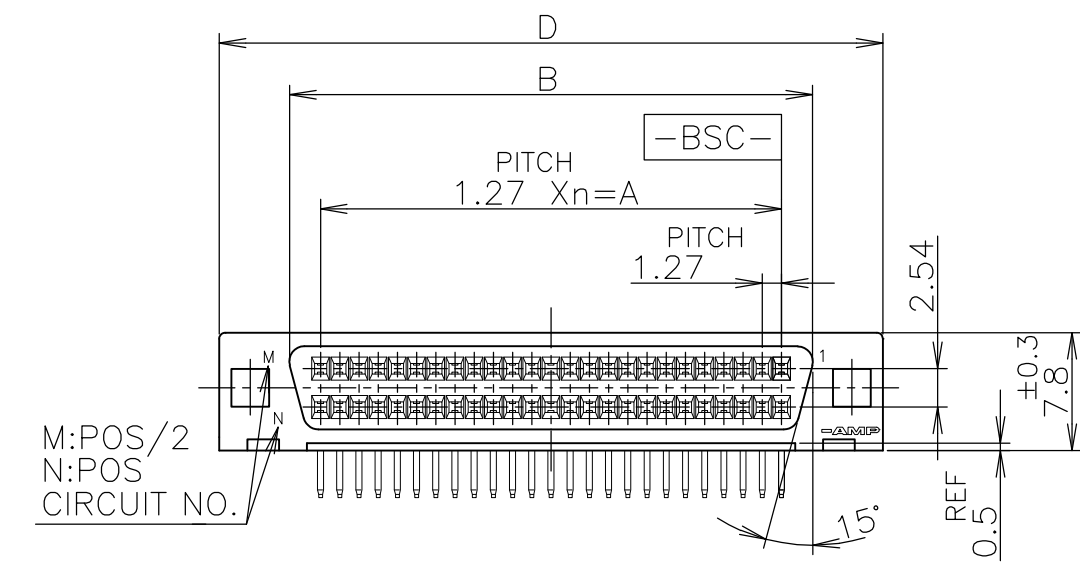
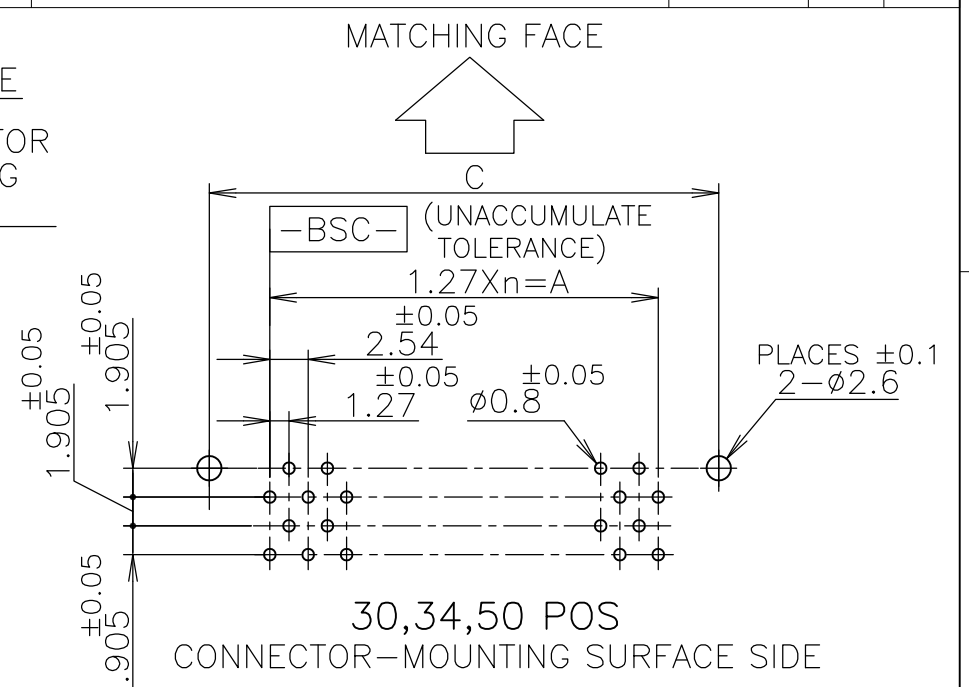
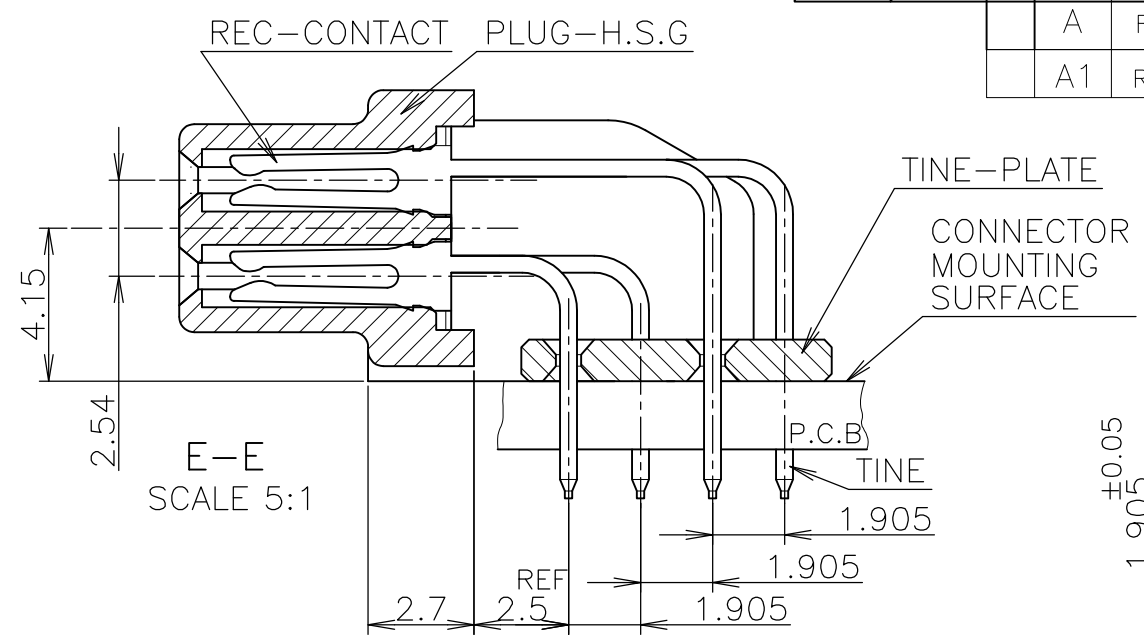
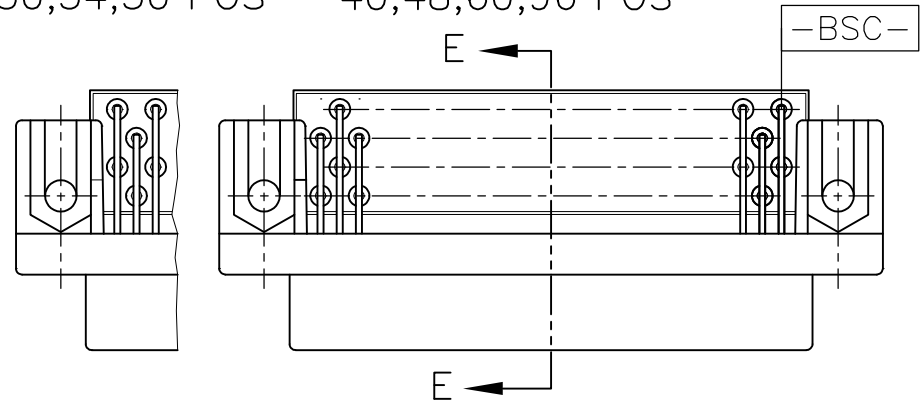

- 1 USE A P.C.B. WHOSE SURFACES ARE TREATED WITH SOLDER RESIST.
  - 2 SHOW P.C.B LAYOUT FROM THE CONNECTOR-MOUNTING SURFACE SIDE.
  - 3 NUMBER THE CONTACTS IN THE P.C.B OR CONNECTOR CONSECUTIVELY FROM THE -BSC- SIDE.
  - 4 WHEN SCREWING THE CONNECTOR TO THE P.C.B, USE M2 SCREW, NUT AND WASHERS.
- △ HOUSING MATERIAL : GLASS 20% FILLED P.B.T RESIN (UL94-V0). COLOR:BLACK
  - △ CONTACT MATERIAL : PHOSPHOR BRONZE.
  - △ FINISH : NICKEL 0.00127 MIN THK OVERALL SELECTIVE GOLD 0.0002 MIN THK ON CONTACT AREA AND TIN 0.001MIN THK ON TINE AREA.
  - △ OBSOLETE PARTS: OBSOLETE CIS STREAMLINING PER D.RENAUD/D.SINISI

|  |           |     |    |       |       |       |       |
|--|-----------|-----|----|-------|-------|-------|-------|
|  | -8        | 96  | 47 | 59.61 | 63.86 | 67.09 | 73.09 |
|  | -6        | 48  | 23 | 29.21 | 33.38 | 36.61 | 42.61 |
|  | -5        | 34  | 16 | 20.32 | 24.49 | 27.72 | 33.72 |
|  | -4        | 60  | 29 | 36.83 | 41.00 | 44.23 | 50.23 |
|  | -3        | 50  | 24 | 30.48 | 34.65 | 37.88 | 43.88 |
|  | -2        | 40  | 19 | 24.13 | 28.30 | 31.53 | 37.53 |
|  | 5173277-1 | 30  | 14 | 17.78 | 21.95 | 25.18 | 31.18 |
|  | P/N       | POS | n  | A     | B     | C     | D     |

LEAD FREE

| GENERAL TOLERANCE |       |
|-------------------|-------|
| 10 ≥              | ±0.2  |
| 30 ≥ > 10         | ±0.25 |
| 100 ≥ > 30        | ±0.3  |
| ANGLES: ±3°       |       |

|   |  |                  |            |           |  |
|---|--|------------------|------------|-----------|--|
| THIS DRAWING IS A CONTROLLED DOCUMENT.                                      |  | DWN              | COREL WANG | 20AUG04   | Tyco Electronics AMP K.K.<br>Kawasaki, Japan                 |
| DIMENSIONS: MM  |  | CHK              | STEVEN YAO | 23AUG04   |  |
| TOLERANCES UNLESS OTHERWISE SPECIFIED:                                      |  | APVD             | I.ENOMOTO  | 23AUG04   |  |
| 0 PLC ±<br>1 PLC ±<br>2 PLC ±<br>3 PLC ±<br>4 PLC ±<br>ANGLES ±<br>FINISH △ |  | PRODUCT SPEC     | 108-60036  |           |  |
| MATERIAL 参照 △△  |  | APPLICATION SPEC | 108-60036  |           | NAME   |
| CUSTOMER DRAWING  |  | WEIGHT           |            |           | PLUG ASSY HORIZONTAL<br>AMPLIMITE .050 SERIES I B-TO-B CONN. |
|   |  | SIZE             | A3         | CAGE CODE | 00779  |
|   |  | DRAWING NO       | G-5173277  |           | RESTRICTED TO  |
|   |  | SCALE            | 2:1        |           | SHEET 1 OF 2   |
|   |  | REV              | A1         |           |  |

| P | LTR | DESCRIPTION            | DATE | DWN | APVD |
|---|-----|------------------------|------|-----|------|
| - | -   | SEE SHEET SHEET 1 OF 3 | -    | -   | -    |

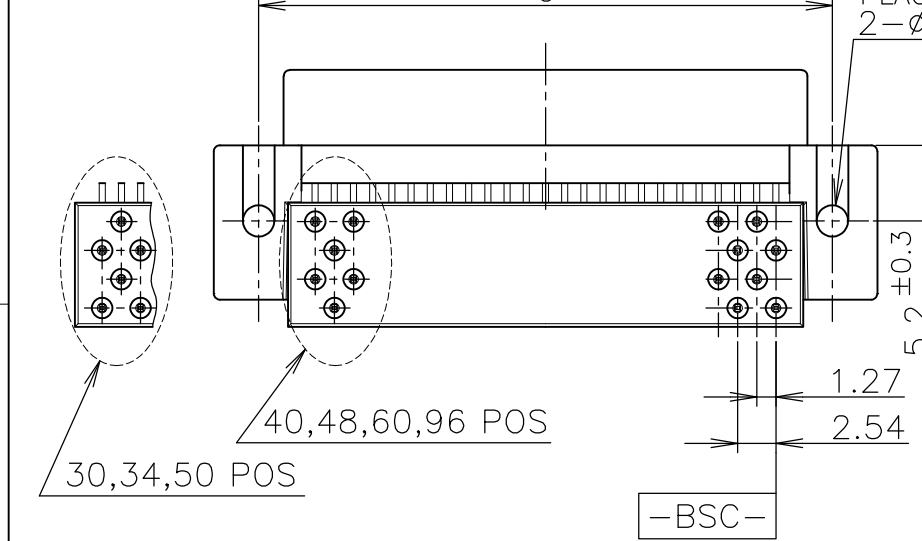
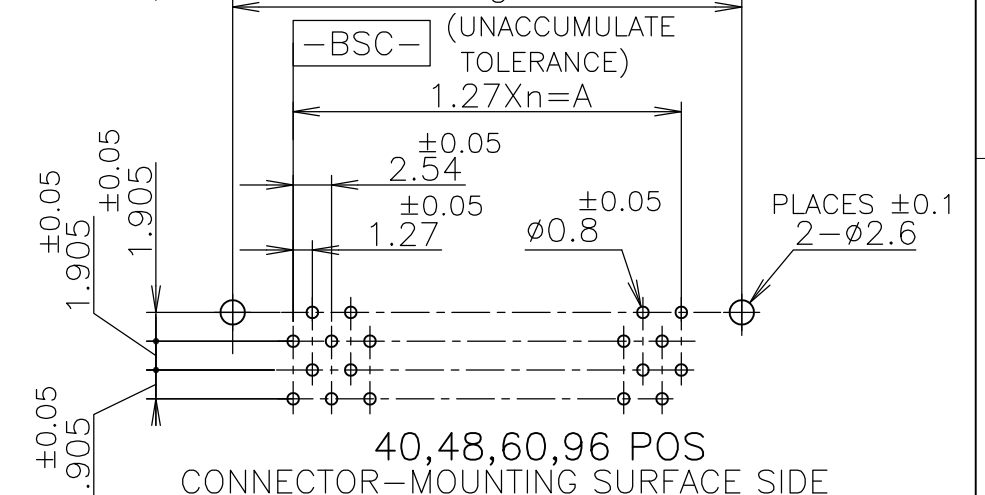
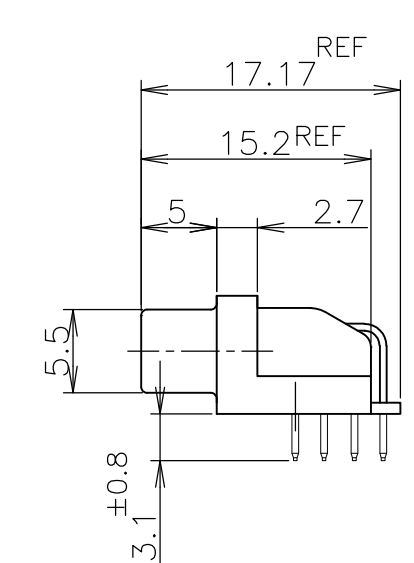
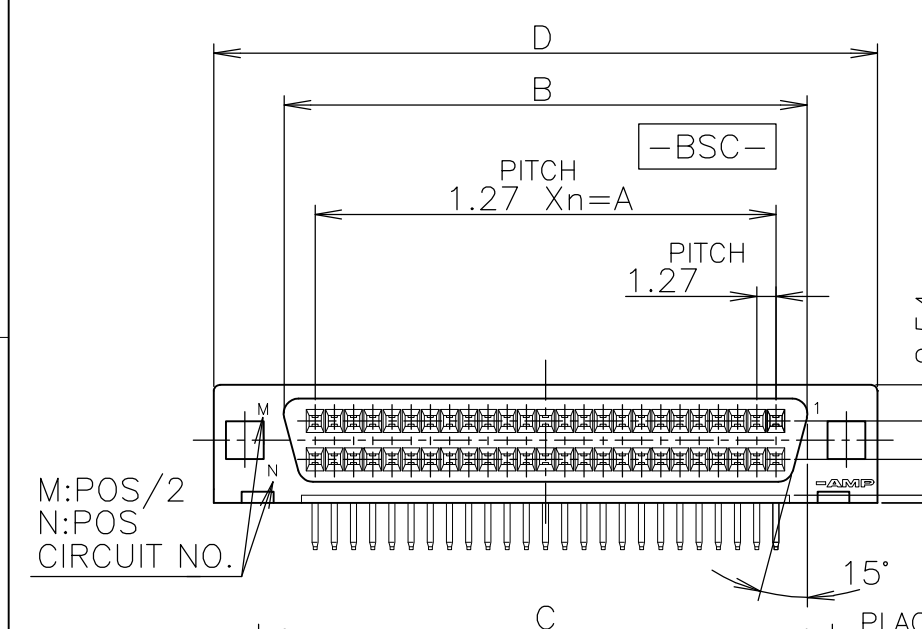
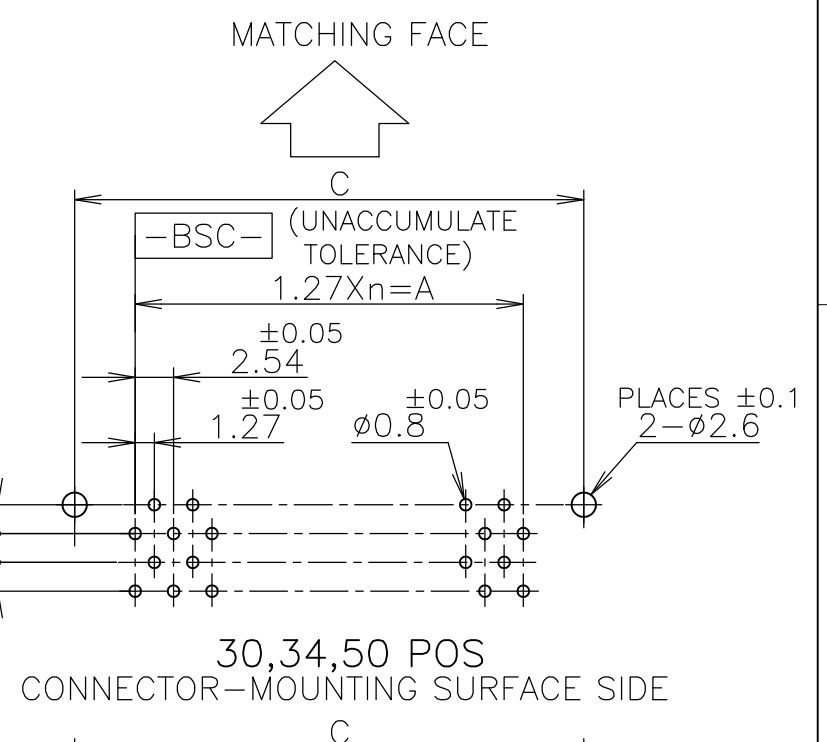
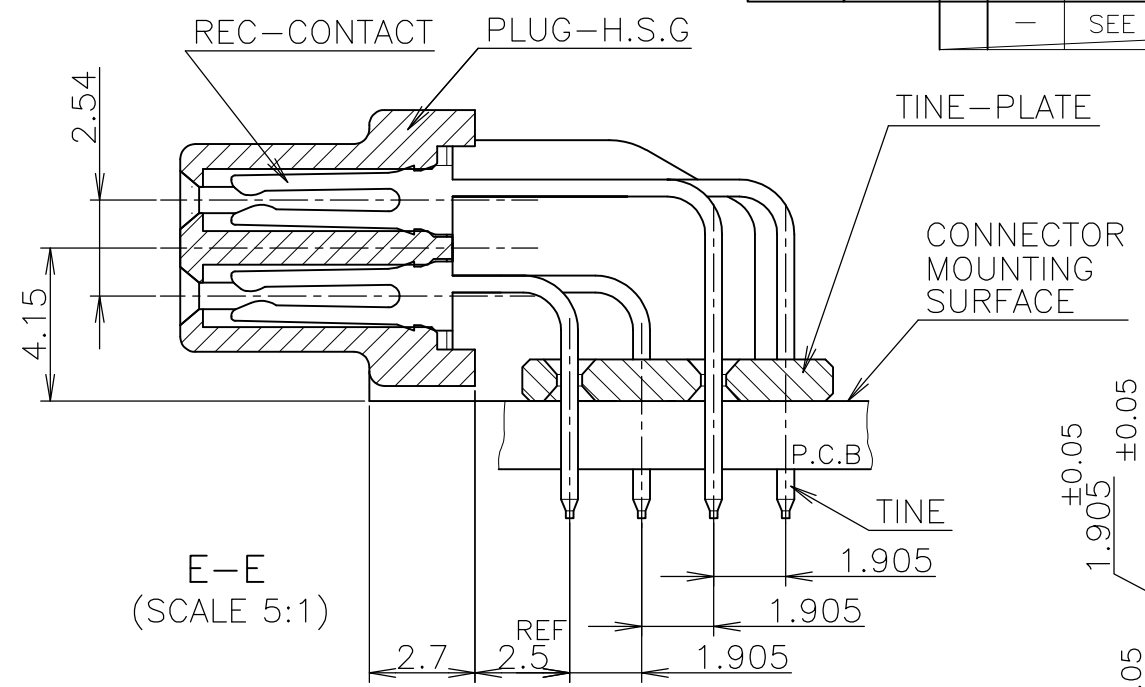
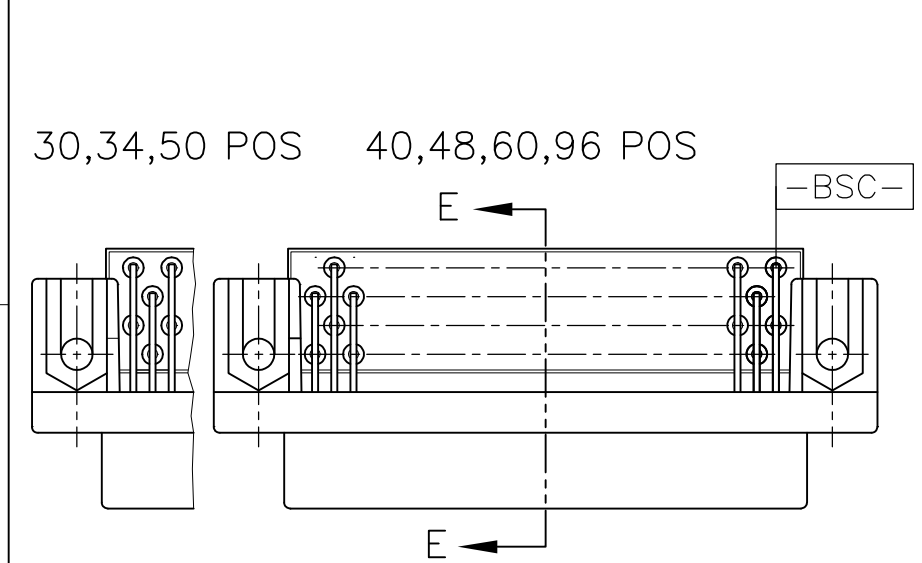

- 1 USE A P.C.B. WHOSE SURFACES ARE TREATED WITH SOLDER RESIST.
- 2 SHOW P.C.B LAYOUT FROM THE CONNECTOR-MOUNTING SURFACE SIDE.
- 3 NUMBER THE CONTACTS IN THE P.C.B OR CONNECTOR CONSECUTIVELY FROM THE [-BSC-] SIDE.
- 4 WHEN SCREWING THE CONNECTOR TO THE P.C.B, USE M2 SCREW, NUT AND WASHERS.
- 5 HOUSING MATERIAL : GLASS 20% FILLED P.B.T RESIN (UL94-V0). COLOR:BLACK
- 6 CONTACT MATERIAL : PHOSPHOR BRONZE.
- 7 FINISH : NICKEL 0.00127 MIN THK OVERALL SELECTIVE GOLD 0.00076 MIN THK ON CONTACT AREA AND TIN 0.001MIN THK ON TINE AREA.
- 8 OBSOLETE PARTS: OBSOLETE CIS STREAMLINING PER D.RENAUD/D.SINISI

| OBS | 6-          | 8   | 96 | 47 | 59.61 | 63.86 | 67.09 | 73.09 |
|-----|-------------|-----|----|----|-------|-------|-------|-------|
|     | 6-          | -6  | 48 | 23 | 29.21 | 33.38 | 36.61 | 42.61 |
| 8   | 6-          | -5  | 34 | 16 | 20.32 | 24.49 | 27.72 | 33.72 |
|     | 6-          | -4  | 60 | 29 | 36.83 | 41.00 | 44.23 | 50.23 |
|     | 6-          | -3  | 50 | 24 | 30.48 | 34.65 | 37.88 | 43.88 |
|     | 6-          | -2  | 40 | 19 | 24.13 | 28.30 | 31.53 | 37.53 |
|     | 6-5173277-1 |     | 30 | 14 | 17.78 | 21.95 | 25.18 | 31.18 |
|     | P/N         | POS | n  | A  | B     | C     | D     |       |

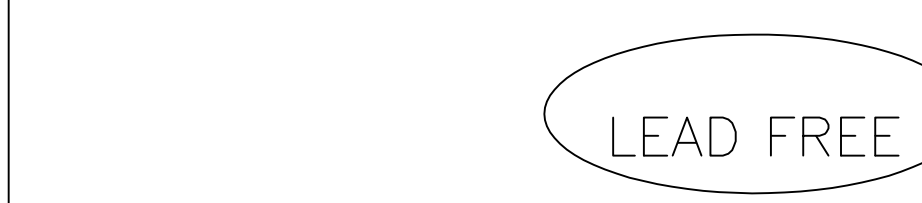

LEAD FREE

GENERAL TOLERANCE

|            |       |
|------------|-------|
| 10 ≥       | ±0.2  |
| 30 ≥ > 10  | ±0.25 |
| 100 ≥ > 30 | ±0.3  |
| ANGLES:    | ±3°   |

THIS DRAWING IS A CONTROLLED DOCUMENT.

|                |  |                  |   |
|----------------|--|------------------|---|
| DIMENSIONS: MM | TOLERANCES UNLESS OTHERWISE SPECIFIED: | DWN              | - |
| 0 PLC          | ± -                                    | CHK              | - |
| 1 PLC          | ± -                                    | APVD             | - |
| 2 PLC          | ± -                                    | PRODUCT SPEC     | - |
| 3 PLC          | ± -                                    | APPLICATION SPEC | - |
| 4 PLC          | ± -                                    | WEIGHT           | - |
| ANGLES         | ± -                                    |                  |   |
| FINISH         | 参照 △                                   |                  |   |

MATERIAL 参照 △△

THIS DRAWING IS A CONTROLLED DOCUMENT.

**Tyco Electronics** Tyco Electronics AMP K.K. Kawasaki, Japan

NAME: PLUG ASSY HORIZONTAL AMPLIMITE .050 SERIES I B-TO-B CONN.

|      |           |            |               |
|------|-----------|------------|---------------|
| SIZE | CAGE CODE | DRAWING NO | RESTRICTED TO |
| A3   | 00779     | C-5173277  | -             |

CUSTOMER DRAWING SCALE 2:1 SHEET 2 OF 2 REV A1