

- [Home](#)
- [About](#)
- [Abbatron](#)
- [Products](#)
- [Locate](#)
- [Distributor](#)
- [or](#)
- [Representative](#)
- [Contact Us](#)
- [Request](#)
- [Information](#)
- [Site Map](#)

Insulated Washer

- Nominal dimensions are indicated. Inner diameter is clearance for screw size shown. Others are +/- 1/64"
- Alternative sizes, materials, or finishes may be obtained in quantity as special order
- Nylon washers are Type 6/6, offered in natural milky white color
- Fiber washers are commercial grade black galvanized fiber

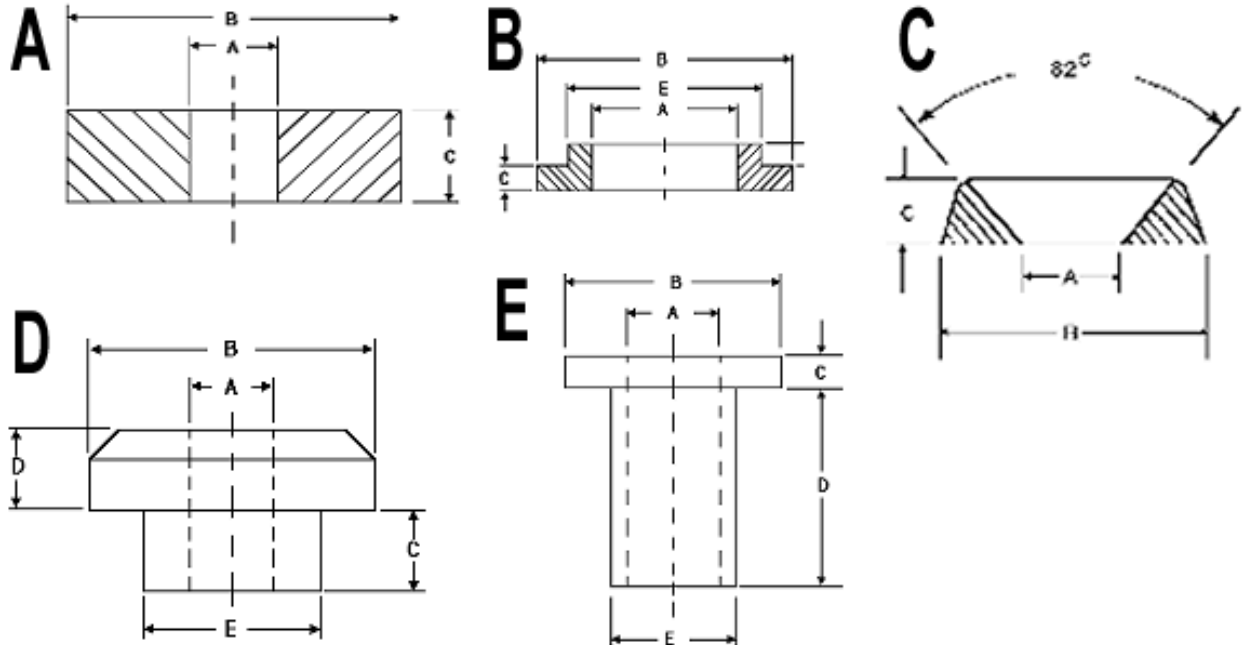

PART NO.	FIG.	SCREW CLEAR	MAT.	ID	OD	THNKS	HT.	DIA.	
				A	B	C	D	E	
2191	A	#2	FIBRE	3/32	1/4	1/32	1/32		
2652			NYLON						1/16
2671						#4	1/8		3/64
2514			FIBRE						
2161		#6		9/64	1/16				1/16
2160			NYLON						
2162					#8	11/64	1/4		3/64
2670			FIBRE						
2515		#10		13/64			3/8		1/16
2672			NYLON						
2673					1/4	1/4	3/32		3/32
2163			FIBRE						
2164		5/16		5/16					
2674			NYLON						
2518					5/16	5/16			
2675			FIBRE						
2676		5/16		5/16					
2166			NYLON						
2165					5/16	5/16			
2167			FIBRE						
2677	NYLON								

Inventory Search

Cross Reference

UPS Tracking

632 Arch Street, POB
726 Meadville, PA
16335 USA 814-724-6440

[Contact Webmaster](#)

© June 6, 2005

2165			FIBRE		1/2					
2167		5/16		5/16						
2677			NYLON		3/4	1/16	1/16			
2679					5/8					
2678		3/8	FIBRE	3/8	3/4					
2168										
2169										
2517		#10	NYLON	13/64	7/16					
2651	B	#2	FIBRE	3/32	1/4	.055	.025	5/32		
2171										
2151		#4		1/8	17/64	1/16				
2661										
2662		#6	NYLON	9/64	1/4	3/32	1/32	3/16		
2663					5/16					
2660	B	#6	NYLON		3/8	3/32	1/32	1/4		
2152					9/64			1/4	3/16	
2153				FIBRE				5/16		
2150								3/8		
2155		#8		11/64	3/8			1/4	1/4	
2665				NYLON						
2666		#10		13/64					5/16	
2156				FIBRE	1/4					
2154		1/4		NYLON	1/4			1/2		
2664										
2669		17/64		FIBRE	17/64					3/8
2159		3/8								
2158								5/8		1/2
2157								3/4		
2668								5/8		
2667				3/4		1/16				
2687	C	#6		9/64	7/16		3/32	-		
2688		#8		11/64	33/64	7/64	7/64			
2689		#10		13/64	37/64	9/64	9/64			
2690				15/64	39/64	5/32	5/32			
2691		1/4"		1/4	43/64	3/16	3/16			
2681	D	#4		1/8	9/32	.040	.040	3/16		
2682		#6	NYLON	9/64	21/64			7/32		
2683		#8		11/64	3/8	.050	.050	1/4		
2684		#10		13/64	7/16			9/32		
2685		1/4		1/4	9/16	.060	.060	3/8		
2686		3/8		3/8	3/4			1/2		
2534	E	#4		7/64	15/64	3/64	1/4	9/64		
2535		#6		9/64	19/64			11/64		
2536		#8		11/64	11/32			13/64		
2537		#10		13/64	13/32	1/16	3/8	17/64		
2538		1/4		17/64	13/64			5/16		