

- 1 RECOMMENDATIONS FOR 2.36 [.093] MIN THICK PC BOARD:
  - A. HOLE DIAMETER AFTER DRILLING = 1.14 ±0.03 [.045±.001].
  - B. HOLE DIAMETER AFTER TIN-LEAD PLATING = 0.94-1.09 [.037-.043].
  - C. HOLE DIAMETER AFTER REFLOW = 0.91-1.09 [.036-.043].
  - D. PC BOARD PLATING TO BE 7.62µm [.000300] MIN TIN-LEAD OVER 0.05±0.03 [.002±.001] COPPER.
- 2 HOUSING: NYLON OR POLYESTER, UL 94V-0 RATED, GLASS FILLED, BLACK.
- 3 CONTACTS: COPPER ALLOY PER ASTM B 122.
- 4 SHELL: CARBON STEEL PER ASTM A 109.
- 5 CONTACTS: GOLD FLASH FOR A LENGTH OF 1.02 [.040] MIN FROM MATING END, 2.54µm [.000100] MIN TIN OR TIN-LEAD FOR A LENGTH OF 5.79 [.228] MIN FROM OPPOSITE END, BOTH OVER 1.27µm [.000050] MIN NICKEL.
- 6 GOLD PLATING PER MIL-G-45204, NICKEL PLATING PER QQ-N-290, TIN PLATING PER MIL-T-10727, COPPER PLATING PER MIL-C-14550.
- 7 SHELL: 5.08µm [.000200] MIN TIN OVER 2.54µm [.000100] MIN COPPER.
- 8 CONTACTS: 0.76µm [.000030] MIN GOLD FOR A LENGTH OF 1.02 [.040] MIN FROM MATING END, 2.54µm [.000100] MIN TIN OR TIN-LEAD FOR A LENGTH OF 5.79 [.228] MIN FROM OPPOSITE END, BOTH OVER 1.27µm [.000050] MIN NICKEL.
- 9 DATUMS AND BASIC DIMENSIONS ESTABLISHED BY CUSTOMERS.

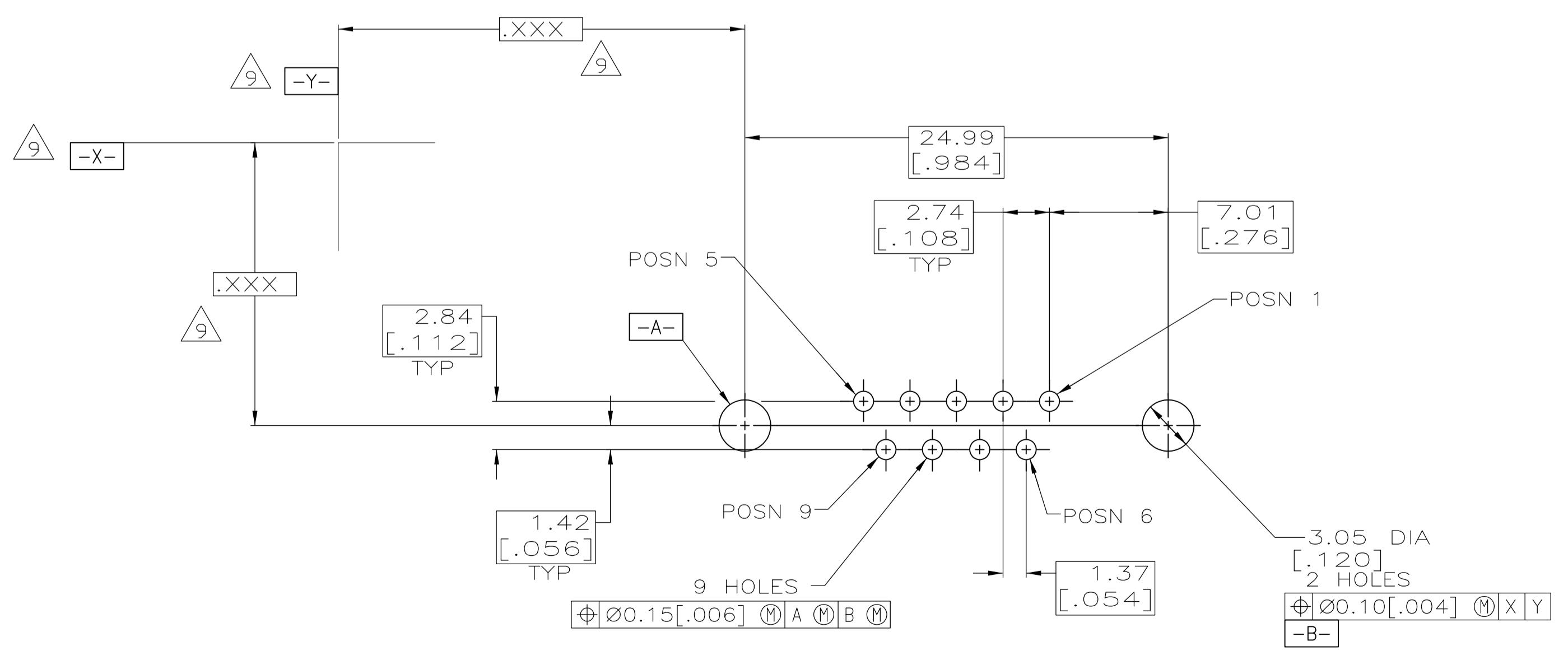
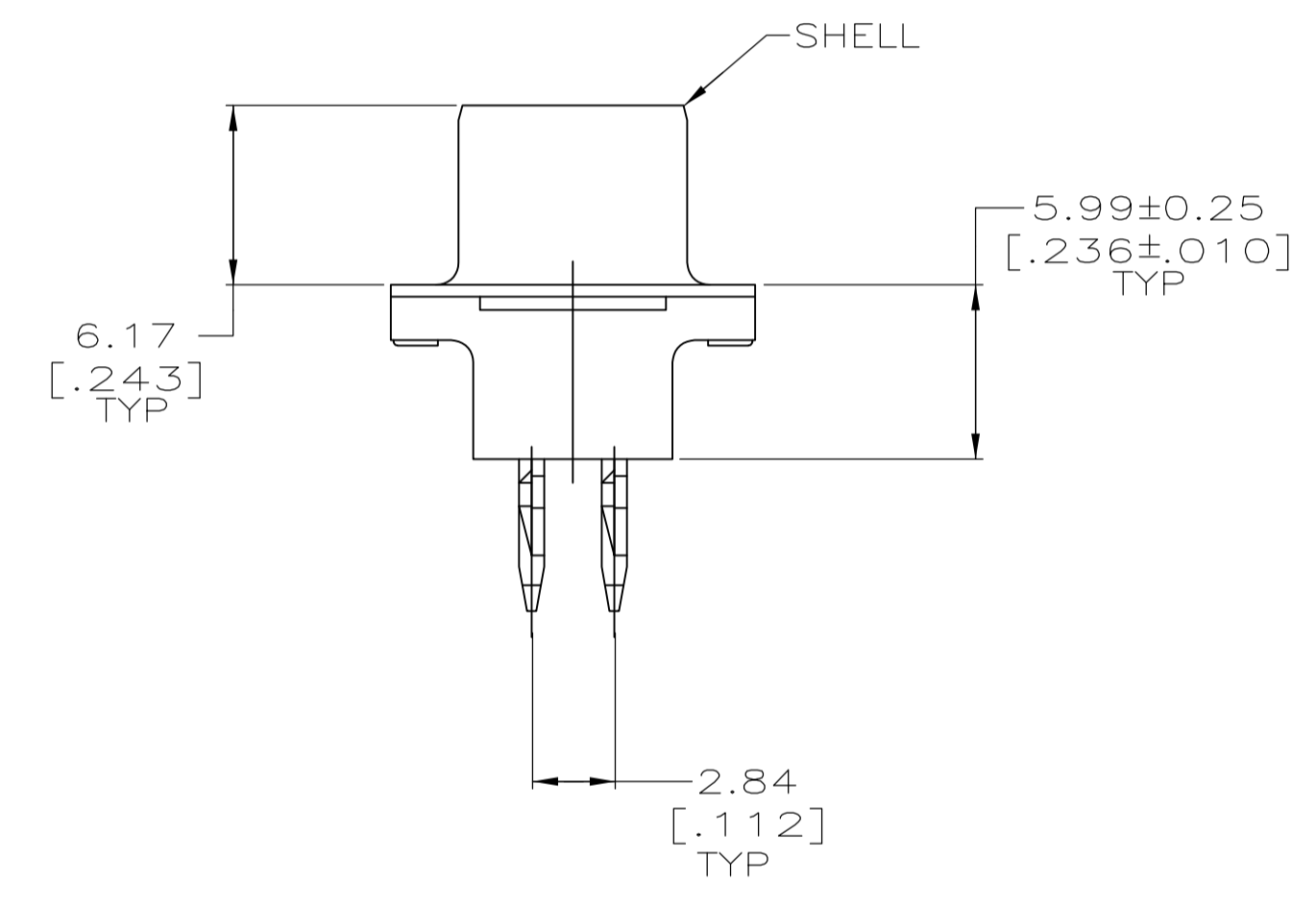
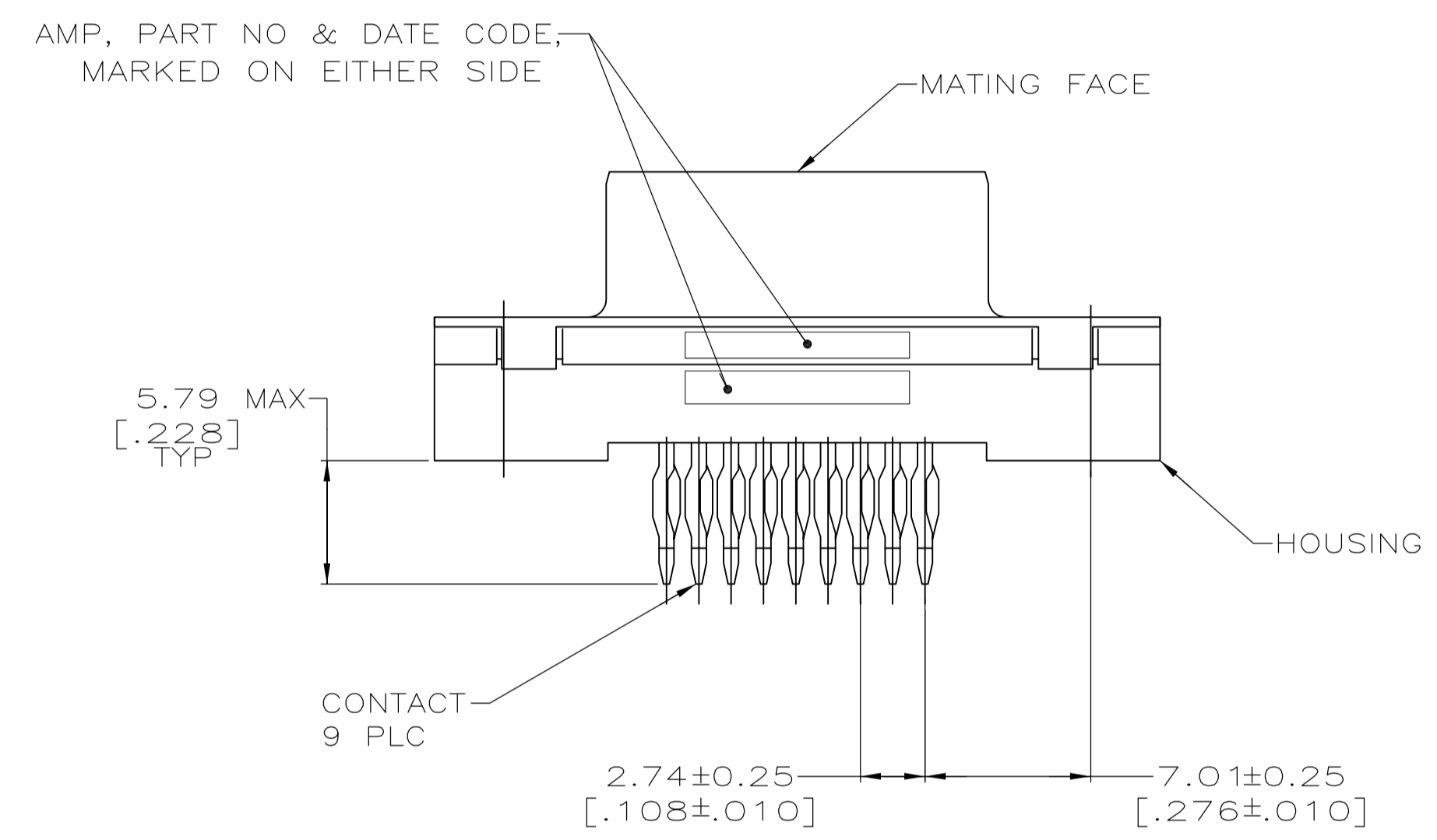

RECOMMENDED PC BOARD MOUNTING DIMENSIONS 1  
 CONNECTOR SIDE OF BOARD

	8	747089-2
SUPERSEDED BY 747089-2	5	747089-1
	FINISH	PART NO

THIS DRAWING IS A CONTROLLED DOCUMENT.		DIN C. OBERMAN 05/15/92	Tyco Electronics Corporation Harrisburg, PA 17105-3608
DIMENSIONS: mm [INCHES]		CIK R. STONE 06/17/92	
TOLERANCES UNLESS OTHERWISE SPECIFIED:		APVD PERCHERKE/PARKER 06/27/92	NAME RECEPTACLE ASSEMBLY, SIZE 1, 9 POSITION, ACTION PIN VERTICAL, FRONT METAL SHELL
0 PLC ± -		PRODUCT SPEC 108-40014	
1 PLC ± -		APPLICATION SPEC	SIZE A1
2 PLC ± 0.13 [.005]		WEIGHT -	CAGE CODE 00779
3 PLC ± -		SCALE 4:1	DRAWING NO 747089
4 PLC ± -		SHEET 1 OF 1	REV K
ANGLES ± -		CUSTOMER DRAWING	