

- ⚠️ MOLDED PARTS: FLAME RETARDANT, 94V-0 RATED, GLASS FILLED NYLON OR POLYESTER, BLACK  
 CONTACTS: BRASS  
 HARDWARE: BRASS
- ⚠️ CONTACTS: SEE TABLE  
 INSERTS: UNPLATED  
 SCREWLOCKS: NICKEL PLATED
- ⚠️ REFER TO APPLICATION SPEC FOR RECOMMENDED P.C. BOARD MOUNTING DIMENSIONS FOR AUTOMATIC INSERTION.
- ⚠️ PLATED WITH GOLD FLASH FOR A LENGTH OF .150 MIN FROM MATING END, WITH POINT OF MEASUREMENT .075 FROM MATING END OF CONTACT, .000100-.000200 TIN OR TIN-LEAD ON SOLDER END, ALL OVER .000050 MIN NICKEL ON ENTIRE CONTACT.
- ⚠️ GOLD PLATED FOR LENGTH OF .150 MIN FROM MATING END, .000030 MIN GOLD IN MATED AREA, WITH POINT OF MEASUREMENT .075 FROM MATING END OF CONTACT, .000100-.000200 TIN OR TIN-LEAD ON SOLDER END, ALL OVER .000050 MIN NICKEL.  
 -OR-  
 GOLD FLASH OVER PALLADIUM NICKEL PLATED FOR A LENGTH OF .150 MIN FROM MATING END, .000030 MIN GOLD IN MATED AREA, WITH POINT OF MEASUREMENT .075 FROM MATING END OF CONTACT, .000100-.000200 TIN OR TIN-LEAD ON SOLDER END, ALL OVER .000050 MIN NICKEL.

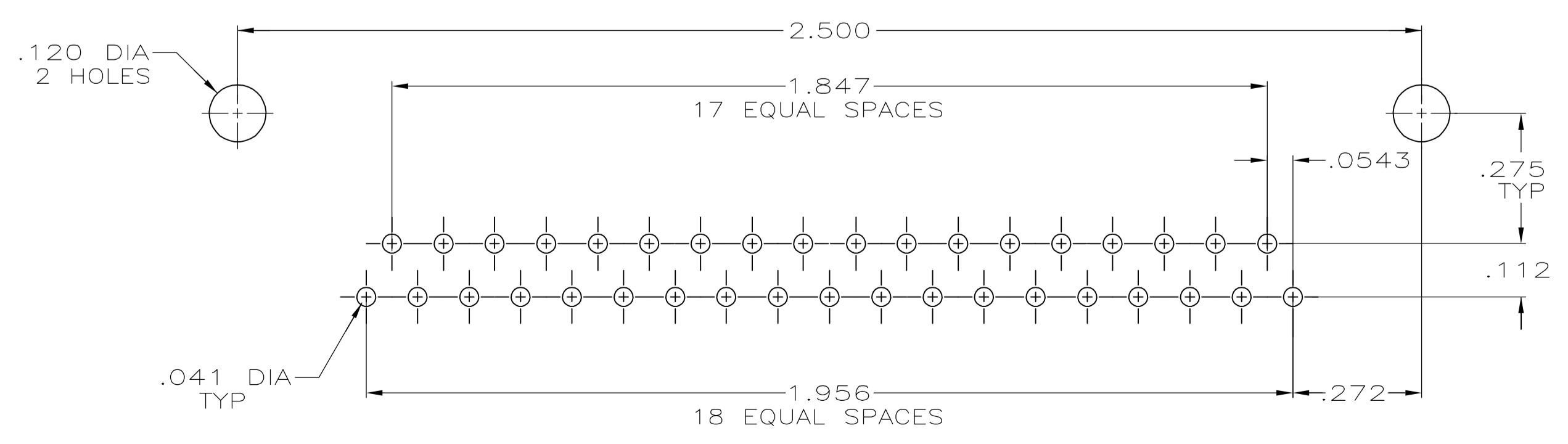
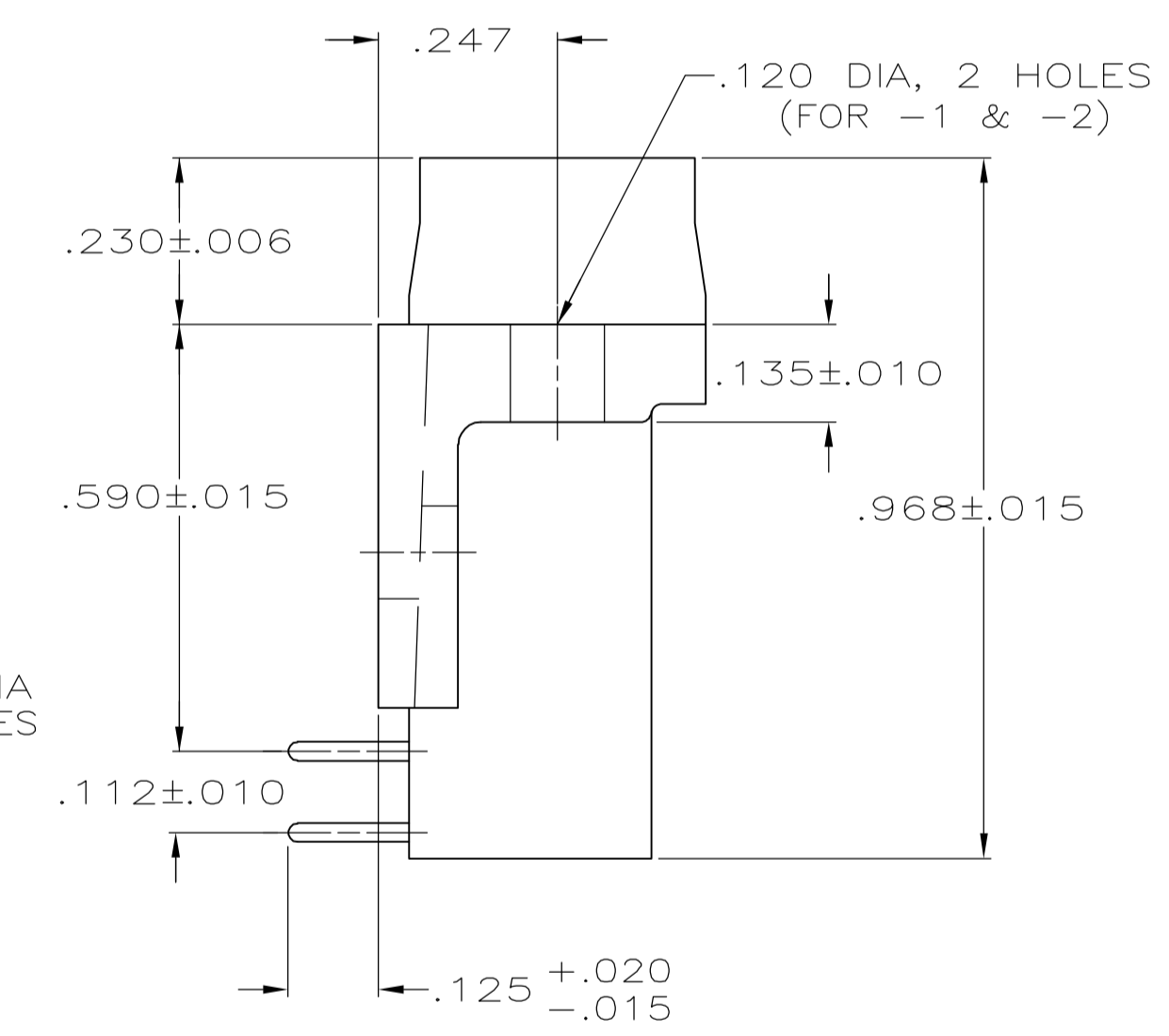
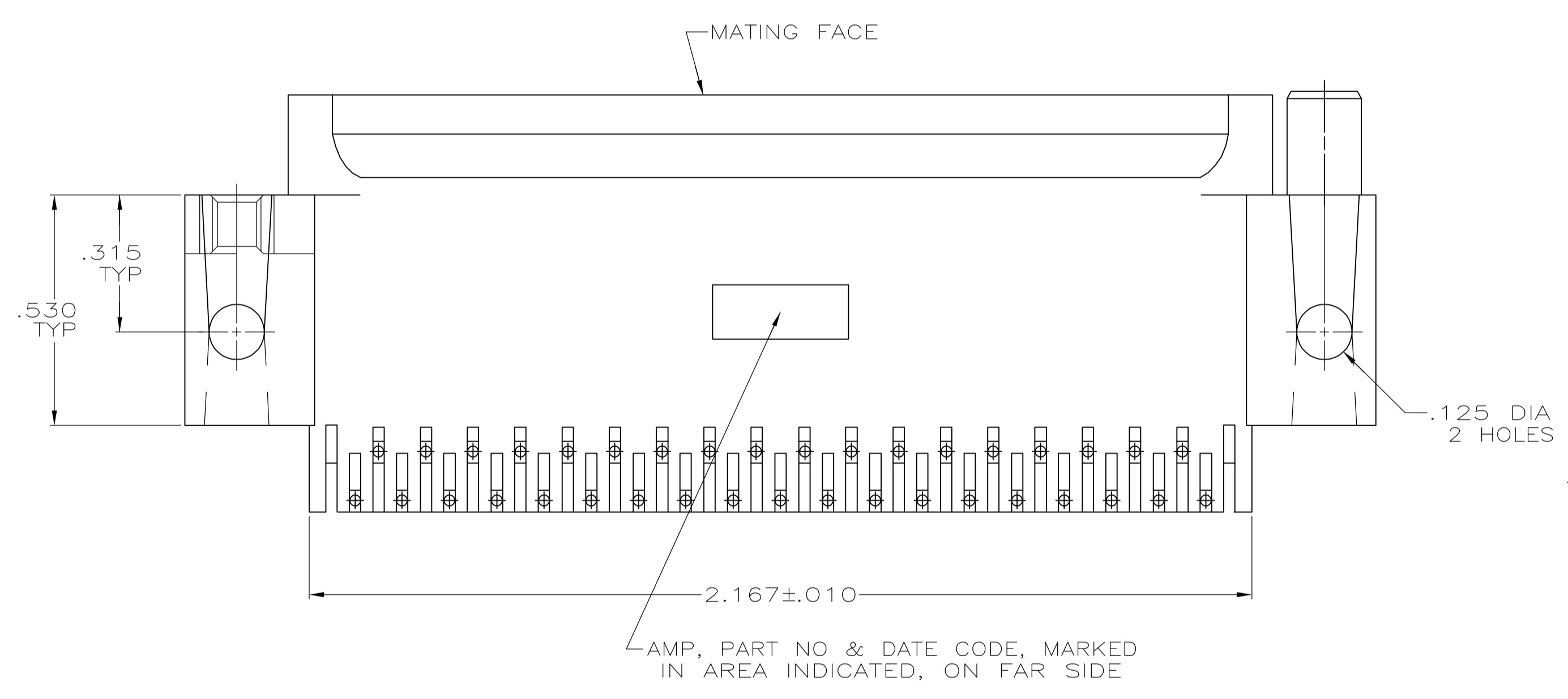

OBSELETE	WITH SCREWLOCKS	⚠️	747470 -6
OBSELETE	WITH SCREWLOCKS	⚠️	747470 -5
OBSELETE	WITH INSERTS	⚠️	747470 -4
OBSELETE	WITH INSERTS	⚠️	747470 -3
	WITH .120 DIA HOLE	⚠️	747470 -2
SUPSD BY 747470-2	WITH .120 DIA HOLE	⚠️	747470 -1
	REMARKS	FINISH	PART NUMBER

THIS DRAWING IS A CONTROLLED DOCUMENT.		DIN C RICHARD 7-29-87	Tyco Electronics Corporation	
DIMENSIONS: INCHES		CHK S WELDON 8-3-87	Harrisburg, PA 17105-3608	
TOLERANCES UNLESS OTHERWISE SPECIFIED:		APP'D B TAYLOR 8-3-87	NAME	
0 PLC	± .005	PRODUCT SPEC		
1 PLC	± .005	108-40005		
2 PLC	± .005	APPLICATION SPEC		
3 PLC	± .005	114-40015		
4 PLC	± .005	SIZE		
ANGLES	± .005	CAGE CODE DRAWING NO		
		A1 00779 C=747470		
MATERIAL	FINISH	WEIGHT	SCALE	SHEET
⚠️	⚠️	-	4:1	1 OF 1
CUSTOMER DRAWING		REV H		