

Current Rating: 3 Amps
 Insulator Resistance: 5000 Megohms min
 Dielectric Withstanding: AC 1000 V
 Operating Temperature: - 40° ~ +105° C
 Contact Material: Copper Alloy
 Insulator Material: Polyester, UL 94V-0
 Standard: PBT
 Underplate: Nickel
 Contact Area: 1u"~30u" Selective Gold
 Solder Tails Area: 100u" Tin/Lead(Brighten Tin)or
 100u" Tin/Lead Free(Brighten Tin/Matte Tin)

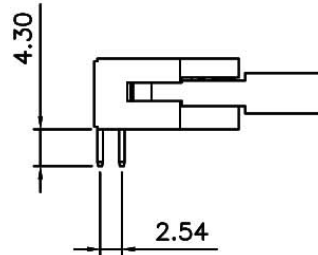
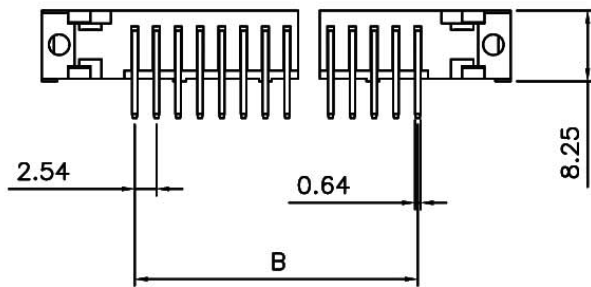
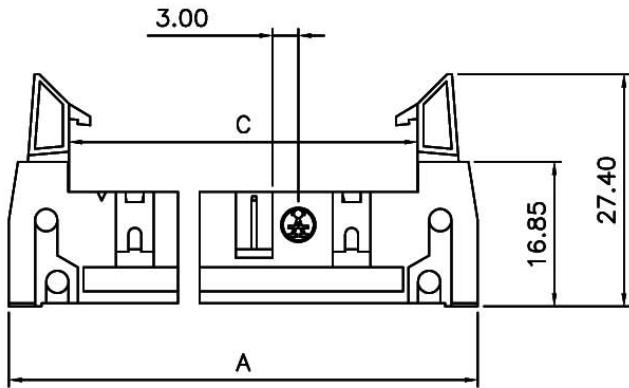

AWHxA-02x2-T-R

Latches
 0 - without latches
 2 - with short latches
 3 - with long latches

No of Contacts:
 10/14/16/20/26/34/40/50/60/64

10. LATCH OPTION:

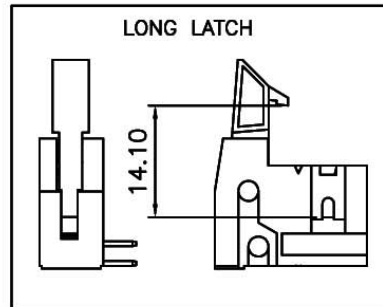
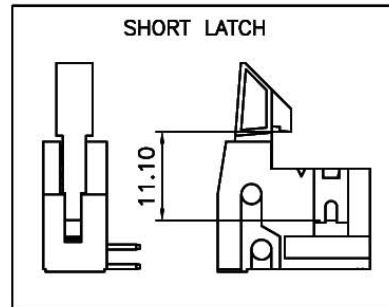
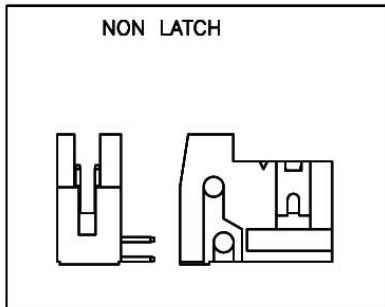

POSITION	10	12	14	16	20	24	26
A	31.90	34.60	36.98	39.52	44.60	49.68	52.15
B	10.16	12.70	15.24	17.78	22.86	27.94	30.48
C	18.00	20.54	23.08	25.62	30.70	35.78	38.32
POSITION	30	34	40	50	60	64	
A	57.40	62.38	70.00	82.70	95.60	100.7	
B	35.56	40.64	48.26	60.96	73.66	78.74	
C	43.40	48.48	56.10	68.80	81.82	86.90	

UNLESS OTHERWISE SPECIFIED TOLERANCE
±0.2

ASSMANN
Electronic Components

SCALE: AS SHOWN UNIT: mm

DRAWN JOE 12/15/05 DRAWN NAME: DUAL ROW HEADER (Pitch:2.54mm)

CHECKED / /

APPROVED / /

DATE 12/14/05

SIZE A4 REV. A

PRODUCT NO. AWHxA-02x2-T-R

FILE NAME:

REV. A ECN-0512096(Emily)

DESCRIPTION

DATE

SIZE

REV. A

FILE NAME: