

B

A

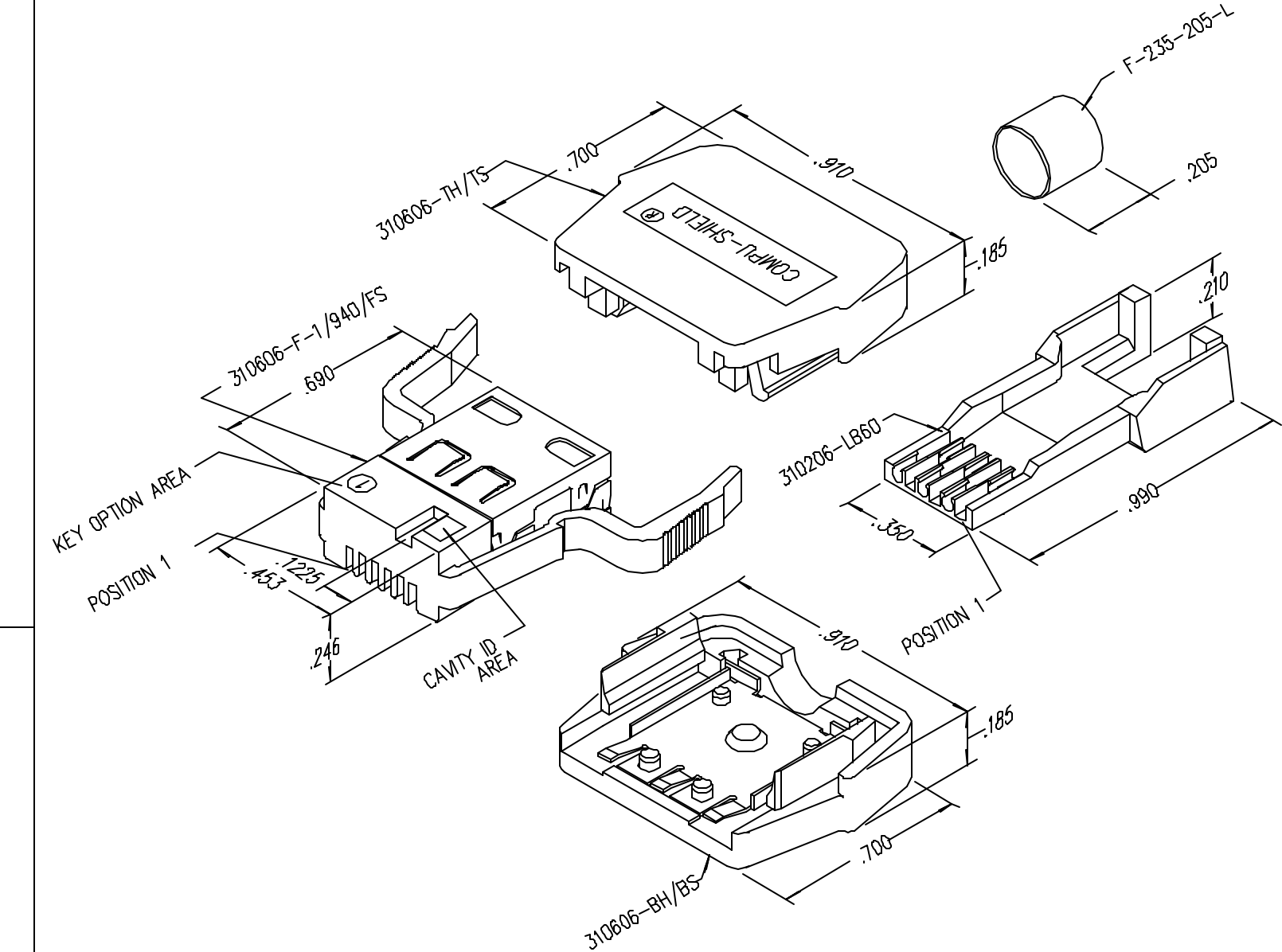

- NOTES:
1. PLUG MATERIALS:  
TOP/BOTTOM HOUSING: PC UL94 V-0 COLOR: BLACK  
FRONT PLASTIC: PC UL94 V-0 COLOR: BLUE  
LOAD BAR: THERMOPLASTIC UL94 V-0 COLOR: CLEAR  
CONTACTS/SHIELD: COPPER ALLOY  
SHIELD/FERRULE PLATING: TIN  
CONTACT PLATING: SELECTIVE GOLD IN CONTACT AREA  
SEE CHART FOR PART NUMBER
  2. CONTACTS TERMINATE SOLID OR STRANDED CONDUCTORS  
UP TO .064" OUTSIDE DIAMETER ON POSITION #1 & #6 CONDUCTORS,  
UP TO .021" OUTSIDE DIAMETER ON POSITION #2 & #5 CONDUCTORS,  
AND UP TO .042 " OUTSIDE DIAMETER ON POSITION #3 & #4 CONDUCTORS
  3. TOLERANCES COMPLY WITH F.C.C. DIMENSION REQUIREMENTS.
  4. HOUSING WILL ACCEPT CABLE UP TO .220" OUTSIDE DIAMETER OF JACKET
  5. FOR PRODUCT SPECIFICATIONS SEE PRO26-01
  6. TERMINATED PLUG HEIGHT .234±.002

|                                   |                |
|-----------------------------------|----------------|
| 50 MICRO-INCHES [1.27um]          | SS-310606-1-60 |
| CONTACT PLATING<br>IN MATING AREA | PART NUMBER    |

THIRD ANGLE PROJECTION

DO NOT SCALE DRAWING  
DRAWING IS SUBJECT TO  
CHANGE WITHOUT NOTICE

DIMENSIONS: INCHES [METRIC]

UNLESS OTHERWISE SPECIFIED  
TOLERANCES ARE ±.005 [0.13]  
ANGLES ARE ± 1°

SHEET NO. 1 OF 1

# Bel Stewart Connector

11118 Susquehanna Trail South  
Glen Rock, PA 17327-9199  
(717) 235-7512 Fax: (717) 235-7954 <http://www.stewartconnector.com>

TITLE: 6X6 COMPU-SHIELD PLUG FINAL ASSEMBLY

|                  |              |
|------------------|--------------|
| DRN BY: TRM      | DATE 5-15-01 |
| APPD BY: TRM     | DATE 5-15-01 |
| DWG NO. CT310029 | REV. B2      |

THIS DRAWING AND THE SUBJECT MATTER SHOWN THEREON ARE CONFIDENTIAL AND THE PROPRIETARY PROPERTY OF BEL STEWART CONNECTOR AND SHALL NOT BE REPRODUCED, COPIED, OR USED IN ANY MANNER WITHOUT PRIOR WRITTEN CONSENT OF BEL STEWART CONNECTOR. THE SUBJECT MATTER MAY BE PATENTED OR A PATENT MAY BE PENDING.

REV. 6/3/05

