

DRAWING MADE IN THIRD ANGLE PROJECTION

MOD	LOC	DIST	REVISIONS					
22	BD	39	P	F	/LTR	DESCRIPTION	DATE	APPROVED
			✓	✓		A REDRAWN ON CAD	4/11/90	-

THIS DRAWING IS UNPUBLISHED. RELEASED FOR PUBLICATION BY AMP INCORPORATED. ALL INTERNATIONAL RIGHTS RESERVED. © COPYRIGHT 19

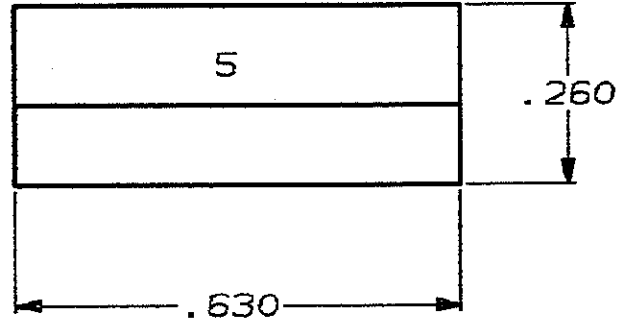
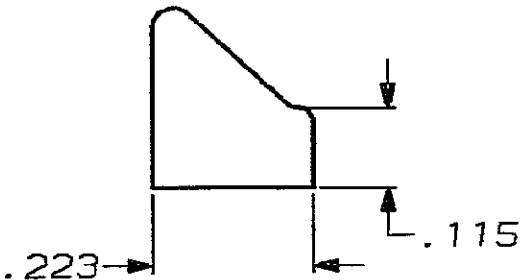

205728-1
PART NUMBER

DO NOT SCALE PRINT. UNLESS SPECIFIED DIMENSIONS IN mm TOLERANCES ON:
2 PLC DEC ± -
3 PLC DEC ± .005
ANGLES ± 0°30'

MATERIAL
POLYPROPYLENE,
COLOR: BLACK

FINISH
-

DR 4/11/90
A. STAUB BS
CHK - 6-18-90
- W.G. Smith
APPD [Signature] 7-9-90
APPD [Signature] 7-16-90
PRODUCT SPEC -
APPLICATION SPEC -
WEIGHT -

AMP AMP INCORPORATED
Harrisburg, Pa. 17105

NAME
GATE CABLE SUPPORT
FOR SIZE #5, 45° & 180°, AMPLIMITE™

SIZE A	FSCM NO 00779	DRAWING NO 205728
SCALE 4:1	SHEET 1 of 1	

AMP 1469-32 REV 3-89

CUSTOMER DRAWING