

THIS DRAWING IS UNPUBLISHED. RELEASED FOR PUBLICATION  
 © COPYRIGHT BY TYCO ELECTRONICS CORPORATION. ALL RIGHTS RESERVED.

LOC	DIST	REVISIONS					
CM	0	P	LTR	DESCRIPTION	DATE	DWN	APVD
		F		ECO-07-012878	20JUN07	KW	DB
		F1		REVISED PER ECO-09-023313	10OCT09	KK	AEG

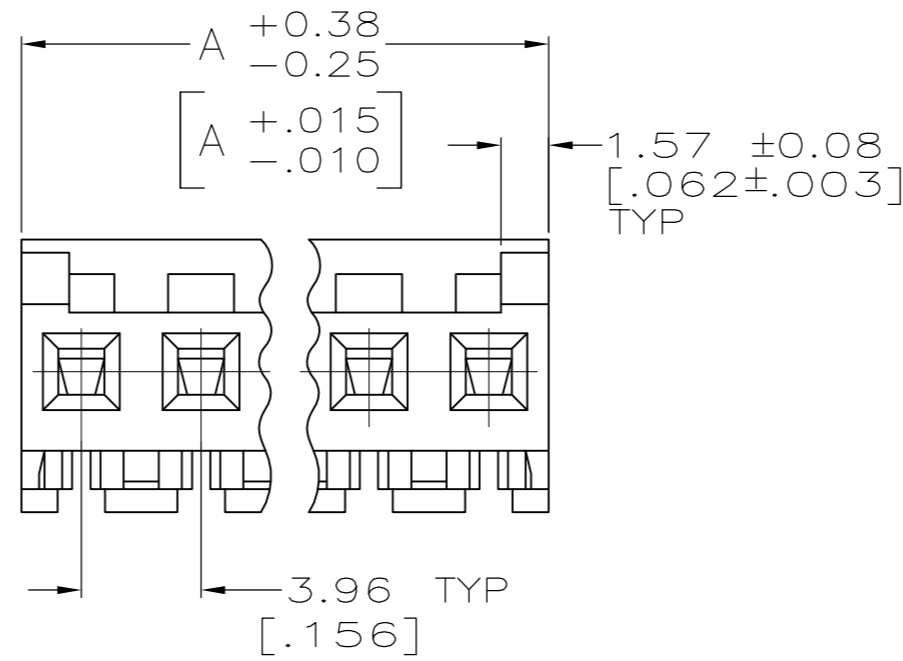
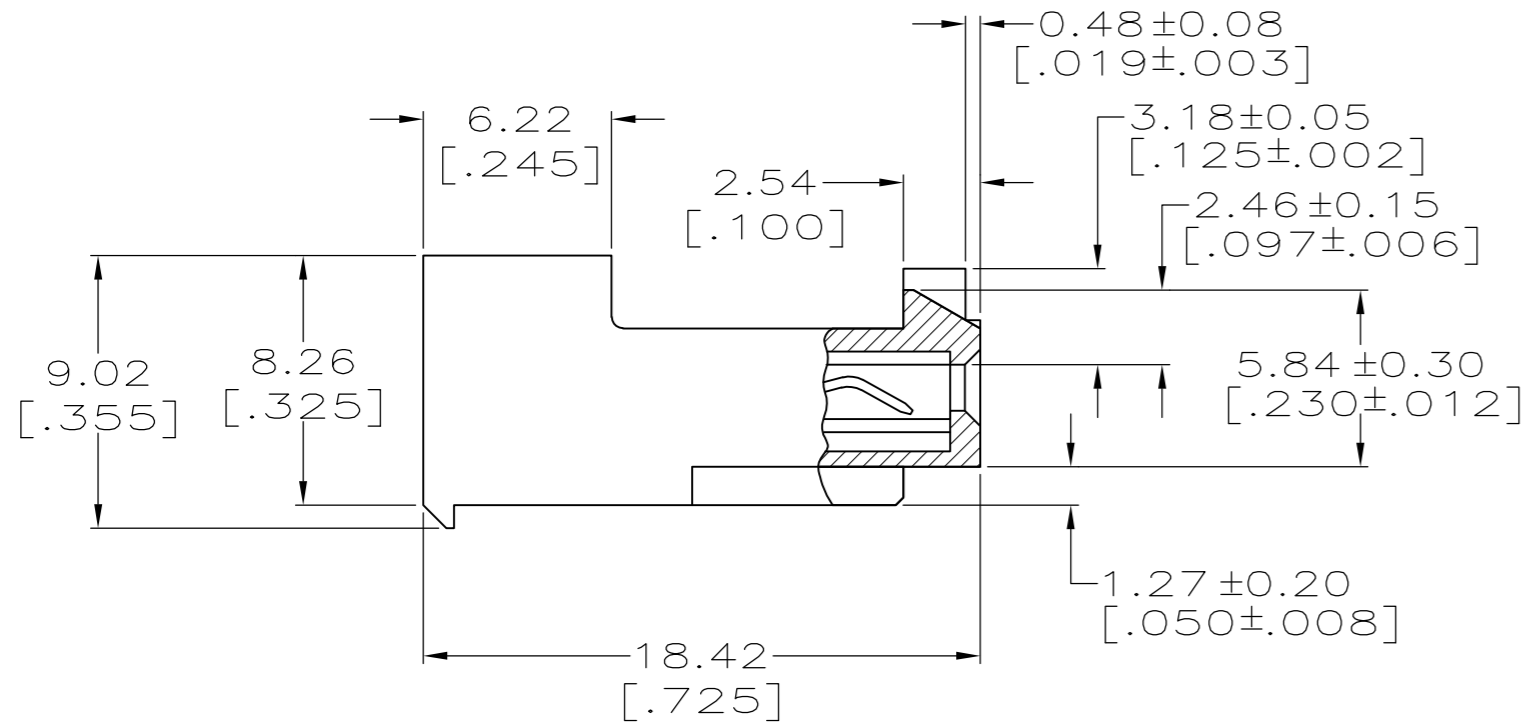
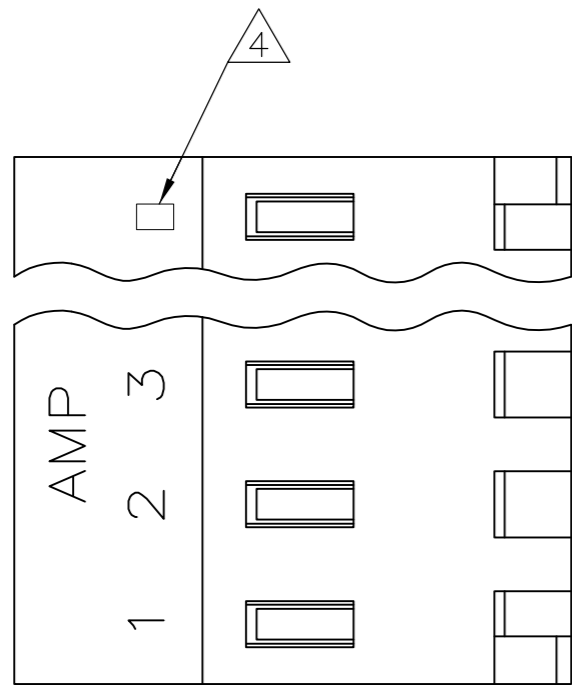

- 1 MATERIAL:  
 CONNECTOR - NYLON UL94V-2 (ORANGE).  
 CONTACTS - 0.30[.012] THICK COPPER ALLOY.  
 PLATING - 0.00038[.000015] GOLD IN CONTACT AREA.  
 0.00203[.000080] MIN THICKNESS BRIGHT TIN LEAD IN  
 SLOT AREA FOR 641148-2 THRU 2-641148-4 OR  
 MATTE WHISKER MITIGATED TIN IN SLOT AREA FOR  
 3-641148-2 THRU 5-641148-4 OVER NICKEL  
 UNDERPLATE.
2. CONTACTS ACCEPT 18 AWG WIRE WITH 2.41[.095] MAX  
 INSULATION DIAMETER.
3. CONTACTS MUST ACCEPT 1.14±0.03[.045±.001] SQUARE  
 POST AND REMAIN LOCKED IN POSITION.
- 4 IDENTIFICATION NUMBER FOR LAST CIRCUIT MAY  
 NOT APPEAR ON ALL ASSEMBLIES.
5. DIMENSIONS IN BRACKETS ARE IN INCHES.
6. HOUSING FEATURES ARE: CLOSED END WITH LOCKING  
 RAMP AND POLARIZING TAB.
- 7 NOTE DELETED.
- 8 NOTE DELTED.
- 9 OBSOLETE PARTS: OBSOLETE CIS STREAMLINING PER D.RENAUD/D.SINISI

CONTACT FINISH	DIM A	NO. OF CIRCUITS	PART NO.
TIN	47.55 [1.872]	12	4-644284-2
	43.59 [1.716]	11	4-644284-1
	39.62 [1.560]	10	4-644284-0
	35.66 [1.404]	9	3-644284-9
	31.70 [1.248]	8	3-644284-8
	27.74 [1.092]	7	3-644284-7
	23.77 [.936]	6	3-644284-6
	19.81 [.780]	5	3-644284-5
	15.85 [.624]	4	3-644284-4
	11.89 [.468]	3	3-644284-3
	7.92 [.312]	2	3-644284-2
	TIN-LEAD	47.55 [1.872]	12
43.59 [1.716]		11	1-644284-1
39.62 [1.560]		10	1-644284-0
35.66 [1.404]		9	644284-9
31.70 [1.248]		8	644284-8
27.74 [1.092]		7	644284-7
23.77 [.936]		6	644284-6
19.81 [.780]		5	644284-5
15.85 [.624]		4	644284-4
11.89 [.468]		3	644284-3
7.92 [.312]		2	644284-2

9 SUPERSEDED  
 9 SUPERSEDED  
 9 SUPERSEDED  
 9 SUPERSEDED  
 9 SUPERSEDED

**METRIC**

THIS DRAWING IS A CONTROLLED DOCUMENT. DWN B. LEWIS 2-12-91  
 CHK R. SWING 2-12-91  
 APVD -  
 PRODUCT SPEC 108-1051  
 APPLICATION SPEC 114-1020  
 MATERIAL -  
 FINISH -

Tyco Electronics Corporation  
 Harrisburg, Pa 17105-3608

NAME MTA 156 CONNECTOR ASSEMBLY,  
 18 AWG, STANDARD

SIZE A2 CAGE CODE 00779 DRAWING NO C=644284 RESTRICTED TO -  
 CUSTOMER DRAWING SCALE 4:1 SHEET 1 OF 1 REV F1