

THIS DRAWING IS UNPUBLISHED. RELEASED FOR PUBLICATION
 © COPYRIGHT BY TYCO ELECTRONICS CORPORATION. ALL RIGHTS RESERVED.

LOC	DIST	REVISIONS			
P	LTR	DESCRIPTION	DATE	DWN	APVD
	CM	54			
	C	ECO-07-012047	01JUN07	KW	DB
	C1	REVISED PER ECO-09-023313	09OCT09	KK	AEG

- 1 MATERIAL: CONNECTOR - NYLON UL94V-2 (ORANGE).
 CONTACTS - 0.30 [.012] THICK COPPER ALLOY (BRIGHT-TIN LEAD 0.00203 [.000080] MIN THK FOR CONTACTS 644461-2 THRU 1-644461-4, MATTE WHISKER MITIGATED TIN 0.00203 [.000080] MIN THICK FOR CONTACTS 3-644461-2 THRU 4-644461-4)
- 2. CONTACTS ACCEPT 18 AWG WIRE WITH 2.41 [.095] MAX INSULATION DIAMETER.
- 3. CONTACTS MUST ACCEPT 1.14±0.03 [.045±.001] SQUARE POST AND REMAIN LOCKED IN POSITION.
- 4 IDENTIFICATION NUMBER FOR LAST CIRCUIT MAY NOT APPEAR ON ALL ASSEMBLIES.
- 5. DIMENSIONS IN BRACKETS ARE IN INCHES.
- 6. HOUSING FEATURES ARE: CLOSED END WITHOUT LOCKING RAMP AND WITH POLARIZING TAB.
- 7 OBSOLETE PARTS: OBSOLETE CIS STREAMLINING PER D.RENAUD/D.SINISI

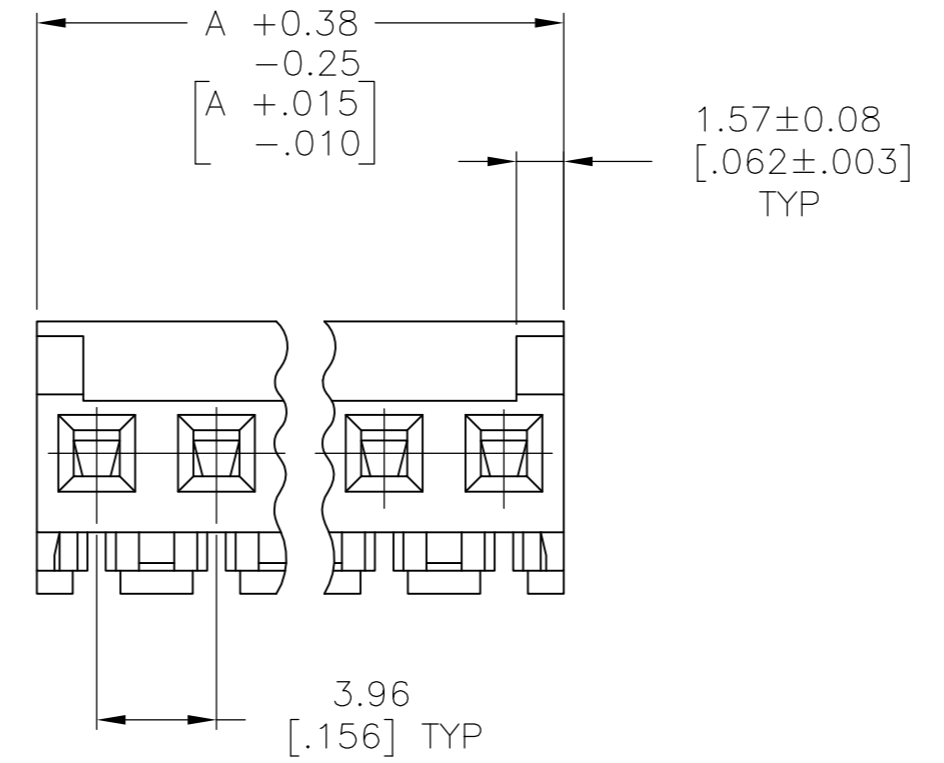
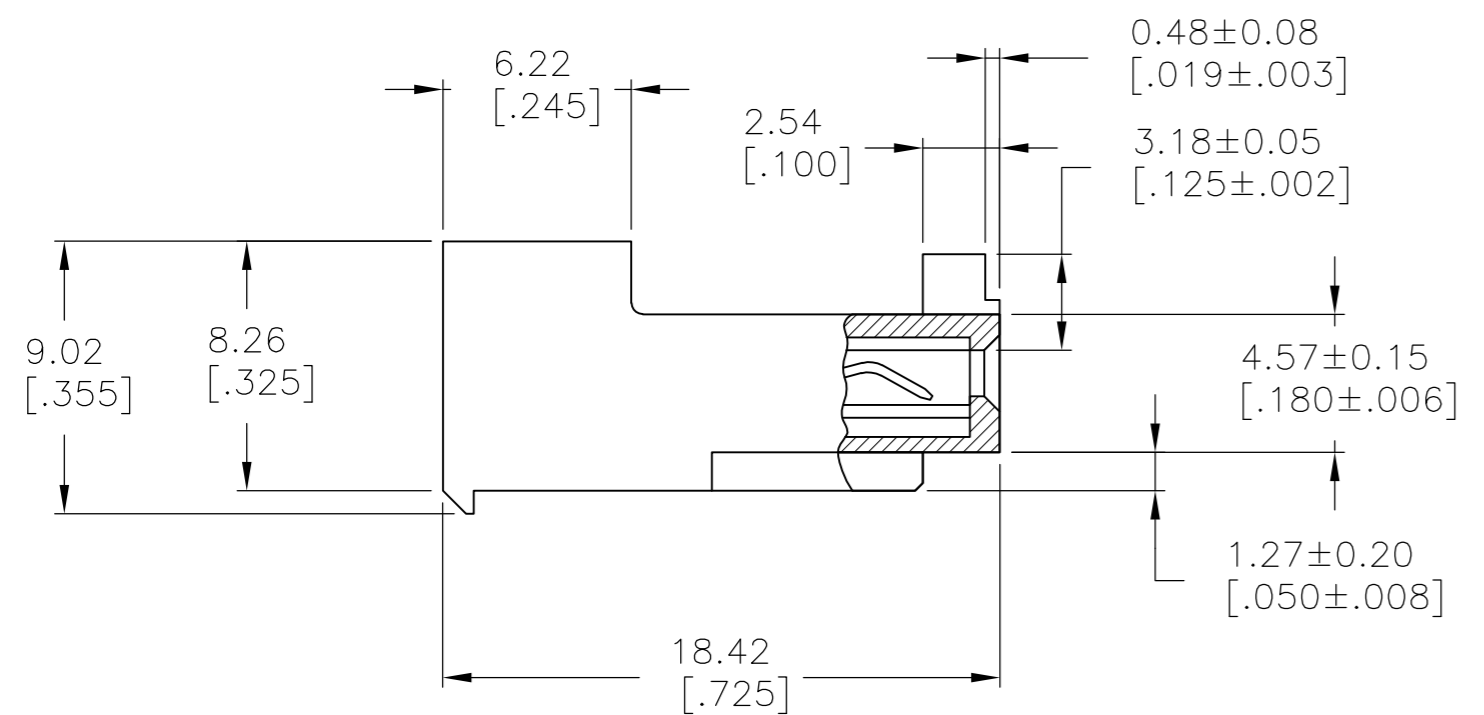
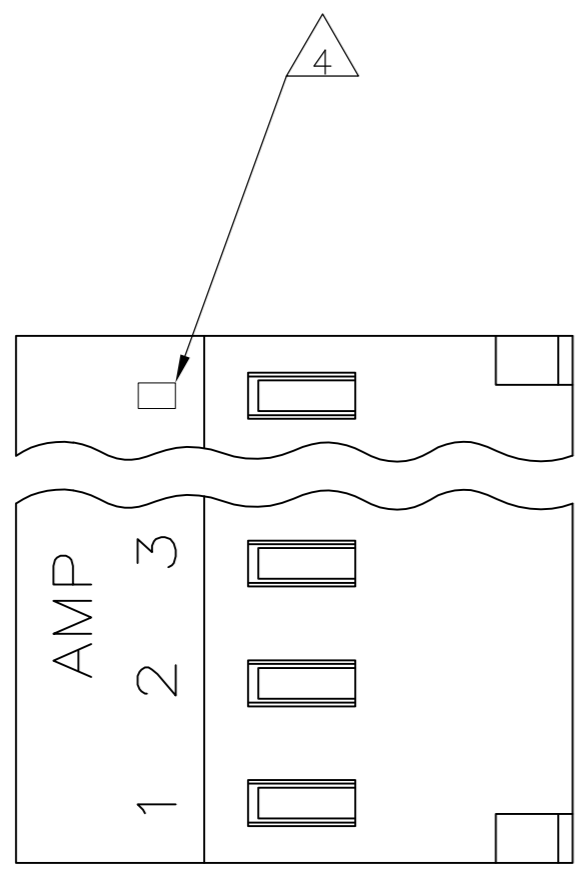

	DIM A	NO. OF CIRCUITS	PART NO.
	55.47 [2.184]	14	4-644461-4
	51.51 [2.028]	13	4-644461-3
	47.55 [1.872]	12	4-644461-2
	43.59 [1.716]	11	4-644461-1
	39.62 [1.560]	10	4-644461-0
	35.66 [1.404]	9	3-644461-9
	31.70 [1.248]	8	3-644461-8
	27.74 [1.092]	7	3-644461-7
	23.77 [.936]	6	3-644461-6
	19.81 [.780]	5	3-644461-5
	15.85 [.624]	4	3-644461-4
	11.89 [.468]	3	3-644461-3
	7.92 [.312]	2	3-644461-2
△ SUPERCEDED	55.47 [2.184]	14	1-644461-4
△ SUPERCEDED	51.51 [2.028]	13	1-644461-3
△ SUPERCEDED	47.55 [1.872]	12	1-644461-2
△ SUPERCEDED	43.59 [1.716]	11	1-644461-1
△ SUPERCEDED	39.62 [1.560]	10	1-644461-0
△ SUPERCEDED	35.66 [1.404]	9	644461-9
△ SUPERCEDED	31.70 [1.248]	8	644461-8
△ SUPERCEDED	27.74 [1.092]	7	644461-7
△ SUPERCEDED	23.77 [.936]	6	644461-6
△ SUPERCEDED	19.81 [.780]	5	644461-5
△ SUPERCEDED	15.85 [.624]	4	644461-4
△ SUPERCEDED	11.89 [.468]	3	644461-3
△ SUPERCEDED	7.92 [.312]	2	644461-2

THIS DRAWING IS A CONTROLLED DOCUMENT.

DWN B. LEWIS 12FEB91
 CHK R. SWING 12FEB91
 APVD D.R. CLARK 20FEB91

TOLERANCES UNLESS OTHERWISE SPECIFIED:
 0 PLC ± -
 1 PLC ± -
 2 PLC ± -
 3 PLC ± -
 4 PLC ± -
 ANGLES ± -
 FINISH △

MATERIAL △

12FEB91
 Tyco Electronics Corporation
 Harrisburg, Pa 17105-3608

NAME MTA 156 CONNECTOR ASSEMBLY, 18 AWG, STANDARD

PRODUCT SPEC 108-1051
 APPLICATION SPEC 114-1020

SIZE A2 CAGE CODE 00779 DRAWING NO C=644461 RESTRICTED TO -

WEIGHT - SCALE 4:1 SHEET 1 OF 1 REV C1

CUSTOMER DRAWING

