

Surface Mount PLCC Sockets

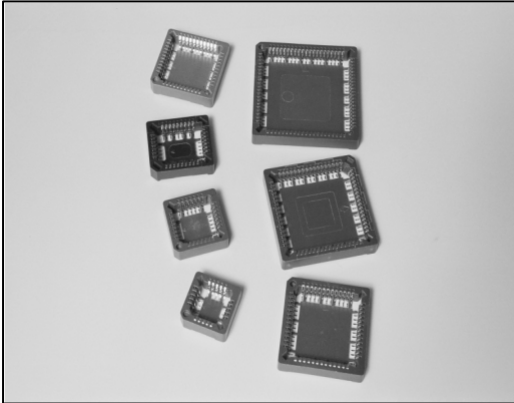

FEATURES

- Low profile design
- Seven different circuit sizes: 20 thru 84 way
- Available in tubes or tape and reel

SPECIFICATIONS

- Insulator: polyphenylene sulfide, UL94V-0 rated
- Contact Material: phosphor bronze
- Insulation resistance: 100 Megohms minimum
- Contact resistance: 30 milliohms maximum
- Plating: tin over nickel, 150u" minimum
- Temperature: -55 to +105 degrees °C
- Hi Temp, 230 °C for 60 s or 260 °C for 10 s max
- Dielectric withstanding: 500VAC (+MS) for one minute

ORDERING GUIDE

D00 - 020 - 4 9 0 - 001

Series
of Contacts
Contact Plating
Contact Tail
Profile
Package

<u>Series</u> D00	PLCC socket
<u>Number of Contacts</u> 020-084	
<u>Contact Plating</u> 2 3 4 6 9	gold flash 15u" gold 150 tin/lead over nickel 30u" gold 50u" gold
<u>Contact Tail</u> 9	surface mount
<u>Profile</u> 0	low profile
<u>Package</u> 001 002	tube tape & reel

EDAC Part #	Description	Tube Qty	Tape & Reel Qty
D00-020-X90-00X	20 contact	37	450
D00-028-X90-00X	28 contact	32	400
D00-032-X90-00X	32 contact	38	500
D00-044-X90-00X	44 contact	35	300
D00-052-X90-00X	52 contact	22	250
D00-068-X90-00X	68 contact	18	225
D00-084-X90-00X	84 contact	15	200

FOR MORE INFORMATION VISIT www.edac.net OR EMAIL edac@edac.net
Phone: 416-754-3322 Fax: 416-754-3299



THIS IS A C.A.D. GENERATED DRAWING
DO NOT MAKE MANUAL REVISIONS TO MASTERS.

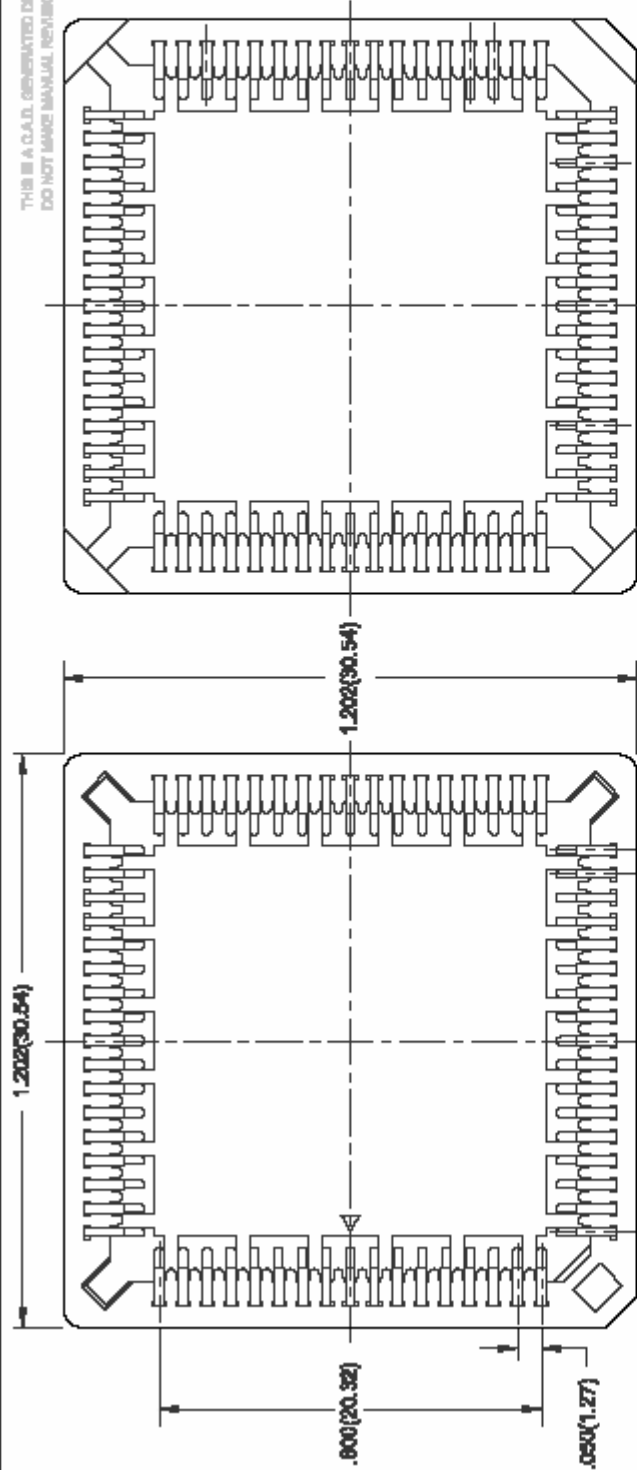

BOTTOM VIEW

MATERIALS AND FINISH
HOUSING: POLYPHENYLENE SULFIDE
UL 94V-0
CONTACTS: PHOSPHOR BRONZE
100 MICRONS MIN. OF TIN LEAD
OVER NICKEL

SPECIFICATIONS
INSULATION RESISTANCE: 1000 MEGOHMS MIN.
DIELECTRIC WITHSTANDING STRENGTH:
500VAC (rms) FOR 1 MINUTE
CONTACT RESISTANCE: 30 MILLIOHMS MAX.
TEMPERATURE: -55°C TO +105°C

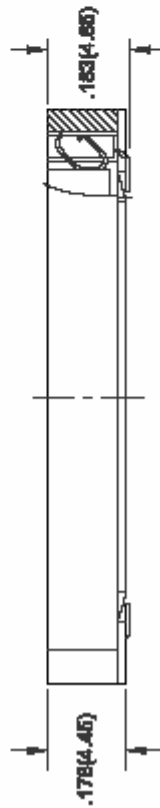

<p>PLCC SMD TYPE LOW PROFILE 68 POSITIONS</p>		ACAD REFERENCE NO. DOO (PLCC)	
		DRAWN: F. BRIONES	DATE: MAR. 15/02
<p>EDAC INC TORONTO, ONTARIO CANADA</p> <p>EDAC</p> <p>YOUR CONNECTION TO QUALITY & SERVICE</p>		CHECKED:	DATE:
		PART NUMBER DOO-068-490-001	ISSUE
<p>THESE DRAWINGS AND SPECIFICATIONS ARE THE PROPERTY OF EDAC INC. AND SHALL NOT BE REPRODUCED OR COPIED IN ANY MANNER WITHOUT THE WRITTEN PERMISSION OF EDAC INC.</p>		DRAWING NUMBER DOO-068-490-001	